

PERMANENT EASEMENT = 0.28 acres
 CONSTRUCTION EASEMENT = 0.28 acres

WILLIAMSBURG LANDING INC.
 D.B. 246 Pg. 116

NOTE: CONSTRUCTION PLANS
 JAMES TERRACE WATER
 TRANSMISSION MAIN SHEET 29 OF 26

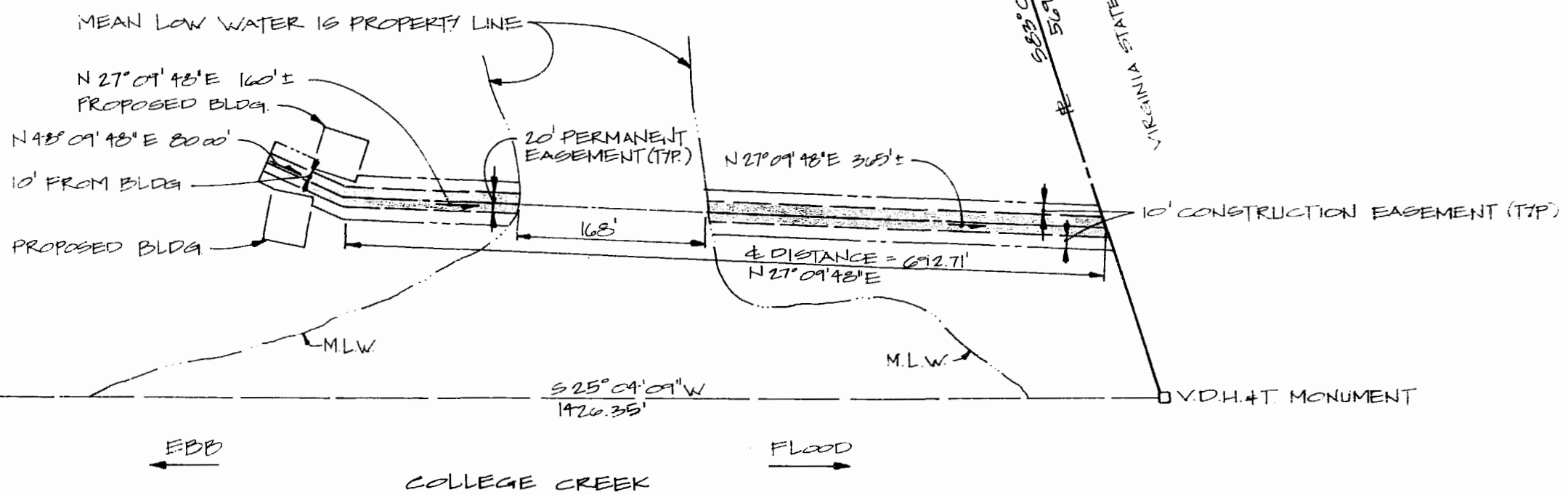

VIRGINIA STATE ROUTE 199 (LIMITED ACCESS),
 R/W VARIES
 D.B. 151 Pg. 397
 D.B. 53 Pg. 709

CEGG THE CEGG PARTNERSHIP
 ARCHITECTS & ENGINEERS
 CORPORATE CENTER TWO, SUITE 240
 VIRGINIA BEACH, VA. 23462
 804 499 4562

**PLAT SHOWING
 WATERLINE EASEMENT**

TO: JAMES CITY SERVICE
 AUTHORITY
 FROM: WILLIAMSBURG
 LANDING INC.

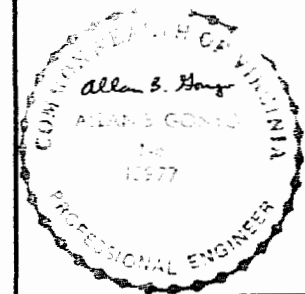

COMM. NO. 4012
 SCALE 1" = 100'
 DATE AUG 15, 1984
 DWN. BY DPN
 CKD. BY ABG

Recorded 17th day of December 1985
 3:08 P.M.
 P. B. No. 290
 217
 Wilson Steward Clerk

