

PROJECT BENCHMARK
MANHOLE RIM
ELEVATION=24.15
INVERT=24.93

ALBEMARLE DRIVE

ALBEMARLE DRIVE

ALBEMARLE DRIVE

RALEIGH STREET

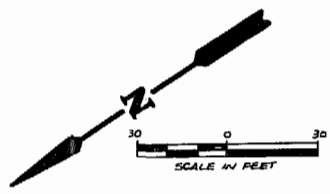

2" 1/2" TAPPING SADDLE
20" OF 8" STEEL CASING BY SADDLE JACK METHOD

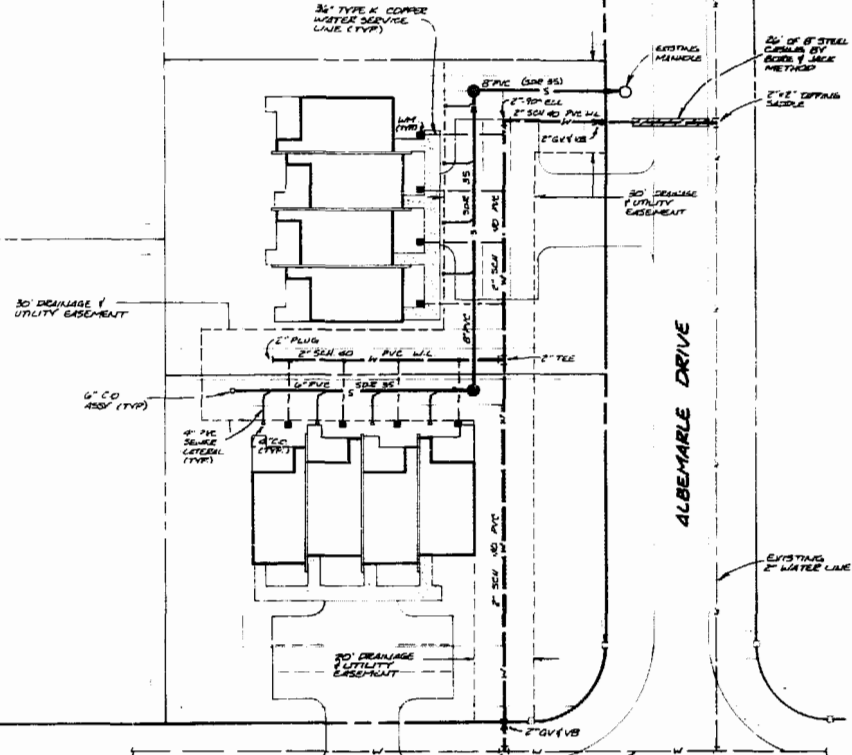
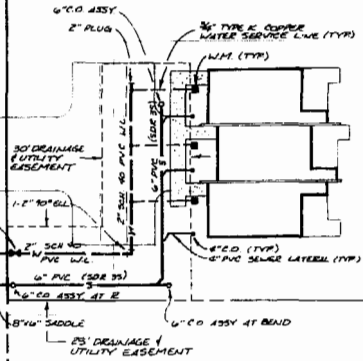

PLAN RECORDED IN
P.B. NO. 40 PAGE 98
Adrian Ward

NO.	DATE	REVISION / COMMENT / NOTE	BY



AES, a professional corporation
1761 Jamestown Road
Williamsburg, Virginia, 23185
804-253-0040
Engineering, Planning, Surveying



UTILITY PLAN
ALBEMARLE CONDOMINIUM
PREPARED FOR: JOSEPH S. TERRELL, INC.
JAMESTOWN DISTRICT JAMES CITY COUNTY VIRGINIA

Designed JNB	Drawn VMB
Scale 1" = 80'	Date FEB., 1988
Project No. 5853	Drawing No. 4