

For Ordinance No 128 to vacate certain Right of Way See 15B194 page 296 Recorded 5/29/79 State: Guillette C. Clifton, Clerk By: Dawn E. Martin, Replink

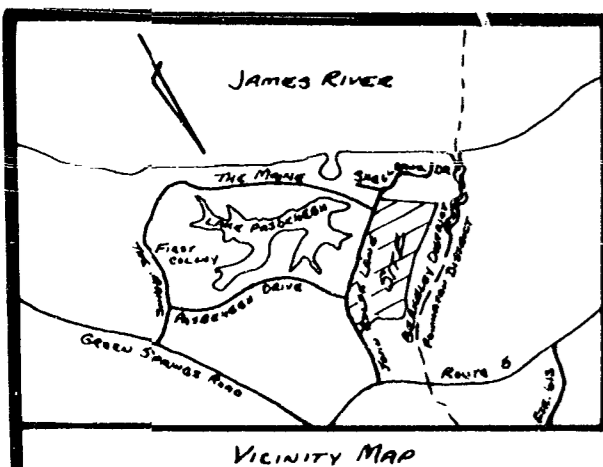

35 48

ASSOCIATION OF VIRGINIA STATE & RTE. 5

THIS SUBDIVISION IS WITH THE FREE CONSENT AND IN ACCORDANCE WITH THE DESIRES OF THE UNDERSIGNED OWNERS AND PROPRIETORS.

Henry H. Slatt, A NOTARY PUBLIC IN AND FOR THE STATE OF VIRGINIA, DO HEREBY CERTIFY THAT THE ABOVE NAMED PERSONS WHOSE NAMES ARE SIGNED TO THE FOREGOING WRITING HAVE ACKNOWLEDGED THE SAME BEFORE ME IN MY OFFICE AND STATE AFORESAID, GIVEN UNDER MY HAND THIS 11 DAY OF October 1978

MY COMMISSION EXPIRES 11-23-98

THIS SUBDIVISION IS APPROVED BY THE UNDERSIGNED IN ACCORDANCE WITH EXISTING SUBDIVISION REGULATIONS AND MAY BE COMMITTED TO RECORD.

10-17-78 Date Henry H. Slatt Agent or Representative of Governing Body

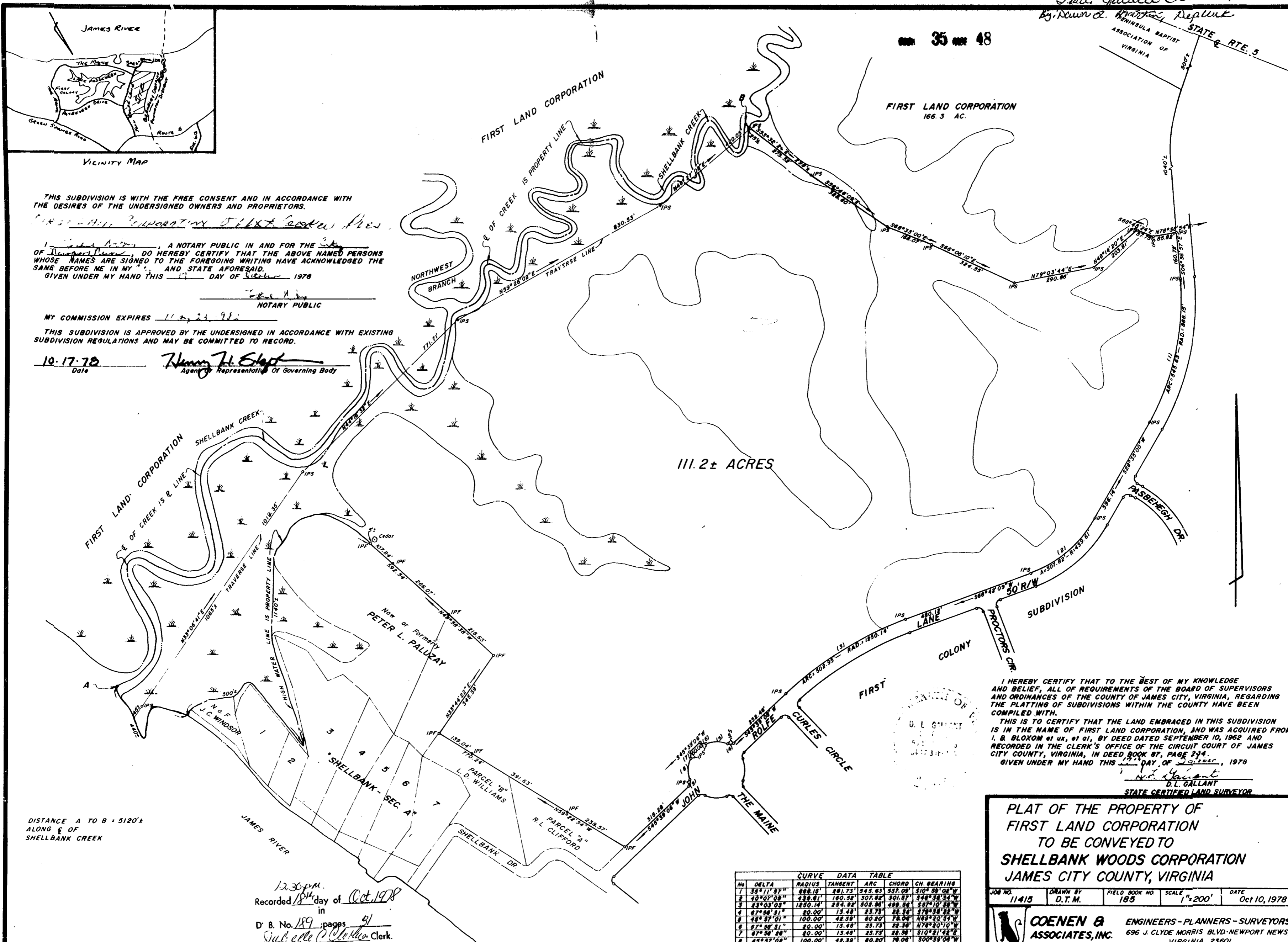

I HEREBY CERTIFY THAT TO THE BEST OF MY KNOWLEDGE AND BELIEF, ALL OF REQUIREMENTS OF THE BOARD OF SUPERVISORS AND ORDINANCES OF THE COUNTY OF JAMES CITY, VIRGINIA, REGARDING THE PLATTING OF SUBDIVISIONS WITHIN THE COUNTY HAVE BEEN COMPILED WITH. THIS IS TO CERTIFY THAT THE LAND EMBRACED IN THIS SUBDIVISION IS IN THE NAME OF FIRST LAND CORPORATION, AND WAS ACQUIRED FROM I. B. BLOXOM et ux, et al, BY DEED DATED SEPTEMBER 10, 1962 AND RECORDED IN THE CLERK'S OFFICE OF THE CIRCUIT COURT OF JAMES CITY COUNTY, VIRGINIA, IN DEED BOOK 87, PAGE 234. GIVEN UNDER MY HAND THIS 11 DAY OF October, 1978

D.L. Gallant STATE CERTIFIED LAND SURVEYOR

PLAT OF THE PROPERTY OF FIRST LAND CORPORATION TO BE CONVEYED TO SHELLBANK WOODS CORPORATION JAMES CITY COUNTY, VIRGINIA

No	DELTA	RADIUS	TANGENT	ARC	CHORD	CH. BEARING
1	38°11'37"	88.18	281.73	545.63	537.08	310°58'08"W
2	40°03'03"	433.81	180.58	307.82	301.67	348°38'34"W
3	23°03'03"	1250.14	254.52	502.84	489.86	337°10'30"W
4	67°58'31"	20.00	13.48	23.73	22.36	378°38'22"W
5	48°37'01"	100.00	48.39	80.20	78.04	189°20'34"W
6	67°58'31"	20.00	13.48	23.73	22.36	178°20'10"W
7	67°58'31"	20.00	13.48	23.73	22.36	310°21'48"E
8	48°37'02"	100.00	48.39	80.20	78.04	300°39'08"W
9	67°58'31"	20.00	13.48	23.73	22.36	311°38'34"W

12:30 p.m.
Recorded 18 day of Oct 1978
in
D. B. No. 189 pages 51
Guillette C. Clifton Clerk.

