

Multiple tables of CURVE DATA with columns for stationing, curve length, and other survey parameters.

CENTERLINES AND BOUNDARIES table with columns for stationing and boundary descriptions.

LISTS table with columns for stationing and list items.

Multiple tables of CURVE DATA located at the bottom left of the page.

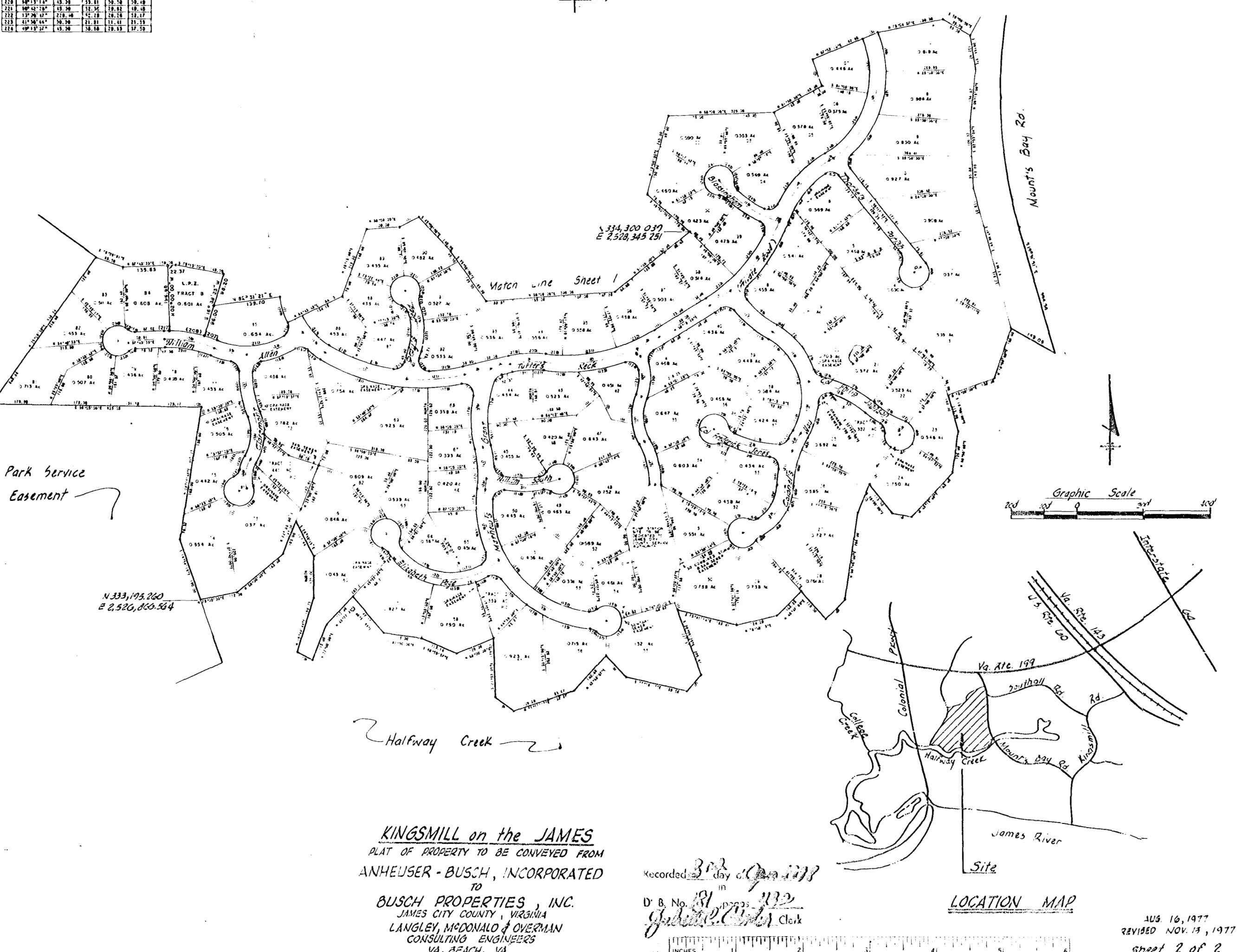

KINGSMILL on the JAMES
PLAT OF PROPERTY TO BE CONVEYED FROM
ANHEUSER-BUSCH, INCORPORATED
TO
BUSCH PROPERTIES, INC.
JAMES CITY COUNTY, VIRGINIA
LANGLEY, McDONALD & OVERMAN
CONSULTING ENGINEERS
VA. BEACH, VA.

Recorded 31st day of Oct 1977
in
D. B. No. 181
G. B. No. 1132
Gibson, Clerk

LOCATION MAP

AUG 16, 1977
REVISED NOV. 13, 1977
Sheet 2 of 2

