

This Subdivision of Property of Anheuser-Busch, Inc., James City County, Virginia, as the same appears on this plat is with free consent and in accordance with the desires of the undersigned Owner.

ANHEUSER-BUSCH, INCORPORATED

By Richard A. Schwartz V.P.

Attest: Richard A. Schwartz Vice Secretary

State of MISSOURI To wit: City of ST. LOUIS

I, Vivian M. Topolaki, a Notary Public in and for the City and State aforesaid, do hereby certify that Jean L. Hayward and RICHARD A. SCHWARTZ whose names are signed to the foregoing writing bearing date on this 26 day of Feb, 1976 have acknowledged the same before me in my City and State aforesaid.

Given unto my hand this 26 day of MARCH, 1976
Vivian M. Topolaki
Notary Public

I certify that this plat and subdivision was made by me at the direction of the owner, and that the subdivision is entirely within the boundaries of land covered by Plats duly of record in the Clerk's Office of the Circuit Court of James City County in Plat Book 27, Pg. 33-36. This subdivision as it appears on this plat conforms to the applicable regulations relating to the subdivision of land.

LANGLEY, McDONALD & OVERMAN

By George E. Langley

CERTIFICATE of APPROVAL

This subdivision approved by the undersigned in accordance with existing subdivision regulations and may be committed to record.

Date: 3/31/76 Craig A. Overman Agent of Governing Body

STATE of VIRGINIA, COUNTY of JAMES CITY

In the Clerk's Office of the Circuit Court of the county of James City this 10 day of April, 1976. The map shown hereon was presented and admitted to the record as the law directs.

Teste: Judith C. Clavilier, Clerk
Plat Book 33, Page 51 & 52

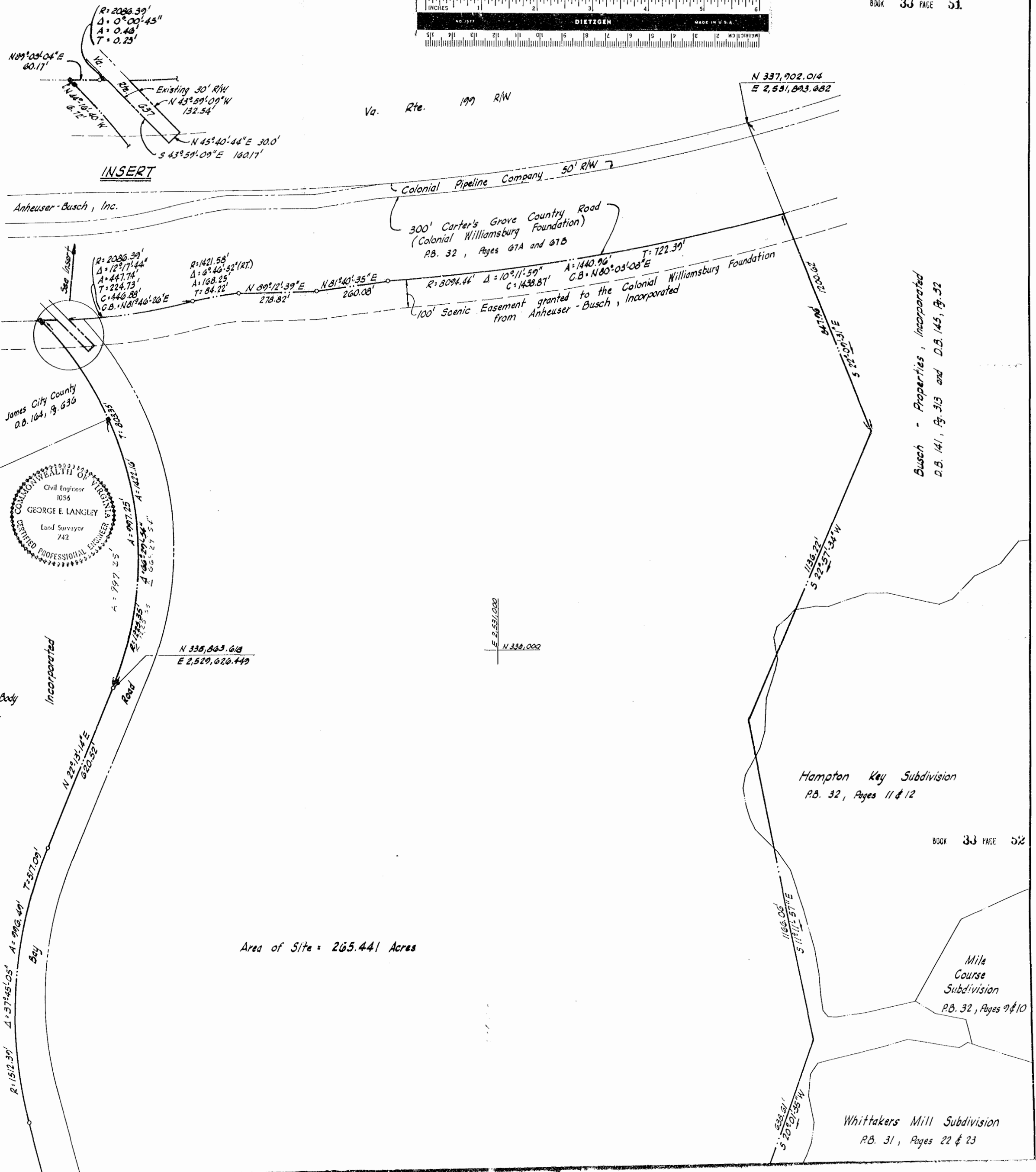

Area of Site = 265.441 Acres

Hampton Key Subdivision
P.B. 32, Pages 11 & 12

Mile Course Subdivision
P.B. 32, Pages 9 & 10

Whittakers Mill Subdivision
P.B. 31, Pages 22 & 23