

See Ordinance To Vacate Easement  
 Section IV lot 91 Sec IV  
 Kristiansand DB 181 page 190  
 Recorded 1/9/78

BOOK 32 PAGE 69

SECTION V

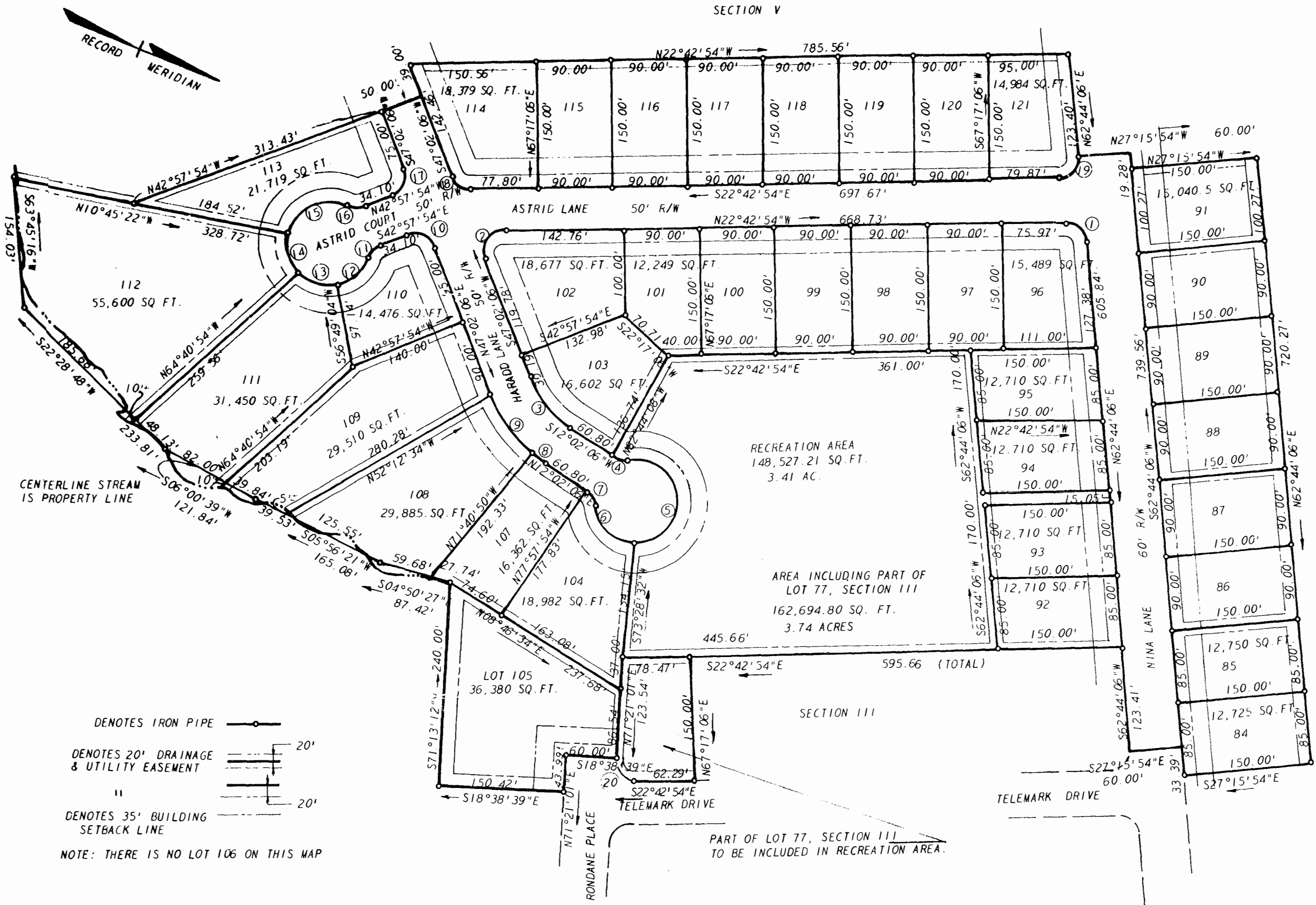

SUBDIVISION CERTIFICATE:  
 THIS SUBDIVISION OF LAND AS SHOWN ON THIS PLAT IS WITH THE FREE CONSENT AND IN ACCORDANCE WITH THE DESIRES OF THE UNDERSIGNED OWNERS.

*Jack L. Massie*  
 JACK L. MASSIE, PRESIDENT, KRISTIANSAND, LTD.  
 A VIRGINIA CORPORATION

STATE OF VIRGINIA  
 CITY/COUNTY OF Williamsburg TO WIT

I, Virginia M. Massie, A NOTARY PUBLIC IN AND FOR THE CITY/COUNTY AND STATE AFORESAID DO HEREBY CERTIFY THAT THOSE NAMES ARE SIGNED TO THE FOREGOING WRITING HAVE ACKNOWLEDGED THE SAME BEFORE ME IN CITY/COUNTY AFORESAID. GIVEN UNDER MY HAND & SEAL THIS 6th DAY OF Nov. 1974. MY COMMISSION EXPIRES June 16, 1975

SOURCE OF TITLE  
 THE PROPERTY SHOWN ON THIS PLAT WAS CONVEYED BY JACK L. MASSIE AND VIRGINIA M. MASSIE, AND PHILLIP T. RUTLEDGE AND EFFIE RUTLEDGE, TO KRISTIANSAND LTD., A VIRGINIA CORPORATION, IN THE CIRCUIT COURT OF JAMES CITY COUNTY, AND RECORDED IN DEED BOOK 140, PAGE 260.

CERTIFICATE OF APPROVAL  
 THIS SUBDIVISION AS SHOWN ON THIS PLAT IS APPROVED BY THE UNDERSIGNED IN ACCORDANCE WITH SUBDIVISION REGULATIONS AND MAY BE COMMITTED TO RECORD.  
*Chas. H. Covey* 2-19-75  
 AGENT OF GOVERNING BODY DATE  
*R.D. Ginter* 11-25-74  
 HIGHWAY DEPARTMENT DATE  
*Edward B. Goff* 10-31-74  
 HEALTH DEPARTMENT DATE

STATE OF VIRGINIA, COUNTY OF JAMES CITY:  
 IN THE CLERK'S OFFICE OF THE CIRCUIT COURT FOR THE COUNTY OF JAMES CITY, THE MAP SHOWN HEREON WAS PRESENTED AND ADMITTED TO RECORD AS THE LAW DIRECTS

TESTE: *Sublette C. Collier*  
 DATE: 7/22/75  
 PLAT BOOK 32 PAGE 69

SURVEYOR'S CERTIFICATE:  
 TO THE BEST OF MY KNOWLEDGE AND BELIEF ALL OF THE REQUIREMENTS SET FORTH IN THE ORDINANCE FOR APPROVING PLATS OF SUBDIVISION FOR RECORDATION IN JAMES CITY COUNTY, VIRGINIA, HAVE BEEN COMPLIED WITH.  
*B.D. Littlepage*  
 B.D. LITTLEPAGE, CERTIFIED LAND SURVEYOR

DENOTES IRON PIPE  
 DENOTES 20' DRAINAGE & UTILITY EASEMENT  
 DENOTES 35' BUILDING SETBACK LINE  
 NOTE: THERE IS NO LOT 106 ON THIS MAP

NOTE: LOTS ARE 13,500 SQ. FT. UNLESS OTHERWISE NOTED

SECTION IV CURVE DATA

NO.	DELTA	RADIUS	LENGTH	TANGENT	CHORD	CHORD BRG.
1	85°27'00"	25.00'	37.28'	23.09'	33.92'	N20°00'36"E
2	110°15'00"	25.00'	48.11'	35.87'	41.02'	N77°50'24"W
3	35°00'00"	125.00'	76.36'	39.41'	75.18'	S29°32'06"W
4	48°11'23"	25.00'	21.03'	11.18'	20.41'	S12°03'35"E
5	199°37'48"	50.00'	174.21'	282.02'	98.54'	S63°39'38"W
6	76°44'58"	50.00'	66.98'	39.52'	62.08'	N21°51'01"E
7	48°11'23"	25.00'	21.03'	11.18'	20.41'	N36°07'48"E
8	06°17'04"	175.00'	19.20'	9.61'	19.19'	N15°10'36"E
9	28°42'56"	175.00'	87.71'	44.90'	86.79'	N32°40'38"E
10	90°00'00"	25.00'	39.27'	25.00'	35.36'	N02°02'06"E
11	48°11'23"	25.00'	21.03'	11.18'	20.41'	S67°03'36"E
12	57°58'21"	50.00'	50.59'	27.70'	48.46'	N62°10'06"W
13	58°30'02"	50.00'	51.05'	28.00'	48.86'	N03°55'54"W
14	53°55'32"	50.00'	47.06'	25.44'	45.34'	N52°16'23"E
15	105°58'51"	50.00'	92.49'	66.33'	72.85'	S47°45'47"E
16	48°11'23"	25.00'	21.03'	11.18'	20.41'	S18°52'13"E
17	90°00'00"	25.00'	39.27'	25.00'	35.36'	S87°59'54"E
18	62°45'00"	25.00'	30.43'	17.42'	28.59'	S12°09'36"W
19	94°33'00"	25.00'	41.26'	27.07'	36.73'	S69°59'24"E
20	24°03'55"	25.00'	41.26'	26.84'	36.59'	S24°19'03"W

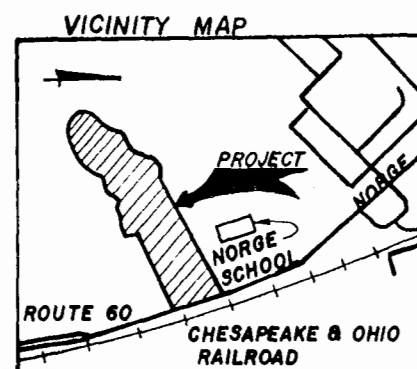

L. V. WOODSON & ASSOCIATES INC.  
 ENGINEERS, SURVEYORS & PLANNERS  
 P. O. BOX 633 WILLIAMSBURG, VIRGINIA 23185

**KRISTIANSAND SECTION IV**  
 POWHATAN DISTRICT  
 JAMES CITY COUNTY, VIRGINIA

SCALE: 1" = 100'  
 DATE: JULY 22, 1974  
 DWG. 802-8