

See DB 133 Page 637
Recorded 11/11/71

R. H. JONES

B. CUMBER

P. MURRAY

C. DEAN

J. DEAN

C. SLAUGHTER

T.M. BURTON

M. A. SCOTT

LINE DATA			
MARKER	CORNER	DISTANCE	BEARING
Pipe	A	100.00	N 10° 11' 30" E
"	B	89.82	S 77° 57' 15" E
"	C	378.36	S 87° 39' 45" E
"	D	176.85	S 81° 45' 30" E
"	E	162.36	S 03° 23' 45" W
"	F	196.05	S 13° 37' 15" E
"	G	159.82	S 07° 51' 00" W
"	H	308.21	S 10° 03' 15" E
"	I	406.42	S 05° 19' 15" E
"	J	231.03	S 11° 32' 45" E
"	K	142.94	S 79° 24' 45" W
"	L	119.58	S 72° 17' 45" W
"	M	119.54	S 21° 27' 45" W
"	N	400.00	N 81° 28' 30" W
"	O	312.17	N 78° 05' 30" W
"	P	530.13	N 00° 45' 00" W
"	Q	609.89	N 00° 45' 00" W
"	R	300.58	N 06° 00' 00" W
"	S	222.00	N 88° 29' 10" E

NOTE: Iron pipes at all corners.
Bearings are clockwise.
Reference: D.B. #12, p. #230.

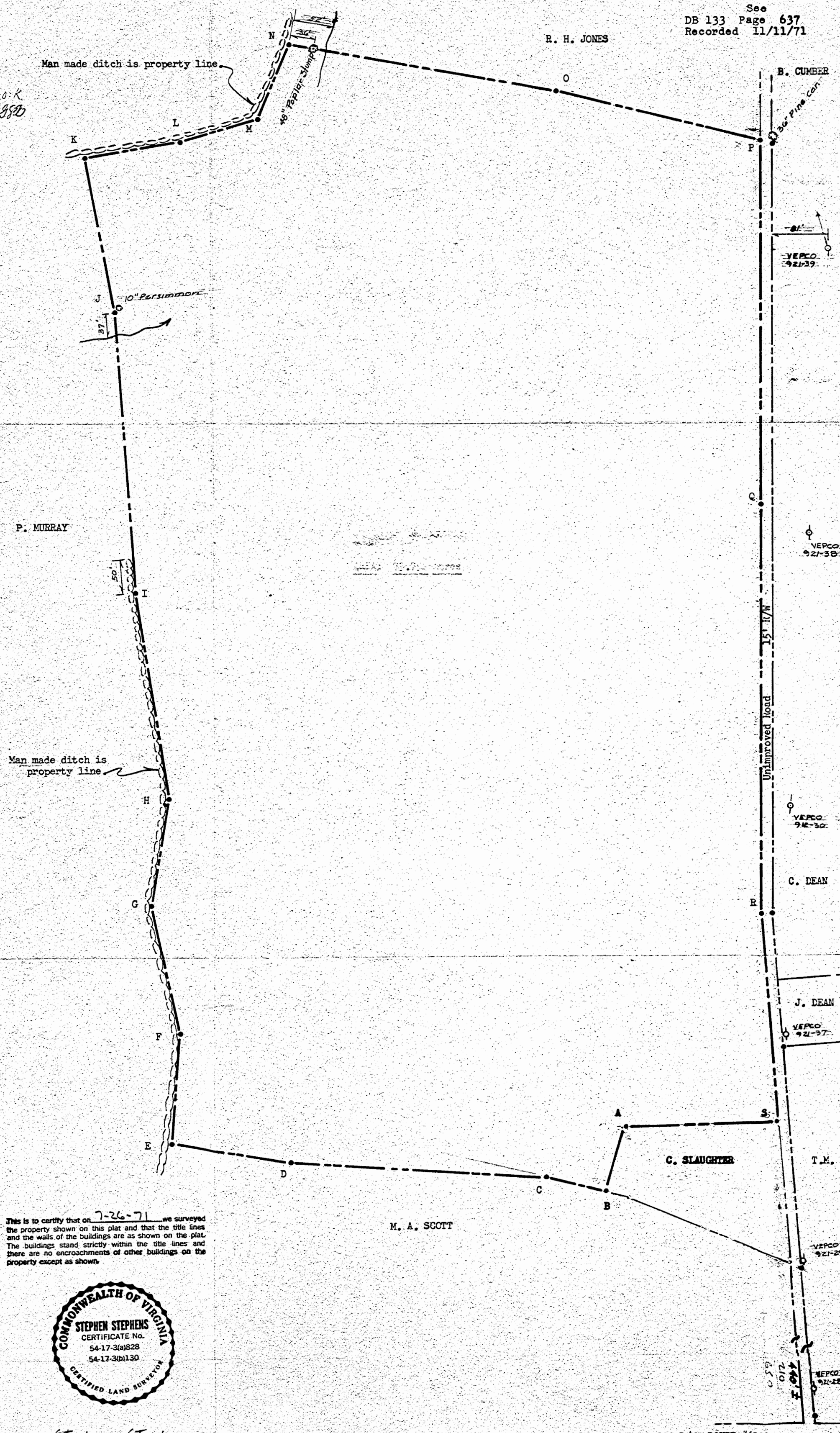

This is to certify that on 7-26-71 we surveyed the property shown on this plat and that the title lines and the walls of the buildings are as shown on the plat. The buildings stand strictly within the title lines and there are no encroachments of other buildings on the property except as shown.



Stephen Stephens
STEPHEN STEPHENS
CERTIFIED LAND SURVEYOR

PHONE CA 9-5462 WILLIAMSBURG, VA.

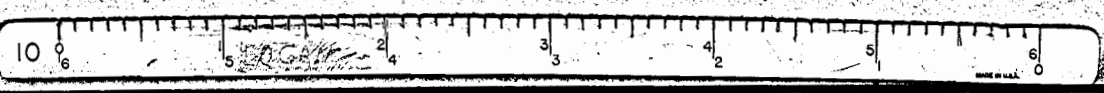

NOTE: Iron pipes at all corners, except as noted. Bearings are clockwise.
Ref.: D.B. #12, p. #230
AREA: 32.909 Acres.

PLAT of:
That part of:
PINWOOD TRACT
Property of:
JOHN W. CHANDLER, Estate,
To Property of:
JAMES B. PARRELL
Scale: 1" = 100'
July 1973
POWHATAN DISTRICT, JAMES CITY COUNTY, VIRGINIA