

Recorded 9/29/70
 See
 DB 128 Pages 214 & 216

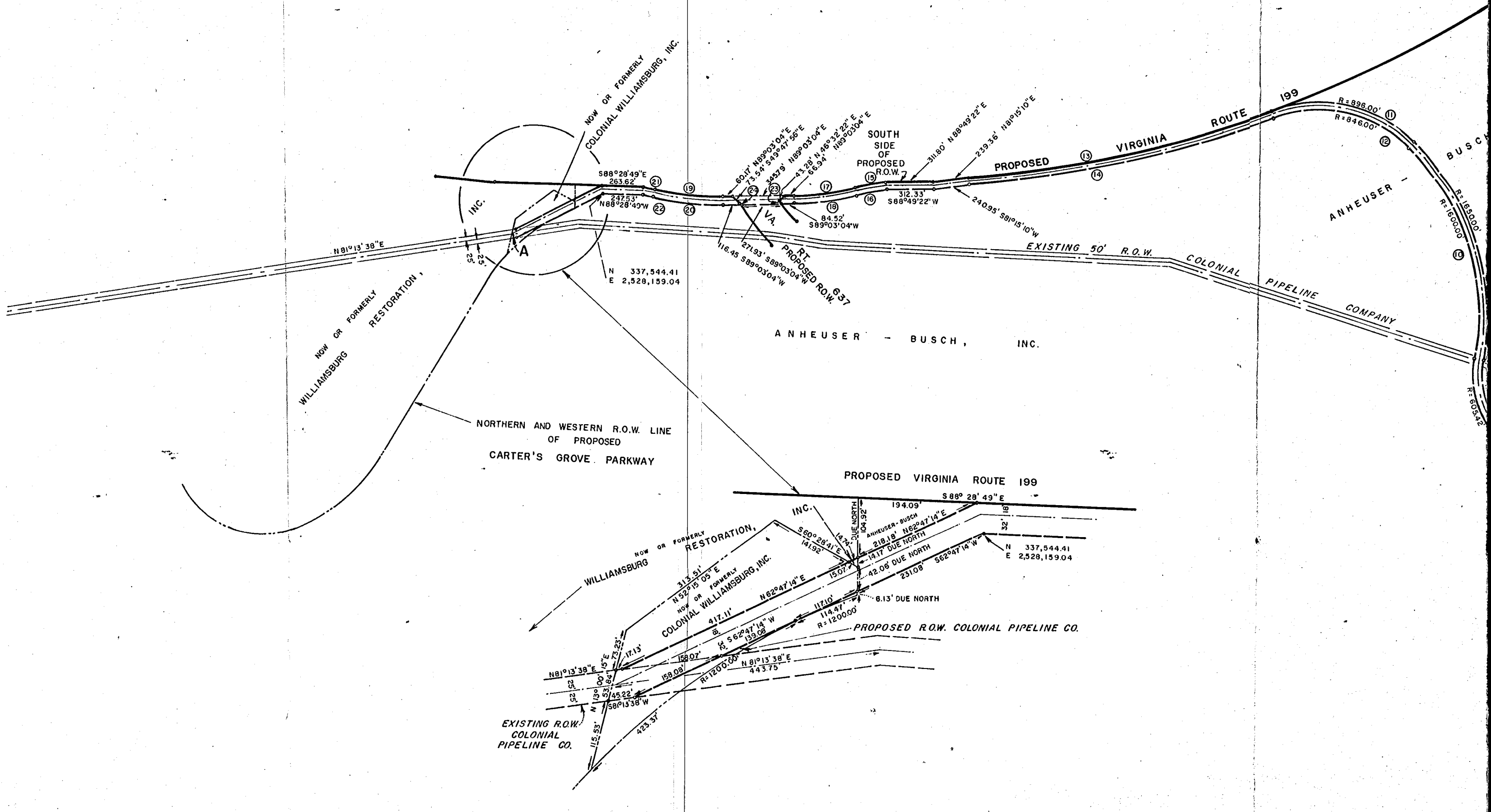

TOTAL LENGTH OF PIPELINE FROM A TO B
 ON CENTER LINE OF PIPE = 16,096.20' FEET

PART
 1.

AREA LEGEND

WILLIAMSBURG RESTORATION, INC.	0.002	ACRES
COLONIAL WILLIAMSBURG, INC.	0.39	ACRES
R.O.W. THROUGH VA. DEPT. HIGHWAYS AT VA. RT. 637	0.34	ACRES
CAMP WALLACE	0.12	ACRES
ANHEUSER-BUSCH, INC.	17.45	ACRES

