

Recorded 1/5/70
See
DB 124 Page 679

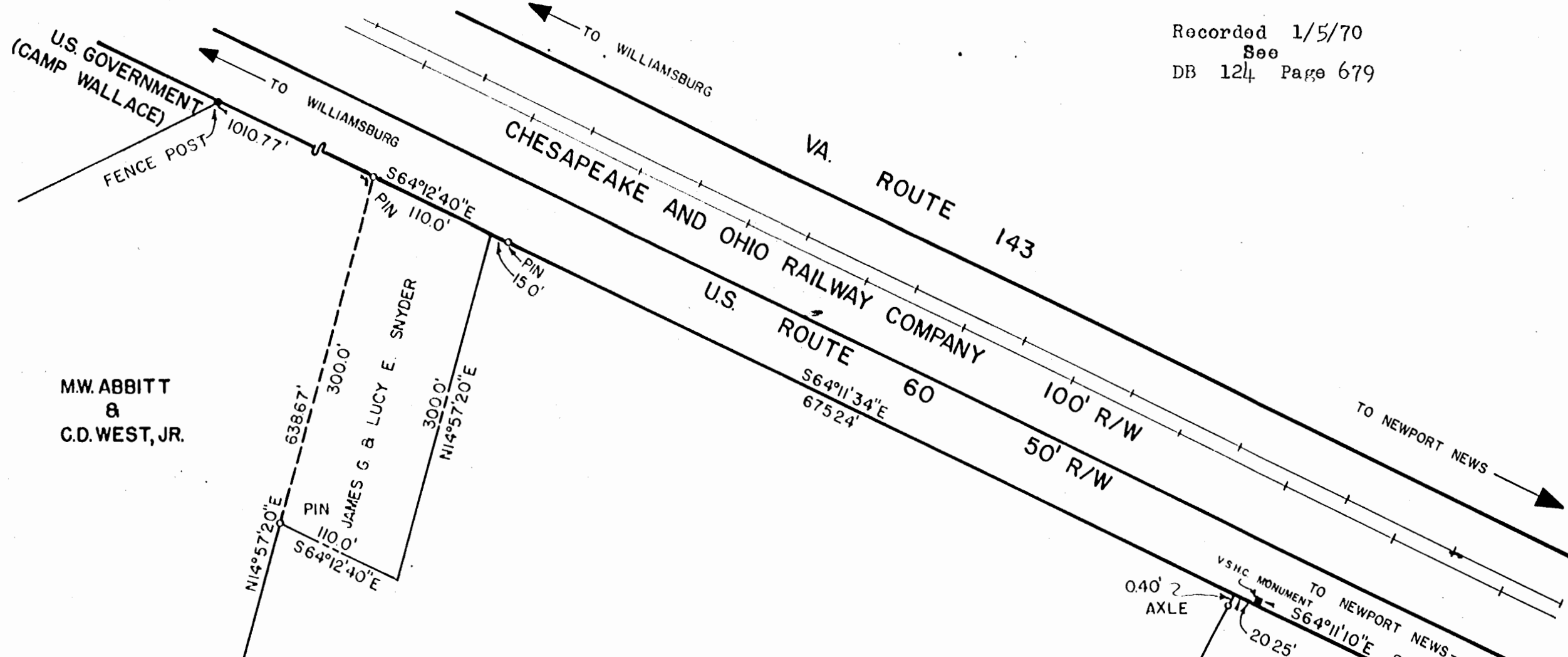

M.W. ABBITT
&
C.D. WEST, JR.

AREA = 10.059 Acres

M.W. ABBITT
&
C.D. WEST, JR.

NOTE
APPROXIMATELY 24 GRAVES
ARE LOCATED IN THIS AREA
BY FIELD MEASUREMENT (NO
FENCING.)



M.W. ABBITT
&
C.D. WEST, JR.

PLAT OF PROPERTY OF
W. AUBREY AND VIRGINIA SKILLMAN
JAMESTOWN DISTRICT
JAMES CITY COUNTY, VIRGINIA
TO BE CONVEYED TO
ANHEUSER-BUSCH, INC.

SCALE: 1" = 100' NOVEMBER 17, 1969

BALDWIN AND GREGG
ENGINEERS • SURVEYORS • PLANNERS
NORFOLK, VIRGINIA