

Recorded 9/13/68  
 see  
 D.B. 43, p. 308

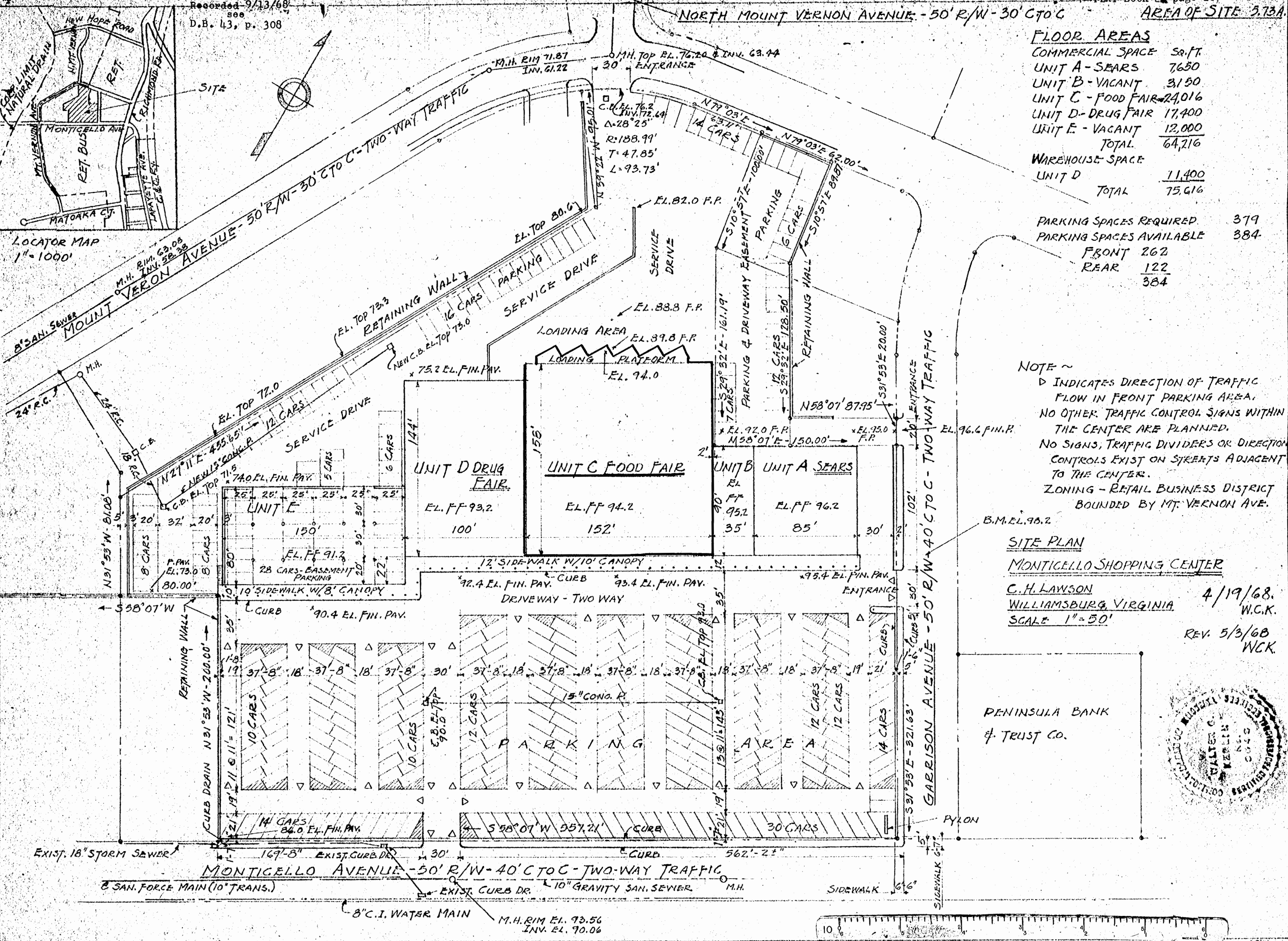
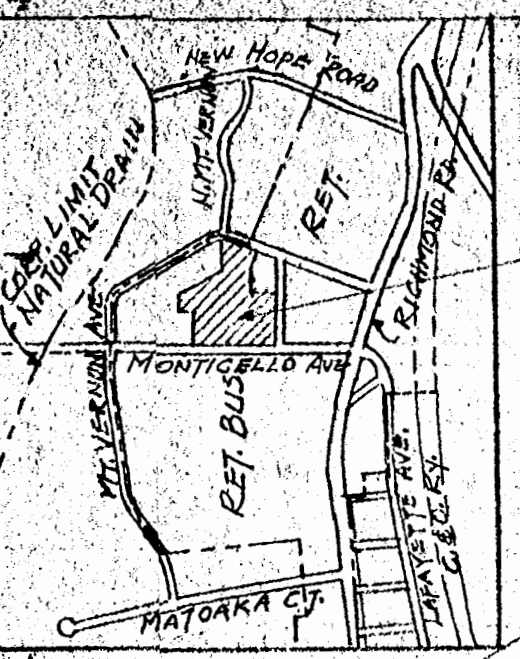

**FLOOR AREAS**

COMMERCIAL SPACE	Sq. Ft.
UNIT A - SEARS	7650
UNIT B - VACANT	3150
UNIT C - FOOD FAIR	24,016
UNIT D - DRUG FAIR	17,400
UNIT E - VACANT	12,000
<b>TOTAL</b>	<b>64,216</b>
WAREHOUSE SPACE	
UNIT D	11,400
<b>TOTAL</b>	<b>75,616</b>

**PARKING SPACES REQUIRED** 379  
**PARKING SPACES AVAILABLE** 384

FRONT	262
REAR	122
<b>TOTAL</b>	<b>384</b>

**NOTE ~**  
 D INDICATES DIRECTION OF TRAFFIC FLOW IN FRONT PARKING AREA. NO OTHER TRAFFIC CONTROL SIGNS WITHIN THE CENTER ARE PLANNED. NO SIGNS, TRAFFIC DIVIDERS OR DIRECTION CONTROLS EXIST ON STREETS ADJACENT TO THE CENTER. ZONING - RETAIL BUSINESS DISTRICT BOUNDED BY MT. VERNON AVE.

**SITE PLAN**  
**MONTICELLO SHOPPING CENTER**  
 C.H. LAWSON  
 WILLIAMSBURG, VIRGINIA  
 SCALE 1" = 50'

4/19/68  
 W.C.K.  
 REV. 5/3/68  
 WCK

PENINSULA BANK  
 & TRUST CO.

