

DR. GEORGE SOUTHEY HANKINS

DR. GEORGE SOUTHEY HANKINS

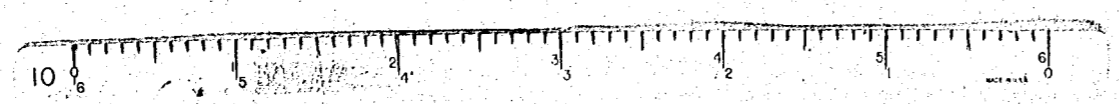
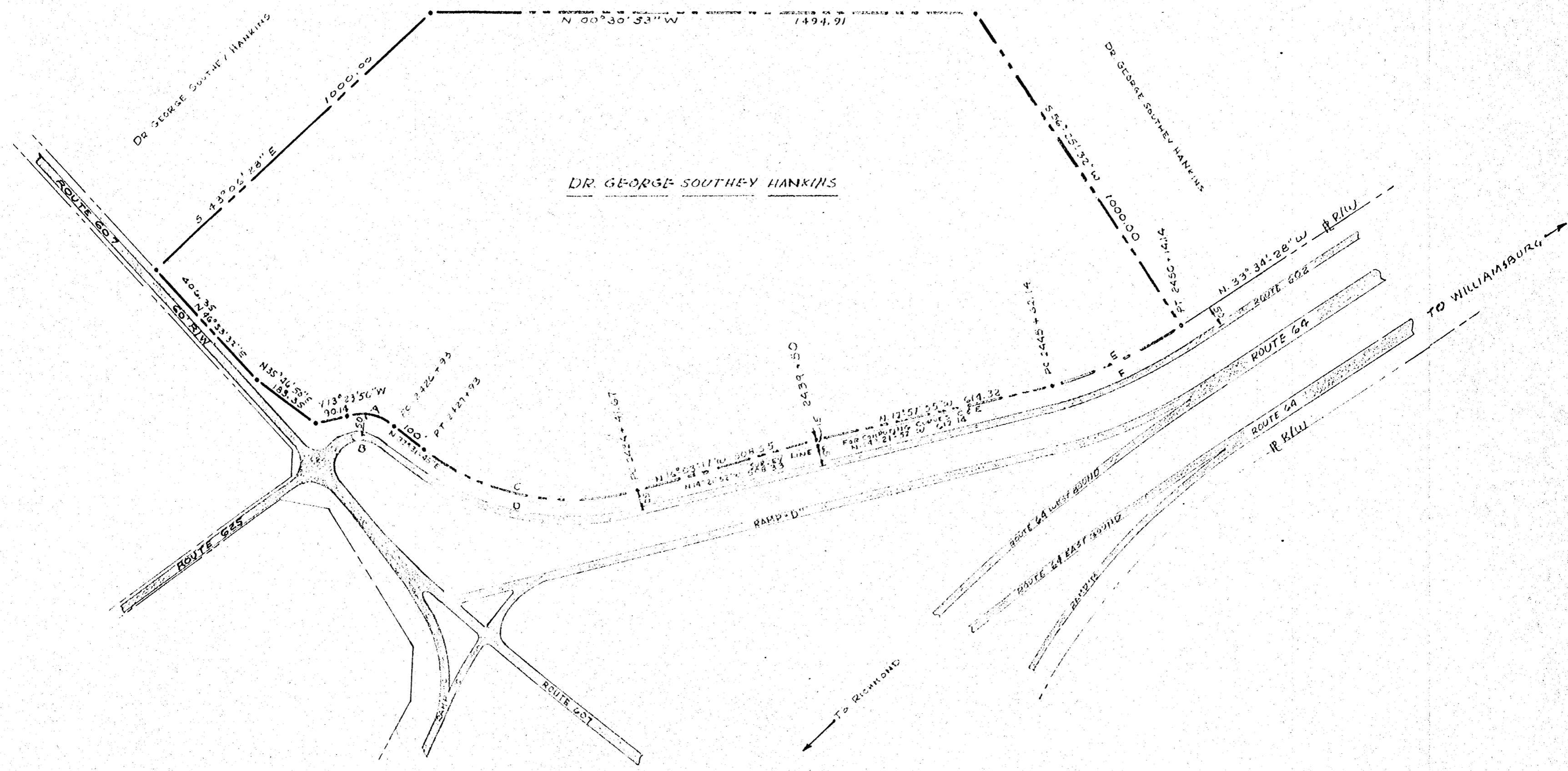

CURVE DATA

NO.	R	L	Δ	Γ	C	CB
A	150.00	133.33	50° 55' 41"	11.43	128.78	N 7° 03' 57" E
B	100.00	147.12	84° 17' 29" RL	90.50	134.20	N 04° 37' 00" W
C	666.20	603.39	51° 53' 37"	324.16	582.97	N 11° 34' 57" E
D	716.20	648.67	51° 53' 37"	348.47	626.13	N 11° 34' 57" E
E	1278.14	435.24	19° 12' 36"	219.68	433.20	N 23° 58' 10" W
F	1348.14	452.00	19° 12' 36"	228.14	449.87	N 23° 58' 10" W

NOTES: Iron Pipes At All Corners
BEARINGS ARE ALL CLOCKWISE
REF: D.B. 1187 p 367
VDH PLAN INT. 64
PROJ. 0064 DAT-101 R/W 202 SHEET 9, 9b & 10
THESE PLANS ARE UNFINISHED AND
ARE NOT TO BE USED FOR ANY TYPE
OF CONSTRUCTION.
AREA: 58,701 ACRES

Stephen Stephens
STEPHEN STEPHENS
CERTIFIED LAND SURVEYOR, #028 & #130
113 WINSTON DR.
ELKHORN, VA 22424 - WILLIAMSBURG, VA.

PLAT OF:
THAT PART OF:
"MOSS SIDE"
PROPERTY OF:
DR. GEORGE SOUTHEY HANKINS
SCALE: 1" = 200'
SEPT 1967
STONEHOUSE DISTRICT, JAMES CITY COUNTY VIRGINIA