

PLAT OF A PORTION OF THE PROPERTY
FIRST LAND CORPORATION

JAMES CITY CO., VA.
Scale 1"=300' Dec. 8, 66
Revised Dec 28, 66

RECORDED 1/3/67
FIRST LAND CORPORATION

PARCELS A- containing 151.88 acres
B- containing 222.65 acres
C- containing 120.00 acres

E.E. PAINE,
consulting engineer
Newport News, Virginia

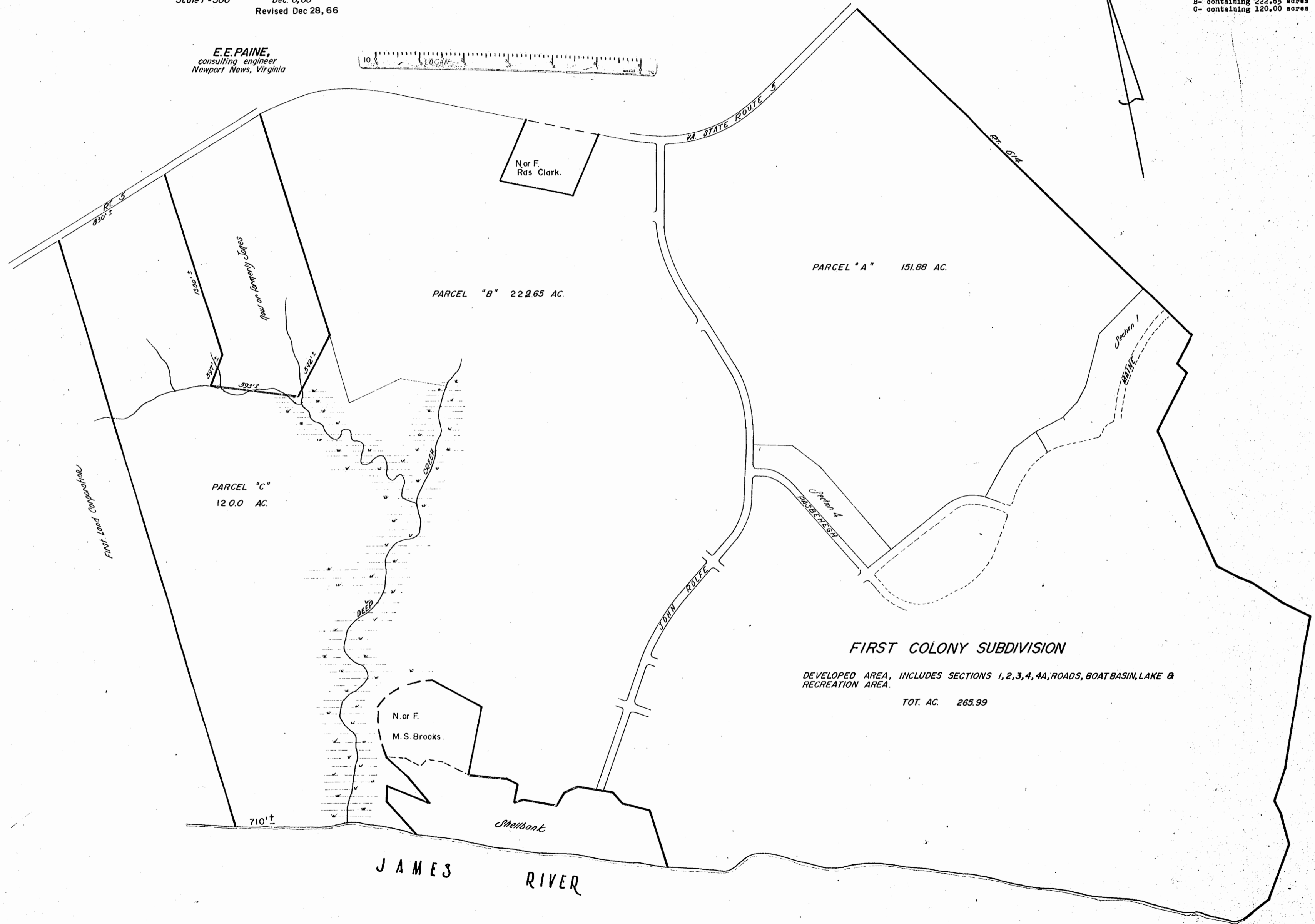

N. or F.
Rds Clark.

PARCEL "A" 151.88 AC.

PARCEL "B" 222.65 AC.

PARCEL "C"
120.0 AC.

FIRST COLONY SUBDIVISION

DEVELOPED AREA, INCLUDES SECTIONS 1,2,3,4,4A,ROADS,BOATBASIN,LAKE &
RECREATION AREA.

TOT. AC. 265.99

N. or F.
M. S. Brooks.

JAMES RIVER

First Land Corporation

710'

Shellbank