

Recorded Aug 26, 1964
in
D. B. 97 page 175.
Virginia Blanchard, Clerk

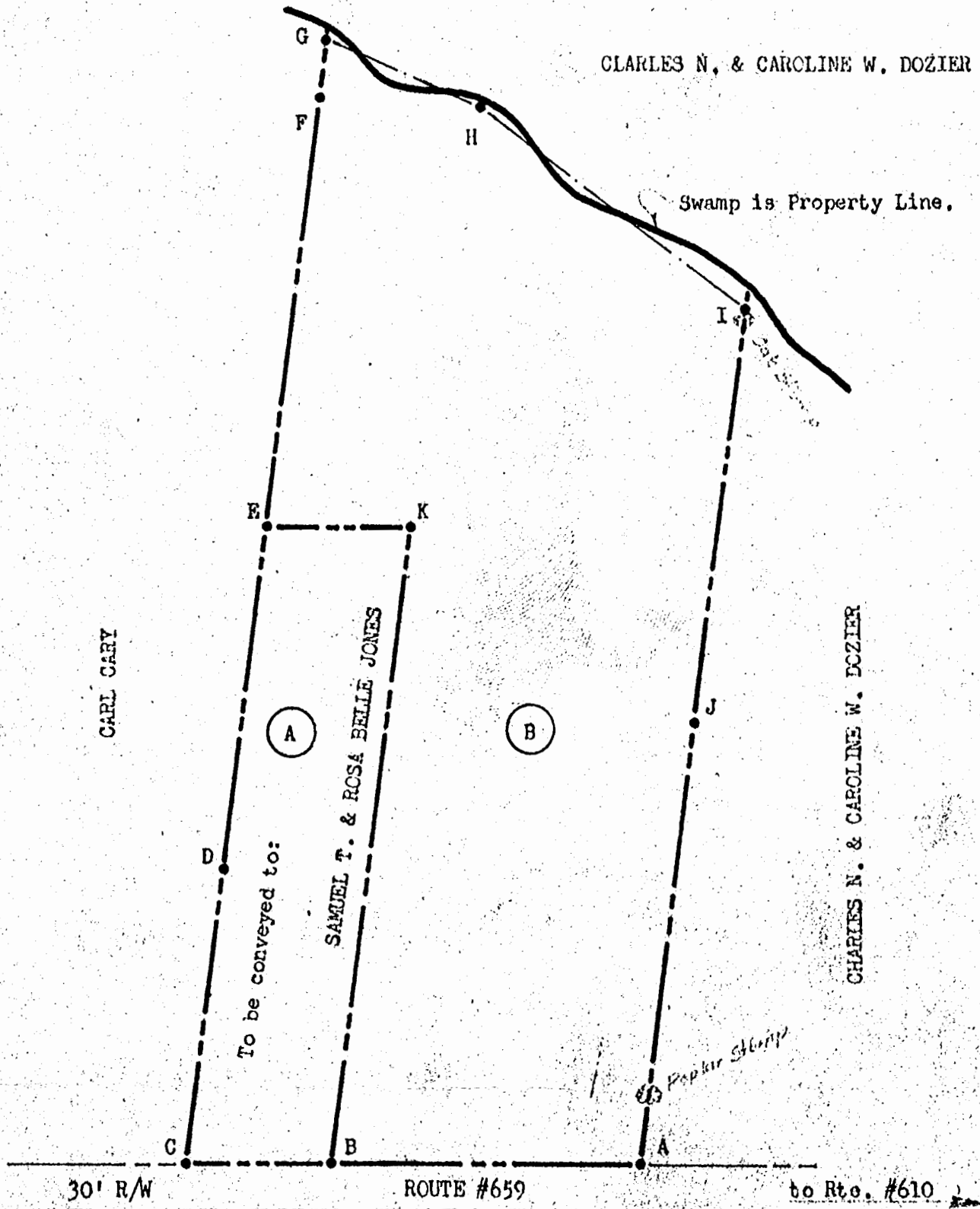
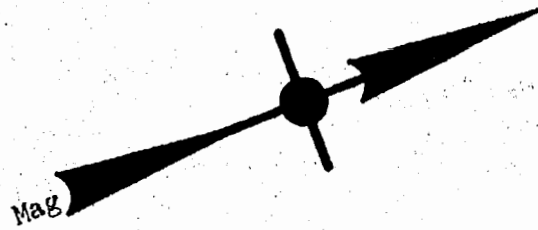

LINE DATA			
MARKER	CORNER	CHORD	BEARING
PIPE	A		
"	B	216.58	S 20° 15' 00" W
"	C	100.00	S 20° 15' 00" W
"	D	201.73	N 62° 47' 30" W
"	E	237.12	N 62° 47' 30" W
"	F	297.70	N 62° 47' 30" W
"	G	40.00	N 62° 47' 30" W
"	H	121.62	N 43° 30' 25" E
"	I	229.10	N 57° 39' 15" E
"	J	283.92	S 62° 47' 30" E
"	K	304.06	S 63° 47' 30" E
"	E	100.00	N 20° 15' 00" E
"	B	138.85	S 62° 47' 30" E

This is to certify that the property lines "G", "H", "I", "J", "A" as shown is as agreed upon by the undersigned adjoining land owners.

Charles N. Dozier
Charles N. Dozier
Caroline W. Dozier
Caroline W. Dozier
Floyd L. Cary
Floyd L. Cary
Henrietta Cary
Henrietta Cary

I, *B. L. Moody*, a Notary Public in and for the State of Virginia, city/county of *James City* do certify that the above named persons whose names are signed to the foregoing writing have acknowledged the same before me in State and city/county aforesaid.

Given under my hand this 26 day July 1963
My commission expires 5 day Jan 1966
B. L. Moody
Notary Public

Area of Parcel (A) = 1,000 Acre
Area of Parcel (B) = 4,000 Acres
Total Area = 5,000 Acres

STEPHEN STEPHENS
CERTIFIED LAND SURVEYOR
133 WINSTON DRIVE
PHONE: CA 9-5462 - WILLIAMSBURG, VA.

PLAT of Part of PEACHY PARK
Property of:
FLOYD L. & HENREITTA GARY
Scale: 1" = 100' June 1963
POWATAN DISTRICT, JAMES CITY COUNTY, VIRGINIA