

Note: All property owned by M. Leah Jones unless otherwise shown.

VIRGINIA ELECTRIC & POWER CO			
WILLIAMSBURG DISTRIBUTION			
PLAT TO ACCOMPANY RIGHT-OF-WAY AGREEMENT WITH			
AS SHOWN			
DISTRICT	COUNTY	STATE	
JAMESTOWN	JAMES CITY	VIRGINIA	
DRAWN BY		WMBG # 1561	

Recorded Aug. 22, 1940
in
D. B. 32 page
Va. Blanchard, Clerk

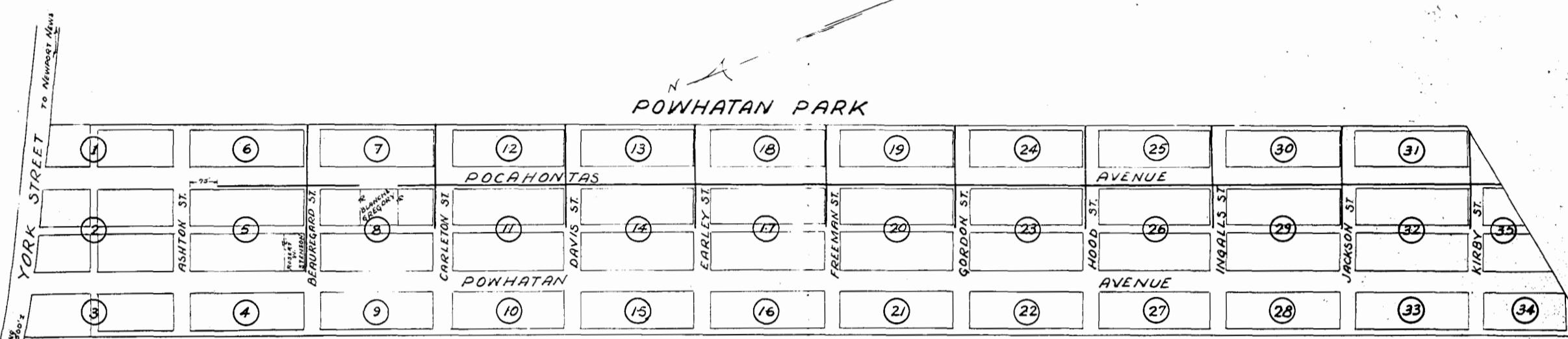

Note: All property owned by M. Leah Jones unless otherwise shown.

VIRGINIA ELECTRIC & POWER CO			
WILLIAMSBURG DISTRIBUTION			
PLAT TO ACCOMPANY RIGHT-OF-WAY AGREEMENT WITH			
AS SHOWN			
DISTRICT	COUNTY	STATE	
JAMESTOWN	JAMES CITY	VIRGINIA	
DRAWN BY		WMBG # 1561	

Recorded Aug. 22, 1940
in
D. B. 32 page
Va. Blanchard, Clerk

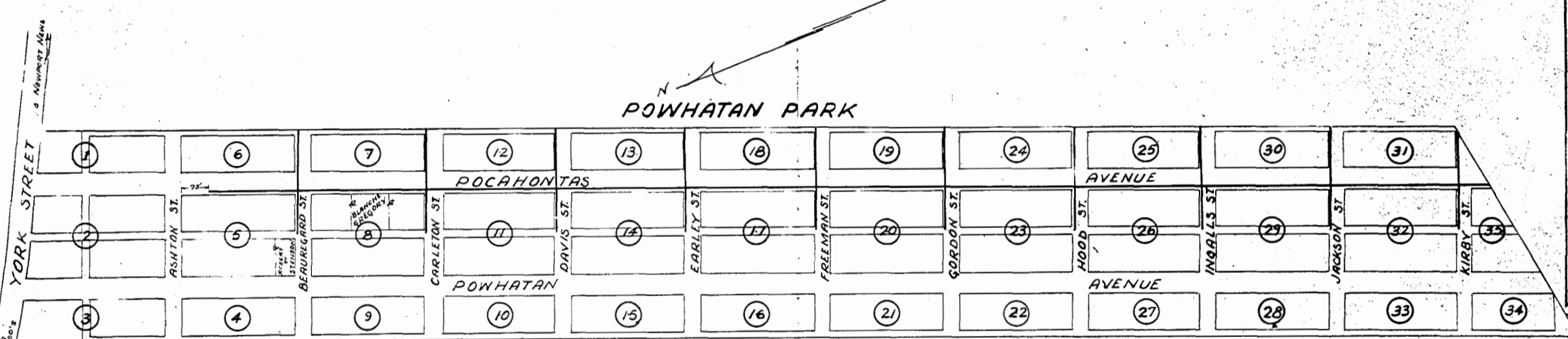

Note: All property owned by M. Leah Jones unless otherwise shown.

VIRGINIA ELECTRIC & POWER CO			
WILLIAMSBURG DISTRIBUTION			
PLAT TO ACCOMPANY RIGHT-OF-WAY AGREEMENT WITH			
AS SHOWN			
DISTRICT	COUNTY	STATE	
JAMESTOWN	JAMES CITY	VIRGINIA	
DRAWN BY		WMBG # 1561	

Recorded Aug. 22, 1940
in
D. B. 32 page
Va. Blanchard, Clerk

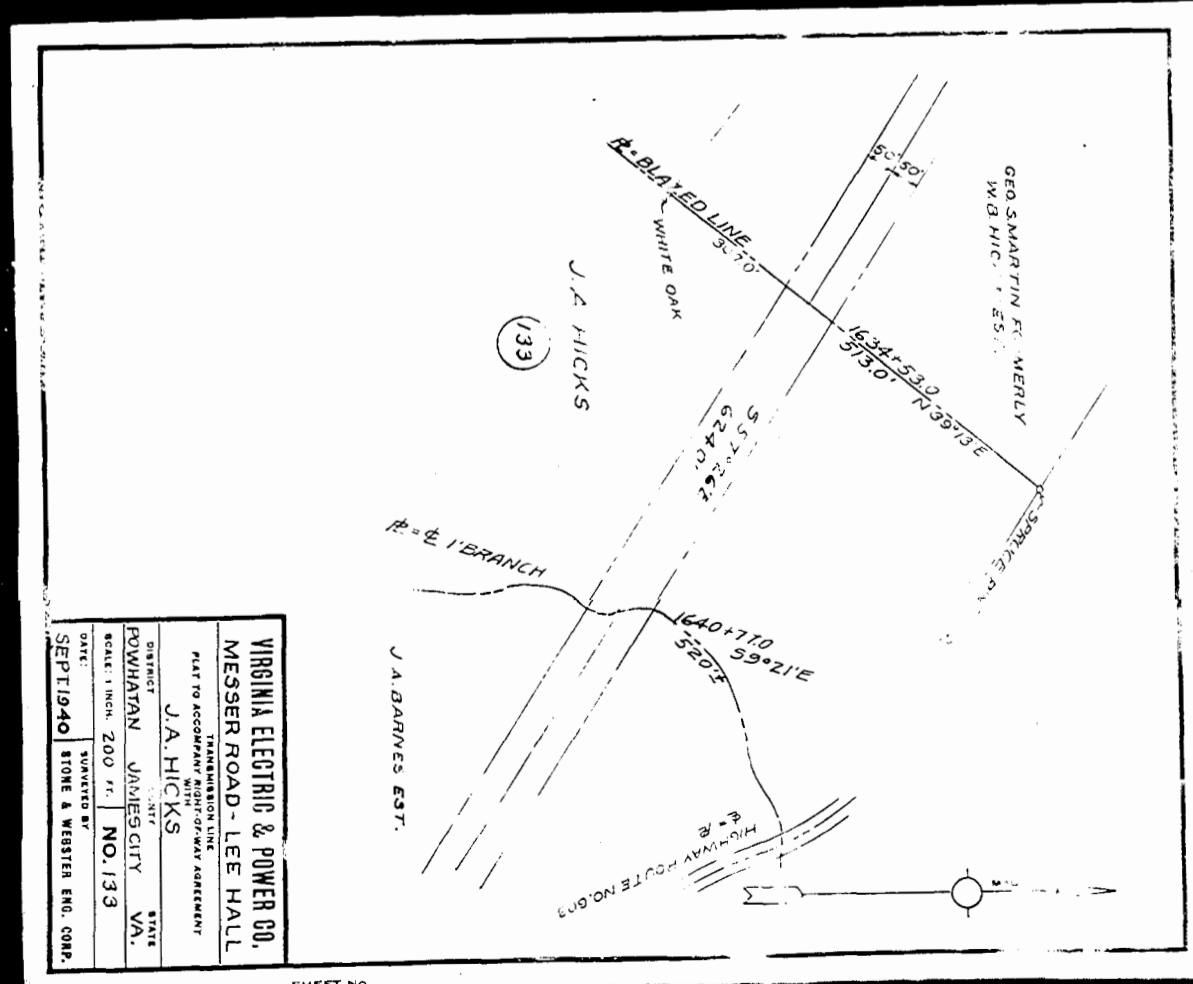

DRAWER NO.		SHEET NO.	
VIRGINIA ELECTRIC & POWER CO.			
MESSER ROAD - LEE HALL			
DRAWN BY J.A. HICKS			
DATE: SEPT 1940			
SCALE: 1 INCH = 200 FT.			
DRAWN BY: J.A. HICKS			
STATE: VA.			
CITY: JAMES CITY			
NO. 133			
DRAWN BY: STONE & WESSLER ENG. CORP.			

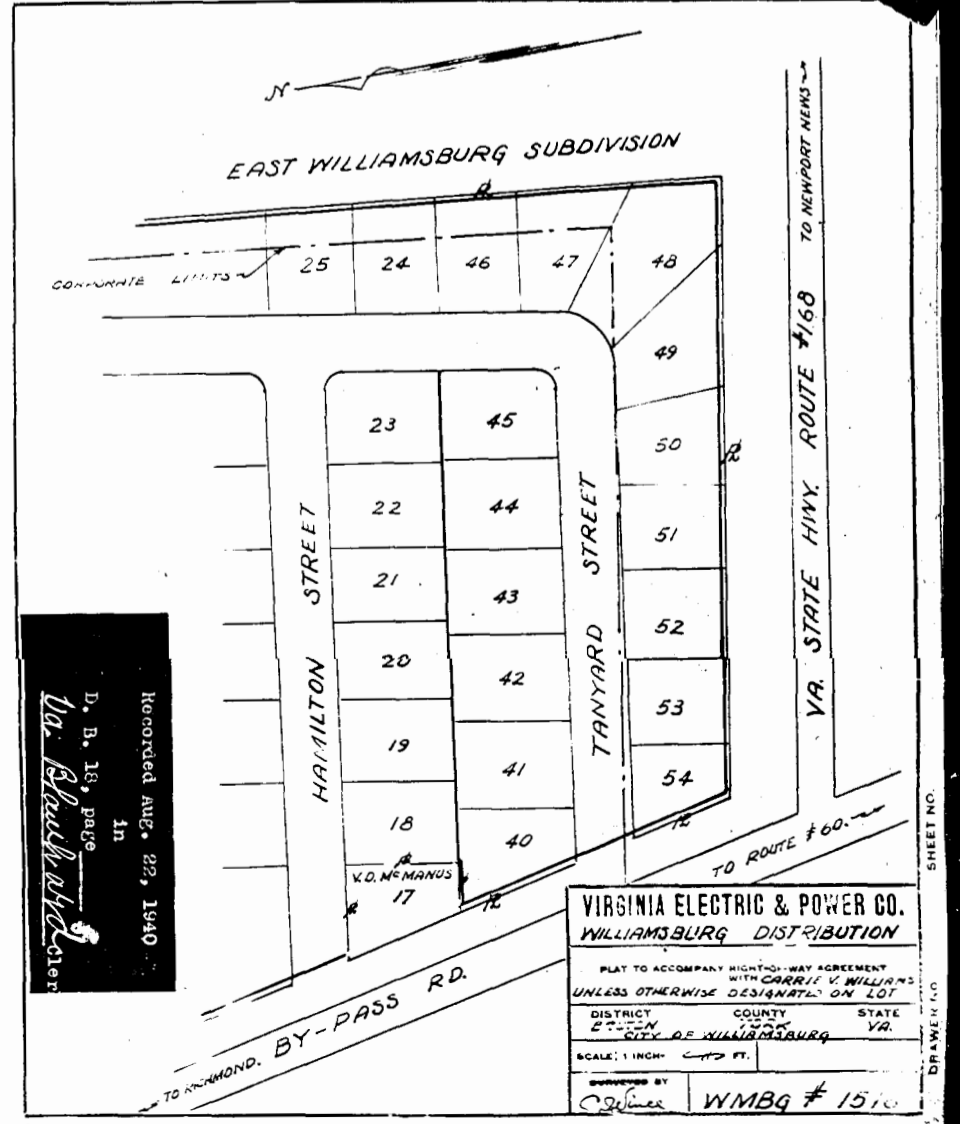

Recorded Aug. 22, 1940
in
D. B. 32 page
Va. Blanchard, Clerk

VIRGINIA ELECTRIC & POWER CO.			
WILLIAMSBURG DISTRIBUTION			
PLAT TO ACCOMPANY RIGHT-OF-WAY AGREEMENT WITH			
UNLESS OTHERWISE DESIGNATED ON LOT			
DISTRICT	COUNTY	STATE	
JAMESTOWN	JAMES CITY	VIRGINIA	
DRAWN BY		WMBG # 1561	

18 INCHES

8-27