

Plat recorded May 27, 1940
 in
 D. B. 18 page 261 and Co. D. B.
 page 141
De Blawhard clerk

Property to be Acquired
 FROM
 EASTERN STATE HOSPITAL
 FOR
 COLONIAL PARKWAY
 Bureau of Public Roads
 Williamsburg, Va.
 Scale 1"=200' June 5, '39

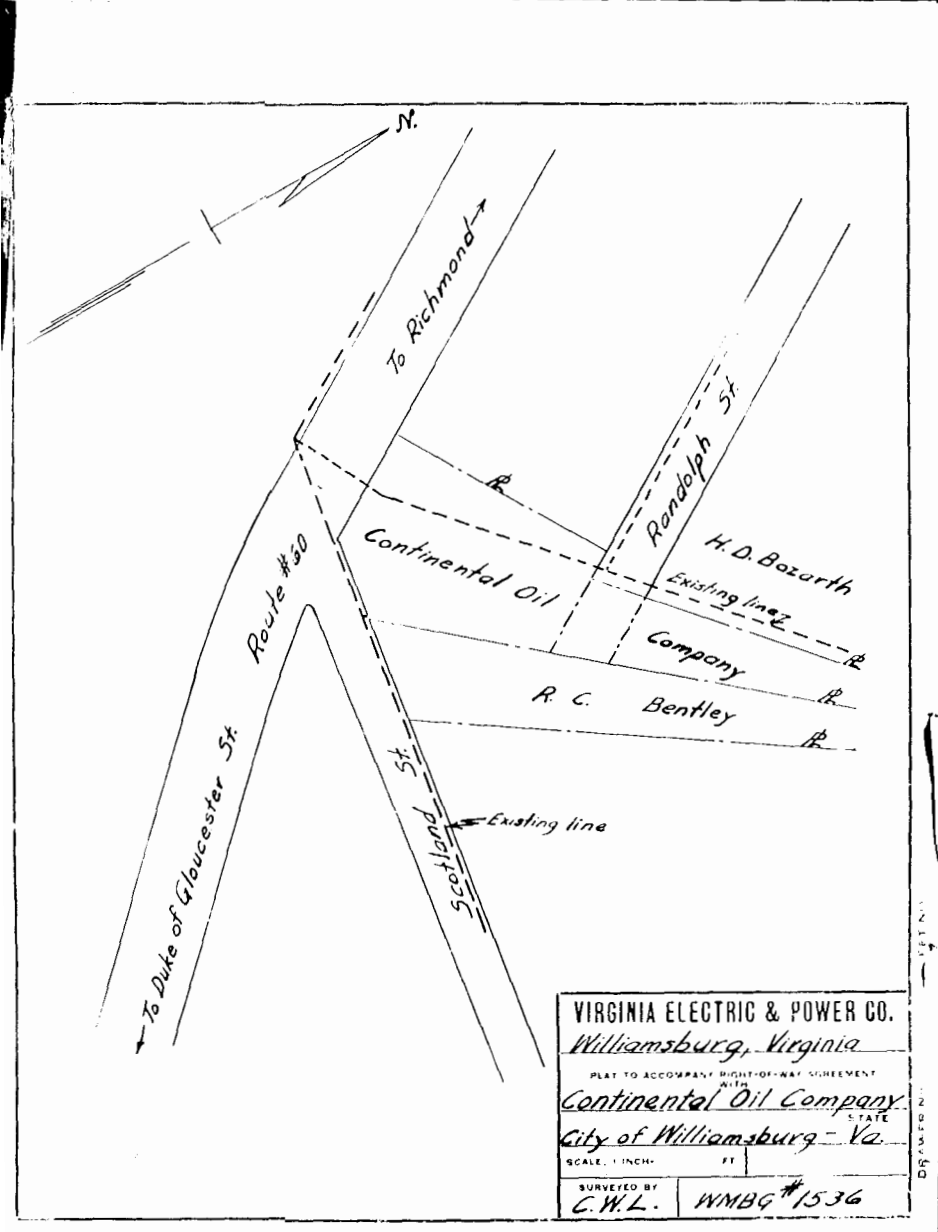

VIRGINIA ELECTRIC & POWER CO.
 Williamsburg, Virginia
 PLAT TO ACCOMPANY RIGHT-OF-WAY AGREEMENT
 WITH
 Continental Oil Company
 City of Williamsburg, Va.
 SCALE: 1"=100'
 SURVEYED BY
 C.W.L. WMBG #1536

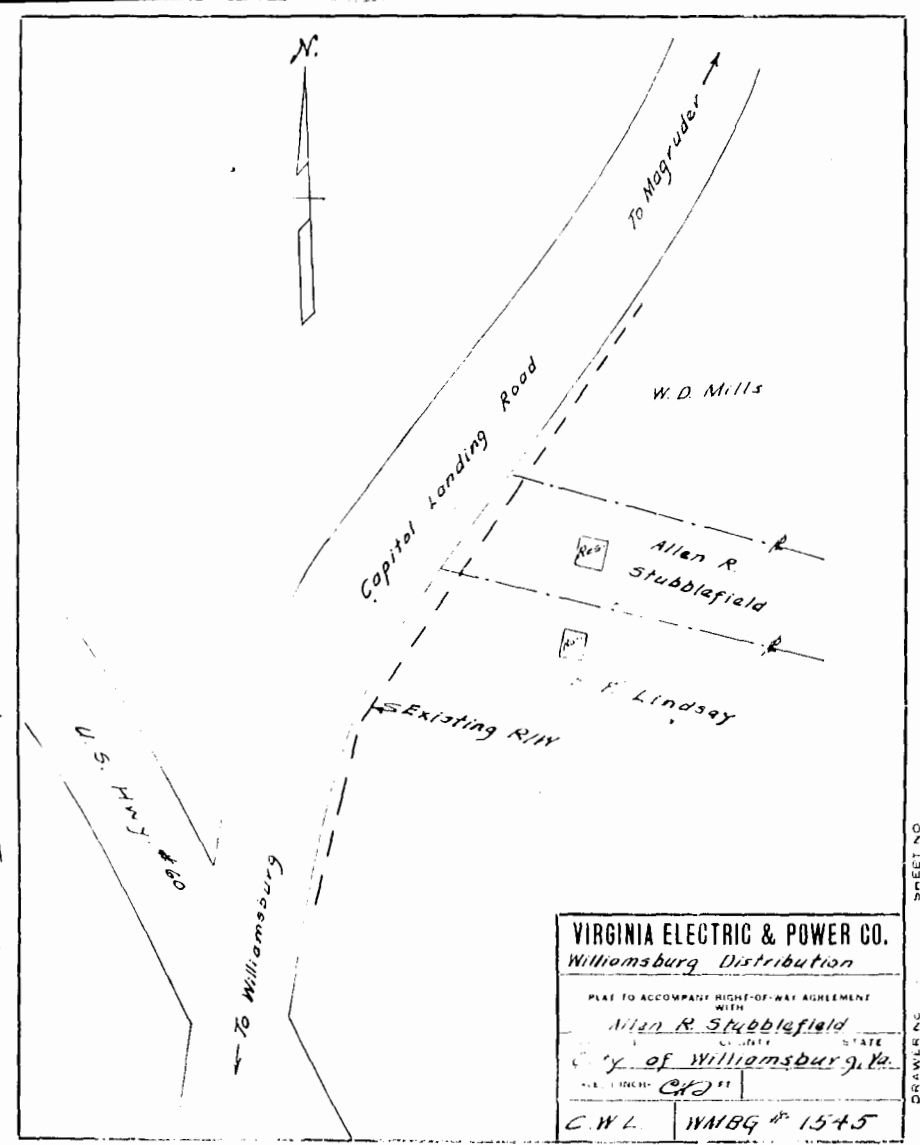

VIRGINIA ELECTRIC & POWER CO.
 Williamsburg Distribution
 PLAT TO ACCOMPANY RIGHT-OF-WAY AGREEMENT
 WITH
 Alan R. Stubbsfield
 City of Williamsburg, Va.
 SCALE: 1"=100'
 C.W.L. WMBG #1545

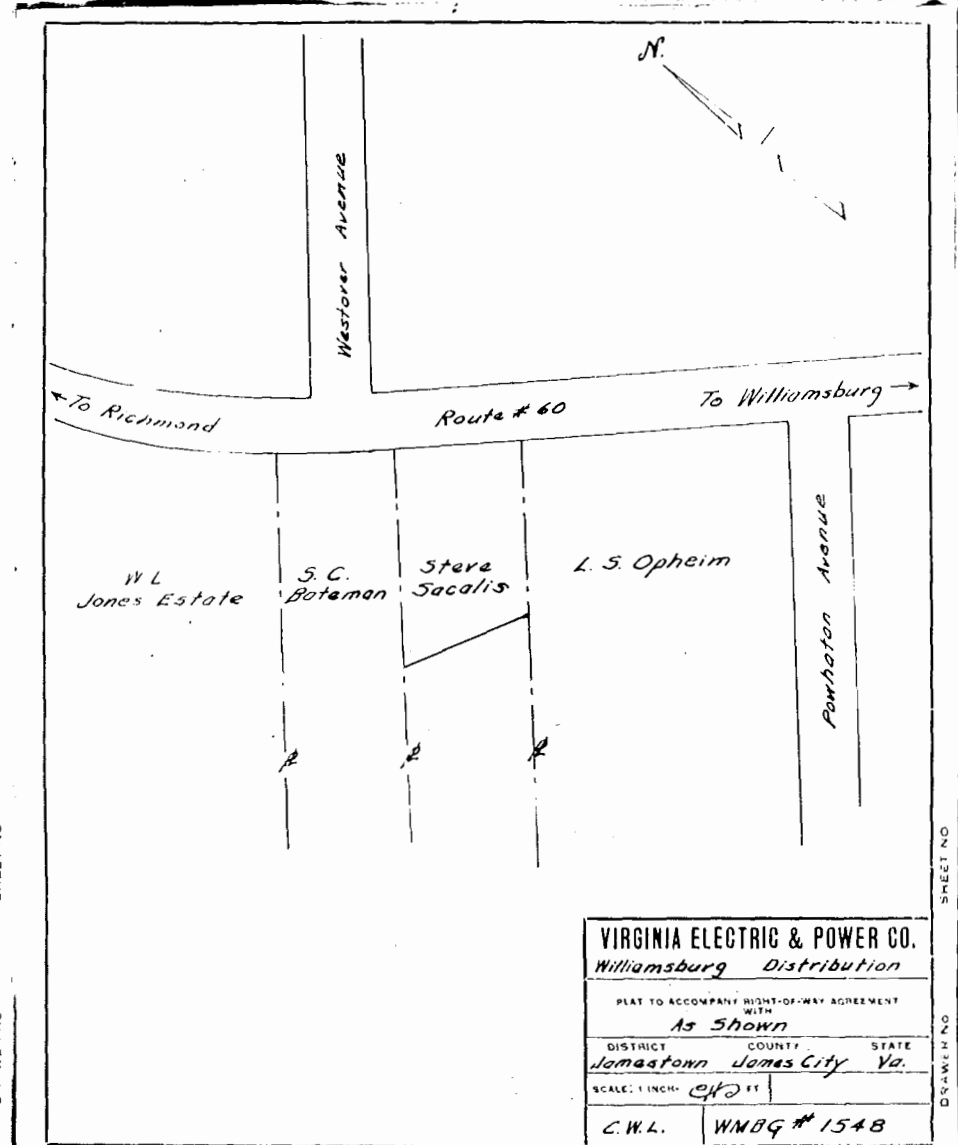

VIRGINIA ELECTRIC & POWER CO.
 Williamsburg Distribution
 PLAT TO ACCOMPANY RIGHT-OF-WAY AGREEMENT
 WITH
 As Shown
 DISTRICT: James City COUNTY: James City STATE: Va.
 SCALE: 1"=100'
 C.W.L. WMBG #1548

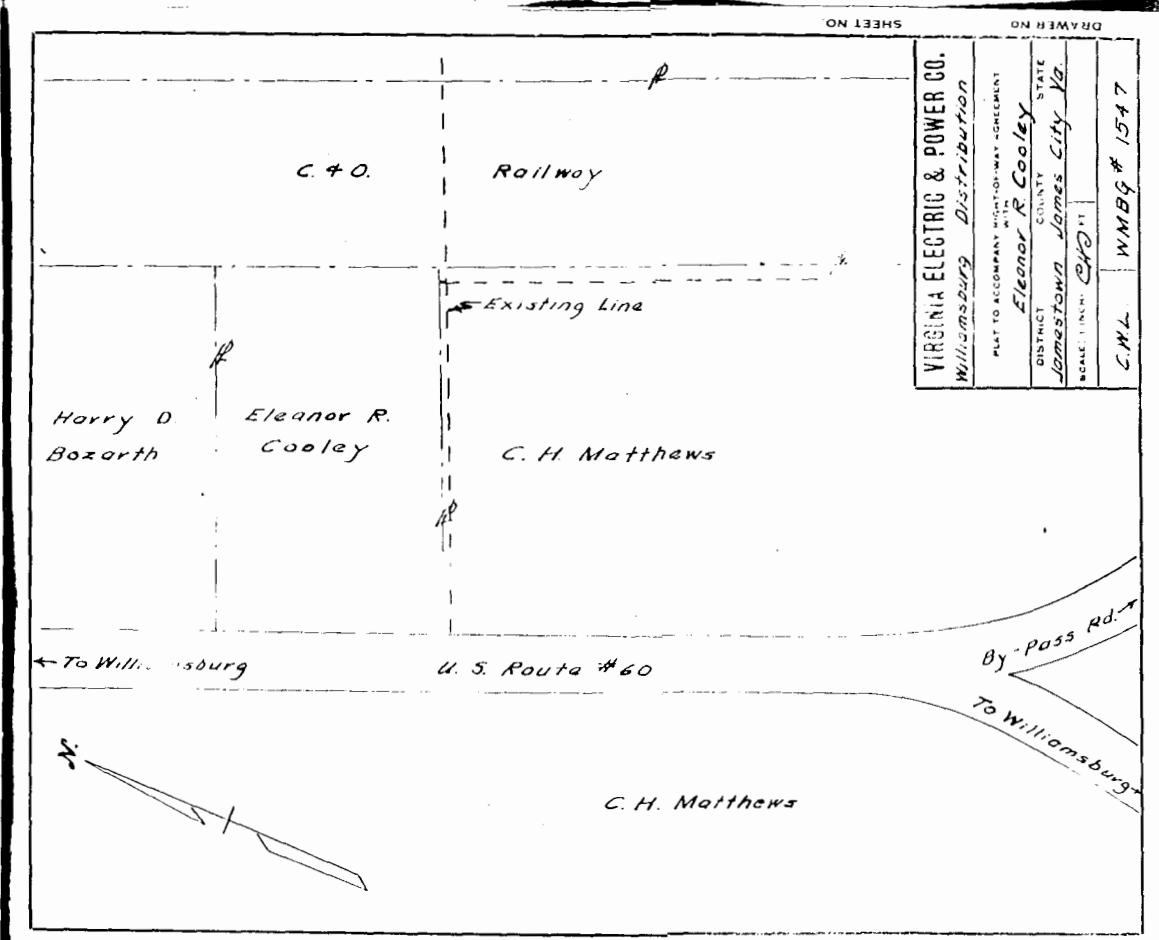

VIRGINIA ELECTRIC & POWER CO.
 Williamsburg Distribution
 PLAT TO ACCOMPANY RIGHT-OF-WAY AGREEMENT
 WITH
 Eleanor R. Cooley
 James City, Va.
 SCALE: 1"=100'
 C.W.L. WMBG #1547

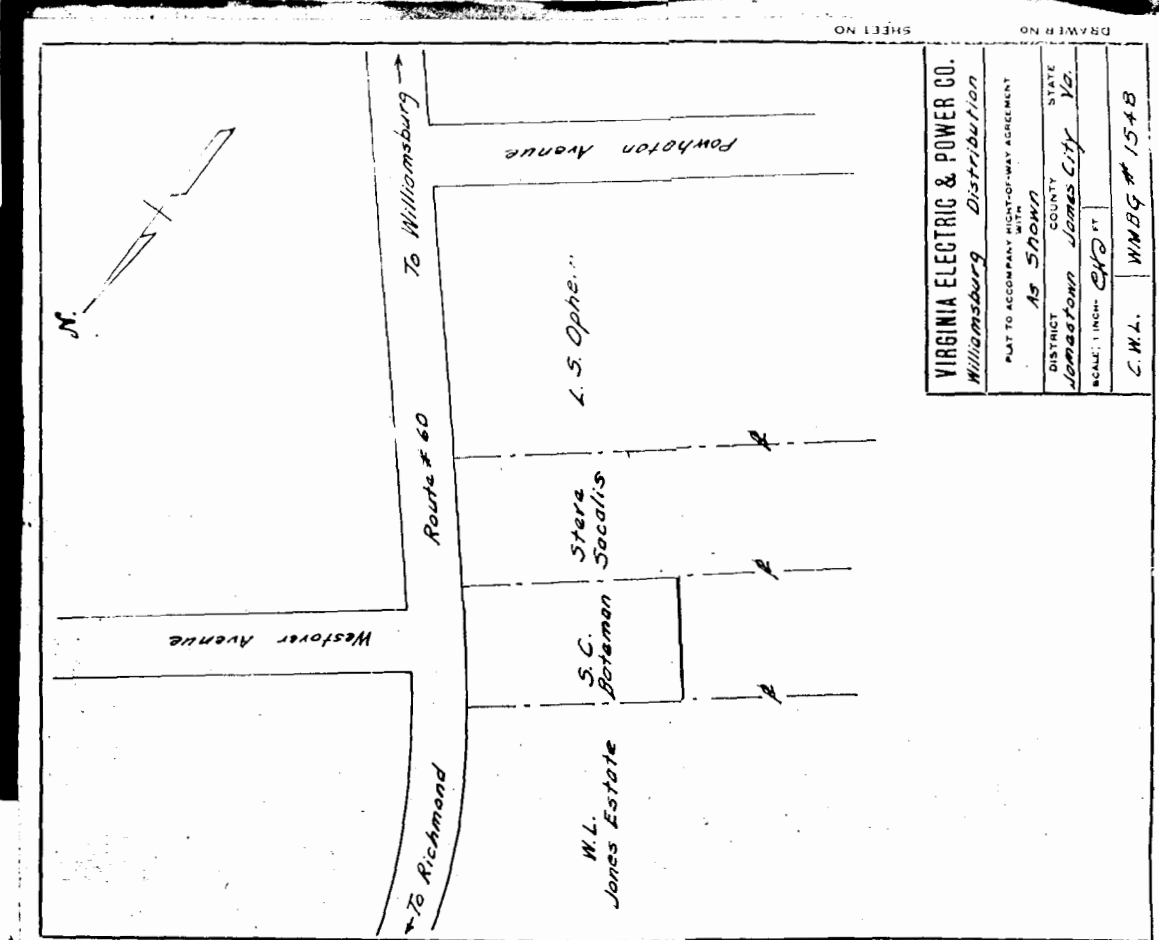

VIRGINIA ELECTRIC & POWER CO.
 Williamsburg Distribution
 PLAT TO ACCOMPANY RIGHT-OF-WAY AGREEMENT
 WITH
 As Shown
 DISTRICT: James City COUNTY: James City STATE: Va.
 SCALE: 1"=100'
 C.W.L. WMBG #1548

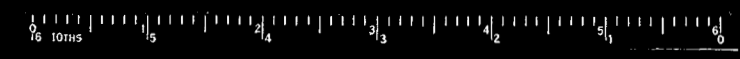

8-22