

Recorded June 15, 1938
in
D. B. 30 page 96
W. B. Blauhard Clerk

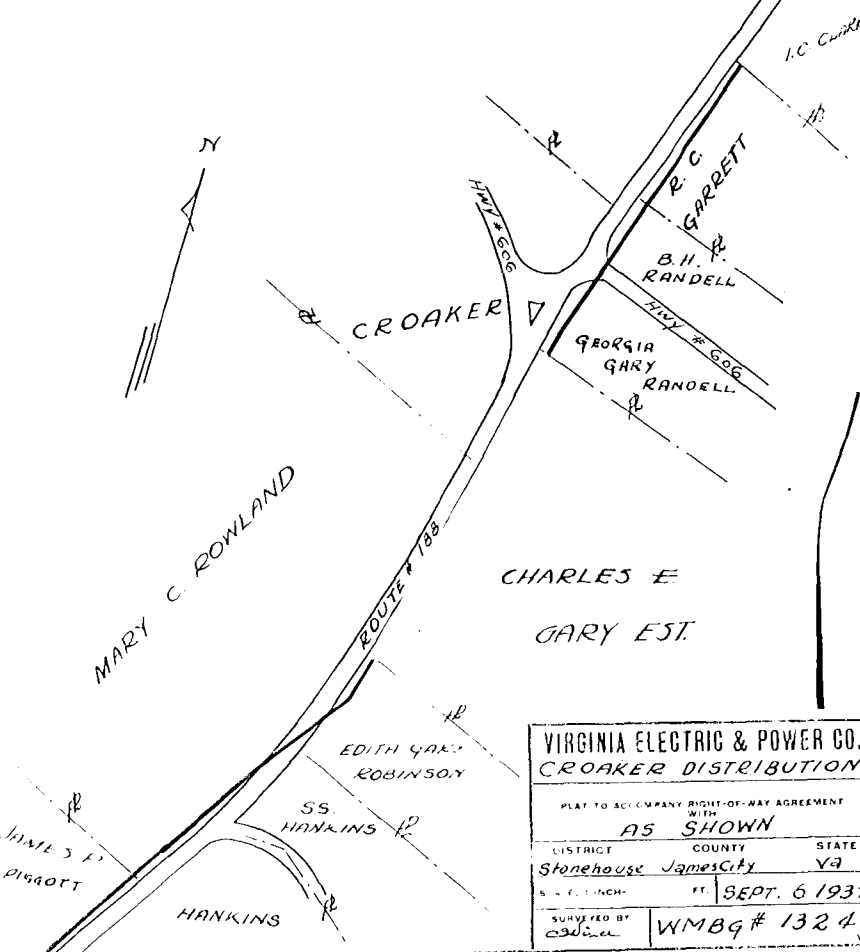

VIRGINIA ELECTRIC & POWER CO.
CROAKER DISTRIBUTION
PLAT TO ACCOMPANY RIGHT-OF-WAY AGREEMENT
WITH
AS SHOWN
DISTRICT COUNTY STATE
Stonehouse James City VA
SCALE: 1 INCH = 100 FT. SEPT. 6 1937
SURVEYED BY
WMBG # 1324

Recorded June 15, 1938
in
D. B. 30 page 92
W. B. Blauhard Clerk

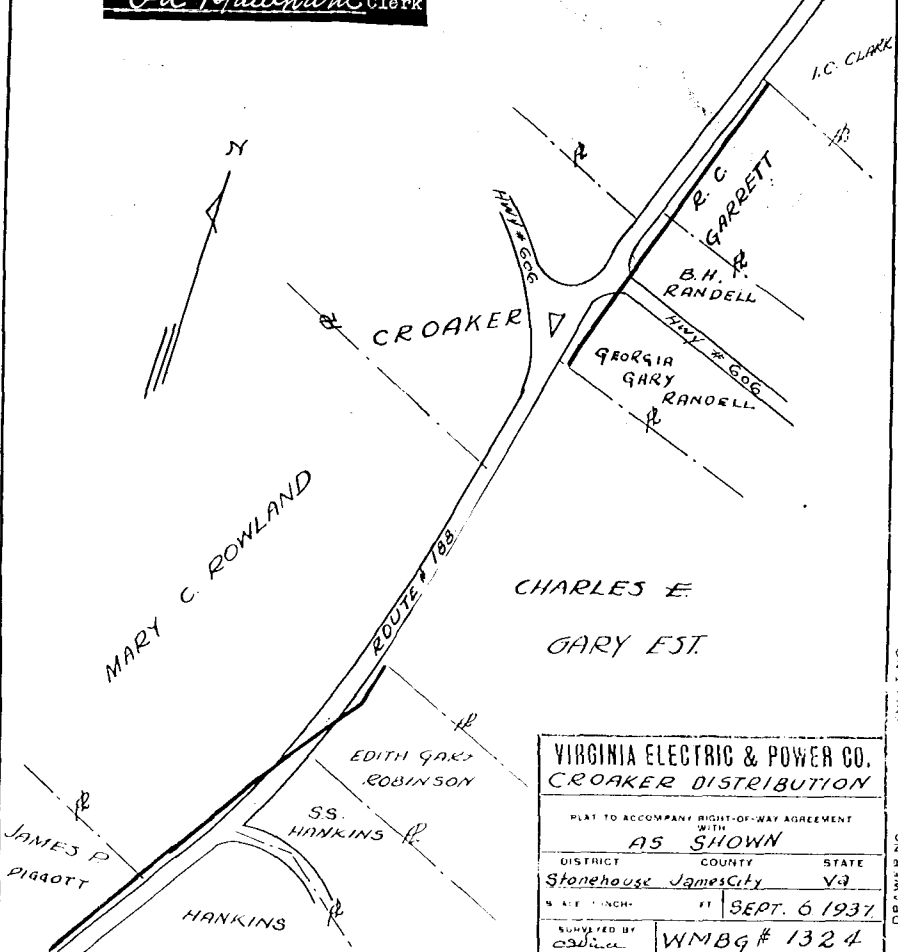

VIRGINIA ELECTRIC & POWER CO.
CROAKER DISTRIBUTION
PLAT TO ACCOMPANY RIGHT-OF-WAY AGREEMENT
WITH
AS SHOWN
DISTRICT COUNTY STATE
Stonehouse James City VA
SCALE: 1 INCH = 100 FT. SEPT. 6 1937
SURVEYED BY
WMBG # 1324

Recorded June 15, 1938,
in
D. B. 30, page 102
W. B. Blauhard Clerk

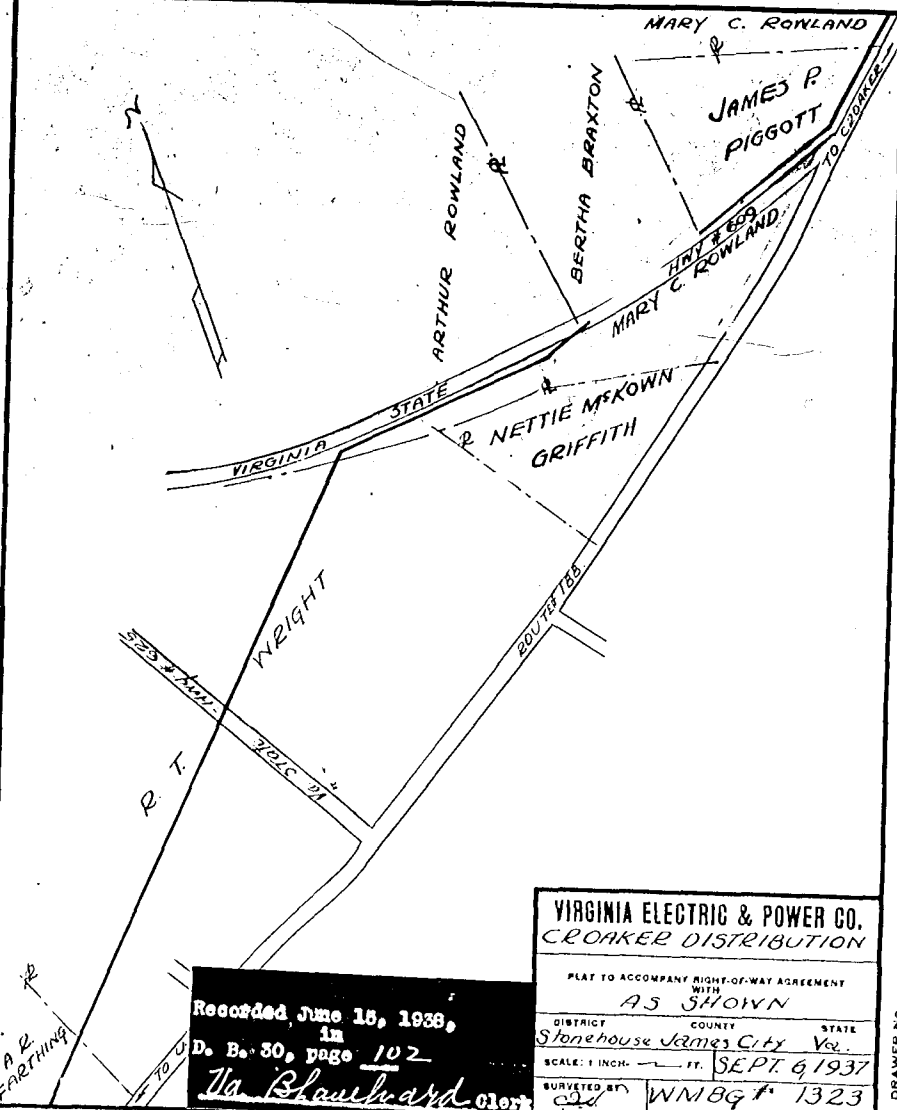

VIRGINIA ELECTRIC & POWER CO.
CROAKER DISTRIBUTION
PLAT TO ACCOMPANY RIGHT-OF-WAY AGREEMENT
WITH
AS SHOWN
DISTRICT COUNTY STATE
Stonehouse James City Va.
SCALE: 1 INCH = 100 FT. SEPT. 6 1937
SURVEYED BY
WMBG # 1323

Recorded June 15, 1938,
in
D. B. No. 30, page 104
W. B. Blauhard Clerk

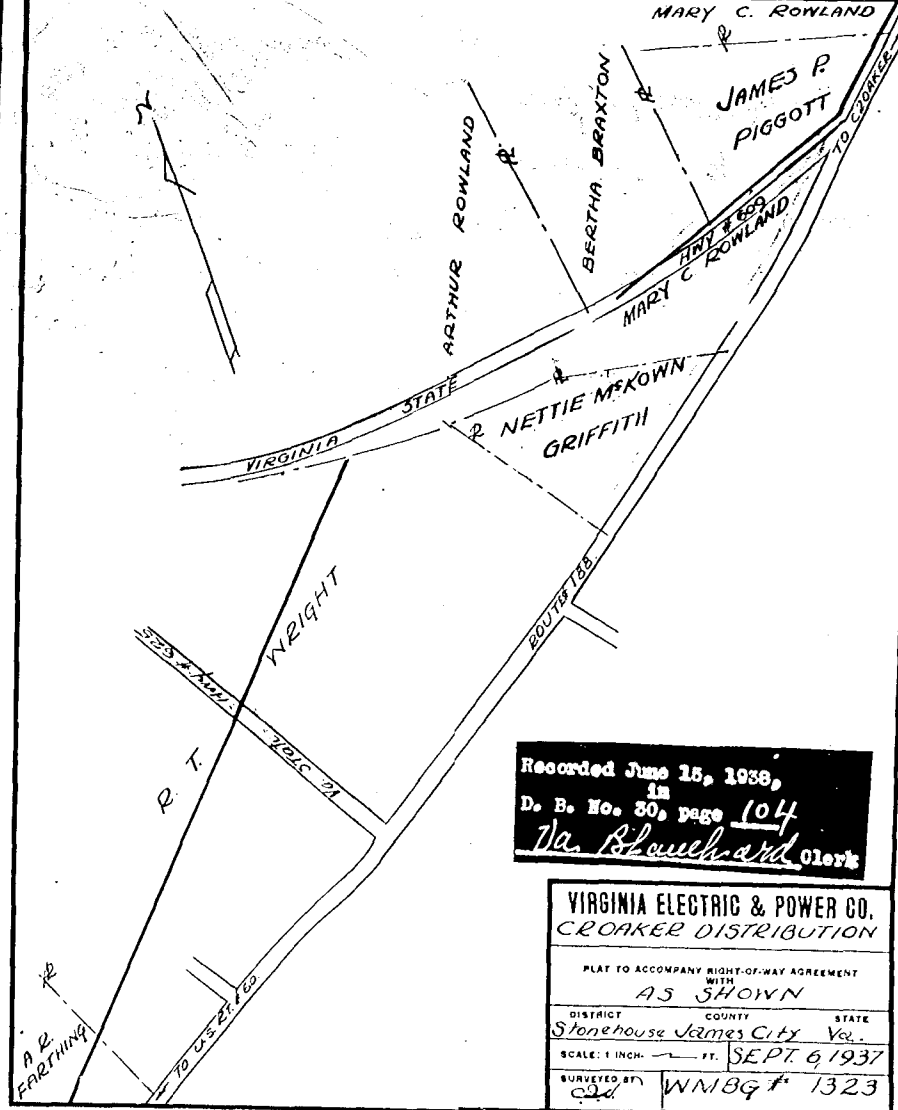

VIRGINIA ELECTRIC & POWER CO.
CROAKER DISTRIBUTION
PLAT TO ACCOMPANY RIGHT-OF-WAY AGREEMENT
WITH
AS SHOWN
DISTRICT COUNTY STATE
Stonehouse James City Va.
SCALE: 1 INCH = 100 FT. SEPT. 6 1937
SURVEYED BY
WMBG # 1323

Recorded June 15, 1938
in
D. B. 30 page 94
W. B. Blauhard Clerk

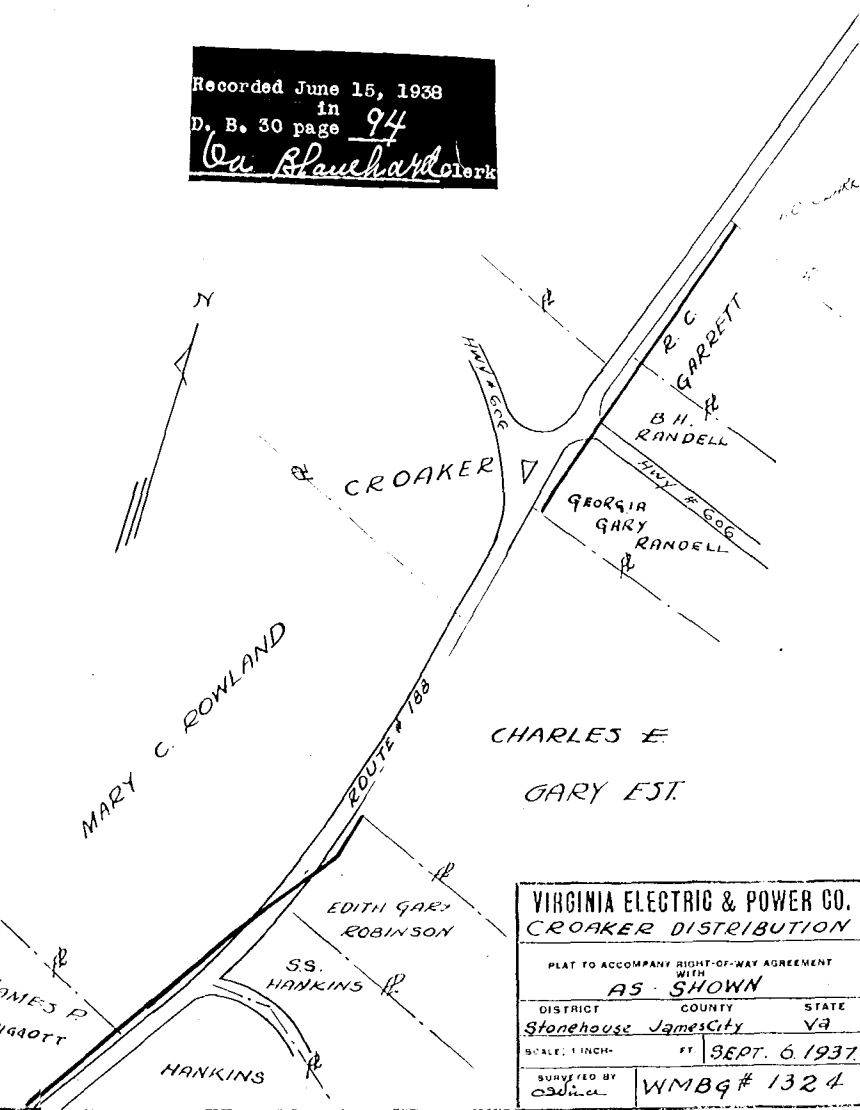

VIRGINIA ELECTRIC & POWER CO.
CROAKER DISTRIBUTION
PLAT TO ACCOMPANY RIGHT-OF-WAY AGREEMENT
WITH
AS SHOWN
DISTRICT COUNTY STATE
Stonehouse James City VA
SCALE: 1 INCH = 100 FT. SEPT. 6 1937
SURVEYED BY
WMBG # 1324

Recorded June 15, 1938
in
D. B. 30 page 91
W. B. Blauhard Clerk

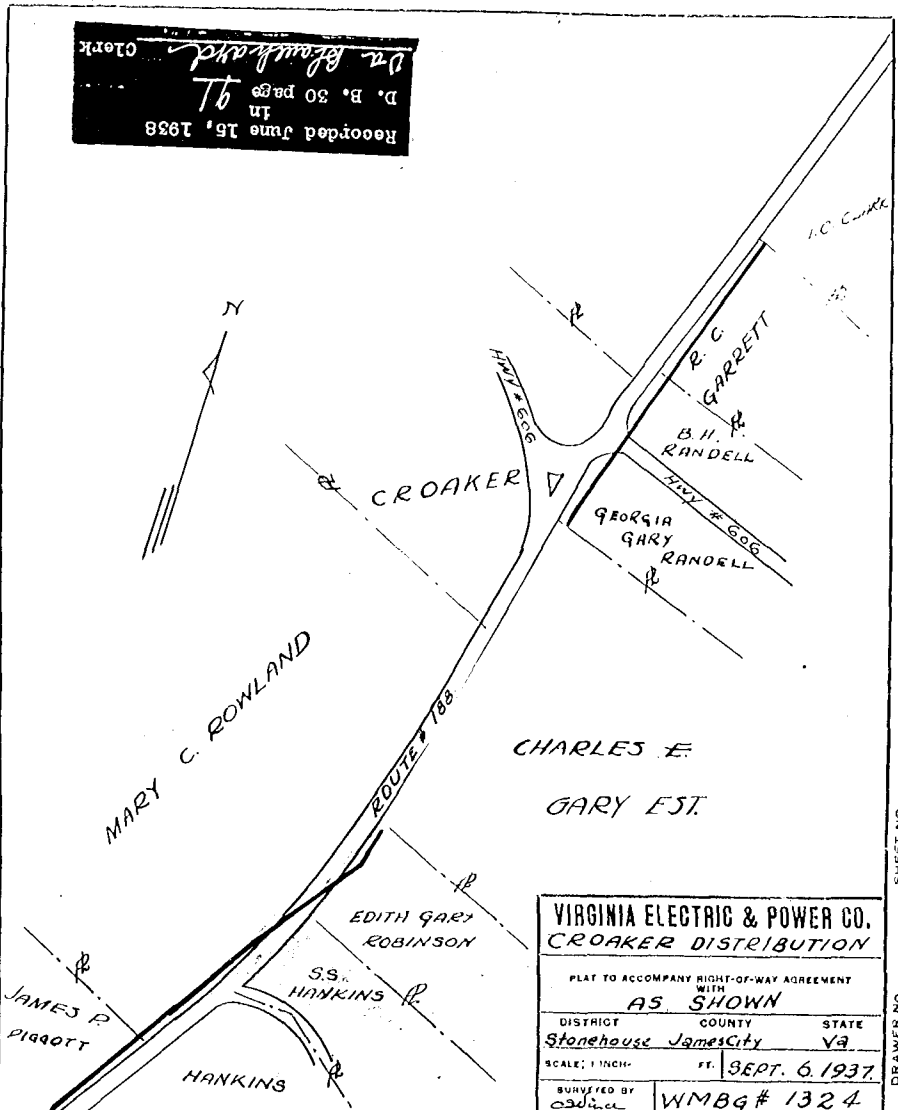

VIRGINIA ELECTRIC & POWER CO.
CROAKER DISTRIBUTION
PLAT TO ACCOMPANY RIGHT-OF-WAY AGREEMENT
WITH
AS SHOWN
DISTRICT COUNTY STATE
Stonehouse James City VA
SCALE: 1 INCH = 100 FT. SEPT. 6 1937
SURVEYED BY
WMBG # 1324

Recorded June 15, 1938
in
D. B. 30 page 101
W. B. Blauhard Clerk

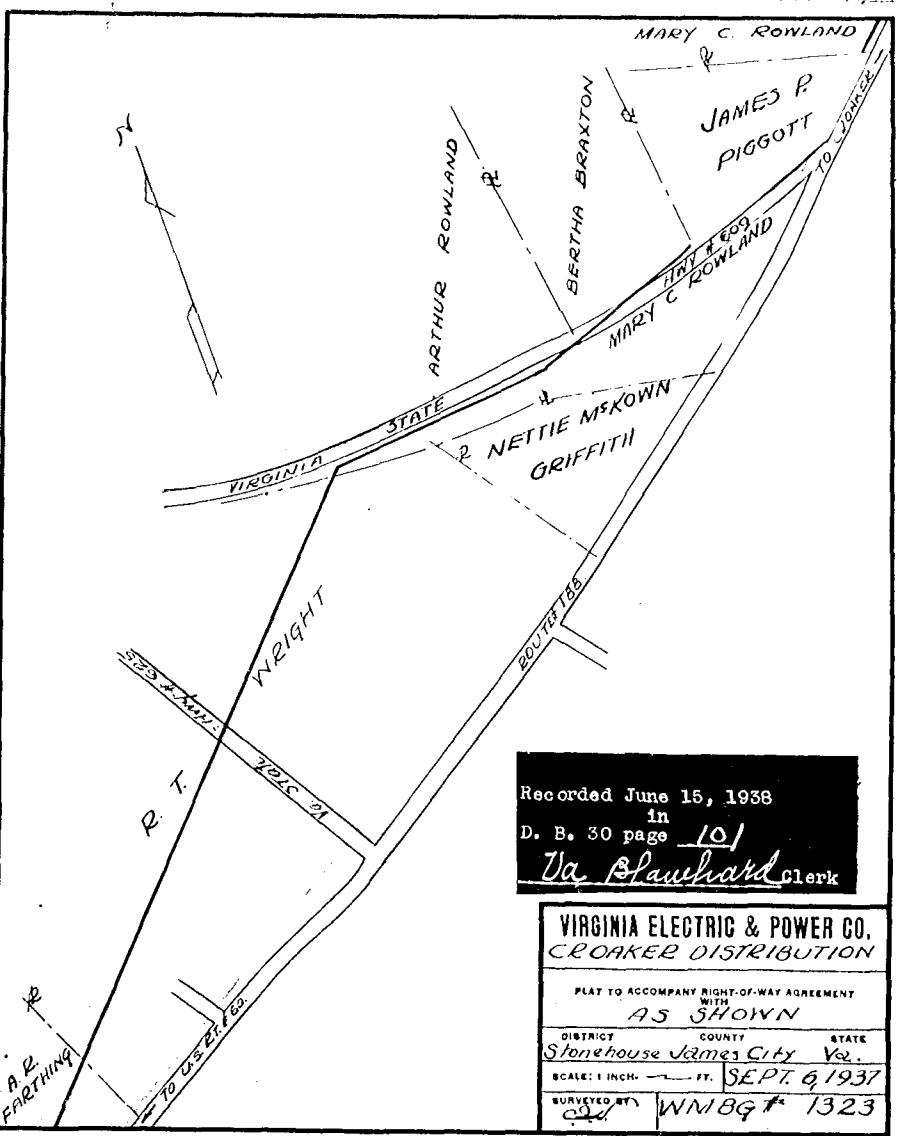

VIRGINIA ELECTRIC & POWER CO.
CROAKER DISTRIBUTION
PLAT TO ACCOMPANY RIGHT-OF-WAY AGREEMENT
WITH
AS SHOWN
DISTRICT COUNTY STATE
Stonehouse James City Va.
SCALE: 1 INCH = 100 FT. SEPT. 6 1937
SURVEYED BY
WMBG # 1323

Recorded June 15, 1938
in
D. B. 30, page 104
W. B. Blauhard Clerk

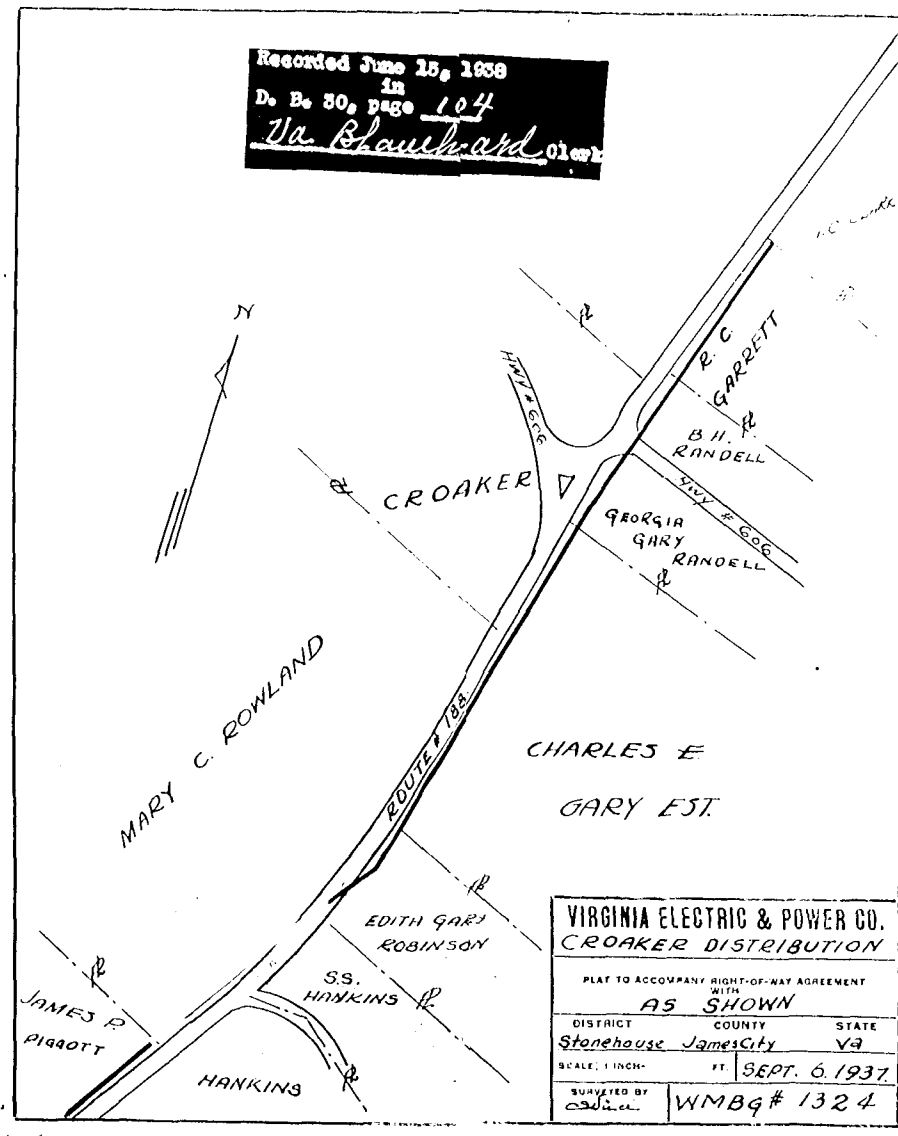

VIRGINIA ELECTRIC & POWER CO.
CROAKER DISTRIBUTION
PLAT TO ACCOMPANY RIGHT-OF-WAY AGREEMENT
WITH
AS SHOWN
DISTRICT COUNTY STATE
Stonehouse James City VA
SCALE: 1 INCH = 100 FT. SEPT. 6 1937
SURVEYED BY
WMBG # 1324

