

VIRGINIA ELECTRIC & POWER CO.		
WILLIAMSBURG-TOANO DISTRIBUTION		
TRANSMISSION LINE		
PLAT TO ACCOMPANY RIGHT-OF-WAY AGREEMENT		
WITH AS SHOWN		
DISTRICT	COUNTY	STATE
JAMES CITY	JAMES CITY	VIRGINIA
SCALE: 1 INCH	FT.	OCT 16, 1933
SURVEYED BY	A.H.M'D JR WMSBG # 1094	

VIRGINIA ELECTRIC & POWER CO.		
WILLIAMSBURG-TOANO DISTRIBUTION		
TRANSMISSION LINE		
PLAT TO ACCOMPANY RIGHT-OF-WAY AGREEMENT		
WITH AS SHOWN		
DISTRICT	COUNTY	STATE
JAMES CITY	JAMES CITY	VIRGINIA
SCALE: 1 INCH	FT.	OCT 16, 1933
SURVEYED BY	A.H.M'D JR WMSBG # 1094	

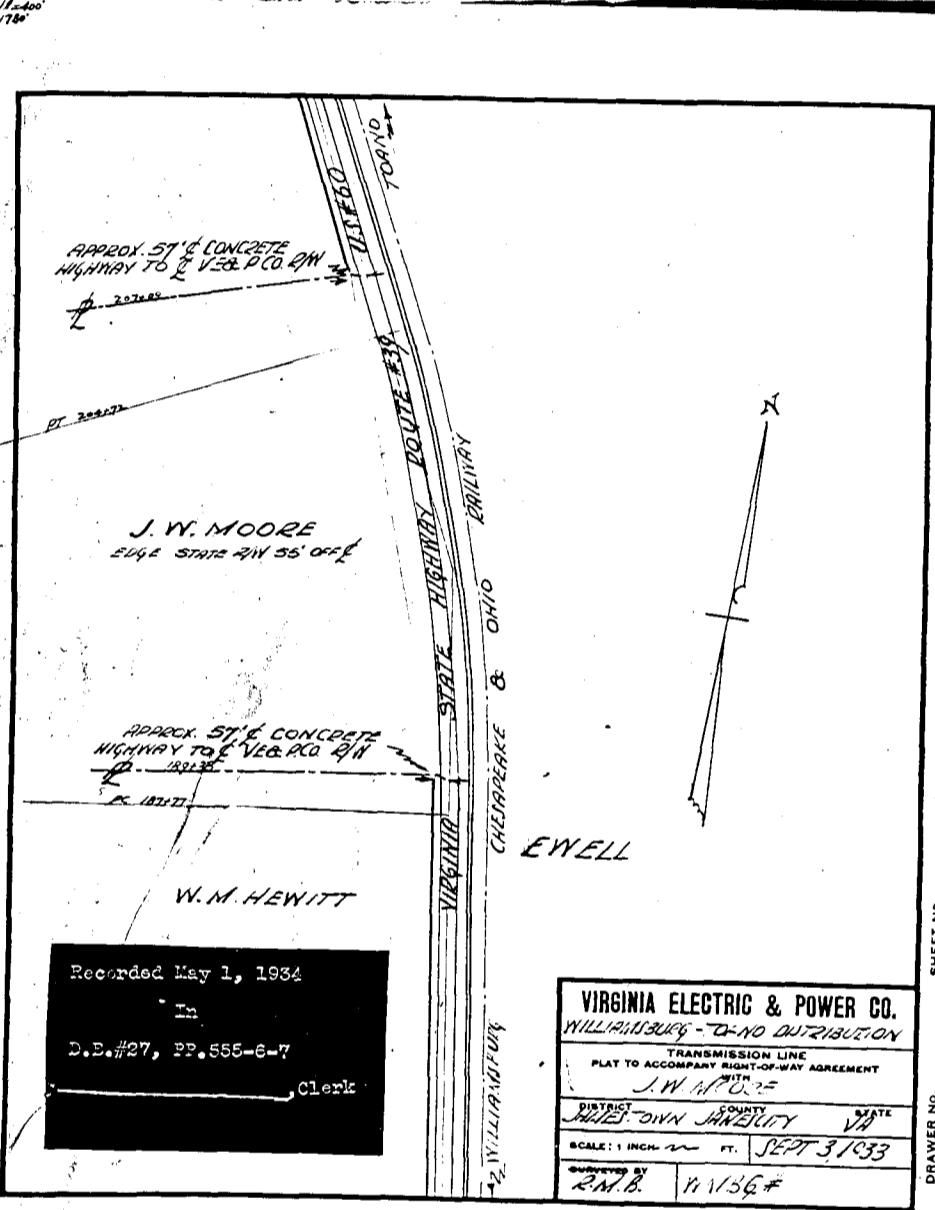

VIRGINIA ELECTRIC & POWER CO.		
WILLIAMSBURG-TOANO DISTRIBUTION		
TRANSMISSION LINE		
PLAT TO ACCOMPANY RIGHT-OF-WAY AGREEMENT		
WITH AS SHOWN		
DISTRICT	COUNTY	STATE
JAMES CITY	JAMES CITY	VIRGINIA
SCALE: 1 INCH	FT.	SEPT 3, 1933
SURVEYED BY	R.M.B. WMSBG # 110	

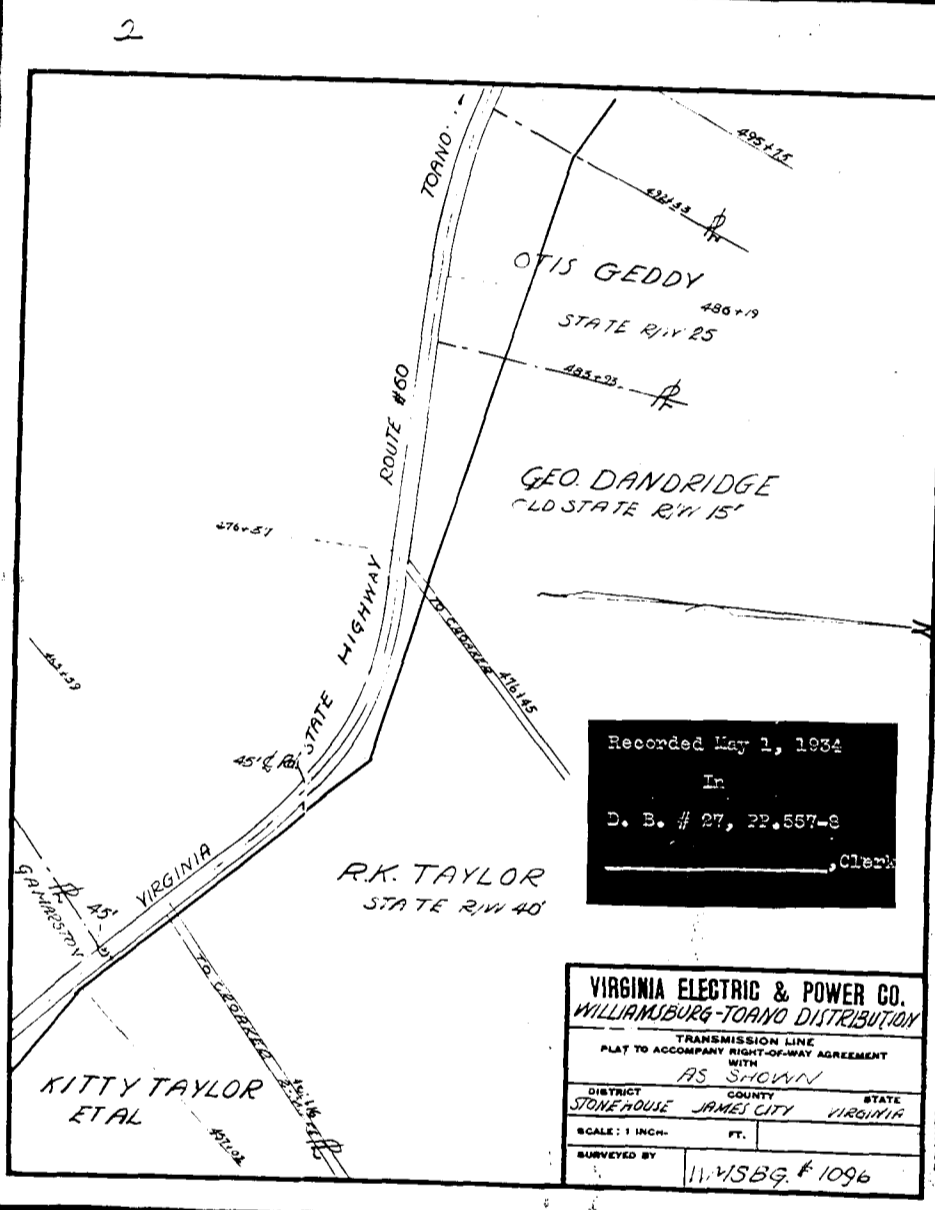

VIRGINIA ELECTRIC & POWER CO.		
WILLIAMSBURG-TOANO DISTRIBUTION		
TRANSMISSION LINE		
PLAT TO ACCOMPANY RIGHT-OF-WAY AGREEMENT		
WITH AS SHOWN		
DISTRICT	COUNTY	STATE
JAMES CITY	JAMES CITY	VIRGINIA
SCALE: 1 INCH	FT.	SEPT 3, 1933
SURVEYED BY	WMSBG # 1096	

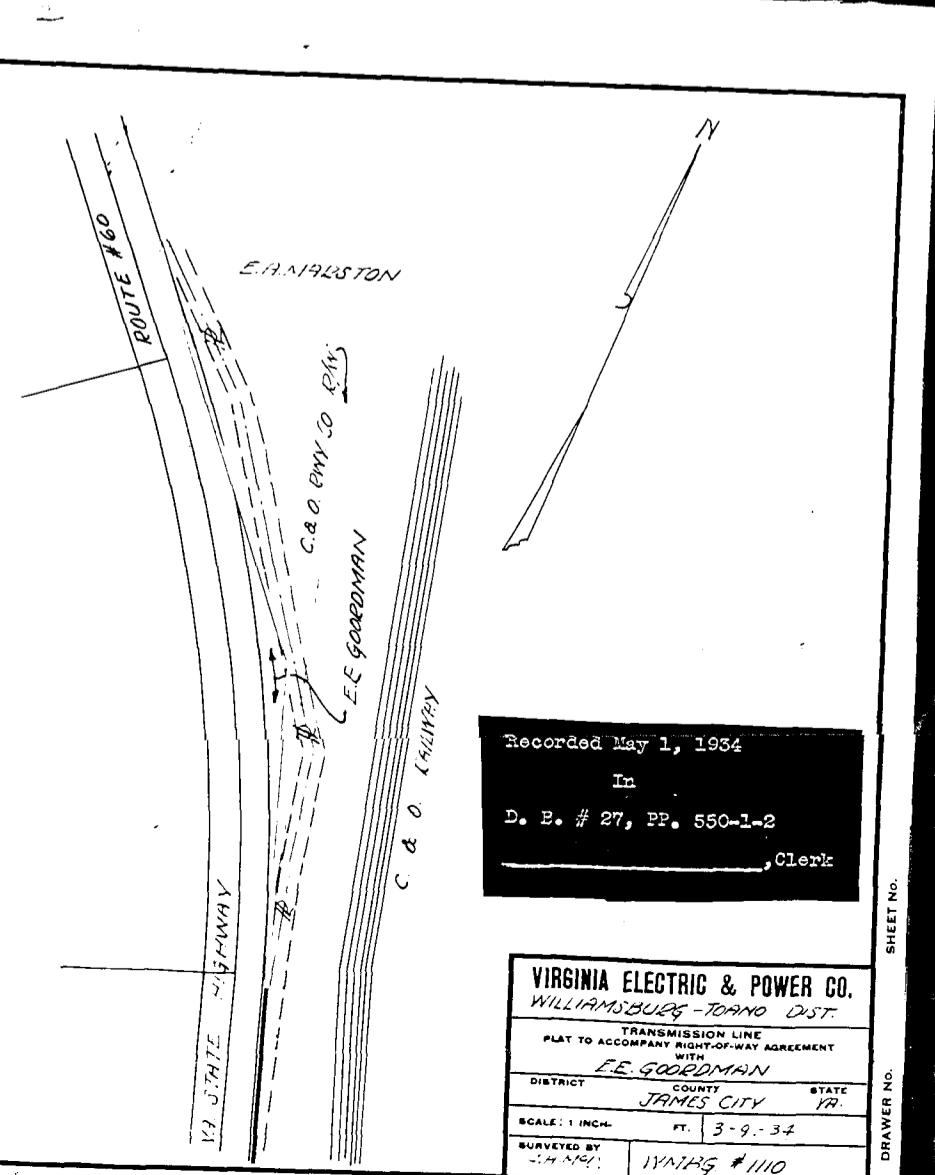

VIRGINIA ELECTRIC & POWER CO.		
WILLIAMSBURG-TOANO DIST.		
TRANSMISSION LINE		
PLAT TO ACCOMPANY RIGHT-OF-WAY AGREEMENT		
WITH AS SHOWN		
DISTRICT	COUNTY	STATE
JAMES CITY	JAMES CITY	VIRGINIA
SCALE: 1 INCH	FT.	3-9-34
SURVEYED BY	WMSBG # 110	

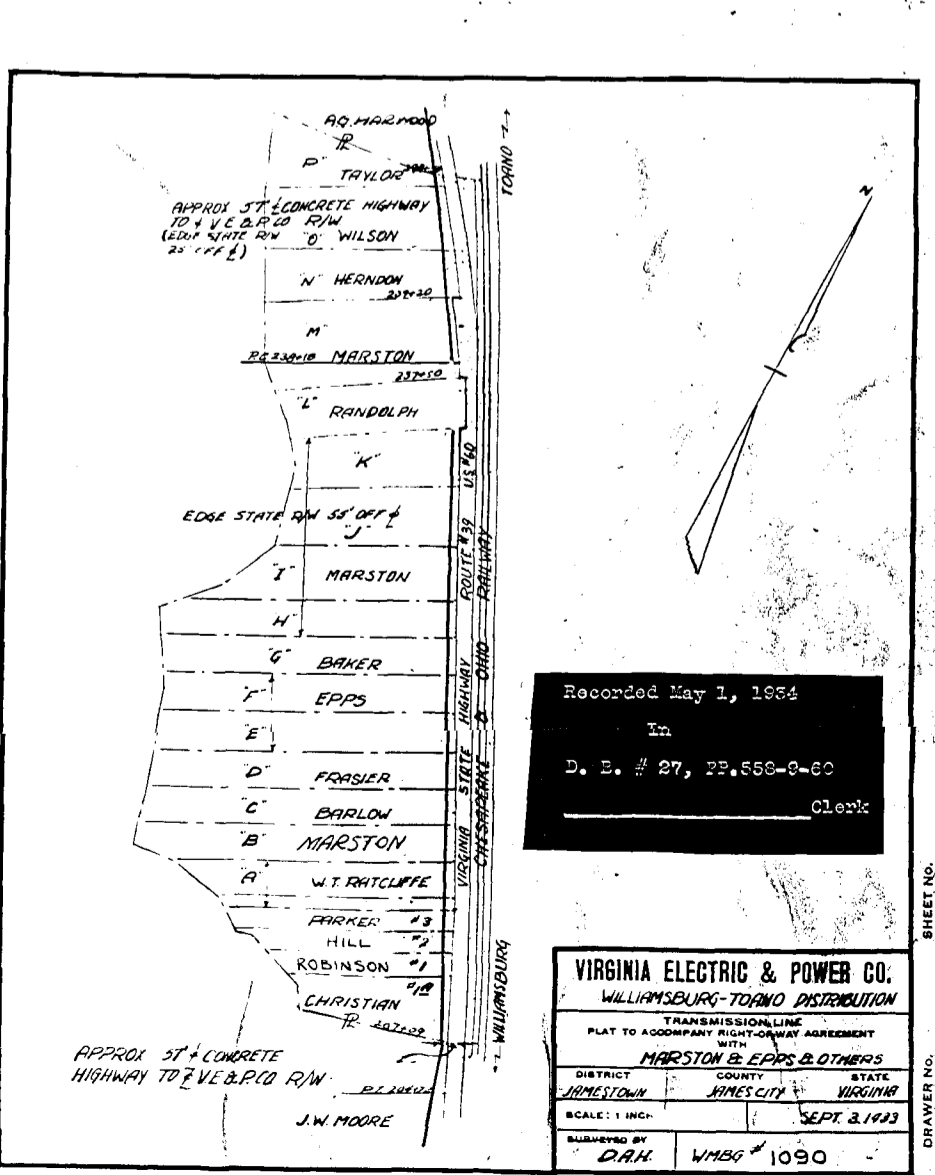

VIRGINIA ELECTRIC & POWER CO.		
WILLIAMSBURG-TOANO DISTRIBUTION		
TRANSMISSION LINE		
PLAT TO ACCOMPANY RIGHT-OF-WAY AGREEMENT		
WITH AS SHOWN		
DISTRICT	COUNTY	STATE
JAMES CITY	JAMES CITY	VIRGINIA
SCALE: 1 INCH	FT.	SEPT 3, 1933
SURVEYED BY	D.A.H. WMSBG # 1090	