

Recorded May 28, 1932,
in
D. B. #26, pp 530
Va. Blanchard, Clerk

VIRGINIA ELECTRIC & POWER CO.
Williamsburg-Jamestown Distr.
TRANSMISSION LINE
PLAT TO ACCOMPANY RIGHT-OF-WAY AGREEMENT
WITH
FRANK & FLOYD POWELL
DISTRICT JAMES TOWN COUNTY JAMES CITY STATE VIRGINIA
SCALE 1 INCH = 100 FT. MAY 3, 1932
SURVEYED BY E.B.H. WMBG #1005

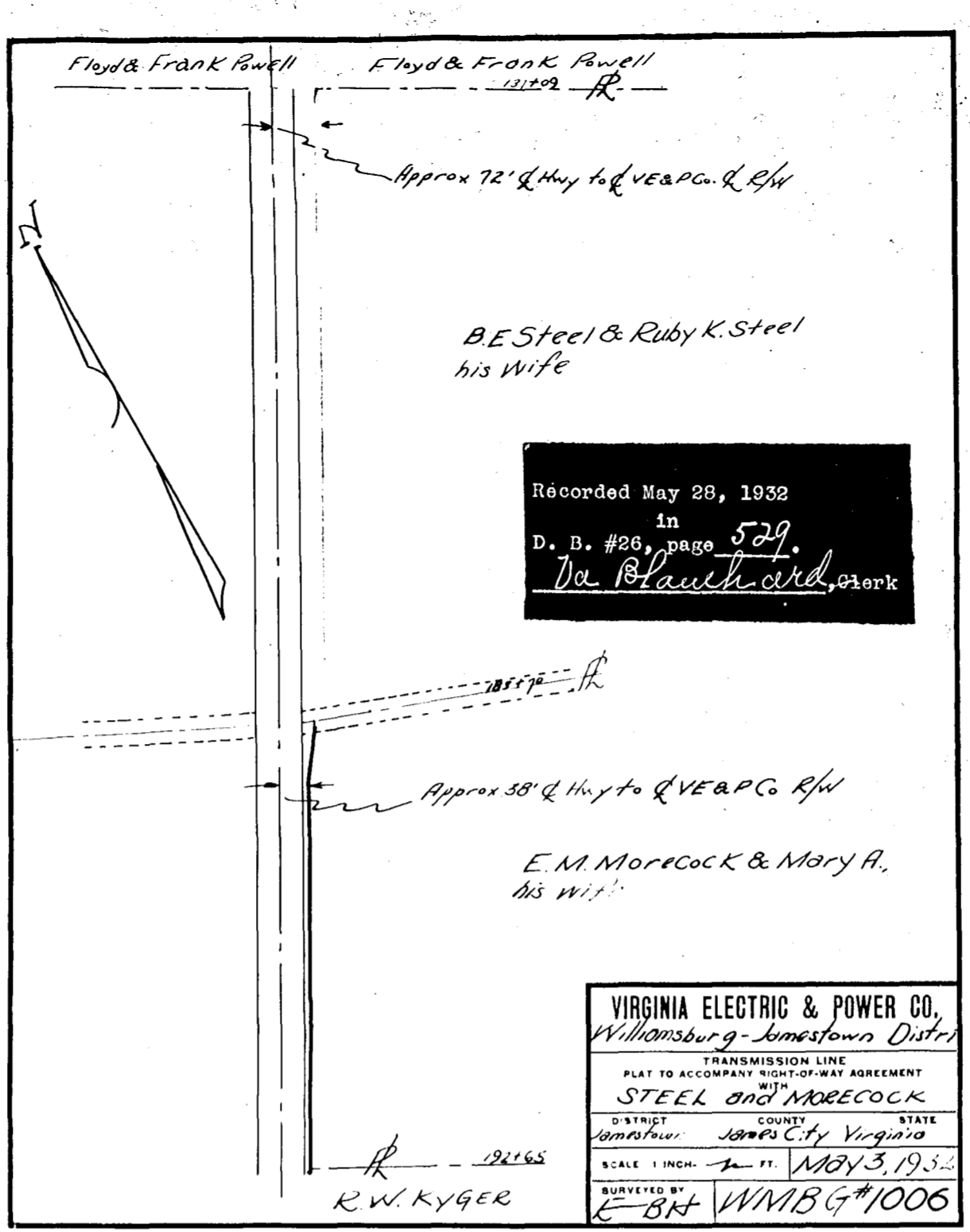

Recorded May 28, 1932
in
D. B. #26, page 529
Va. Blanchard, Clerk

VIRGINIA ELECTRIC & POWER CO.
Williamsburg-Jamestown Distr.
TRANSMISSION LINE
PLAT TO ACCOMPANY RIGHT-OF-WAY AGREEMENT
WITH
STEEL and MORECOCK
DISTRICT JAMES TOWN COUNTY JAMES CITY STATE VIRGINIA
SCALE 1 INCH = 100 FT. MAY 3, 1932
SURVEYED BY E.B.H. WMBG #1006

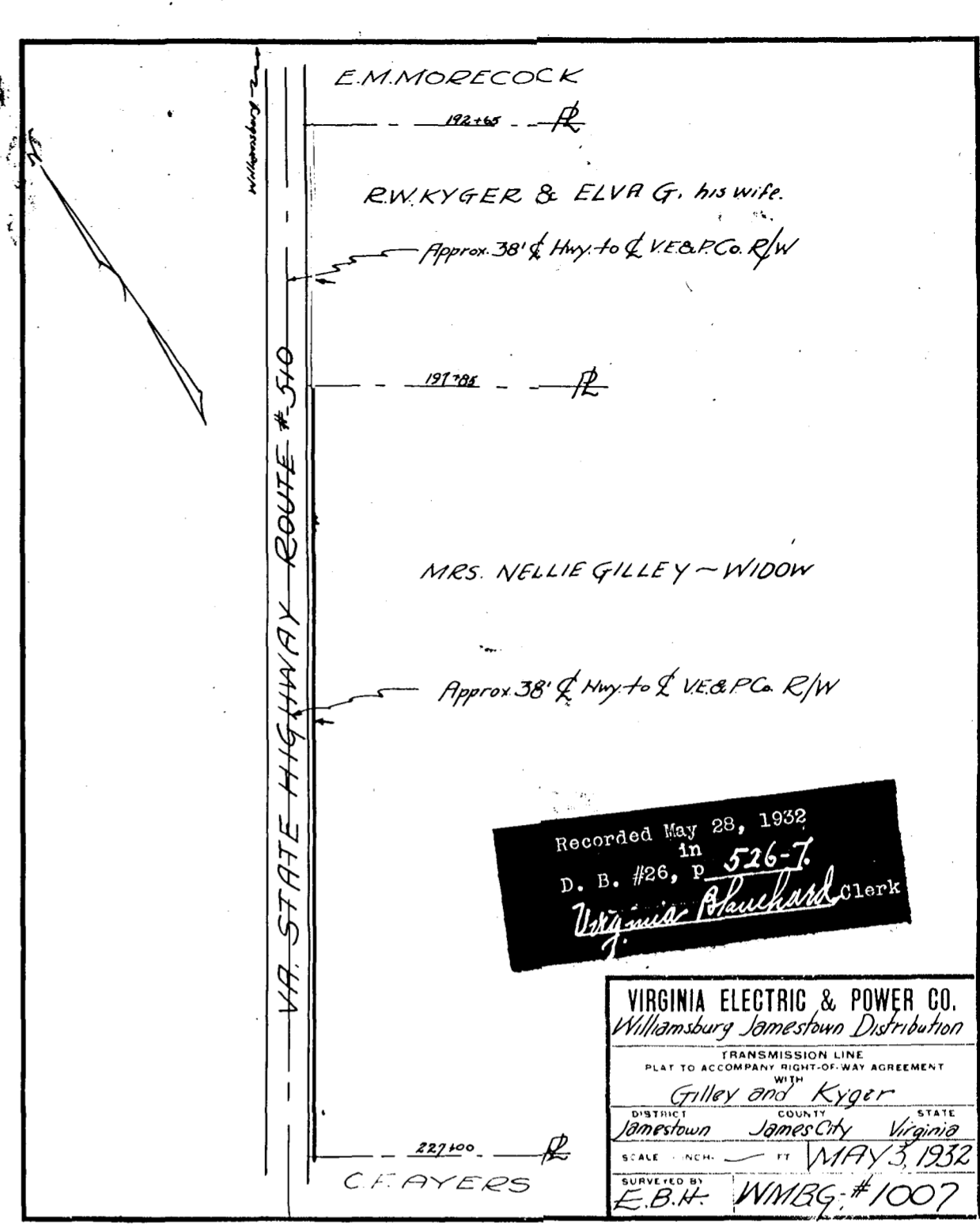

Recorded May 28, 1932
in
D. B. #26, p 526-7
Virginia Blanchard, Clerk

VIRGINIA ELECTRIC & POWER CO.
Williamsburg-Jamestown Distribution
TRANSMISSION LINE
PLAT TO ACCOMPANY RIGHT-OF-WAY AGREEMENT
WITH
Gilley and Kyger
DISTRICT JAMES TOWN COUNTY JAMES CITY STATE VIRGINIA
SCALE 1 INCH = 100 FT. MAY 3, 1932
SURVEYED BY E.B.H. WMBG #1007

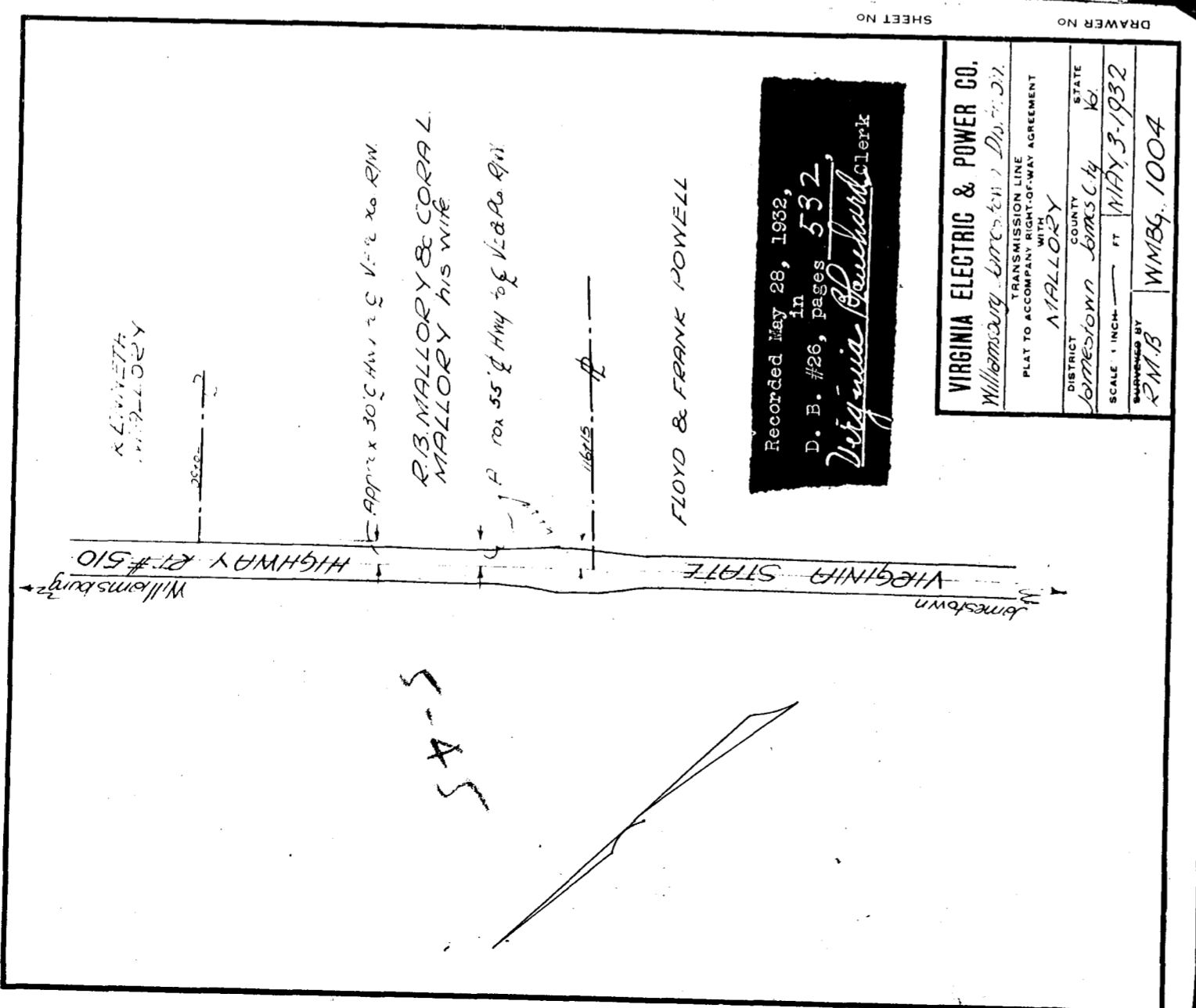

Recorded May 28, 1932,
in
D. B. #26, pages 532
Virginia Blanchard, Clerk

VIRGINIA ELECTRIC & POWER CO.
Williamsburg-Jamestown Distr.
TRANSMISSION LINE
PLAT TO ACCOMPANY RIGHT-OF-WAY AGREEMENT
WITH
MALLORY
DISTRICT JAMES TOWN COUNTY JAMES CITY STATE VIRGINIA
SCALE 1 INCH = 100 FT. MAY 3, 1932
SURVEYED BY E.B.H. WMBG #1004

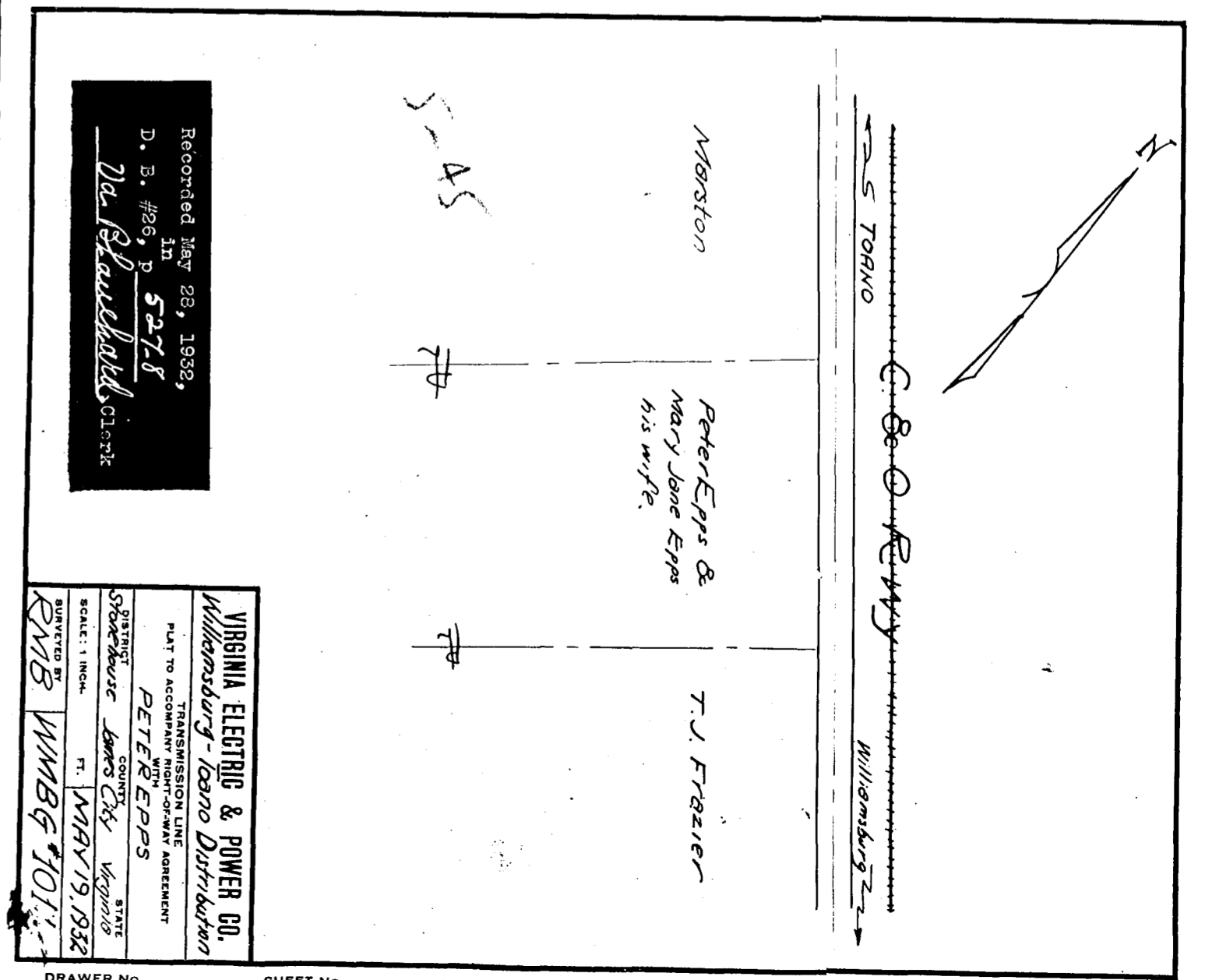

Recorded May 28, 1932,
in
D. B. #26, p 527-8
Va. Blanchard, Clerk

VIRGINIA ELECTRIC & POWER CO.
Williamsburg-Jamestown Distribution
TRANSMISSION LINE
PLAT TO ACCOMPANY RIGHT-OF-WAY AGREEMENT
WITH
PETER EPPS
DISTRICT JAMES TOWN COUNTY JAMES CITY STATE VIRGINIA
SCALE 1 INCH = 100 FT. MAY 19, 1932
SURVEYED BY E.B.H. WMBG #1011

