

CAPITOL HEIGHTS WILLIAMSBURG - VA.

PROPERTY OF
FRANK G. LINEKIN
WILLIAMSBURG, VA.

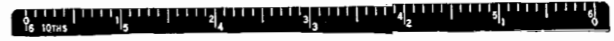

Plat recorded June 24, 1930,
Virginia Blanchard, Clerk

BOLTON-CLARKE & PRATT-INC.
CIVIL ENGINEERS AND SURVEYORS
WILLIAMSBURG RICHMOND.

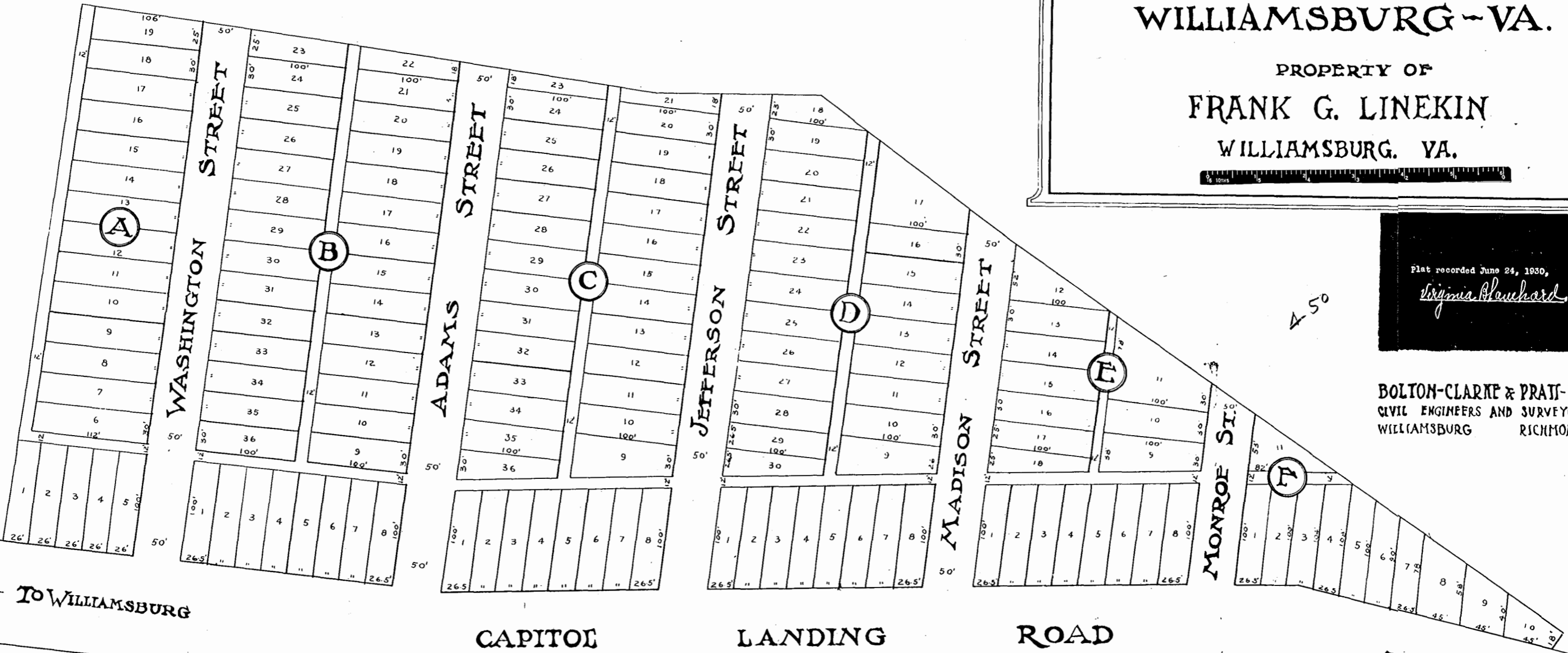

100.0' ← TO WILLIAMSBURG

CAPITOL LANDING ROAD

TO YORK RIVER →

NOTE: STREETS ARE 50 FEET WIDE
ALLEYS ARE 12 FEET WIDE

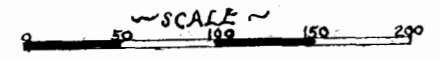

TRACED FROM ORIGINAL COPY
JUNE 24, 1930
V.D. McMANUS
CERTIFIED SURVEYOR FOR
WILLIAMSBURG, VA.
M.F.