

VIRGINIA ELECTRIC & POWER CO.
Proposed Line
TRANSMISSION LINE
PLAT TO ACCOMPANY RIGHT-OF-WAY AGREEMENT
WITH
Mrs. L. W. Cottrell
DISTRICT COUNTY STATE
Powhatan James City Va
SCALE: 1" = None' 6-27-29
SURVEYED BY: Wbg. T. P. No. 41

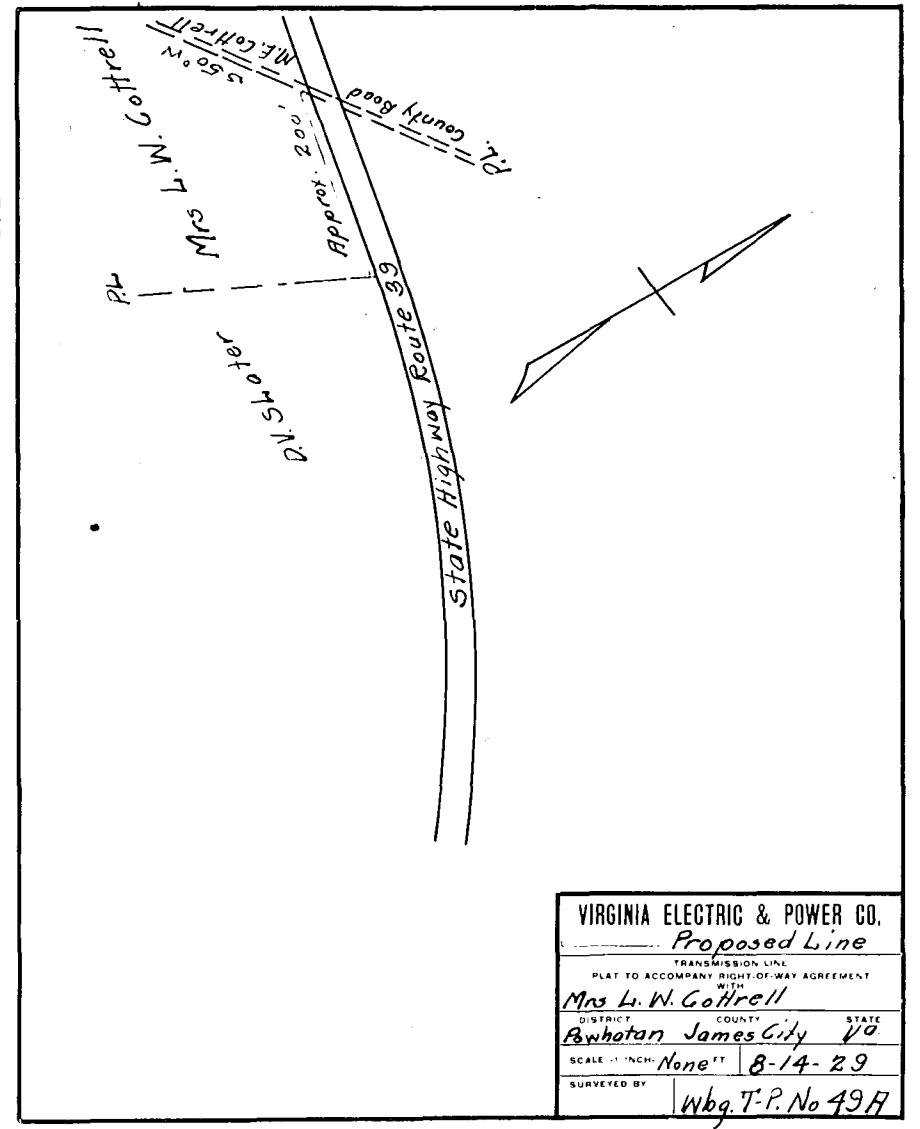

VIRGINIA ELECTRIC & POWER CO.
Proposed Line
TRANSMISSION LINE
PLAT TO ACCOMPANY RIGHT-OF-WAY AGREEMENT
WITH
Mrs. L. W. Cottrell
DISTRICT COUNTY STATE
Powhatan James City Va
SCALE: 1" = None' 8-14-29
SURVEYED BY: Wbg. T. P. No. 49A

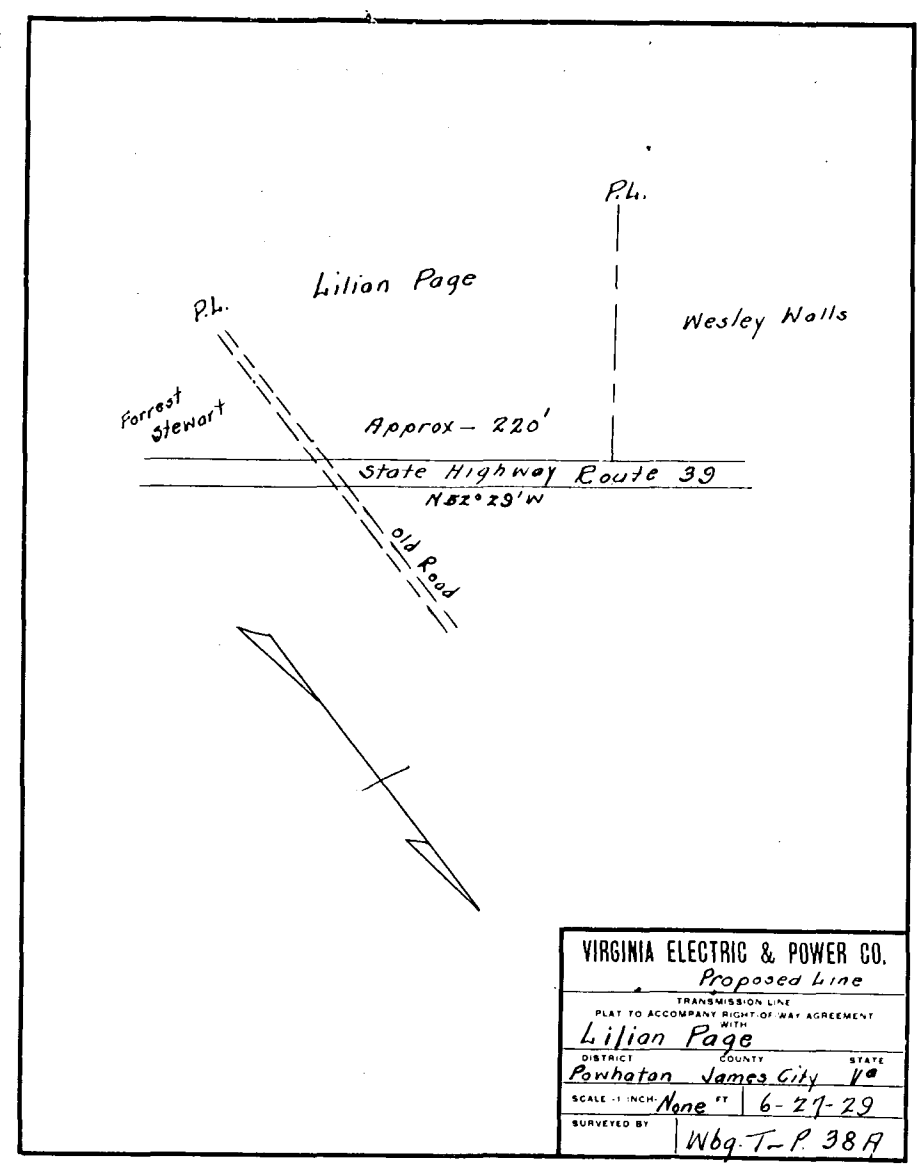

VIRGINIA ELECTRIC & POWER CO.
Proposed Line
TRANSMISSION LINE
PLAT TO ACCOMPANY RIGHT-OF-WAY AGREEMENT
WITH
Lilian Page
DISTRICT COUNTY STATE
Powhatan James City Va
SCALE: 1" = None' 6-27-29
SURVEYED BY: Wbg. T. P. No. 38A

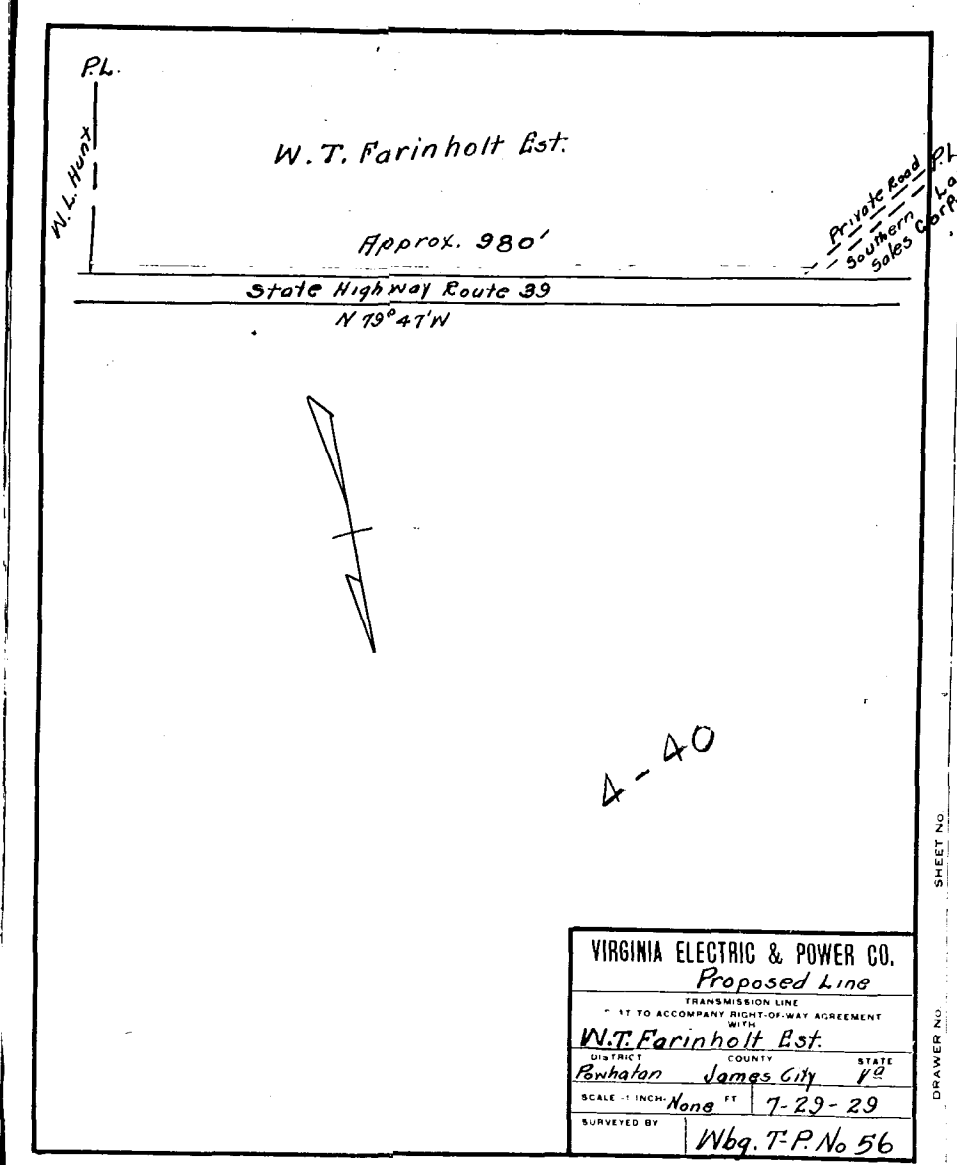

VIRGINIA ELECTRIC & POWER CO.
Proposed Line
TRANSMISSION LINE
PLAT TO ACCOMPANY RIGHT-OF-WAY AGREEMENT
WITH
W. T. Farinholt Est.
DISTRICT COUNTY STATE
Powhatan James City Va
SCALE: 1" = None' 7-29-29
SURVEYED BY: Wbg. T. P. No. 56

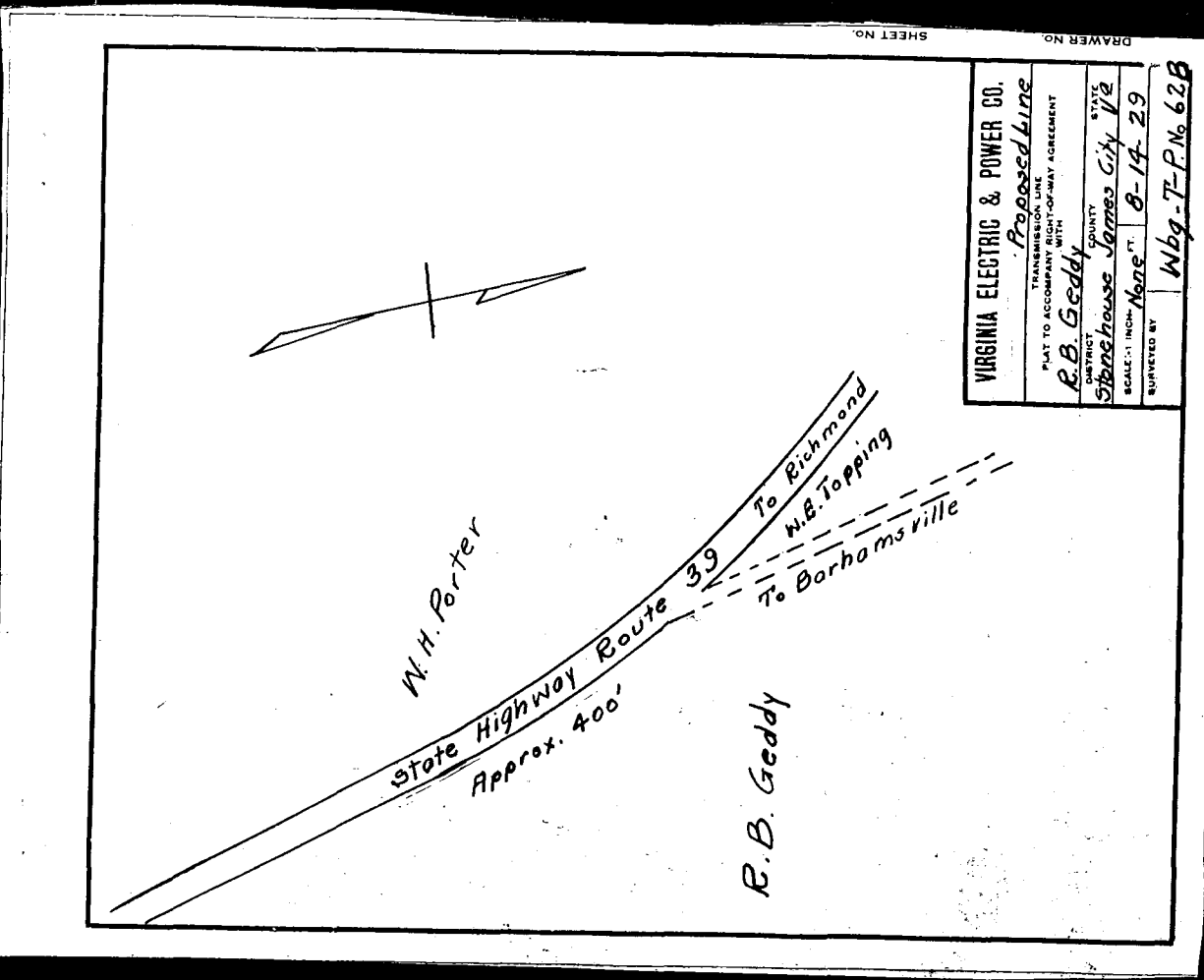

VIRGINIA ELECTRIC & POWER CO.
Proposed Line
TRANSMISSION LINE
PLAT TO ACCOMPANY RIGHT-OF-WAY AGREEMENT
WITH
R. B. Geddy
DISTRICT COUNTY STATE
Stanhouse James City Va
SCALE: 1" = None' 8-14-29
SURVEYED BY: Wbg. T. P. No. 62B

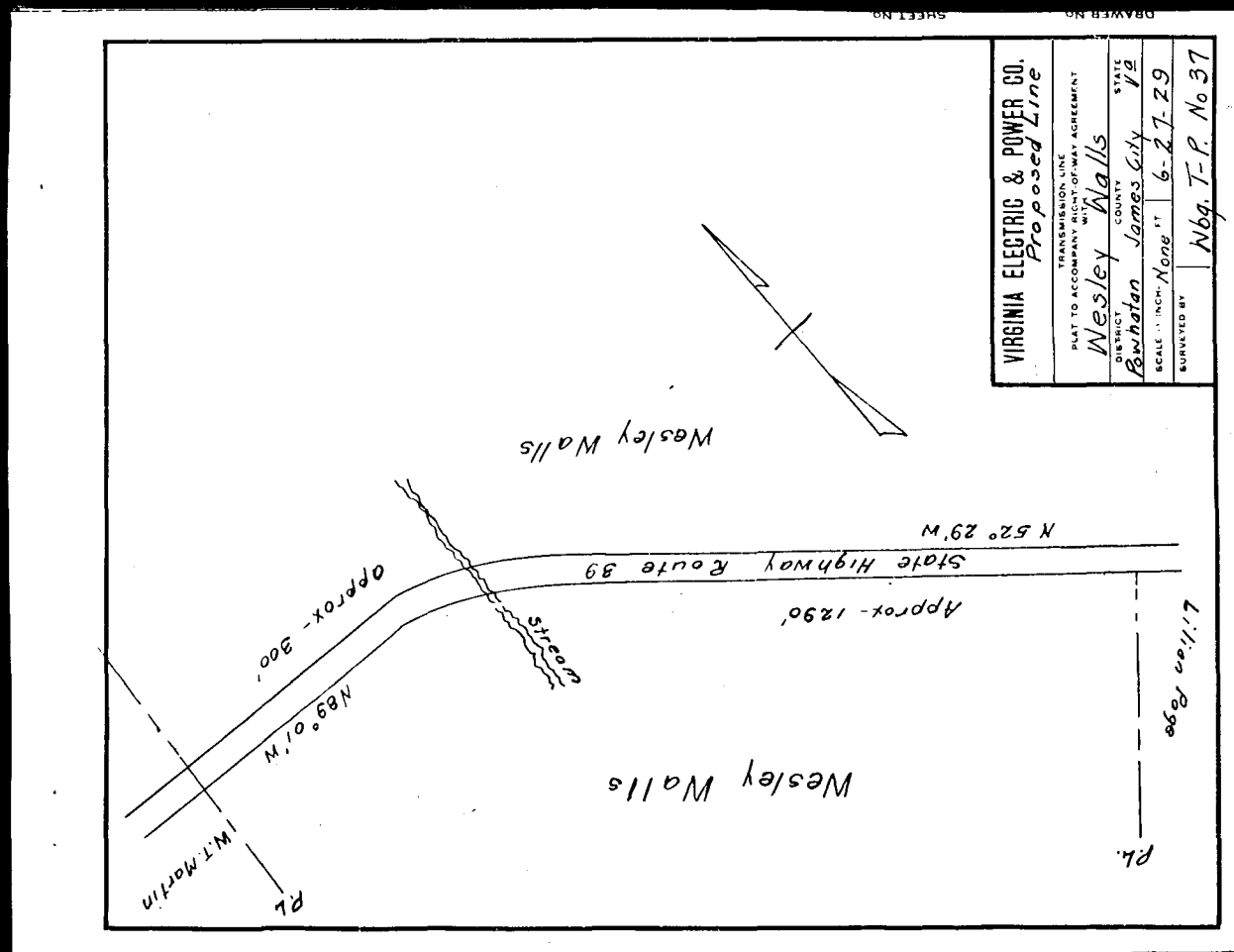

VIRGINIA ELECTRIC & POWER CO.
Proposed Line
TRANSMISSION LINE
PLAT TO ACCOMPANY RIGHT-OF-WAY AGREEMENT
WITH
Wesley Walls
DISTRICT COUNTY STATE
Powhatan James City Va
SCALE: 1" = None' 6-27-29
SURVEYED BY: Wbg. T. P. No. 37

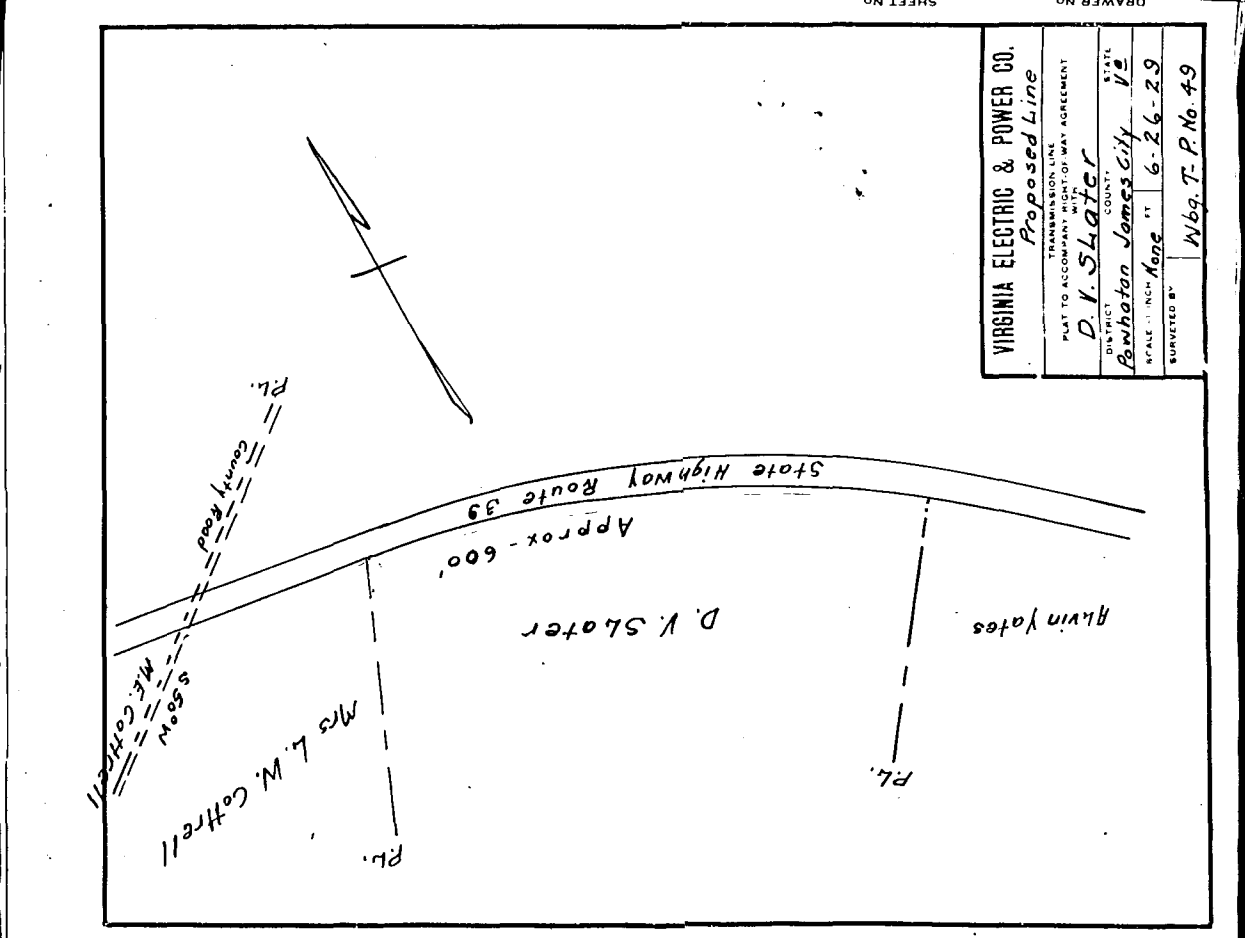

VIRGINIA ELECTRIC & POWER CO.
Proposed Line
TRANSMISSION LINE
PLAT TO ACCOMPANY RIGHT-OF-WAY AGREEMENT
WITH
D. V. Slater
DISTRICT COUNTY STATE
Powhatan James City Va
SCALE: 1" = None' 6-26-29
SURVEYED BY: Wbg. T. P. No. 49