

VIRGINIA ELECTRIC & POWER CO.  
 WILLIAMSBURG - TOANO  
 TRANSMISSION LINE  
 PLAT TO ACCOMPANY RIGHT-OF-WAY AGREEMENT  
 WITH  
 C S WILLIS  
 DISTRICT COUNTY STATE  
 JAMESTOWN JAMES CITY VA.  
 5-17-26  
 SURVEYED BY  
 F.P.LYELL W-T-1926-13

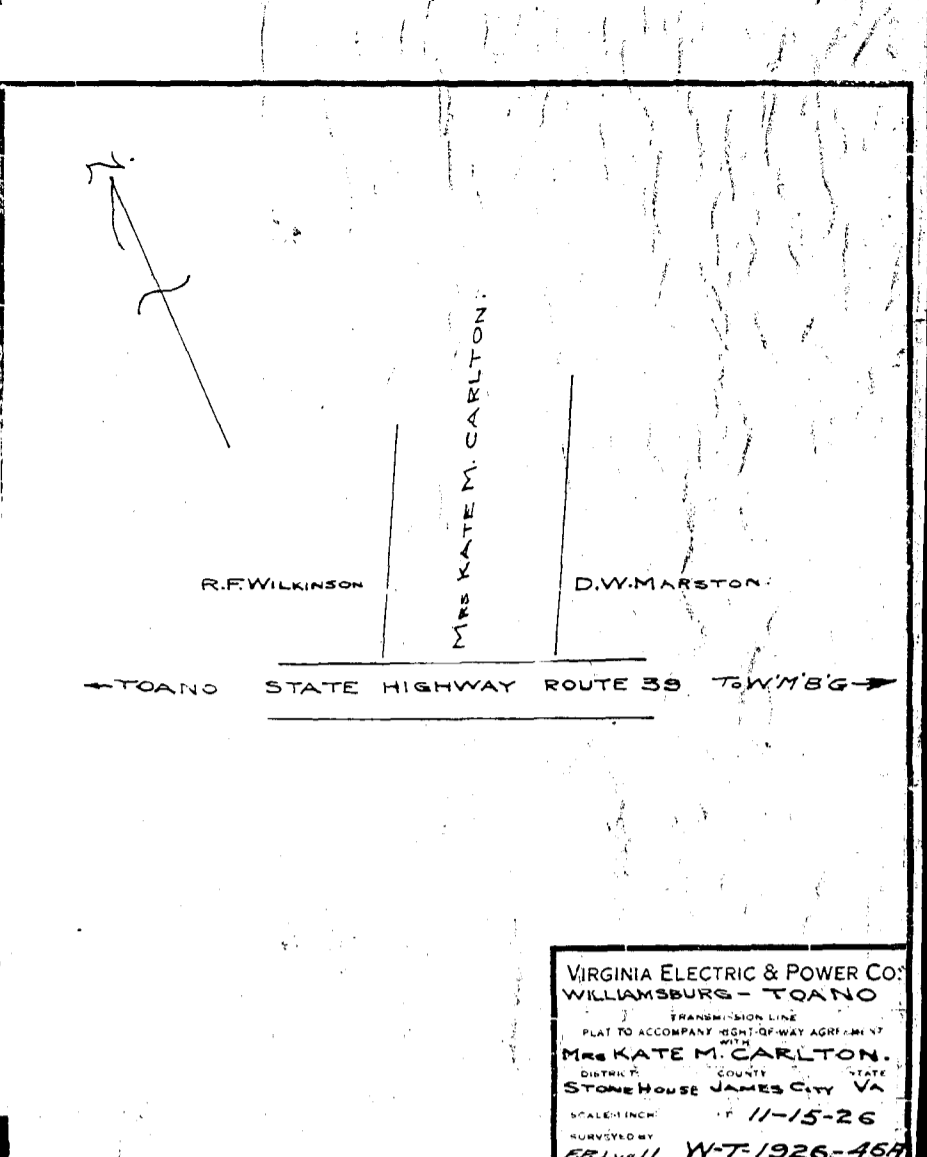

VIRGINIA ELECTRIC & POWER CO.  
 WILLIAMSBURG - TOANO  
 TRANSMISSION LINE  
 PLAT TO ACCOMPANY RIGHT-OF-WAY AGREEMENT  
 WITH  
 Mrs KATE M. CARLTON.  
 DISTRICT COUNTY STATE  
 Stone House JAMES CITY VA.  
 SCALE: 1 INCH = 11-15-26  
 SURVEYED BY  
 F.P.LYELL W-T-1926-45A

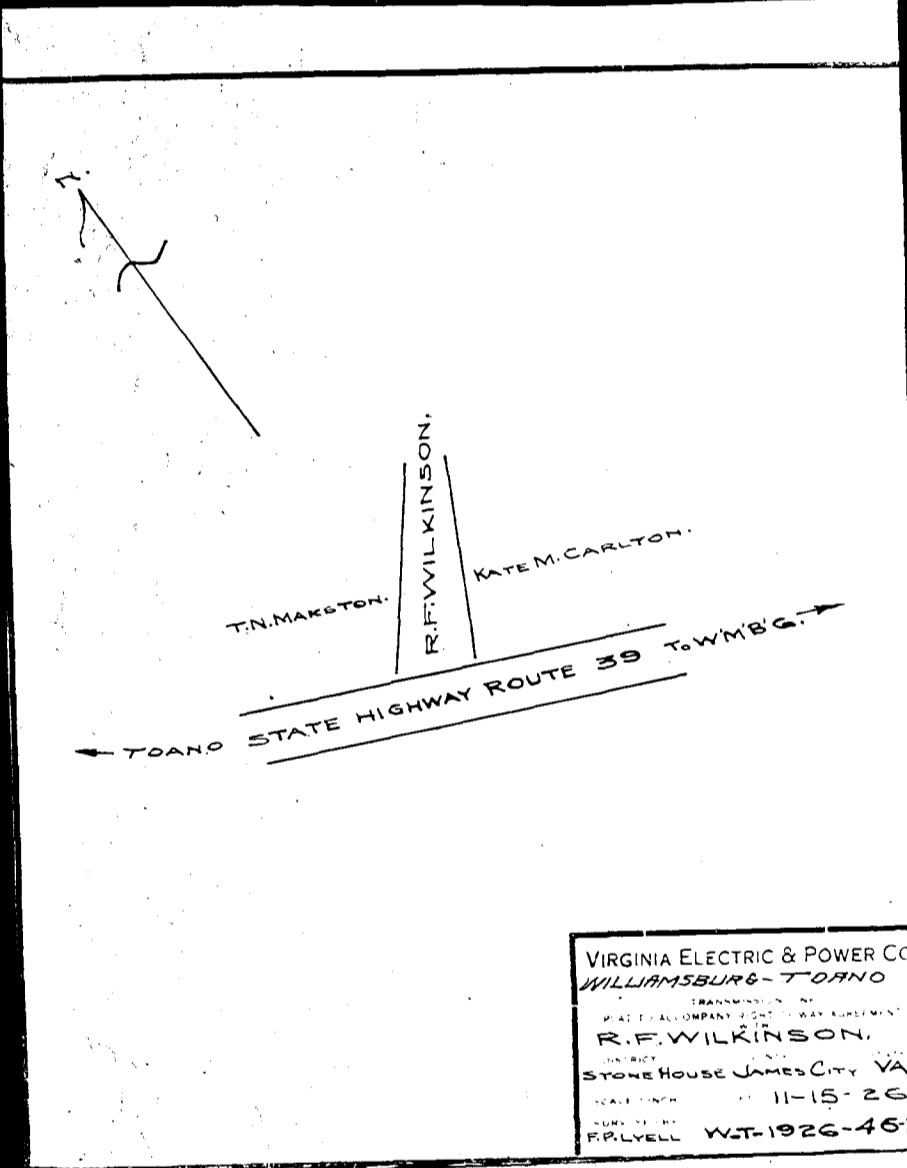

VIRGINIA ELECTRIC & POWER CO.  
 WILLIAMSBURG - TOANO  
 TRANSMISSION LINE  
 PLAT TO ACCOMPANY RIGHT-OF-WAY AGREEMENT  
 WITH  
 R.F. WILKINSON.  
 DISTRICT COUNTY STATE  
 Stone House JAMES CITY VA.  
 11-15-26  
 SURVEYED BY  
 F.P.LYELL W-T-1926-45B

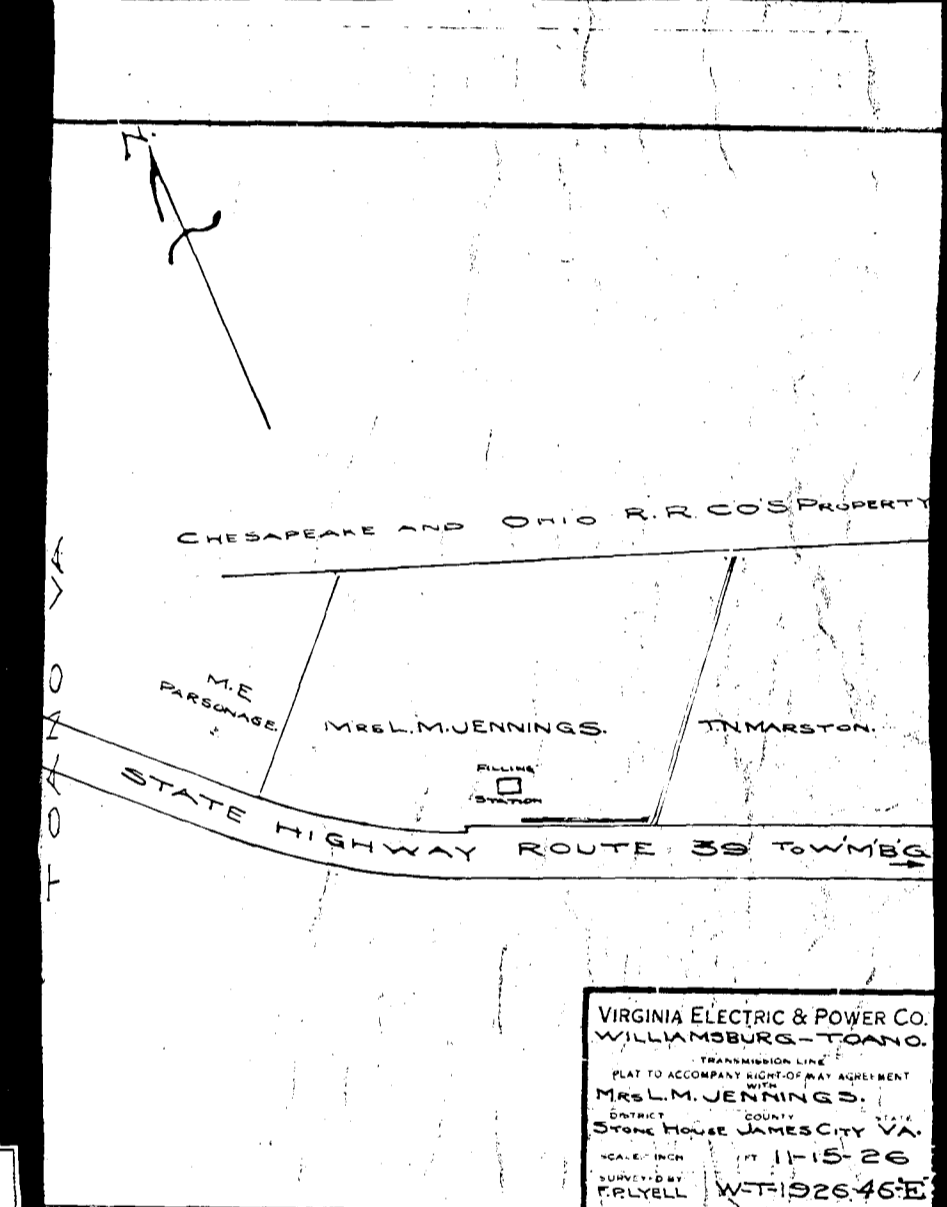

VIRGINIA ELECTRIC & POWER CO.  
 WILLIAMSBURG - TOANO.  
 TRANSMISSION LINE  
 PLAT TO ACCOMPANY RIGHT-OF-WAY AGREEMENT  
 WITH  
 Mrs L.M. JENNINGS.  
 DISTRICT COUNTY STATE  
 Stone House JAMES CITY VA.  
 SCALE: 1 INCH = 11-15-26  
 SURVEYED BY  
 F.P.LYELL W-T-1926-46E

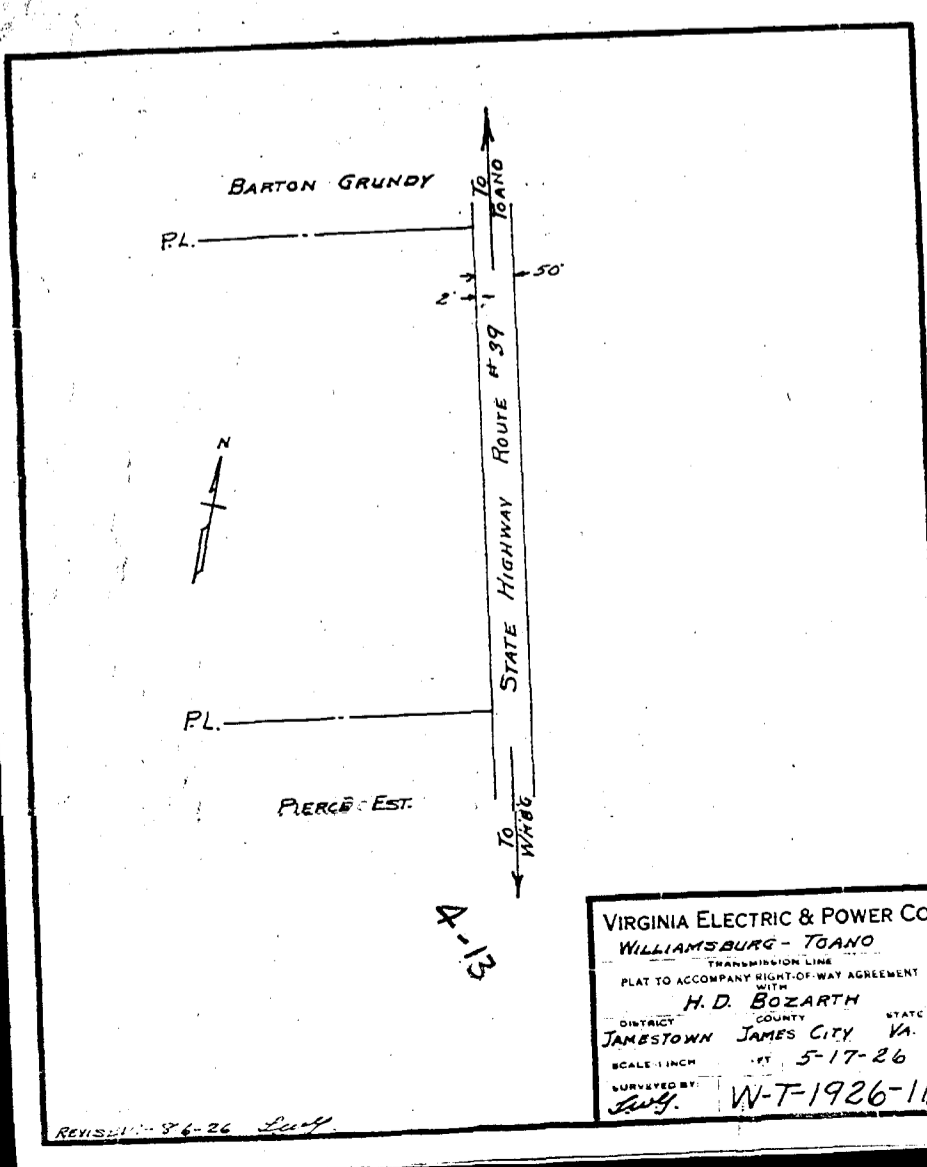

VIRGINIA ELECTRIC & POWER CO.  
 WILLIAMSBURG - TOANO  
 TRANSMISSION LINE  
 PLAT TO ACCOMPANY RIGHT-OF-WAY AGREEMENT  
 WITH  
 H. D. BOZARTH  
 DISTRICT COUNTY STATE  
 JAMESTOWN JAMES CITY VA.  
 5-17-26  
 SURVEYED BY  
 F.P.LYELL W-T-1926-1X

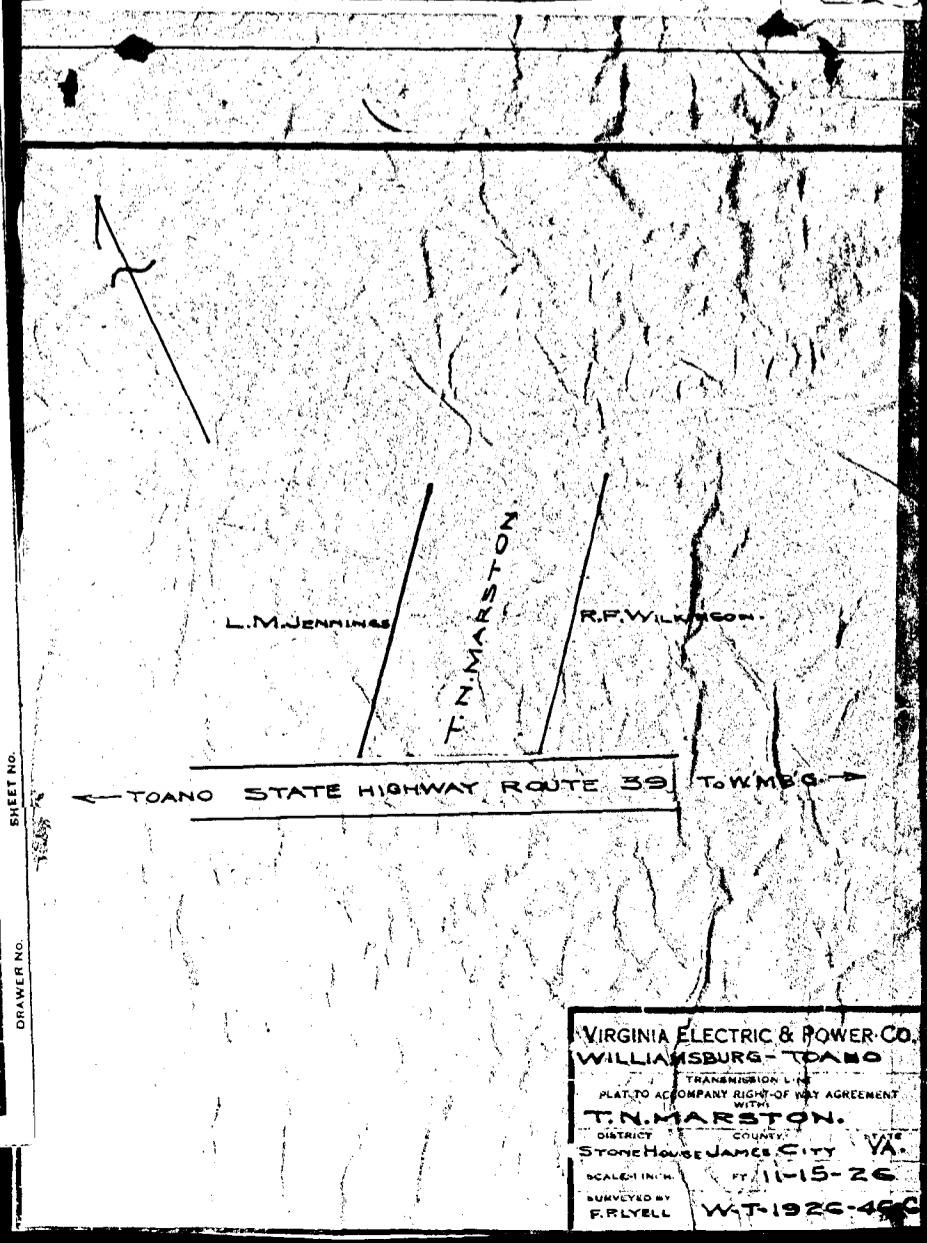

VIRGINIA ELECTRIC & POWER CO.  
 WILLIAMSBURG - TOANO  
 TRANSMISSION LINE  
 PLAT TO ACCOMPANY RIGHT-OF-WAY AGREEMENT  
 WITH  
 T.N. MARSTON.  
 DISTRICT COUNTY STATE  
 Stone House JAMES CITY VA.  
 SCALE: 1 INCH = 11-15-26  
 SURVEYED BY  
 F.P.LYELL W-T-1926-46C