

Stephens Tract #2
 J.W. Rickett - owner
 Scale 1" = 50'
 Total Area = 13.6 Acres
 Surveyed & Plotted by
 J.W. Rickett & Co.
 1926
 James City County
 Southhouse District
 Recorded June 10, 1926 -
 Original Plat Book
 of Newport News

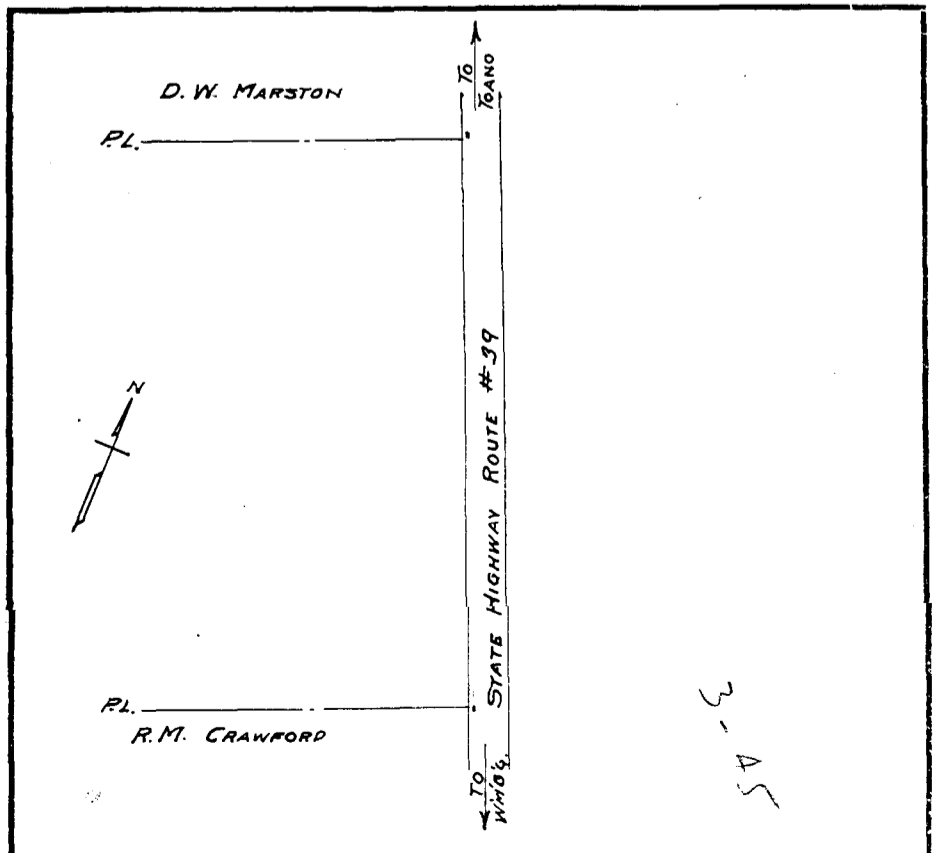

VIRGINIA ELECTRIC & POWER CO.
 WILLIAMSBURG - TOANO
 PLAT TO ACCOMPANY RIGHT-OF-WAY AGREEMENT
 WITH
J. W. MOORE
 JAMESTOWN JAMES CITY VA.
 5-17-26
 Plat. W-T-1926-18

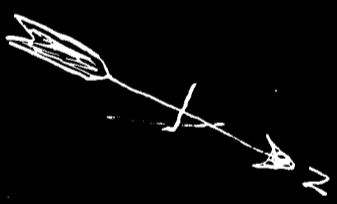
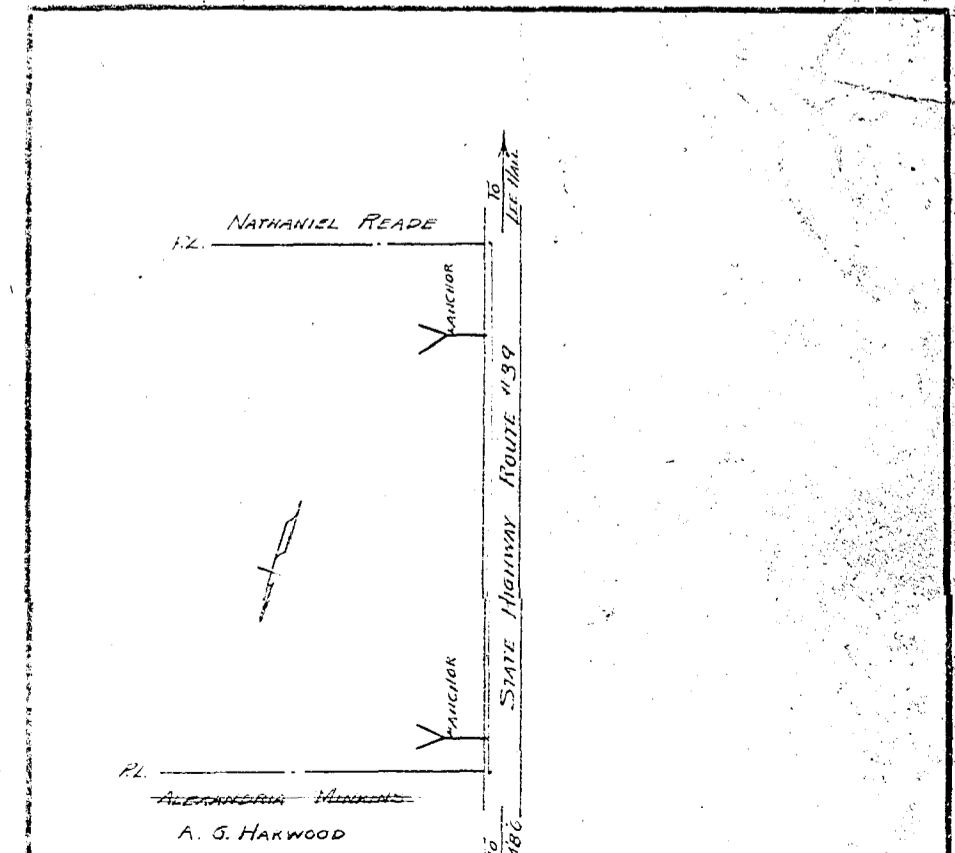

VIRGINIA ELECTRIC & POWER CO.
 WILLIAMSBURG - YORKTOWN
 PLAT TO ACCOMPANY RIGHT-OF-WAY AGREEMENT
 WITH
HARRISON MINKINS
 JAMESTOWN JAMES CITY VA.
 6-29-26
 Plat. W-Y-1926-29-F

SHEET NO. DRAWER NO.