

Plat of the land  
belonging to  
Floyd Powell -  
Williamsburg Va.  
Scale 25" = 100'

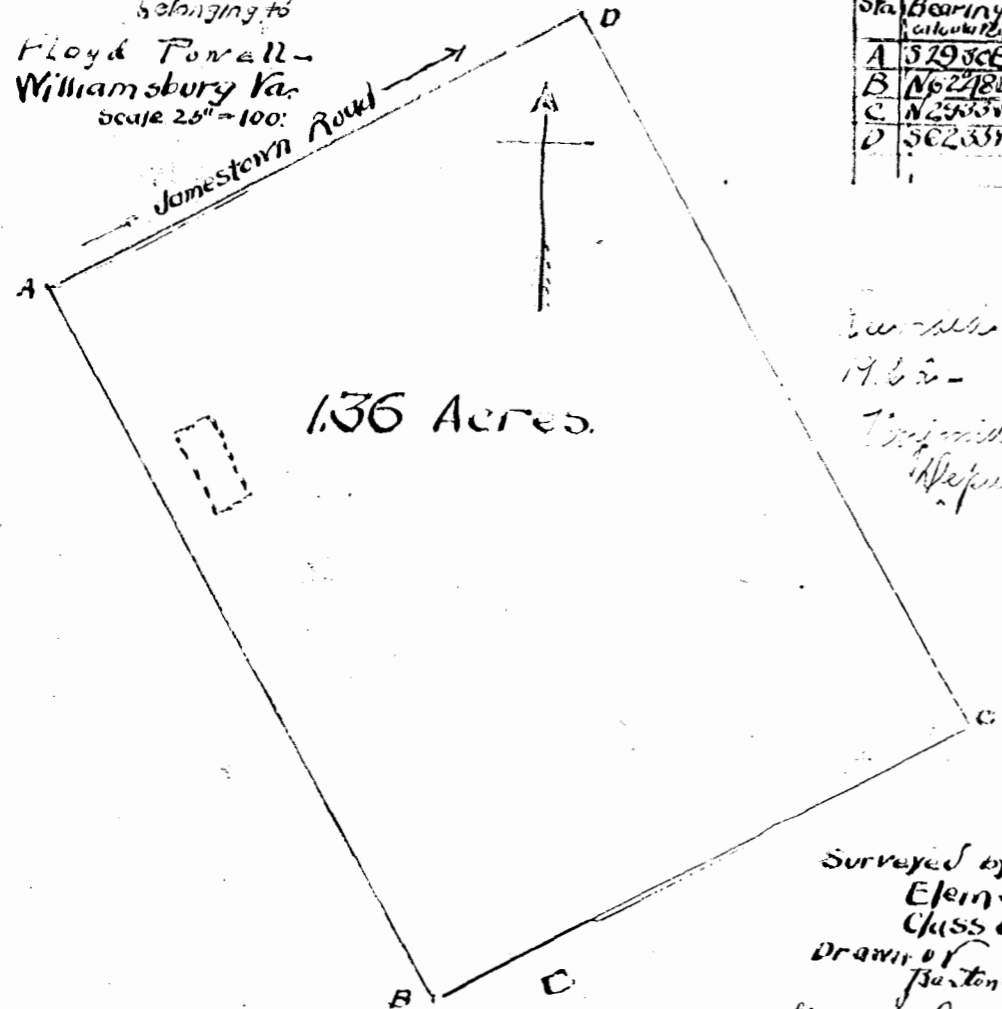

Sta	Bearing calculated	Dist 100'
A	S 29° 30' E	282.4
B	N 62° 18' E	210.3
C	N 25° 33' W	282.4
D	S 62° 33' W	210.3

Surveyed and Plat  
19.6.22 -  
Virginia, Staunton  
Deputy Clerk

Surveyed by  
Elin Surveying  
Class of W.M.C.  
Drawn by  
Barton W. Parkers  
OK J.P. Counselman

1 acre = 4356 sq ft

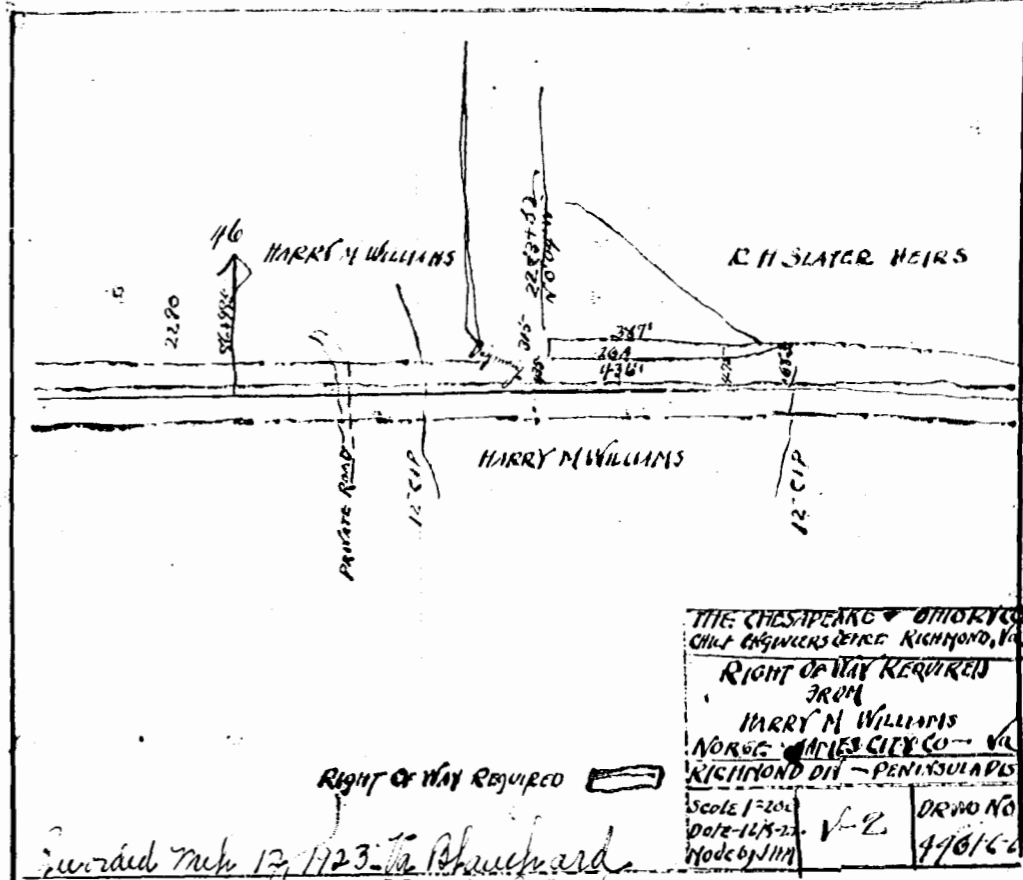

THE CHESAPEAKE & OTTOMYCO  
CIVIL ENGINEERS OFFICE RICHMOND, VA.  
RIGHT OF WAY REQUIRED  
FROM  
HARRY M WILLIAMS  
NORFOLK & SOUTHERN CO. - VA.  
RICHMOND DIV. - PENINSULAR DIV.  
Scale 1" = 200'  
DATE 12/15/22  
Made by JHM  
DRAWN NO  
440164

Recorded Feb 17, 1923 - to the Recorder  
Deputy Clerk

3-18