

BEGIN BOOK TWO

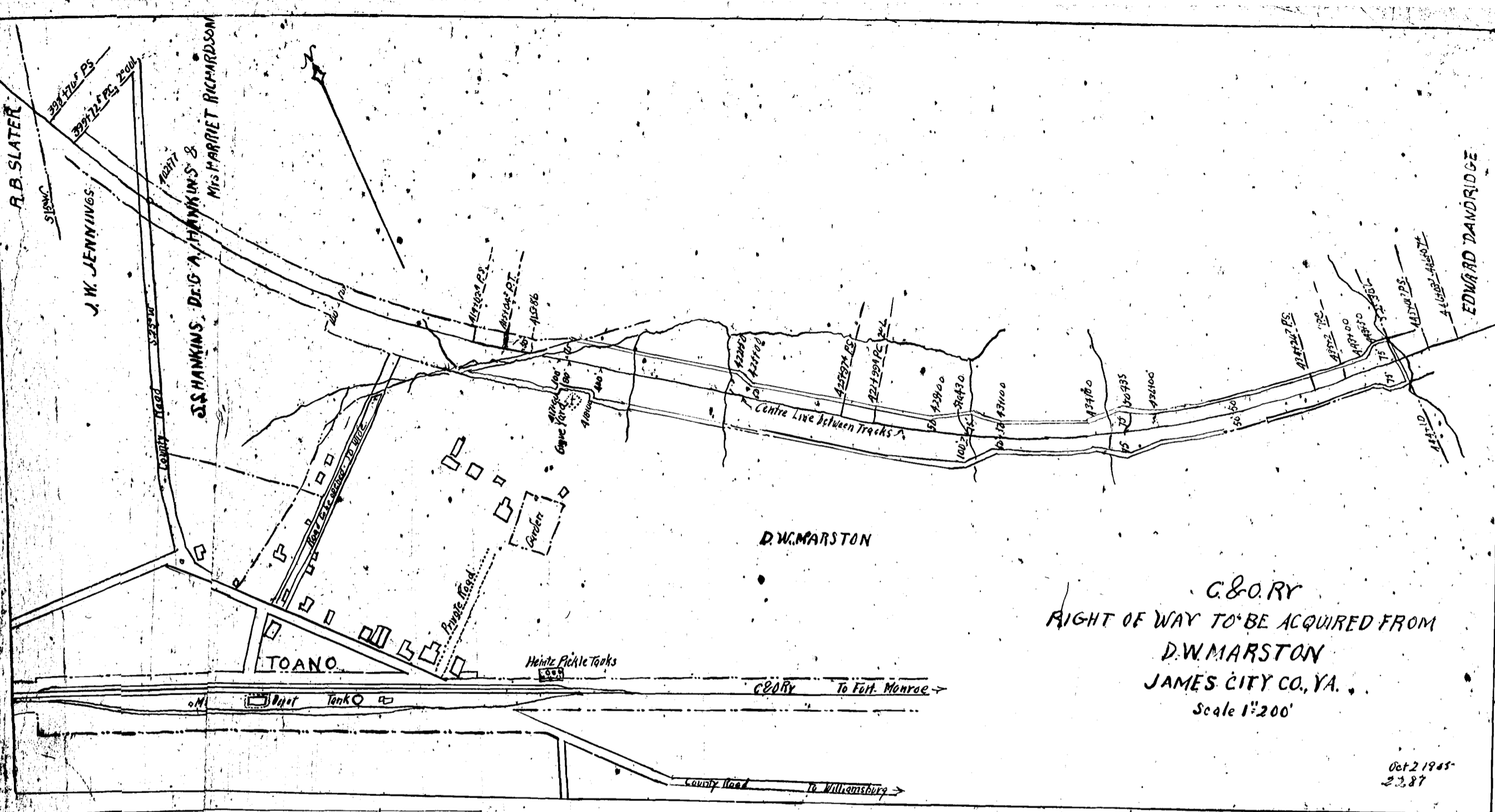

C&O.R.R.
RIGHT OF WAY TO BE ACQUIRED FROM
D.W. MARSTON
JAMES CITY CO., VA.
Scale 1"=200'

Oct 2 1945
2387

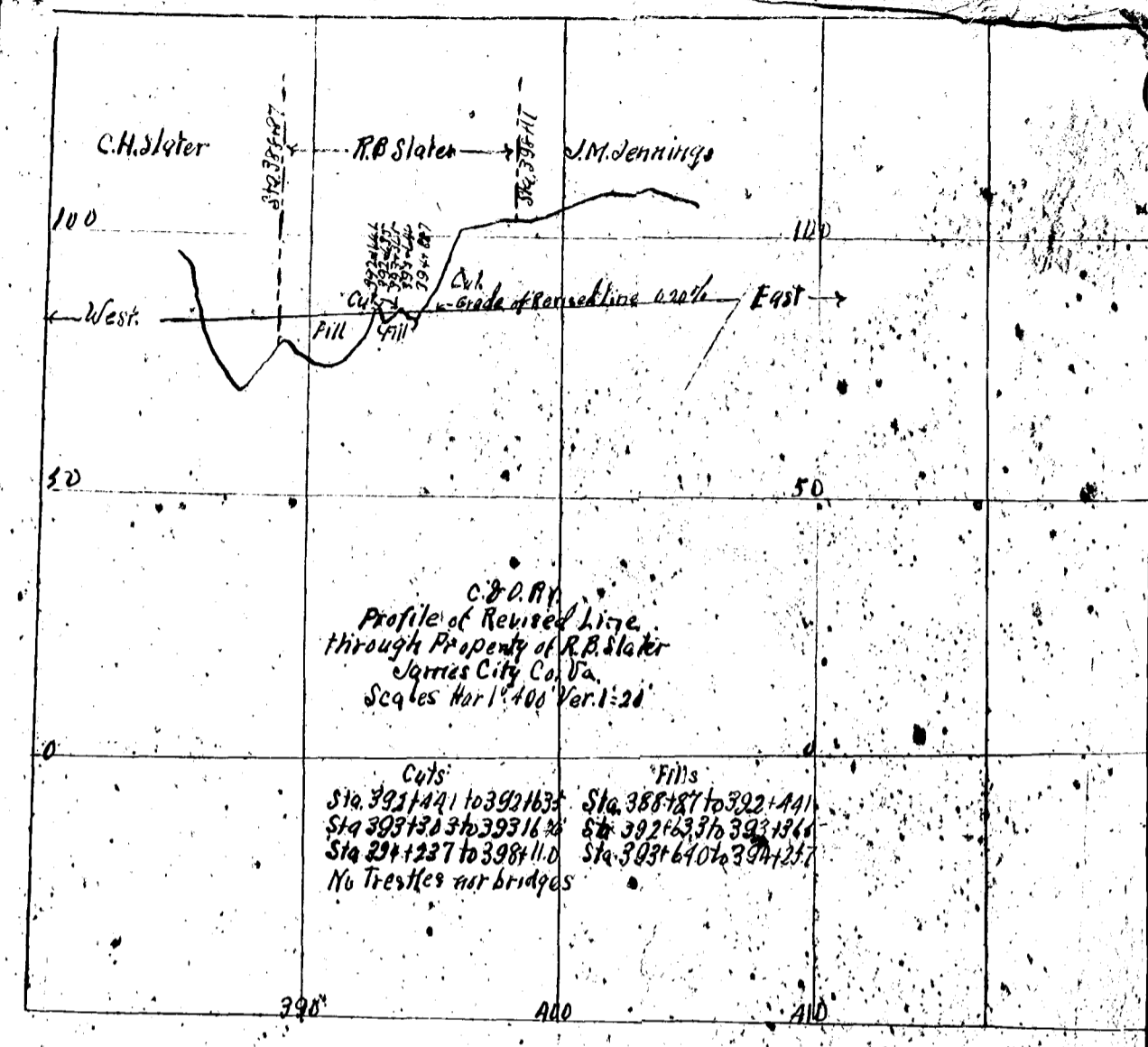

C&O.R.R.
Profile of Revised Line
through Property of R.B. Slater
James City Co., Va.
Scale Mar 1940 Ver. 1:20

Cuts
Sta. 391+421 to 392+163
Sta. 393+176 to 393+176
Sta. 394+227 to 398+110
No Trestles nor bridges

Fills
Sta. 388+187 to 392+141
Sta. 392+163 to 393+176
Sta. 393+640 to 394+257

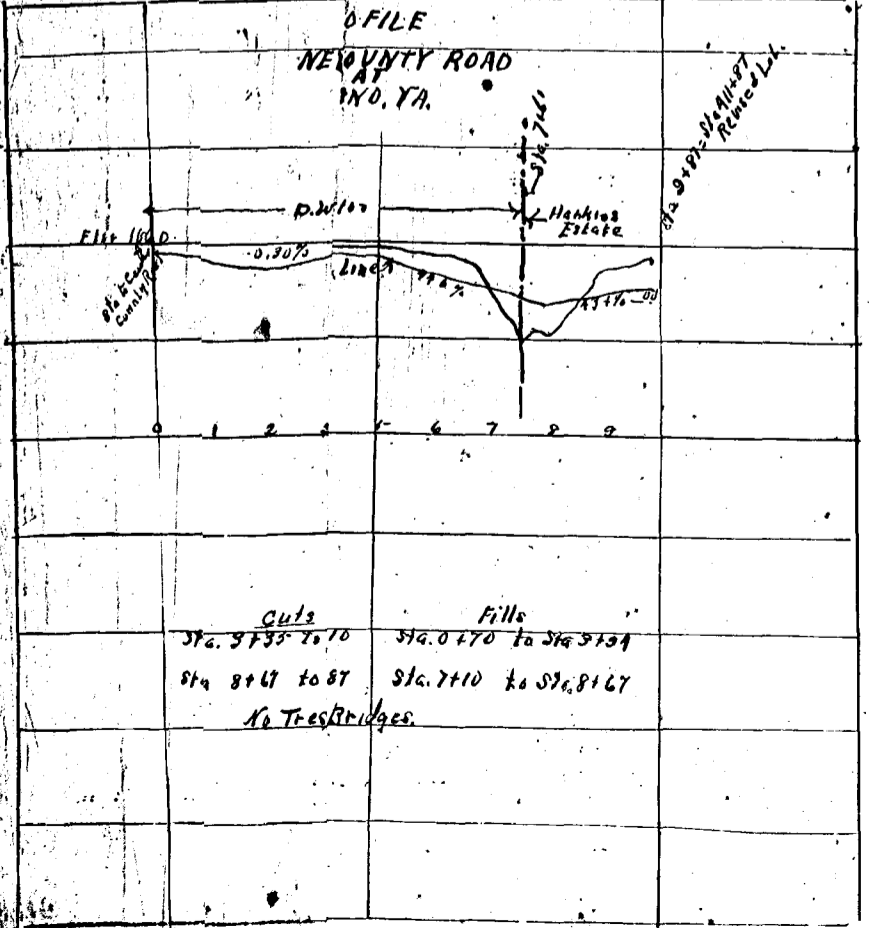

C&O.R.R.
Right of Way to be acquired from
R.B. Slater
James City Co., Va.
Scale 1"=200'

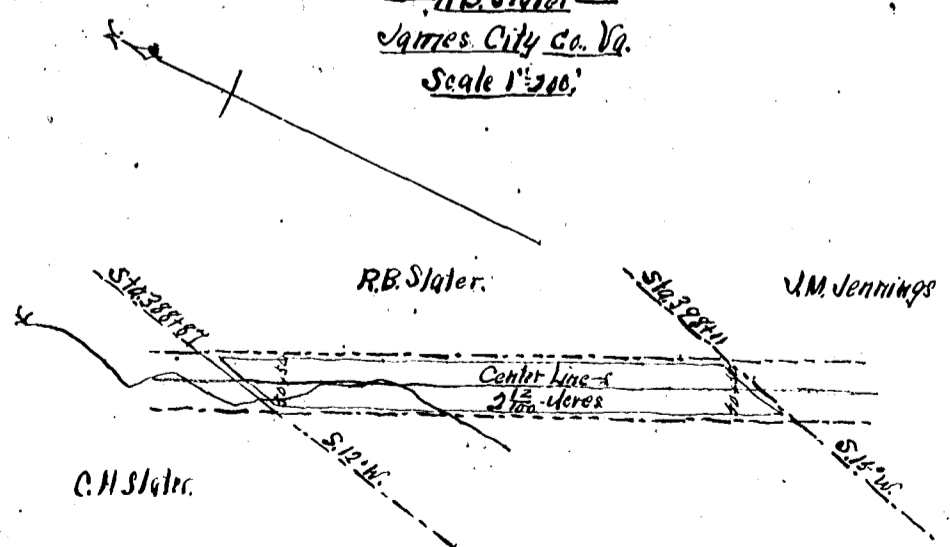

C&O.R.R.
RIGHT OF WAY TO BE ACQUIRED FROM
MRS. M.L. SLATER
JAMES CITY CO., VA.
Scale 1"=200'

