

A Map of part of the
James + Willis tract, surveyed by
F.W. Hammond in 1887,
and added to by Benj. S. Smith,
May, 19 - 1904.

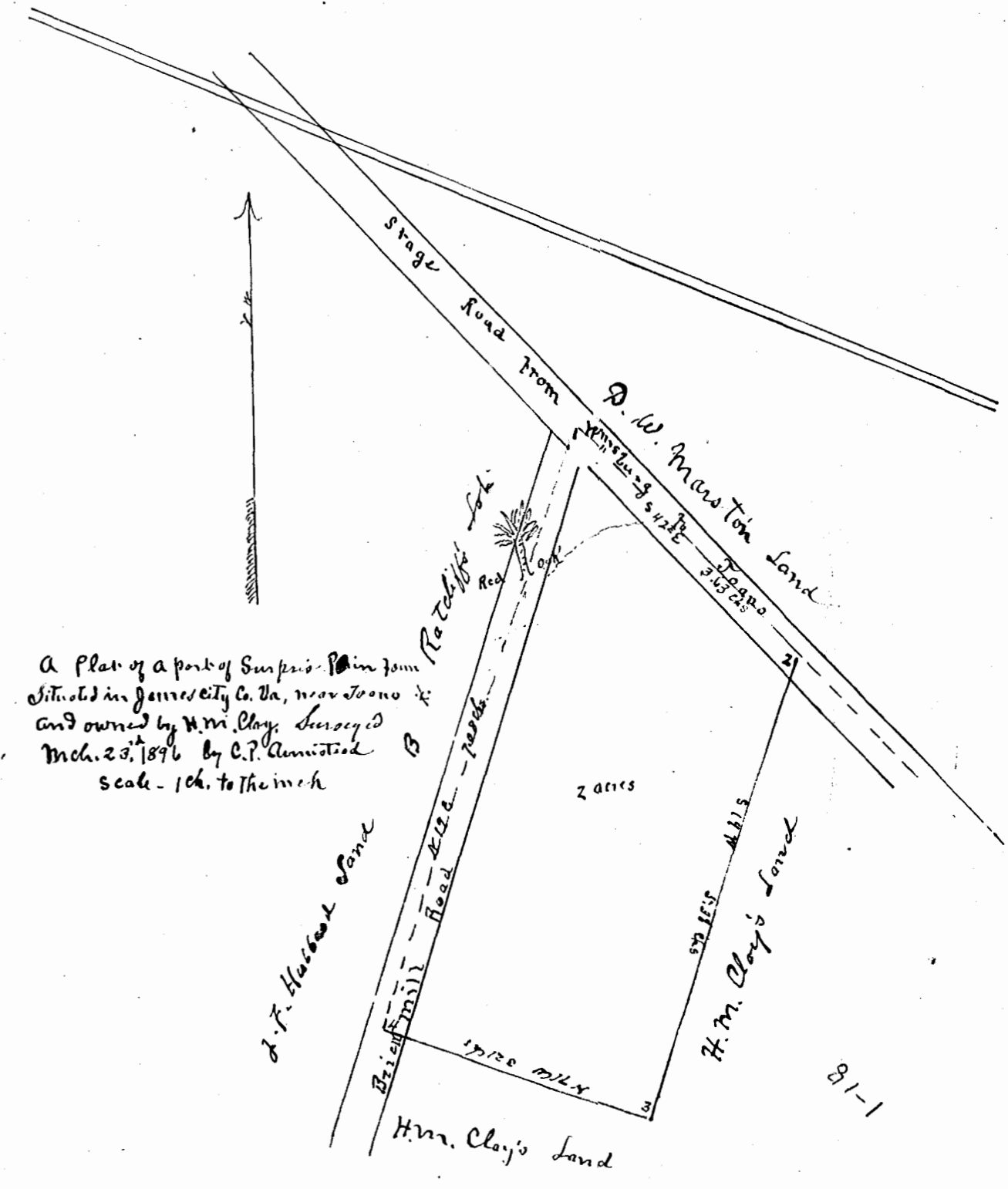

Recorded June 1st with
Rec'd May 29-1904.
Teste
J.H. Gaddy, clerk
See D.P. No 9-p 335-36 for
DEED



A Plat of a part of Surper's Plain farm
situated in James City Co. Va. near Jones
and owned by H.M. Clay, Surveyed
Mch. 23, 1896 by C.F. Amundson
Scale - 1 in. to the inch

Recorded July 2nd 1905.
See D.P. No. 6-page 143

Teste
J.H. Gaddy, clerk

