

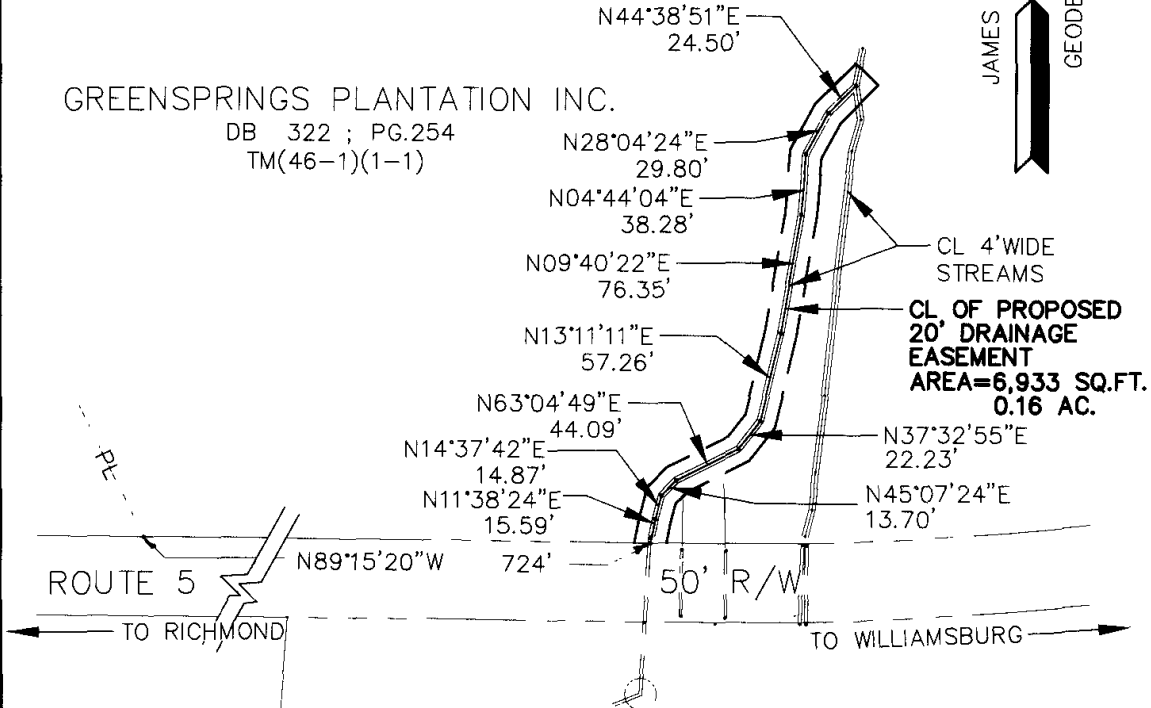

GREENSPRINGS PLANTATION INC.  
 DB 322 ; PG.254  
 TM(46-1)(1-1)



CL 4' WIDE  
 STREAMS  
 CL OF PROPOSED  
 20' DRAINAGE  
 EASEMENT  
 AREA=6,933 SQ.FT.  
 0.16 AC.

ROUTE 5  
 TO RICHMOND

TO WILLIAMSBURG

TM(45-2)(13-1B)

JAMESTOWN BUILDING CORP., INC.  
 DB 626 ; PG.761  
 TM(46-1)(1-2)

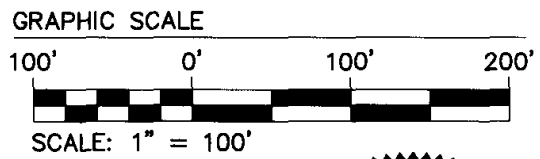

FIELDCREST  
 SUBDIVISION  
 SECTION 4  
 PB 51 ; PG.53

NOTE:  
 PROPERTY LINE INFORMATION SHOWN HEREON  
 IS BASED UPON RECORD INFORMATION AND  
 FOUND MONUMENTATION AND DOES NOT  
 REPRESENT A RESURVEY OF THE BOUNDARY.

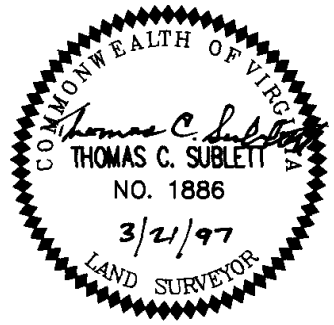

**ES** Consulting Engineers  
 Engineers, Surveyors, Planners

5248 Olde Towne Road, Suite 1  
 Williamsburg, Virginia 23188  
 Ph. (757)-253-0040, Fax (757)-220-8994

PLAT SHOWING 20' DRAINAGE EASEMENT  
 FROM : GREENSPRINGS PLANTATION INC.  
 TO : JAMES CITY COUNTY  
 BERKELEY DISTRICT, JAMES CITY COUNTY, VIRGINIA

Scale: 1"=100'

Ref: PB 54 ; PG.69

Date: 3/21/97

Job No: 7324-P

03 21 97-19 14 73420P1B

TCS