

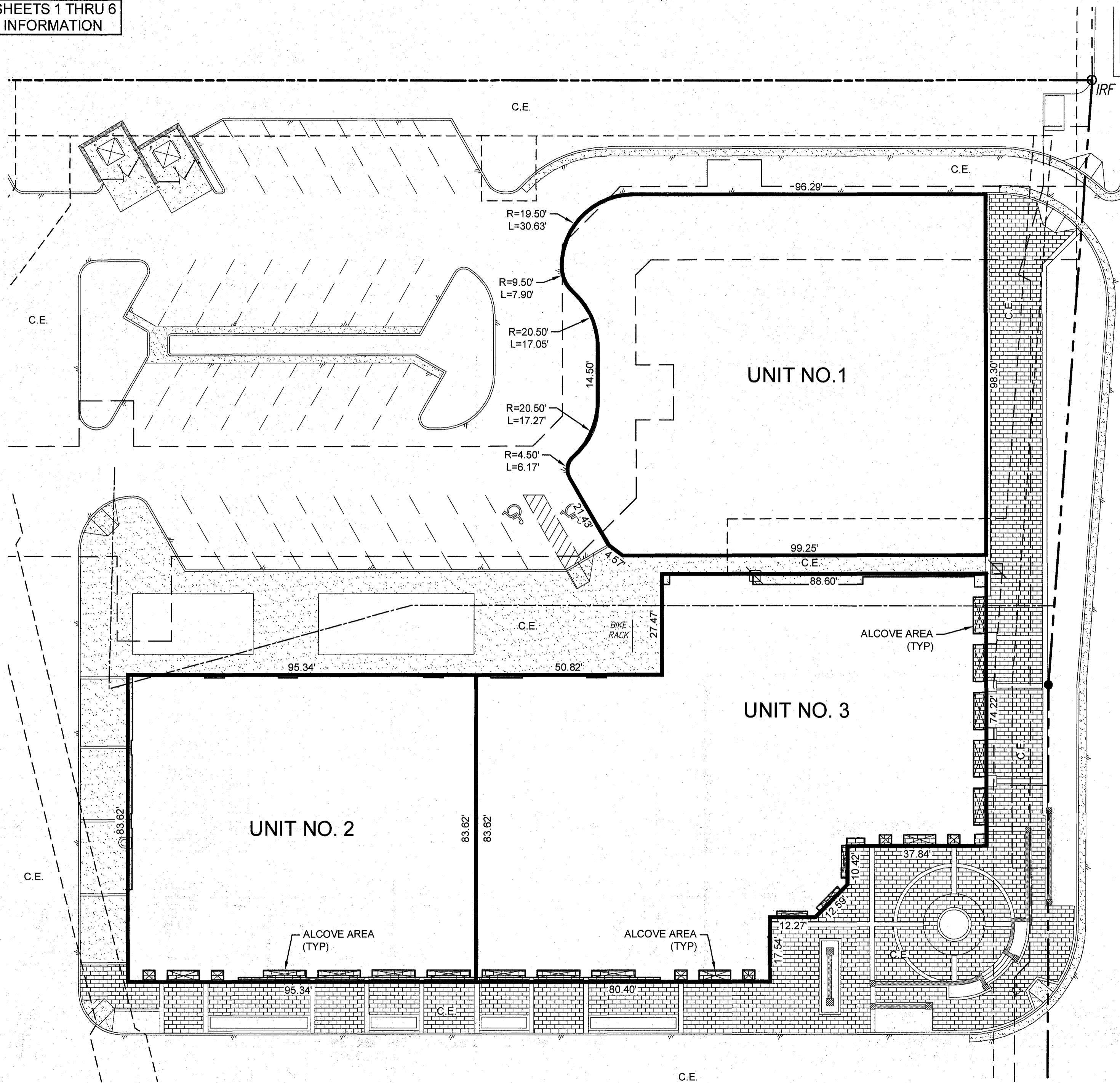

REFER TO SHEETS 1 THRU 6
FOR PLAT INFORMATION

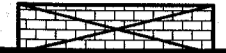
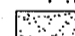

NOTE:
AREAS DESIGNATED AS  ARE RECESSED STOREFRONTS AND ENTRANCE ALCOVES AND ARE PART OF OF UNIT NO. 2 AND PART OF UNIT NO. 3 RESPECTFULLY, HOWEVER THE ASSOCIATION IS RESPONSIBLE FOR MAINTAINING AND REPLACING THE PAVERS IN THE AREAS DESIGNATED AS SUCH.

LEGEND:

- IRF = IRON ROD FOUND
- "P.K." NF = "P.K." NAIL FOUND
-  CONCRETE SURFACE
-  BRICK PAVER SURFACE
- C.E. = COMMON ELEMENT
-  = (L.C.E.) LIMITED COMMON ELEMENT

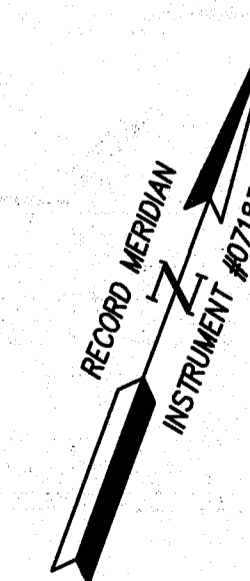
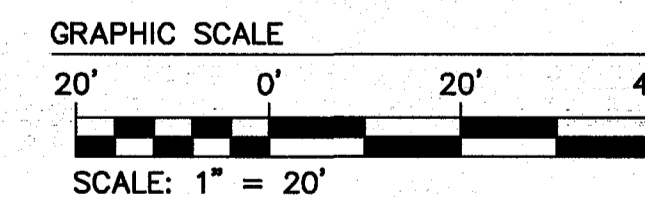

13	Large	Small	Plat(s) Recorded
herewith as #	211058		
Rev.	Date		

City of Williamsburg & County of James City
Circuit Court: This PLAT was recorded on March 29, 2021
at 3:13 AM (PM) PB PG
Document # 211058
MONA A. FOLEY, CLERK
Mona A. Foley Clerk

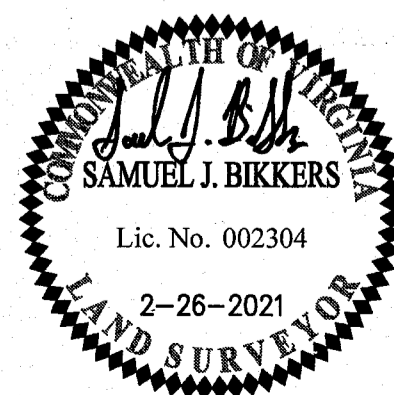

5248 Olde Towne Road, Suite 1
Williamsburg, Virginia 23188
Phone: (757) 253-0040
Fax: (757) 220-8994
www.aesva.com

EXHIBIT D
CONDOMINIUM PLATS SHOWING
SUBMITTED LAND, IMPROVEMENTS AND EXISTING EASEMENTS
HIGH STREET CONDOMINIUM
CITY OF WILLIAMSBURG VIRGINIA

Project Contacts:	SJB / CMA
Project Number:	W10594-00
Scale:	1" = 20'
Date:	02-26-2021
Sheet Number	7 OF 13