

THE FOXES
(50' PRIVATE RW)

N/F
DAVID INGE CLAY &
MARY HARWOOD VAIDEN-CLAY
LOT 11-D
THE FOXES
D.B. 212, PG. 49
P.B. 36, PG. 75
PIN: 4710300014
4572 THE FOXES

N/F
HELFRICH
PIN:
4710300013

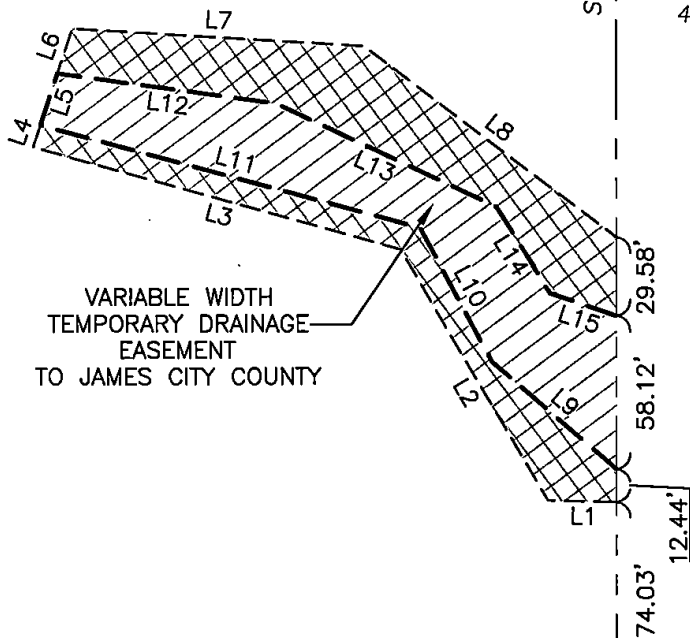
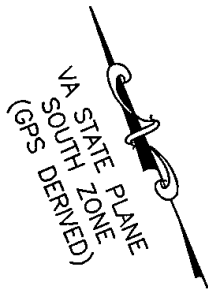

N 67°11'12" W 765.68' (T)

N/F
DAURIA
PIN: 4710500030C

N/F
LEWIS
PIN: 4710500029

N/F
NOWALDY
PIN: 4710500030B

STATE OF VIRGINIA
CITY OF WILLIAMSBURG & COUNTY OF JAMES CITY CIRCUIT COURT.
THIS _____ DAY OF _____, 2018.
THE PLAT SHOWN HEREON WAS PRESENTED AND ADMITTED TO
THE RECORD AS THE LAW DIRECTS AT _____ AM/PM
INSTRUMENT # _____

TESTE: _____ IRF = IRON ROD FOUND
MONA A. FOLEY, CLERK SHEET 1 OF 2 (T) = TOTAL

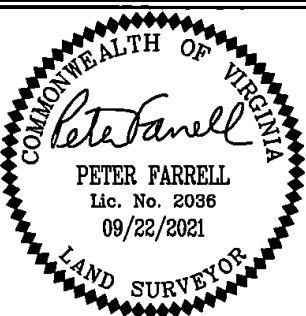

REFERENCES:
P.B. 36, PG. 75
REVISED 9/22/21
DATE: 06/04/18
SCALE: 1"=60'
JOB# 18-216
CAD File
18-216.dwg

PLAT SHOWING EASEMENTS TO BE GRANTED TO
JAMES CITY COUNTY
FROM
**DAVID INGE CLAY &
MARY HARWOOD VAIDEN-CLAY**
JAMES CITY COUNTY VIRGINIA

LandTech Resources, Inc.
ENGINEERING & SURVEYING CONSULTANTS
3925 Midlands Road, Williamsburg, Virginia 23188
Telephone: 757-565-1677 Fax: 757-565-0782
Web: landtechresources.com