



PROJECT MANAGER Mr. Wolf Zaman, PE - VDOT Hampton Roads District - (757) 956-3272  
SURVEYED BY, DATE Dewberry Engineers Inc., 03/2020  
DESIGNED BY, Dewberry Engineers Inc. - (804) 205-3340  
SUBSURFACE UTILITY BY, Accumark, 04/2020

		REVISED	STATE	ROUTE	PROJECT	SHEET NO.
		03/24/21 10/21/21	VA.	60	0060-047-627 R-201 C-501	13

DESIGN FEATURES RELATING TO CONSTRUCTION OR TO REGULATION AND CONTROL OF TRAFFIC MAY BE SUBJECT TO CHANGE AS DEEMED NECESSARY BY THE DEPARTMENT

Matthew C. Thomas Dewberry Engineers Inc. Glen Allen, Virginia HYDRAULIC ENGINEER	Date: 2021.10.21 08:06:18 -04'00'	Matthew C. Thomas Dewberry Engineers Inc. Glen Allen, Virginia ROADWAY ENGINEER	Date: 2021.10.21 08:06:32 -04'00'
--	--------------------------------------	--	--------------------------------------

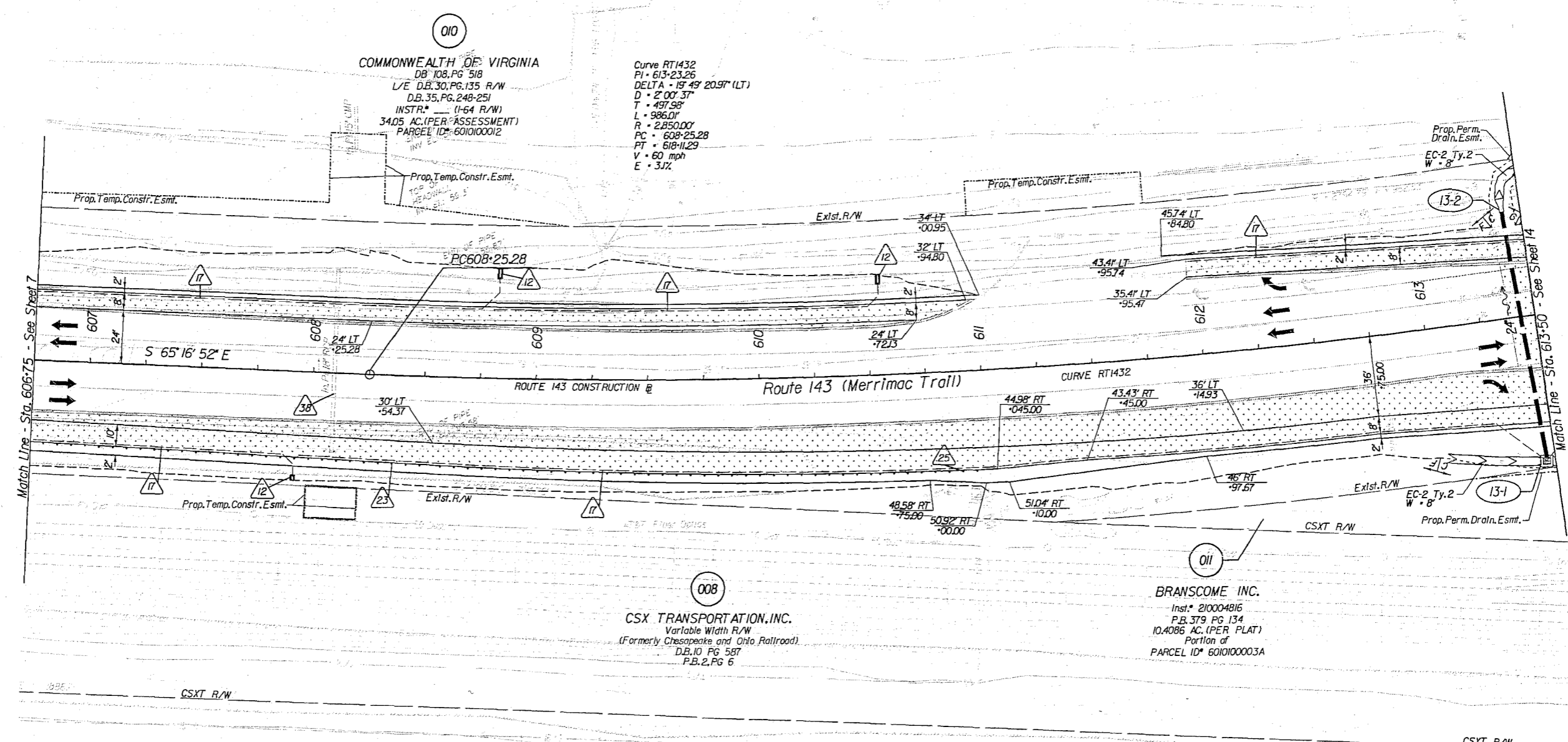

- Key Legend**
- |  |   |  |   |
|--|---|--|---|
| 1 6" Curb, S'd, CG-2 Req'd.              | 12 Underdrain Endwall, S'd, EW-12 Req'd.    | 23 Guardrail, S'd, GR-MGS1 Req'd.                    | 34 Remove Exist. Guardrail                  |
| 2 4" Curb, S'd, CG-3 Req'd.              | 13 Abandon Pipe, S'd, PP-1 Req'd.           | 24 Guardrail, S'd, GR-MGS1A Req'd.                   | 35 Remove Exist. Fence                      |
| 3 6" Curb and Gutter, S'd, CG-6 Req'd.   | 14 Groundwater Underdrain, S'd, UD-1 Req'd. | 25 Guardrail Terminal, S'd, GR-MGS2 Req'd.           | 36 Remove Exist. Structure                  |
| 4 Curb and Gutter, S'd, CG-7 Req'd.      | 15 Median Underdrain, S'd, UD-2 Req'd.      | 26 Guardrail, S'd, GR-10, 3' Height, Type I Req'd.   | 37 Remove Exist. Pipe                       |
| 5 Conc. Raised Median, S'd, MS-1 Req'd.  | 16 Sidewalk Underdrain, S'd, UD-3 Req'd.    | 27 Guardrail, S'd, GR-10, 3' Height, Type II Req'd.  | 38 Abandon and Plug Exist. Pipe             |
| 6 Conc. Raised Median, S'd, MS-1A Req'd. | 17 Pavement Underdrain, S'd, UD-4 Req'd.    | 28 Guardrail, S'd, GR-10, 3' Height, Type III Req'd. | 39 Adj. Exist. Structure                    |
| 7 Grass Raised Median, S'd, MS-2 Req'd.  | 18 Crossdrain, S'd, CD-1 Req'd.             | 29 Trailing End Terminal, S'd, GR-MGS3 Req'd.        | 40 Clean Out Exist. Structure               |
| 8 Entrance Gutter, S'd, CG-9B Req'd.     | 19 Crossdrain, S'd, CD-2 Req'd.             | 30 Fixed Object AH, S'd, GR-FOA-5 Req'd.             | 41 Clean Out Exist. Pipe                    |
| 9 Entrance Gutter, S'd, CG-9D Req'd.     | 20 Handrail, S'd, HR-1 Type II Req'd.       | 31 Fixed Object AH, S'd, GR-FOA-2 Req'd.             | 42 Full Depth Sawcut                        |
| 10 Entrance, S'd, CG-11 Req'd.           | 21 Barbed Wire Fence, S'd, FE-B Req'd.      | 32 Guardrail, S'd, GR-MGS4                           | 43 6" Curb and Dry Gutter, Mod. CG-6 Req'd. |
| 11 Curb Ramp, S'd, CG-12 Req'd.          | 22 Chain Link Fence, S'd, FE-CL Req'd.      | 33 Bridge Pier Protection, S'd, BPPS-1               | 44 Conc. Median Barrier, S'd, MB-7F Req'd.  |
- Denotes Full Depth Pavement  
 Denotes Guardrail Bumpout Pavement Section  
 Denotes Pavement Demolition  
 Denotes Mill & Variable Depth Overlay  
 Denotes Milling and Overlay  
 Denotes Construction Limits In Cuts  
 Denotes Construction Limits In Fills

**REFERENCES**  
(PROFILES, DETAIL & DRAINAGE DESCRIPTION SHEETS, ETC.)

Alignment Data	1G
ESC Phase 1	2D series
ESC Phase 2	2E series
ESC Phase 3	2F series
Merrimac Trail Profile	13A
Right-of-Way Plan	13RW
Drainage Descriptions	16
Storm Sewer Profiles	17

SCALE: 0 25' 50'

PROJECT	0060-047-627	SHEET NO.	13
---------	--------------	-----------	----