

PROJECT: MAINTENANCE/REPAIR/RECONSTRUCTION OF ROUTE 607, HAMPTON BOARDS DISTRICT
 SURVEYED BY: DATE Virginia Department of Transportation, Updated 12/2019
 DESIGN BY Johnson, Mirmiran & Thompson, Updated 12/2019
 SUBSURFACE UTILITY: BY: DATE Johnson, Mirmiran & Thompson, Updated 12/2019

NOTE: See Sheet IE(3) for Utility Owners Information

REFERENCES (PROFILES, DETAIL & DRAINAGE DESCRIPTION SHEETS, ETC.)	
Croaker Rd. SB Profile	4A
Croaker Rd. NB Profile	4B
Pond / Apartment Entrance Profiles	8C
Right-of-Way	4RW
Signaling and Pavement Marking Plan	11(2)
SWM Pond Details	12(1)-12(3)

Curve	Curve	Curve
A Route 607 SB Curve SBC1 PI • 303+66.04 DELTA • 2° 40' 13.69" (RT) D • 2' 59' 48" T • 365.95' L • 723.16' R • 1912.00' PC • 300+00.09 PT • 307+23.25 e • 3.30% V • 50 MPH Lr • 119 Lr • 72	C Apartment Entrance Curve AC1 PI • 602+01.87 DELTA • 28° 29' 20.99" (RT) D • 28' 38" 52" T • 50.77' L • 99.45' R • 200' PC • 601+51.09 PT • 602+50.54 e • NC (ULS) V • 20 MPH Lr • N/A Lr • N/A	B Route 607 NB Curve NBC1 PI • 203+62.22 DELTA • 2° 40' 13.75" (RT) D • 3' 01' 42" T • 362.12' L • 715.59' R • 1892.00' PC • 200+00.09 PT • 207+15.69 e • Match Existing V • 45 MPH ULS (Existing) Lr • Match Existing Lr • Match Existing

JANE B. SPEEGLE, A ONE-HALF UNDIVIDED INTEREST AND JOHN H. SPEEGLE, A ONE-HALF UNDIVIDED INTEREST
 Inst. #18001183
 PDB 365 PG 260
 7.859 AC.
 Tax# 2320100001

REVISED	STATE	ROUTE	PROJECT	SHEET NO.
04/02/21	VA.	607	0607-047-630 R201.C501	4

DESIGN FEATURES RELATING TO CONSTRUCTION OR TO REGULATION AND CONTROL OF TRAFFIC MAY BE SUBJECT TO CHANGE AS DEEMED NECESSARY BY THE DEPARTMENT

Johnson, Mirmiran & Thompson
Richmond, Virginia
HYDRAULIC ENGINEER

Johnson, Mirmiran & Thompson
Richmond, Virginia
ROADWAY ENGINEER

RW PLANS

THESE PLANS ARE UNFINISHED AND UNAPPROVED AND ARE NOT TO BE USED FOR ANY TYPE OF CONSTRUCTION.

- Legend**
- Perm... Denotes Permanent Easement
 - Temp... Denotes Temporary Easement
 - C... Denotes Construction Limits In Cuts
 - E... Denotes Construction Limits In Fills
 - [Hatched] Denotes mill and overlay
 - [Dotted] Denotes demolition of pavement
 - [Stippled] Denotes proposed hydraulic cement sidewalk
 - [Dashed] Denotes asphalt shared use path
 - [Cross-hatched] Denotes area of proposed pavement

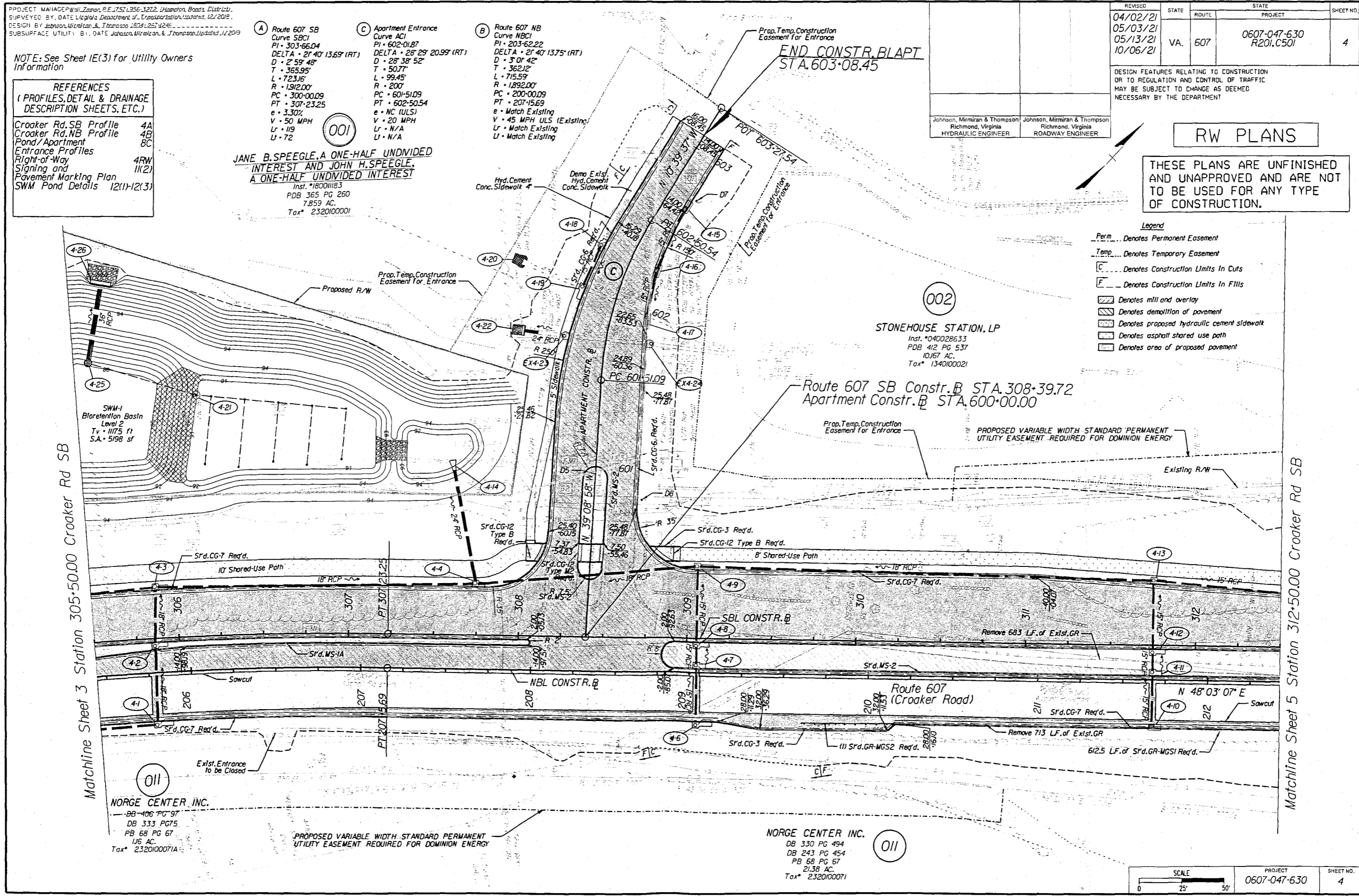

Matchline Sheet 3 Station 305+50.00 Croaker Rd SB

Matchline Sheet 5 Station 312+50.00 Croaker Rd SB

NORGE CENTER INC.
 BB 406 PG 97
 DB 333 PG 75
 PB 68 PG 67
 1.16 AC.
 Tax# 2320100071A

NORGE CENTER INC.
 DB 330 PG 494
 DB 243 PG 454
 PB 68 PG 67
 21.38 AC.
 Tax# 2320100071

SCALE 0 25' 50'	PROJECT 0607-047-630	SHEET NO. 4
--------------------	-------------------------	----------------