

PROJECT: MAHAGEWall, Zoran, P.E. (2571956-3272, Hampton, Roads, District),
SURVEYED BY: DATE Virginia, Department of Transportation, Updated 12/2018
DESIGN BY: Johnson, Mirmiran & Thompson, (BQ4) 267-1246
SUBSURFACE UTILITY BY: DATE Johnson, Mirmiran & Thompson, Updated 12/2019

REVISED	STATE	ROUTE	STATE PROJECT	SHEET NO.
04/02/21	VA.	607	0607-047-630 R201.C501	3

DESIGN FEATURES RELATING TO CONSTRUCTION OR TO REGULATION AND CONTROL OF TRAFFIC MAY BE SUBJECT TO CHANGE AS DEEMED NECESSARY BY THE DEPARTMENT

Johnson, Mirmiran & Thompson
Richmond, Virginia
HYDRAULIC ENGINEER

Johnson, Mirmiran & Thompson
Richmond, Virginia
ROADWAY ENGINEER

NOTE: See Sheet IE(3) for Utility Owners Information

BEGIN PROJECT 0607-047-630 P101.C501

CROAKER ROAD SB @ STA. 300+48.50

BEGIN PROJECT 0607-047-630 R201

CROAKER ROAD SB @ STA. 300+58.84

001

JOHN H. & JANE B. SPEEGLE

Inst. #18001183
PDB 365 PG 260
7.859 AC.
Tax# 2320100001

001

A Route 607 SB
Curve SBC1
PI - 303+66.04
DELTA - 2° 40' 13.69" (RT)
D - 2' 59' 48"
L - 723.16'
T - 365.95'
R - 1.912.00'
PC - 300+00.09
PT - 307+23.25
e - 3.30%
V - 50 MPH
Lr - 119'
Lr - 72'

B Route 607 NB
Curve NBC1
PI - 203+62.22
DELTA - 2° 40' 13.75" (RT)
D - 3' 01' 42"
L - 362.12'
T - 715.59'
R - 1.892.00'
PC - 200+00.09
PT - 207+15.69
e - Match Existing
V - 45 MPH ULS (Existing)
Lr - Match Existing
Lr - Match Existing

I Bank Driveway
Curve BLBANK_3
PI - 700+96.51
DELTA - 28° 04' 41.75" (RT)
D - 76' 23' 40"
L - 18.75'
T - 36.75'
R - 75.00'
PC - 700+77.76
PT - 701+14.51
e - Match Existing
Lr - N/A
Lr - N/A

J Curve 3047900LT_3
PI - 1+06.42
DELTA - 10° 22' 30.05" (RT)
D - 286' 28' 44"
T - 24.42'
L - 35.39'
R - 20.00'
PC - 0+82.00
PT - 1+17.39

- Legend**
- Perm Denotes Permanent Easement
 - Temp Denotes Temporary Easement
 - C Denotes Construction Limits In Cuts
 - F Denotes Construction Limits In Fills
 - Denotes mill and overlay
 - Denotes demolition of pavement
 - Denotes proposed hydraulic cement sidewalk
 - Denotes asphalt shared use path
 - Denotes area of proposed pavement

PROPOSED VARIABLE WIDTH STANDARD PERMANENT UTILITY EASEMENT REQUIRED FOR DOMINION ENERGY AND VDOT UTILITY EASEMENT

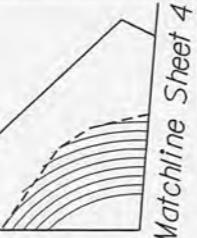

Matchline This Sheet

Matchline This Sheet

Matchline Sheet 4 Station 305+50.00 Croaker Rd SB

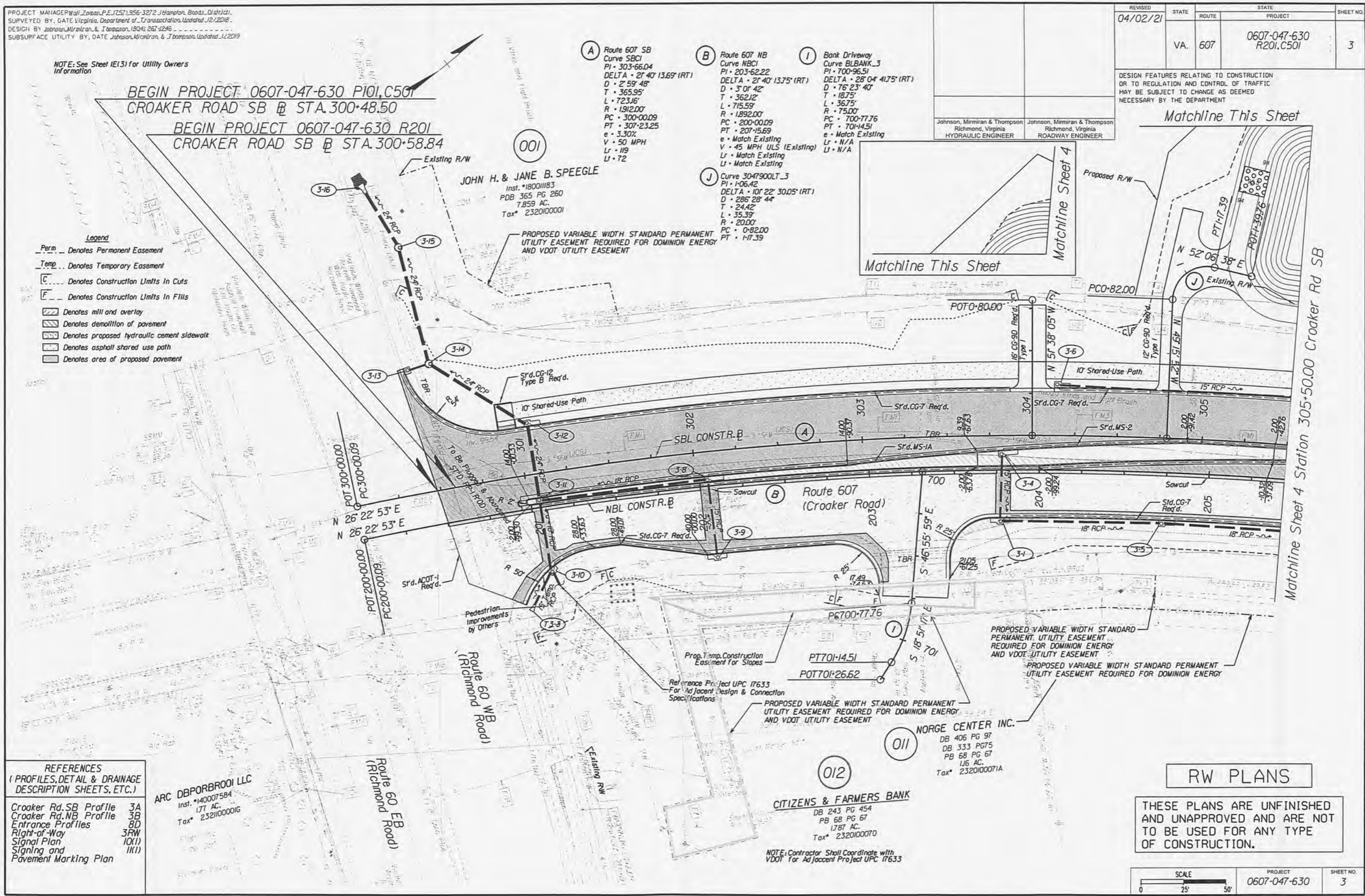

REFERENCES
(PROFILES, DETAIL & DRAINAGE DESCRIPTION SHEETS, ETC.)

Croaker Rd. SB Profile	3A
Croaker Rd. NB Profile	3B
Entrance Profiles	8D
Right-of-Way	3RW
Signal Plan	10(I)
Signaling and Pavement Marking Plan	11(I)

ARC DBPORBROO1 LLC
Inst. #140007584
177 AC.
Tax# 2321000016

CITIZENS & FARMERS BANK
DB 243 PG 454
PB 68 PG 67
1787 AC.
Tax# 2321000070

NORGE CENTER INC.
DB 406 PG 97
DB 333 PG 75
PB 68 PG 67
116 AC.
Tax# 2321000071A

NOTE: Contractor Shall Coordinate with VDOT For Adjacent Project UPC 17633

RW PLANS

THESE PLANS ARE UNFINISHED AND UNAPPROVED AND ARE NOT TO BE USED FOR ANY TYPE OF CONSTRUCTION.

SCALE 0 25' 50'	PROJECT 0607-047-630	SHEET NO. 3
--------------------	-------------------------	----------------

RIGHT OF WAY PLAN SHEET SHOWING PROPOSED RIGHT OF WAY & EASEMENTS Conveyed By Deed To The COMMONWEALTH OF VIRGINIA

Stonehouse Magisterial District
James City County, Virginia
Scale 1" = 25'
Plat By Michael L. Williams, L. S.
September 14, 2020

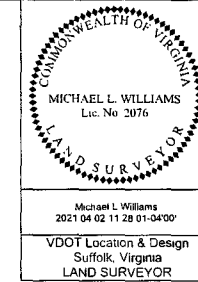

REVISED 12-17-2020 04-02-2021	STATE VA	ROUTE 607	STATE PROJECT 0607-047-630 R201, C501	SHEET NO 3RW
-------------------------------------	-------------	--------------	--	-----------------

- GENERAL NOTES:**
- Plat Is Intended For Acquisition Only And Does Not Constitute A Boundary Survey.
 - Property Line Information Is Based on Plats And Deeds Of Record. Limited Field Work Was Performed In The Creation Of This Plat.
 - Plat Was Prepared Without The Benefit Of A Title Report, Consequently Not All Encumbrances May Be Depicted.
 - All Property And/Or Easements Described Hereon Are Hereby Acquired By Correlated Deed.
 - This Plat Was Forwarded Electronically In "Read Only" Format. Any Attempt At Alteration Invalidates The Seal And Signature. An Original Hard Copy Remains On File At The Virginia Department Of Transportation, Hampton Roads District Office.
 - The Property's Physical Improvements Are Not Shown Hereon.
 - This Survey Datum Is Based On NAD 83 (93) State Plane Grid Virginia South Zone.
 - Station And Offsets Are Based On The Construction Baseline.
 - Bearings And Distances In Parenthesis Are From Record Data.

<p>(A) Route 607 SB Curve SBC1 PI = 303+66.04 DELTA = 21° 40' 13.69" (RT) D = 2° 59' 48" T = 365.95' L = 723.16' R = 1,912.00' PC = 300+00.09 PT = 307+23.25</p>	<p>(B) Route 607 NB Curve NBC1 PI = 203+62.22 DELTA = 21° 40' 13.75" (RT) D = 3° 01' 42" T = 362.12' L = 715.59' R = 1,892.00' PC = 200+00.09 PT = 207+15.69</p>
--	--

NOW OR FORMERLY
CROSSWALK CHURCH HOLDINGS LLC
Inst. #150007309
Inst. #060013607 Plat
8.721 AC
Tax# 2321100001B

Route 607 (Croaker Road)
80' RW

NOW OR FORMERLY
ARC DBPORBR001 LLC
Inst. #140007584
1.77 AC
Tax# 2321100001G

PARCEL #	R/W TAKE	PERMANENT UTILITY EASEMENT	TEMPORARY CONSTRUCTION EASEMENT	PERMANENT DRAINAGE EASEMENT
001	40,622 SF	3,396 SF	17,611 SF	N/A
011	N/A	13,501 SF	N/A	N/A
012	N/A	7,829 SF	2,304 SF	N/A

Route 60 (Richmond Road)
Variable Width RW

Route 60 (Richmond Road)
Variable Width RW

(001)
JOHN H. & JANE B. SPEEGLE
Inst. #180011183
PDB 365 PG 260
7.859 AC
Tax# 2320100001

(012)
CITIZENS & FARMERS BANK
DB 243 PG 454
PB 68 PG 67
1.787 AC
Tax# 2320100070

(011)
NORGE CENTER INC.
DB 406 PG 97
DB 333 PG 75
PB 68 PG 67
1.16 AC
Tax# 2320100071A

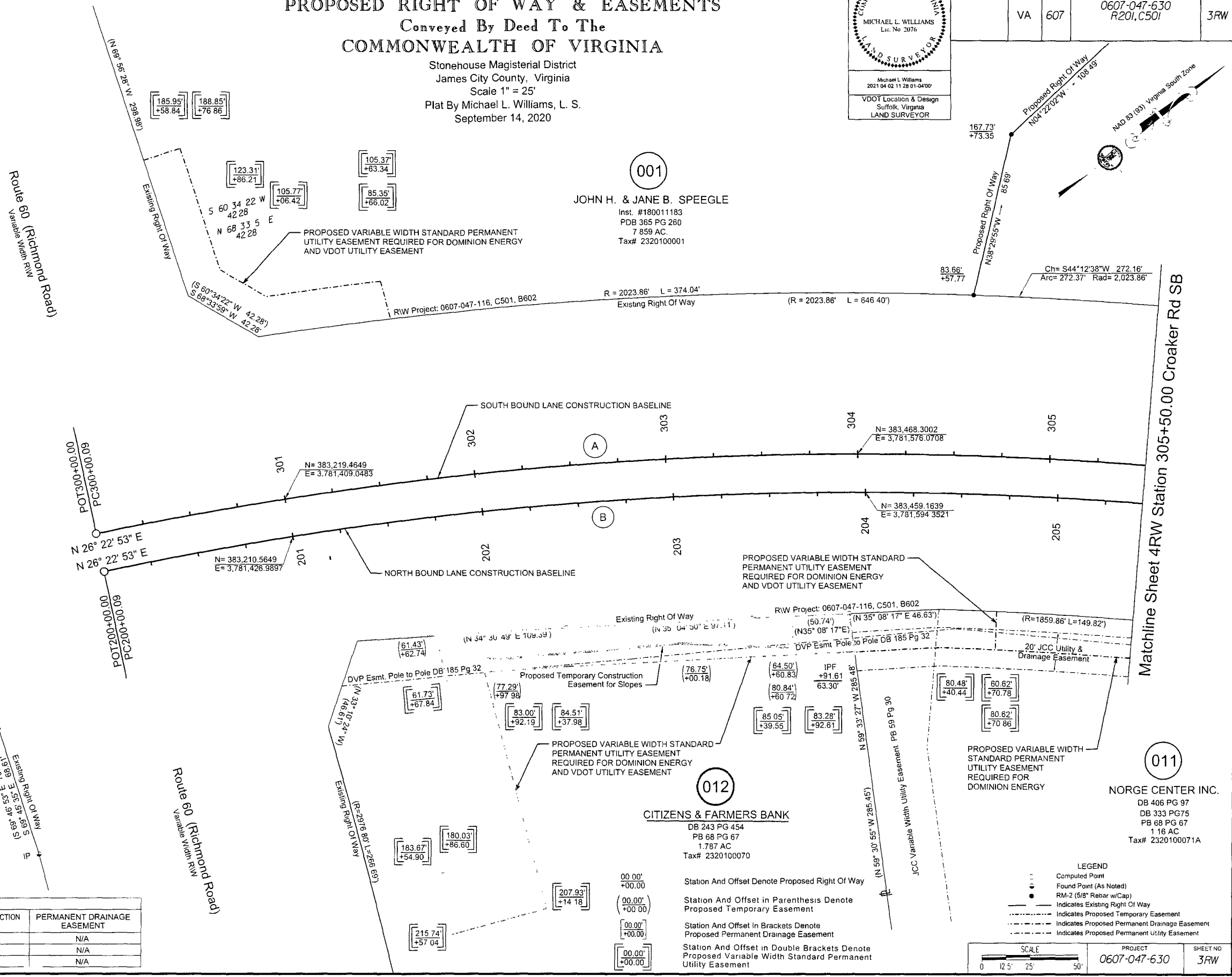

LEGEND

- Computed Point
- Found Point (As Noted)
- RM-2 (5/8" Rebar w/Cap)
- Indicates Existing Right Of Way
- Indicates Proposed Temporary Easement
- Indicates Proposed Permanent Drainage Easement
- Indicates Proposed Permanent Utility Easement

SCALE
0 12.5' 25' 50'

PROJECT: 0607-047-630
SHEET NO: 3RW

PROJECT MANAGER: Wall, Logan, P.E. (757) 956-3272, (Hampton Roads District)
 SURVEYED BY, DATE: Virginia, Department of Transportation, Updated 12/2018.
 DESIGN BY: Johnson, Mirmiran, & Thompson, (804) 267-1264
 SUBSURFACE UTILITY BY, DATE: Johnson, Mirmiran, & Thompson, Updated 1/2019

REVISED	STATE		PROJECT	SHEET NO.
	STATE	ROUTE		
	VA.	607	0607-047-630 R201, C501	3A

CROAKER ROAD SOUTHBOUND PROFILE

DESIGN FEATURES RELATING TO CONSTRUCTION OR TO REGULATION AND CONTROL OF TRAFFIC MAY BE SUBJECT TO CHANGE AS DEEMED NECESSARY BY THE DEPARTMENT

Johnson, Mirmiran & Thompson
Richmond, Virginia
HYDRAULIC ENGINEER

Johnson, Mirmiran & Thompson
Richmond, Virginia
ROADWAY ENGINEER

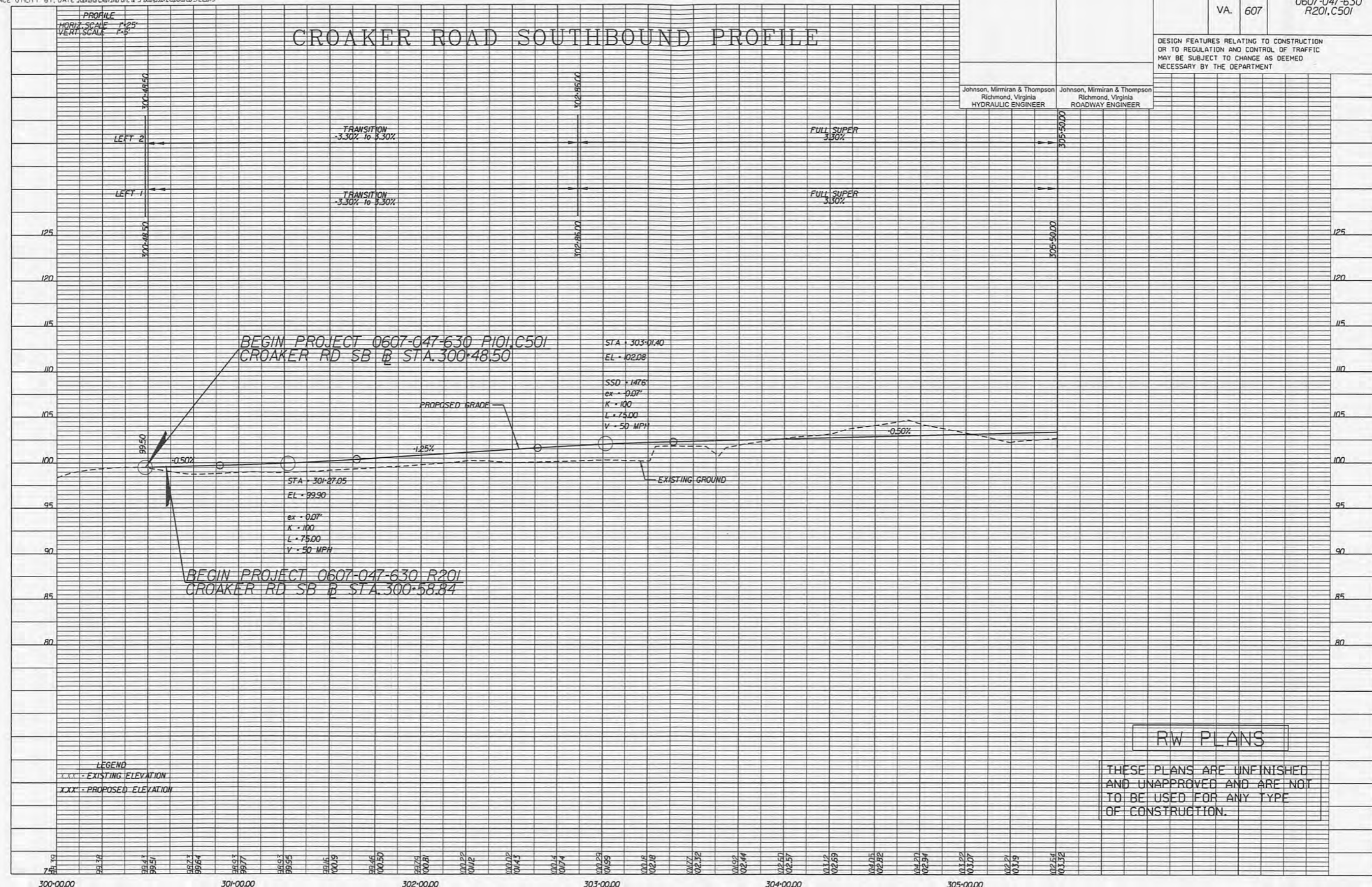

LEGEND
 ---X--- EXISTING ELEVATION
 ---X--- PROPOSED ELEVATION

RW PLANS

THESE PLANS ARE UNFINISHED AND UNAPPROVED AND ARE NOT TO BE USED FOR ANY TYPE OF CONSTRUCTION.

300+00.00 301+00.00 302+00.00 303+00.00 304+00.00 305+00.00

PROJECT 0607-047-630	SHEET NO. 3A
-------------------------	-----------------

PROJECT MANAGER: Wall Zapan, P.E. (571) 956-3272, (Hampton Roads District)
SURVEYED BY, DATE: V. L. G. / L. G. / L. G., Department of Transportation, Updated 1/2/2018
DESIGN BY: Johnson, Mirmiran, & Thompson, (804) 267-1268
SUBSURFACE UTILITY BY, DATE: Johnson, Mirmiran, & Thompson, Updated 1/2/2019

REVISED	STATE	ROUTE	STATE	PROJECT	SHEET NO.
	VA.	607		0607-047-630 R201, C501	8D

ENTRANCE PROFILES

DESIGN FEATURES RELATING TO CONSTRUCTION OR TO REGULATION AND CONTROL OF TRAFFIC MAY BE SUBJECT TO CHANGE AS DEEMED NECESSARY BY THE DEPARTMENT

Johnson, Mirmiran & Thompson
Richmond, Virginia
HYDRAULIC ENGINEER

Johnson, Mirmiran & Thompson
Richmond, Virginia
ROADWAY ENGINEER

RW PLANS

THESE PLANS ARE UNFINISHED AND UNAPPROVED AND ARE NOT TO BE USED FOR ANY TYPE OF CONSTRUCTION.

ENTR. 504+00.00 LT
CROAKER SOUTHBOUND

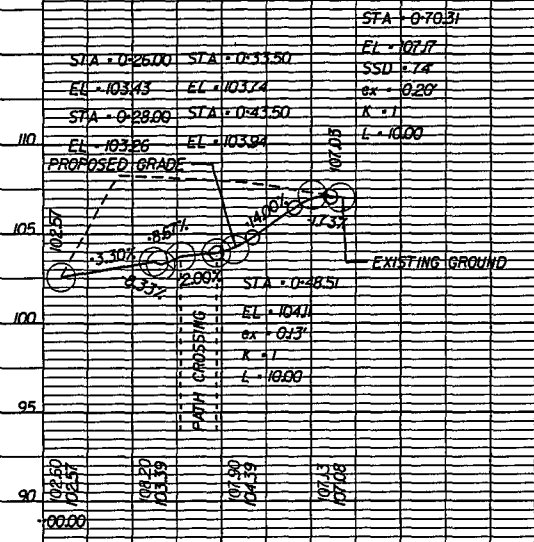

ENTR. 501+80.09 RT
ROSE LANE

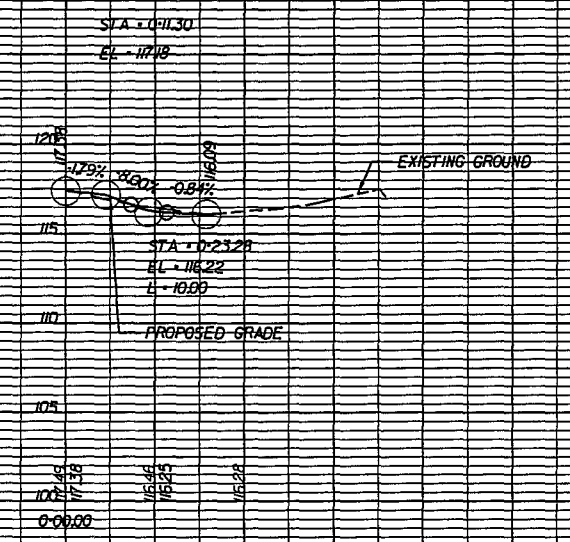

BANK DRIVEWAY
STA 203+31.35 NB CONSTR. BL

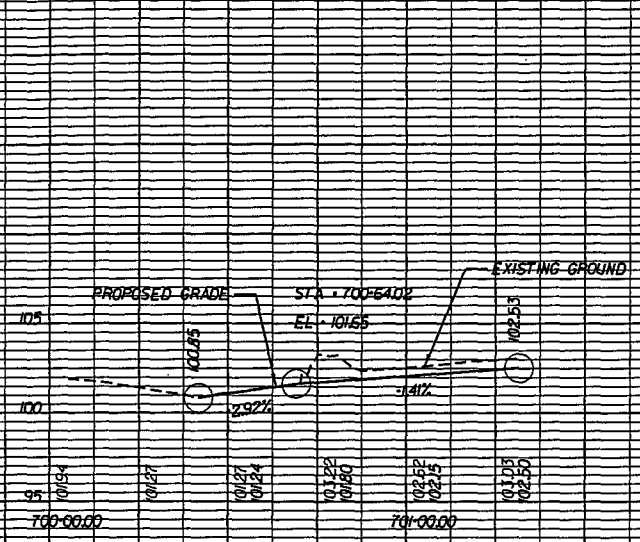

ENTR. 502+36.06 RT
ROSE LANE

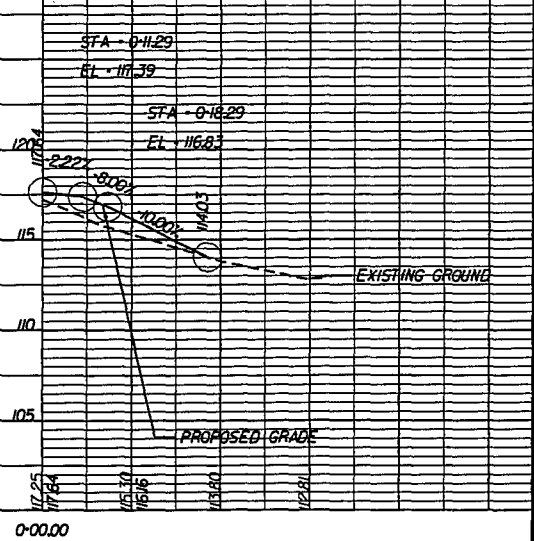

ENTR. 504+21.48 LT
ROSE LANE

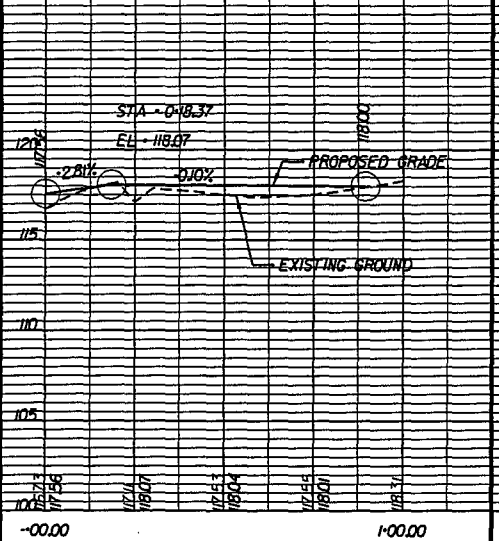

ENTR. 505+22.06 RT
ROSE LANE

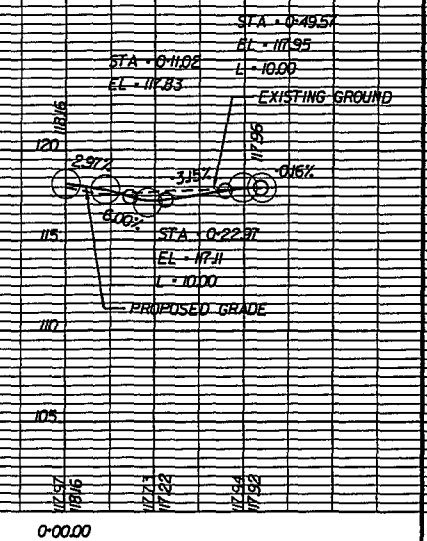

ENTR. 506+25.87 LT
ROSE LANE

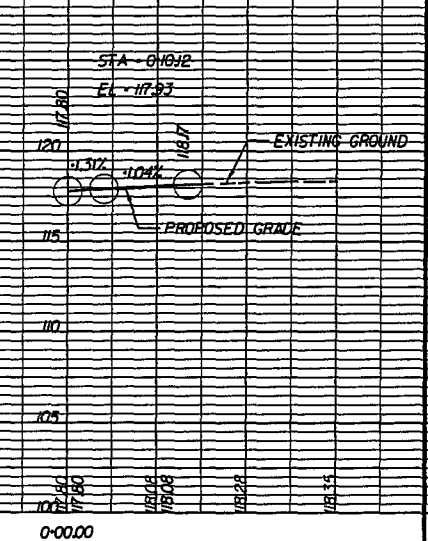

LEGEND
X.XX - EXISTING ELEVATION
X.XX - PROPOSED ELEVATION