

210008803

BUILDING 56 (10-PLEX)

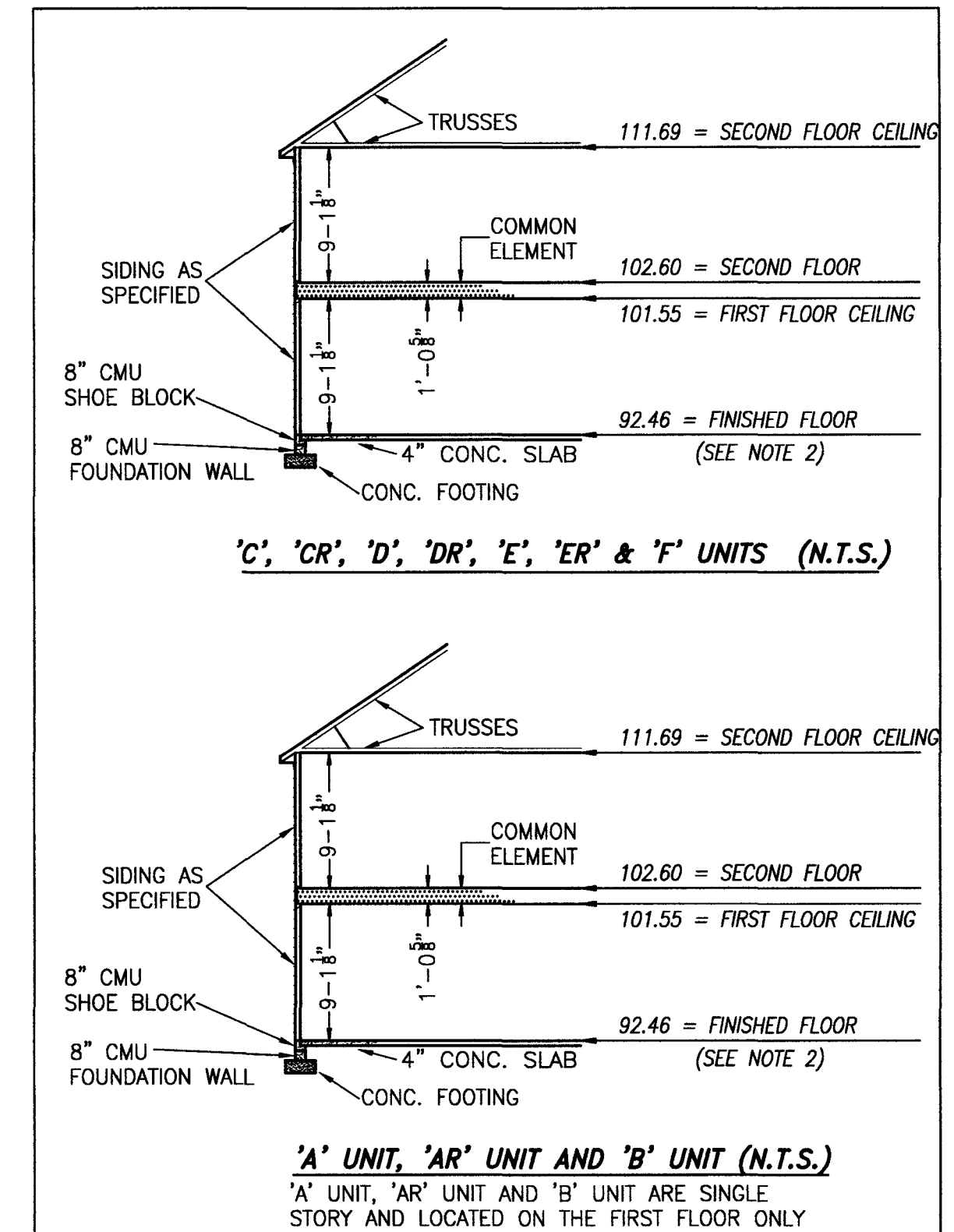
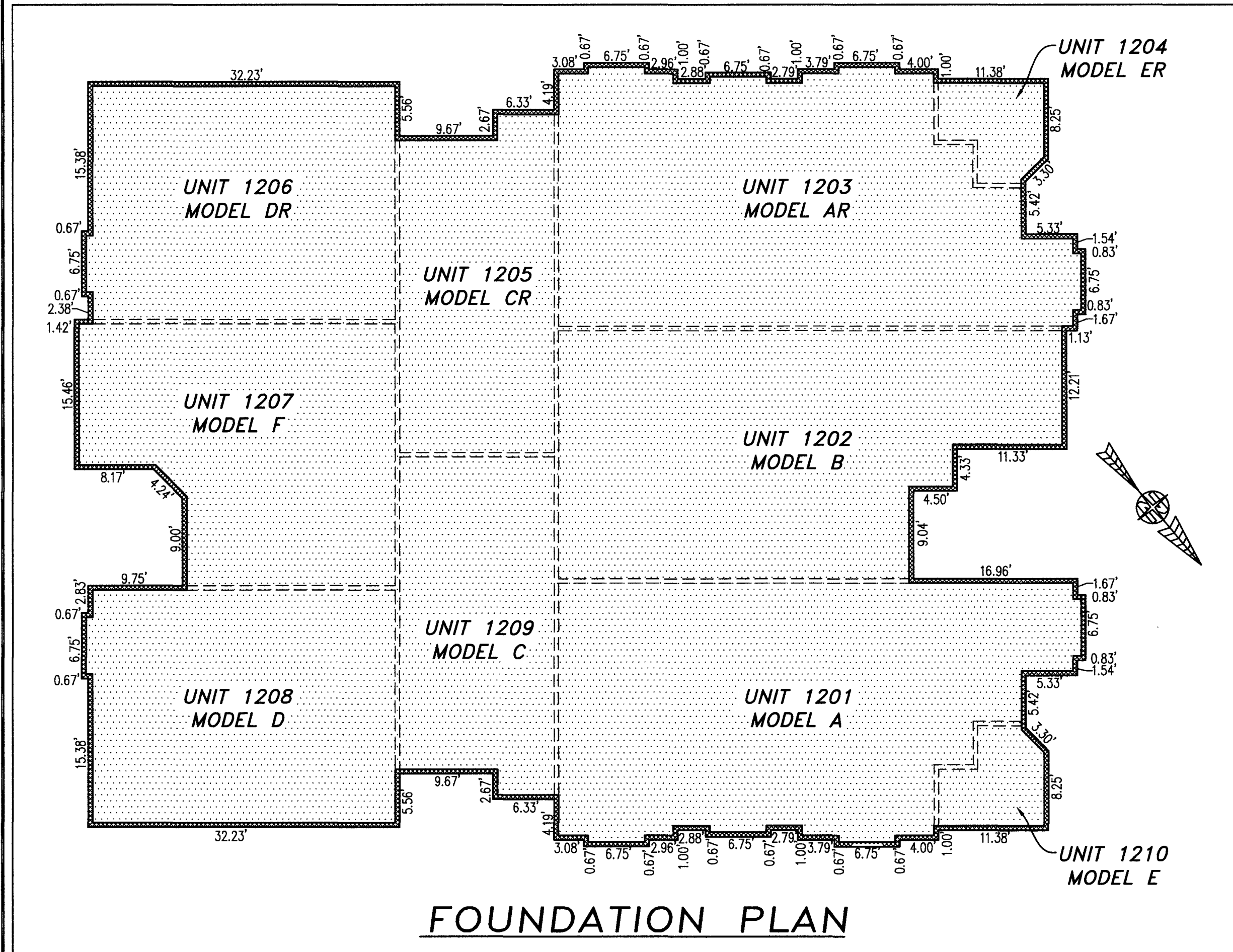

TYPICAL BUILDING SECTION
NOT TO SCALE (N.T.S.)

NOTES:

1. VERTICAL DATUM REFERENCE: NATIONAL GEODETIC VERTICAL DATUM OF 1929 (NGVD29).
2. FINISHED FLOOR ELEVATION SHOWN WAS TAKEN FROM AS-BUILT SURVEY OF BUILDING #56 (10-PLEX) THE PROMENADE AT JOHN TYLER BY HAYDEN FRYE AND ASSOCIATES PERFORMED ON 02/09/2021.

I HEREBY CERTIFY THAT THIS PLAT IS ACCURATE AND THAT IT COMPLIES WITH THE PROVISIONS OF THE CODE OF VIRGINIA OF 1950 AS AMENDED, § 55.1-1920A & B AND I FURTHER CERTIFY THAT ALL IMPROVEMENTS THEREOF DEPICTED HEREON, PURSUANT TO THE CODE OF VIRGINIA § 55.1-1920B, ARE SUBSTANTIALLY COMPLETE.

5 Large/Small Plat(s) Recorded
herewith as # 210008803



City of Williamsburg & County of James City
Circuit Court: This PLAT was recorded on
April 30, 2021
at 11:04 AM, PG
Document # 210008803
MONA A. FOLEY, CLERK
Mona A. Foley, Clerk

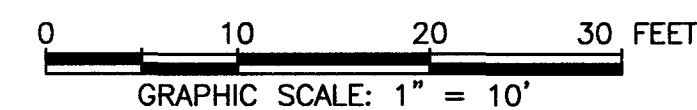

THIS SHEET: FOUNDATION PLAN AND SECTION

PHASE 56
CONDOMINIUM PLAT AND PLAN
OF
THE PROMENADE
AT
JOHN TYLER
A CONDOMINIUM
JAMES CITY COUNTY, VIRGINIA

Job# 160921

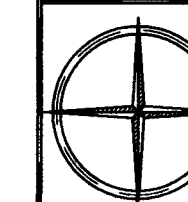

Hayden Frye and Associates, Inc.
Land Surveyors
333 KELLAM ROAD, SUITE 200
VIRGINIA BEACH, VA., 23462
PH: (757) 491-7228 FAX: (757) 491-7229

DATE: APRIL 20, 2021
SCALE: 1"=10'
SHEET 4 OF 5 THIS PHASE