

202605397

TE026022002
EXHIBIT "A"

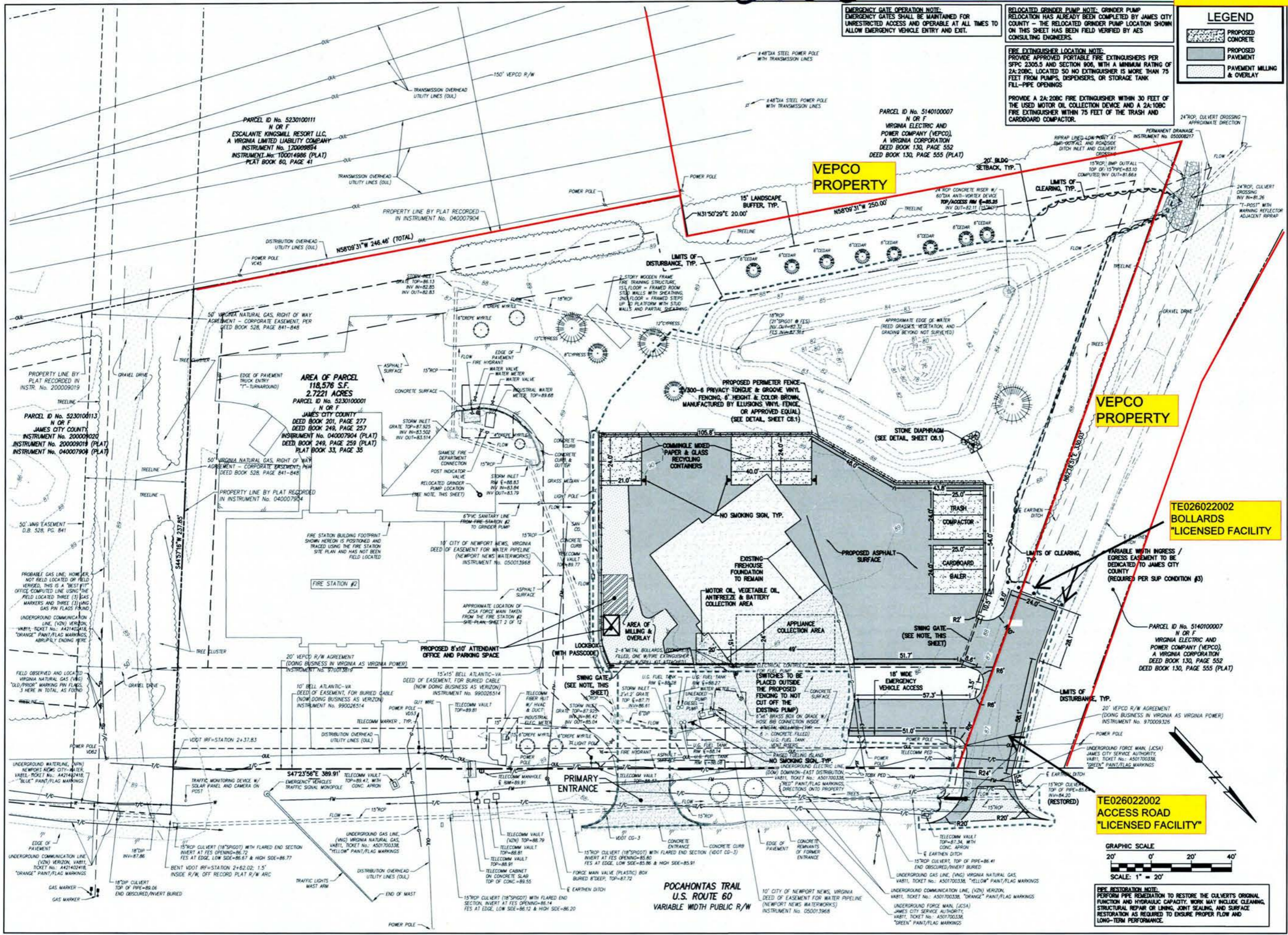

EMERGENCY GATE OPERATION NOTE:
EMERGENCY GATES SHALL BE MAINTAINED FOR UNRESTRICTED ACCESS AND OPERABLE AT ALL TIMES TO ALLOW EMERGENCY VEHICLE ENTRY AND EXIT.

RELOCATED GRINDER PUMP NOTE: GRINDER PUMP RELOCATION HAS ALREADY BEEN COMPLETED BY JAMES CITY COUNTY - THE RELOCATED GRINDER PUMP LOCATION SHOWN ON THIS SHEET HAS BEEN FIELD VERIFIED BY AES CONSULTING ENGINEERS.

FIRE EXTINGUISHER LOCATION NOTE:
PROVIDE APPROVED PORTABLE FIRE EXTINGUISHERS PER SFC 2305.5 AND SECTION 906, WITH A MINIMUM RATING OF 2A:20BC. LOCATED SO NO EXTINGUISHER IS MORE THAN 75 FEET FROM PUMPS, DISPENSERS, OR STORAGE TANK FILL-PIPE OPENINGS.

PROVIDE A 2A:20BC FIRE EXTINGUISHER WITHIN 30 FEET OF THE USED MOTOR OIL COLLECTION DEVICE AND A 2A:10BC FIRE EXTINGUISHER WITHIN 75 FEET OF THE TRASH AND CARDBOARD COMPACTOR.

LEGEND

- PROPOSED CONCRETE
- PROPOSED PAVEMENT
- PAVEMENT MILLING & OVERLAY

REV	DATE	DESCRIPTION
1	11/12/2025	REVISED PER COMMENTS FROM JAMES CITY COUNTY
2	01/22/2026	REVISED PER COMMENTS FROM JAMES CITY COUNTY



AES
City of Williamsburg & County of James City
Circuit Court: This PLAT was recorded on
at 12:15 AM (PM), PB PG
Document # 202605397
ELIZABETH E. O'CONNOR, CLERK
Elizabeth E. O'Connor, Clerk

SITE PLAN FOR GROVE CONVENIENCE CENTER
8429 POCAHONTAS TRAIL
ROBERTS DISTRICT
JAMES CITY COUNTY, VIRGINIA

Project Contacts: CJS
Project Number: W10648-E-01
Scale: 1"=20'
Date: 07/02/2025
Sheet Title: SITE PLAN
Sheet Number: C4.0

Large (Small Plat(s)) Recorded
herewith as # 202605397

at 12:15 AM (PM), PB PG
Document # 202605397
ELIZABETH E. O'CONNOR, CLERK
Elizabeth E. O'Connor, Clerk

TE026022002
ACCESS ROAD
"LICENSED FACILITY"

TE026022002
BOLLARDS
"LICENSED FACILITY"

VEPCO
PROPERTY

VEPCO
PROPERTY

POCAHONTAS TRAIL
U.S. ROUTE 60
VARIABLE WIDTH PUBLIC R/W

PIPE RESTORATION NOTE:
PERFORM PIPE RESTORATION TO RESTORE THE CULVERT'S ORIGINAL FUNCTION AND HYDRAULIC CAPACITY. WORK MAY INCLUDE CLEANING, STRUCTURAL REPAIR OR LINING, JOINT SEALING, AND SURFACE RESTORATION AS REQUIRED TO ENSURE PROPER FLOW AND LONG-TERM PERFORMANCE.