

202508443

Proposed 20' VDOT Permanent Drainage Easement

- (A) S08°48'12"W 46.89' (D) N1°36'37"E 36.89'
 (B) S1°36'37"W 12.37' (E) N08°48'12"E 51.06'
 (C) S50°15'13"W 32.03' (F) S68°03'47"E 20.54'

Large Small Plat(s) Recorded
 herewith as # 202508443

City of Williamsburg & County of James City
 Circuit Court: This PLAT was recorded on
June 24, 2025

at 10:51 AM/PM; PB PG
 Document # 202508443
 ELIZABETH E. O'CONNOR, CLERK
Elizabeth E. O'Connor, Clerk

LEGEND

- Iron Pin (Found)
- Iron Pipe (Found)
- Existing Right Of Way
- - - Meander Line

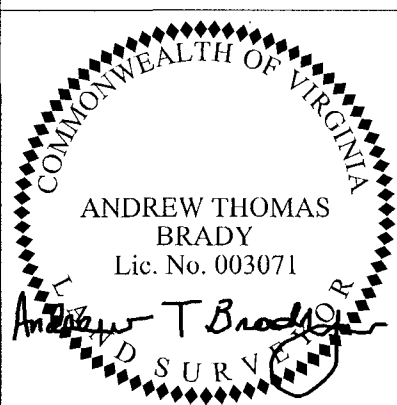

09/07/2021

VDOT Location and Design
 Suffolk, Virginia
 LAND SURVEYOR

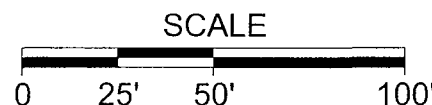

#7643
HUDSON HOMES & LEASING LLC
 Inst.# 210011498
 Inst.# 060003723 (Plat)
 1.67 AC.
 TAX MAP# 0930100017
 Proposed 5' Temporary Construction Easement 240 Sq. Ft. / 0.005 Ac.

#7647
**KENNETH B. HODGE
 CYNTHIA A. HODGE**
 Inst.# 150004941
 0.58 AC.
 TAX MAP# 0930100016
 Proposed 20' Permanent Drainage Easement 1,472 Sq. Ft. / 0.033 Ac.
 Proposed 5' Temporary Construction Easement 730 Sq. Ft. / 0.016 Ac.

GENERAL NOTES:

1. Sketch Is Intended For Acquisition Only And Does Not Constitute A Boundary Survey.
2. Property Line Information Is Based on Highway Plans,Plats And Deeds Of Record. Limited Field Work Was Performed For The Creation Of This Sketch.
3. Sketch Was Prepared Without The Benefit Of A Title Report, Consequently Not All Encumbrances May Be Depicted.
4. This Sketch Was Forwarded Electronically In "Read Only" Format. Any Attempt At Alteration Invalidates The Seal And Signature. An Original Hard Copy Remains On File At The Virginia Department Of Transportation, Hampton Roads District Office.



Andrew T. Brady, LS
 Hampton Roads District
 1700 North Main Street
 Suffolk Va, 23434
 (757) 925-2661

**COMMONWEALTH OF VIRGINIA
 DEPARTMENT OF TRANSPORTATION
 SKETCH SHOWING PROPOSED 20' VDOT
 PERMANENT DRAINAGE EASEMENT TO BE
 DONATED BY KENNETH B. AND CYNTHIA A. HODGE**

**PROPERTY OF
 KENNETH B. & CYNTHIA A. HODGE**
 INST. #150004941
 POWHATAN MAGISTERIAL DISTRICT
 LEXANA, VA

UPC:	PROJECT:	DRAWN BY: JEP	PARCEL:
SCALE: 1" = 50'	DATE: September 7, 2021	CHECKED BY: ATB	SHEET 1 OF 1

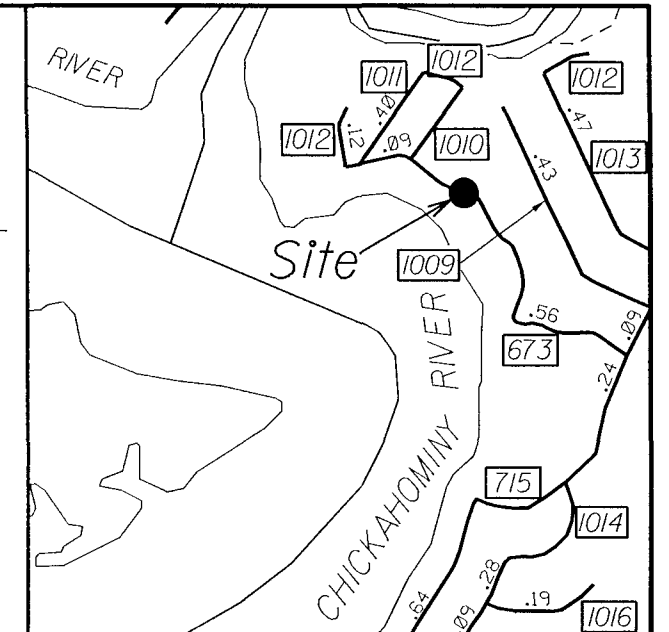

VICINITY MAP
Not To Scale