

GENERAL NOTES

- WORK PERFORMED SHALL COMPLY WITH THE FOLLOWING:
 - THE VIRGINIA UNIFORM BUILDING CODE (VUBC), 2018 EDITION
 - THE INTERNATIONAL RESIDENTIAL CODE (IRC), 2018 EDITION AS AMENDED BY THE VUBC.
 - ALL APPLICABLE STATE AND LOCAL CODES, ORDINANCES AND REGULATIONS.
- DESIGN LOADS:

A. BUILDING CLASSIFICATION CATEGORY		
B. GROUND SNOW, P _g	15 PSF	
C. ULTIMATE WIND SPEED, V	114 MPH	
EXPOSURE	D	
D. SOIL UNIT WEIGHT	120 PCF	
E. LIVE LOADS:		
LANDSCAPE & MAINTENANCE	UNIFORM 50 PSF	CONCENTRATED 200LB
GUARD ASSEMBLY	50 PSF	200LB
- SEISMIC DESIGN:

SEISMIC IMPORTANCE FACTOR, I	1.0
MAPPED SPECTRAL RESPONSE ACCELERATION S _s @ 0.10	
MAPPED SPECTRAL RESPONSE ACCELERATION S ₁ @ 0.44	
SITE SOIL CLASS	E
SPECTRAL COEFFICIENT, S _{ds}	0.14
SPECTRAL COEFFICIENT, S ₀₁	0.125
SEISMIC DESIGN CATEGORY	D
BASIC STRUCTURAL SYSTEM	SEGMENTAL BLOCK RETAINING WALL
- THE CONTRACTOR SHALL VERIFY DIMENSIONS IN FIELD PRIOR TO FABRICATION OF MEMBERS AND COMMENCING WORK.
- CONTRACTOR SHALL NOTIFY "MISS UTILITY OF VIRGINIA" PRIOR TO BEGINNING EXCAVATION FOR LOCATION OF UNDERGROUND UTILITIES. THE CONTRACTOR SHALL BEAR SOLE RESPONSIBILITY FOR COSTS ASSOCIATED WITH DAMAGE AND REPAIR OF ANY LINES MARKED BY MISS UTILITY OF VIRGINIA.
- PROVIDE TEMPORARY SHORING/BRACING AS REQUIRED TO RESIST SOIL PRESSURE AND OTHER LOADS DURING CONSTRUCTION.
- THE CONTRACTOR SHALL PROTECT EXISTING STRUCTURES, EQUIPMENT, ADJACENT GROUNDS, SPRINKLERS, TREES AND PLANTS DURING ALL PHASES OF CONSTRUCTION. THE CONTRACTOR SHALL REPAIR AND/OR REPLACE, AT NO ADDITIONAL COSTS TO THE OWNER, ANY ITEMS DAMAGED DURING THE CONSTRUCTION.

- LEVELING PAD:**
- LEVELING PAD FOR SEGMENTAL BLOCK RETAINING WALLS SHALL BE A MINIMUM OF 8" THICK COMPACTED NO. 21A CRUSHED STONE WRAPPED IN FILTER CLOTH. ALTERNATELY, 8" THICK 950 PSI FLOWABLE FILL MAY BE UTILIZED FOR THE LEVELING PAD.
 - ALL FLOWABLE FILL SHALL BE MIXED, PLACED AND TESTED IN ACCORDANCE WITH THE LATEST EDITION OF ACI 318.
 - ALL FLOWABLE FILL SHALL HAVE A SLUMP OF 1" ± 1" UNLESS NOTED OTHERWISE.
 - ALL FLOWABLE FILL TO BE POURED IN COLD WEATHER, AS DEFINED IN SECTION 11 OF ACI 306R, COLD WEATHER CONCRETING, SHALL FULLY COMPLY WITH ACI 306.1, STANDARD SPECIFICATIONS FOR COLD WEATHER CONCRETING, AND 306R.
 - ALL FLOWABLE FILL TO BE POURED IN HOT WEATHER, AS DEFINED IN SECTION 12 OF ACI 306R, HOT WEATHER CONCRETING, SHALL FULLY COMPLY WITH ACI 305.1, STANDARD SPECIFICATIONS FOR HOT WEATHER CONCRETING, AND ACI 305R.

- RETAINING WALL:**
- ELEVATIONS SHOWN ARE APPROXIMATE AND BASED ON TOPOGRAPHIC SURVEY PROVIDED BY JAMES CITY COUNTY GIS. CONTRACTOR TO VERIFY ALL ELEVATIONS IN FIELD.
 - ANY VARIATION IN LOCATION OR ELEVATION OF RETAINING WALL, ELEVATION IN THE GRADE EITHER ABOVE OR BELOW THE WALL, OR THE RECOMMENDED INSTALLATION DETAILS, REQUIRE REVIEW BY THE ENGINEER OF RECORD.
 - EXISTING SITE SOILS ARE PEANICK SILT LOAM WITH MODERATE POTENTIAL BASED ON A SHRINK-SWELL SOIL EVALUATION REPORT FROM EGS MID-ATLANTIC, LCC, DATED AUGUST 30, 2023.
 - LEVELING PAD WAS DESIGNED TO BEAR ON UNDISTURBED SOIL BELOW THE FROST LINE AND A MINIMUM OF 2'-0" BELOW THE EXISTING GRADE UNLESS NOTED OTHERWISE WITH A MINIMUM SOIL BEARING PRESSURE OF 1500 PSF UNLESS NOTED OTHERWISE.
 - BACKFILL MATERIAL MUST BE COMPACTED TO 95% STANDARD PROCTOR DENSITY IN MAXIMUM 8" LIFTS USING A VIBRATORY PLATE COMPACTOR. ALL BACKFILL SHALL BE FREE-DRAINING, NON-FROST SUSCEPTIBLE GRANULAR MATERIAL SM OR BETTER, UNLESS NOTED TO BE STONE. RETAINED BACKFILL MATERIAL SHALL HAVE A MINIMUM FRICTION ANGLE OF 25 DEGREES, EXCEPT IN THE REINFORCED ZONE BACKFILL MATERIAL TO BE USED IN THE REINFORCED ZONE SHALL BE SM OR BETTER WITH MINIMUM FRICTION ANGLE OF 30 DEGREES.
 - CHIMNEY DRAIN ADJACENT TO MODULAR WALL UNITS AND MATERIAL USED TO FILL MODULAR WALL UNITS SHALL BE VIBRATORY PLATE COMPACTED NO. 51 STONE, OR A WELL GRADED COMPACTIBLE NO. 21A STONE, 1/4" TO 1/2" DIAMETER WITH NO MORE THAN 10% PASSING THE #200 SIEVE.
 - PLACE A 4" DIAMETER PERFORATED PVC DRAIN PIPE WRAPPED IN FILTER CLOTH ADJACENT TO INSIDE FACE OF THE MODULAR CONCRETE UNIT RETAINING WALL. PROVIDE DRAINAGE TO DAYLIGHT.
 - ALL GEOGRID REINFORCEMENT TO BE MIRAGRID 3XT SERIES MANUFACTURED BY TENCATE GEOSYNTHETICS. LENGTH OF GEOGRID SHOWN ON DRAWINGS IS TAKEN FROM OUTSIDE FACE OF RETAINING WALL. GEOGRID SHALL BE PULLED TAUGHT PRIOR TO INFILLING BACKFILL.
 - SEGMENTAL RETAINING WALL UNITS SHALL BE VERTICA MANUFACTURED BY ANCHOR WALL SYSTEMS, LLC.
 - CONTRACTOR SHALL FOLLOW INSTRUCTIONS PROVIDED BY BLOCK MANUFACTURER REGARDING THE CONSTRUCTION OF THE MODULAR CONCRETE UNIT WALLS. ANY INSTRUCTIONS THAT DIFFER FROM THOSE INDICATED ON THE CONSTRUCTION DRAWINGS SHALL BE BROUGHT TO THE ATTENTION OF THE ENGINEER OF RECORD PRIOR TO CONSTRUCTION.
 - PEDESTRIAN PROTECTION IS REQUIRED WHEN WALL HEIGHT EXCEEDS 30" ABOVE FINISH GRADE. GUARD RAILING, FENCING, AND/OR LANDSCAPE SHRUBBERY SHALL BE PROVIDED WHERE WALL HEIGHT EXCEEDS 30" ABOVE FINISH GRADE.
 - RETAINING WALL MINIMUM DESIGN SAFETY FACTORS:
 - OVERTURNING - 2.0
 - SLIDING - 1.5
 - GLOBAL STABILITY - 1.5

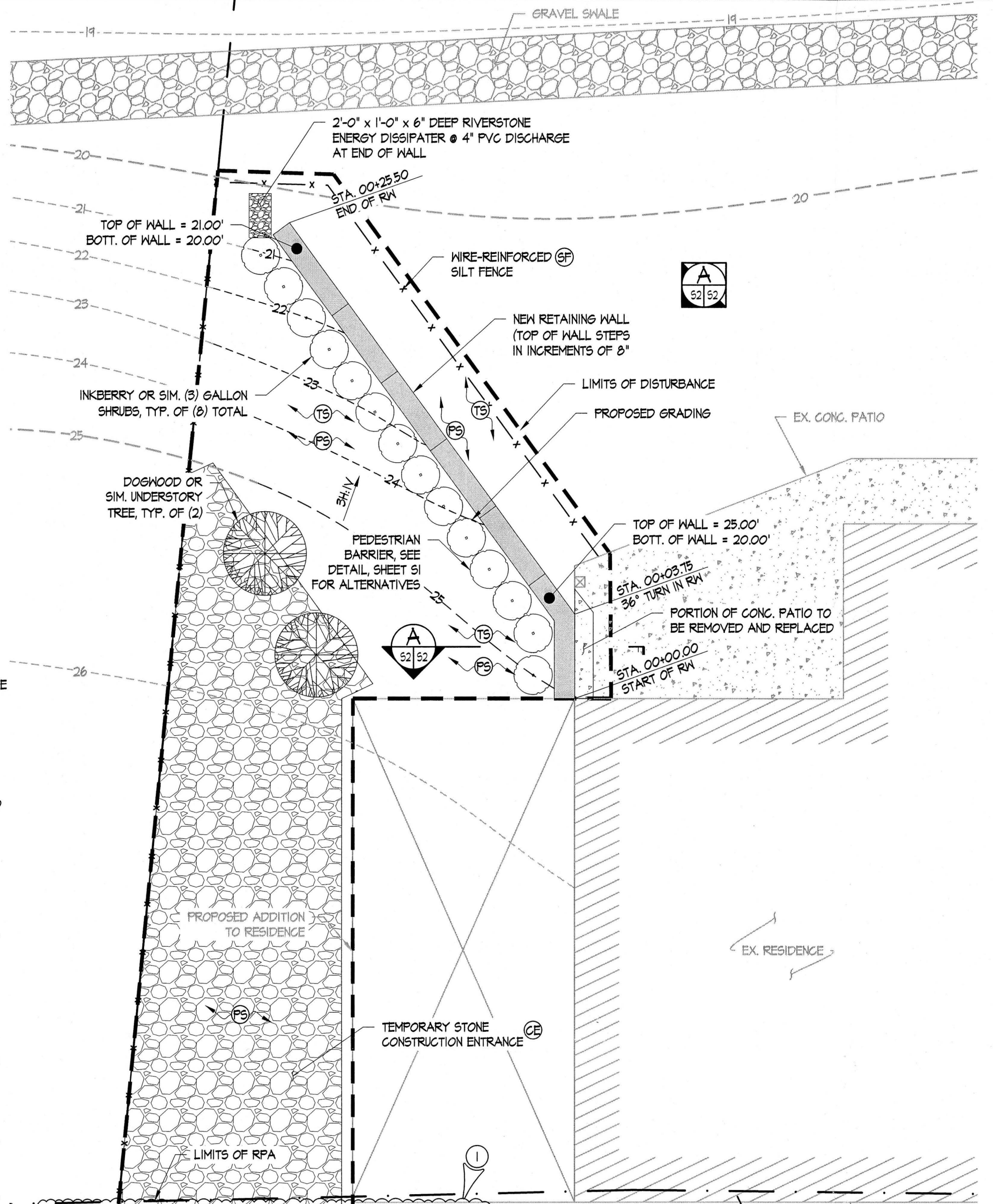

RETAINING WALL PLAN
SCALE: 1/4" = 1'-0"

LEGEND			
MARK	SYMBOL	CODE	DESCRIPTION
- x - x -	⊕	3.05	WIRE-REINFORCED SILT FENCE
⊕	⊕	3.02	CONSTRUCTION ENTRANCE
⊕	⊕	3.31	TEMPORARY SEEDING
⊕	⊕	3.32	PERMANENT SEEDING

PLANT SCHEDULE			
QUANTITY REQ'D	PROVIDED	SCIENTIFIC NAME	COMMON NAME
8	14	ILEX GLABRA	INKBERRY SHRUB
2	2	CORNUS FLORIDA	DOGWOOD TREE

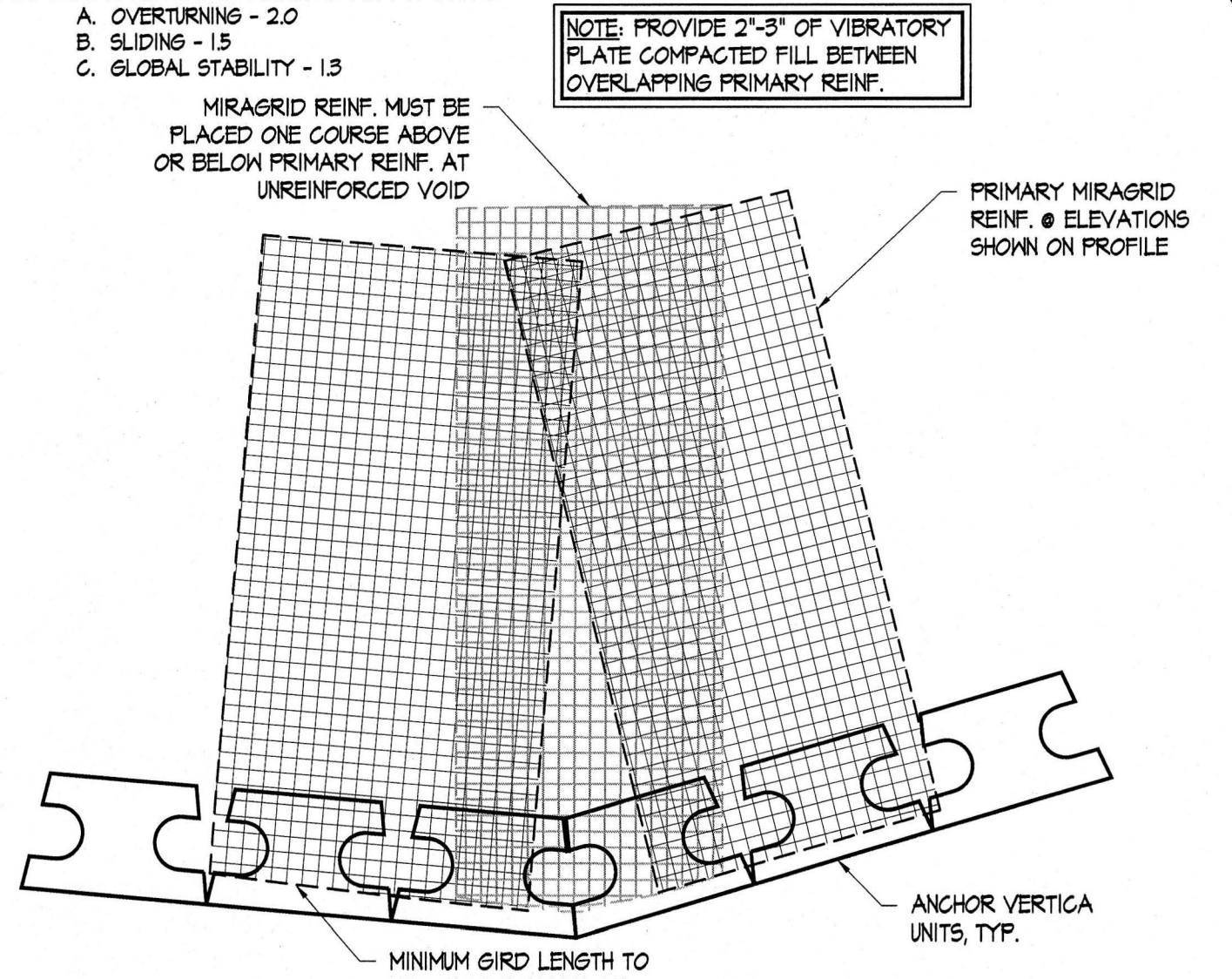

DETAIL
SCALE: 3/4" = 1'-0"

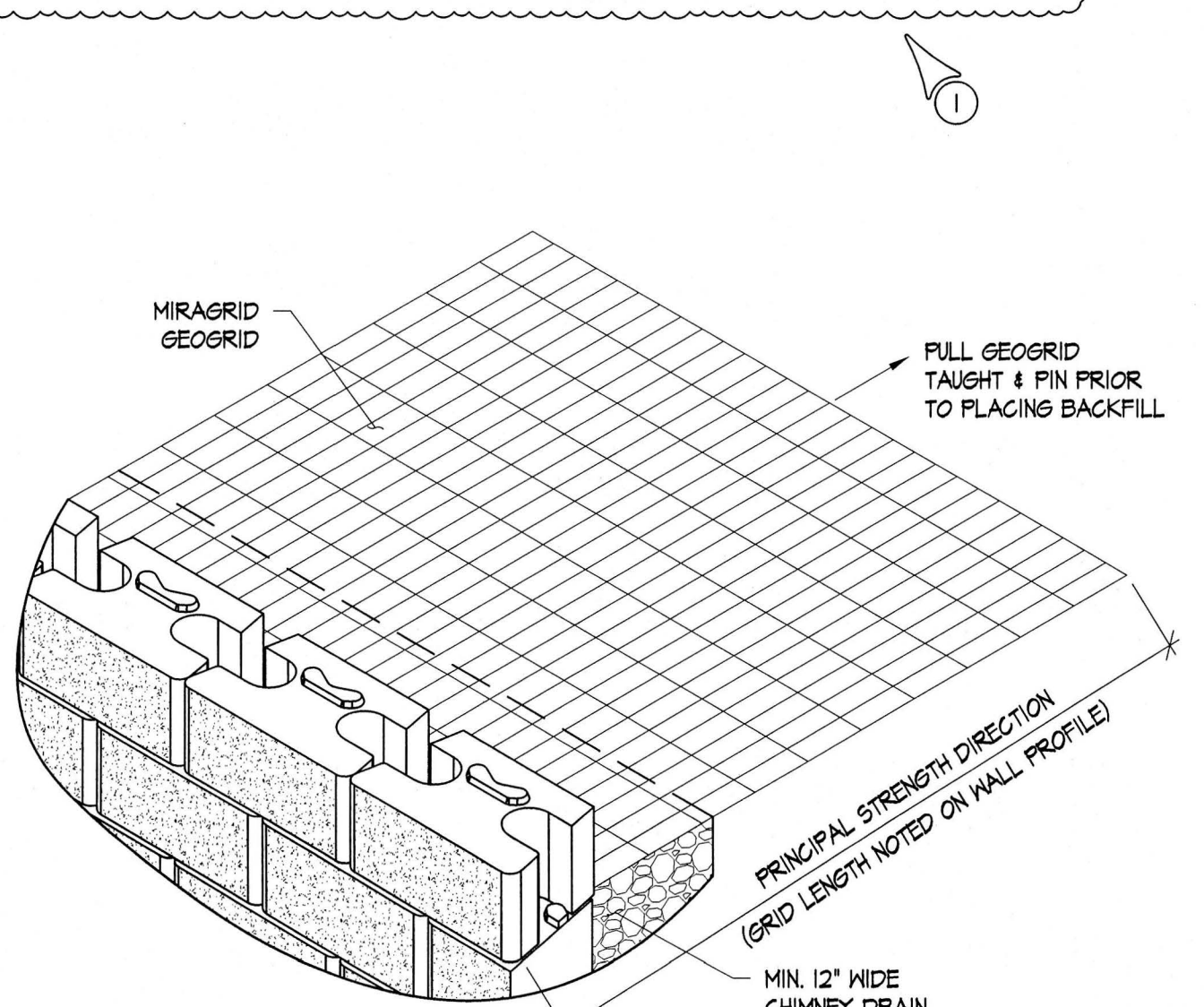

DETAIL
SCALE: 3/4" = 1'-0"

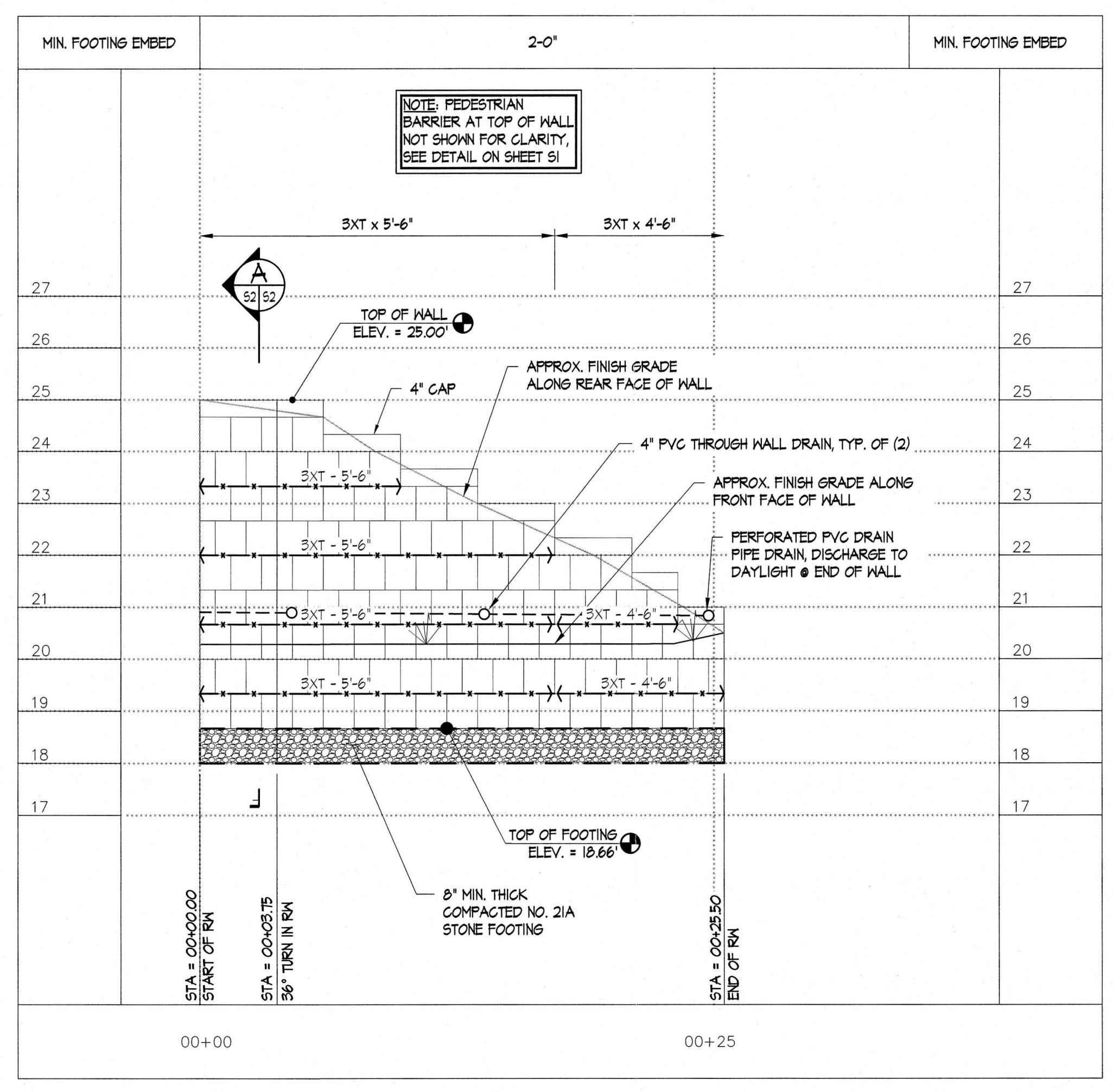

WALL PROFILE
HORIZ. SCALE: 1"=5'-0", VERT. SCALE: 1"=2'-0"

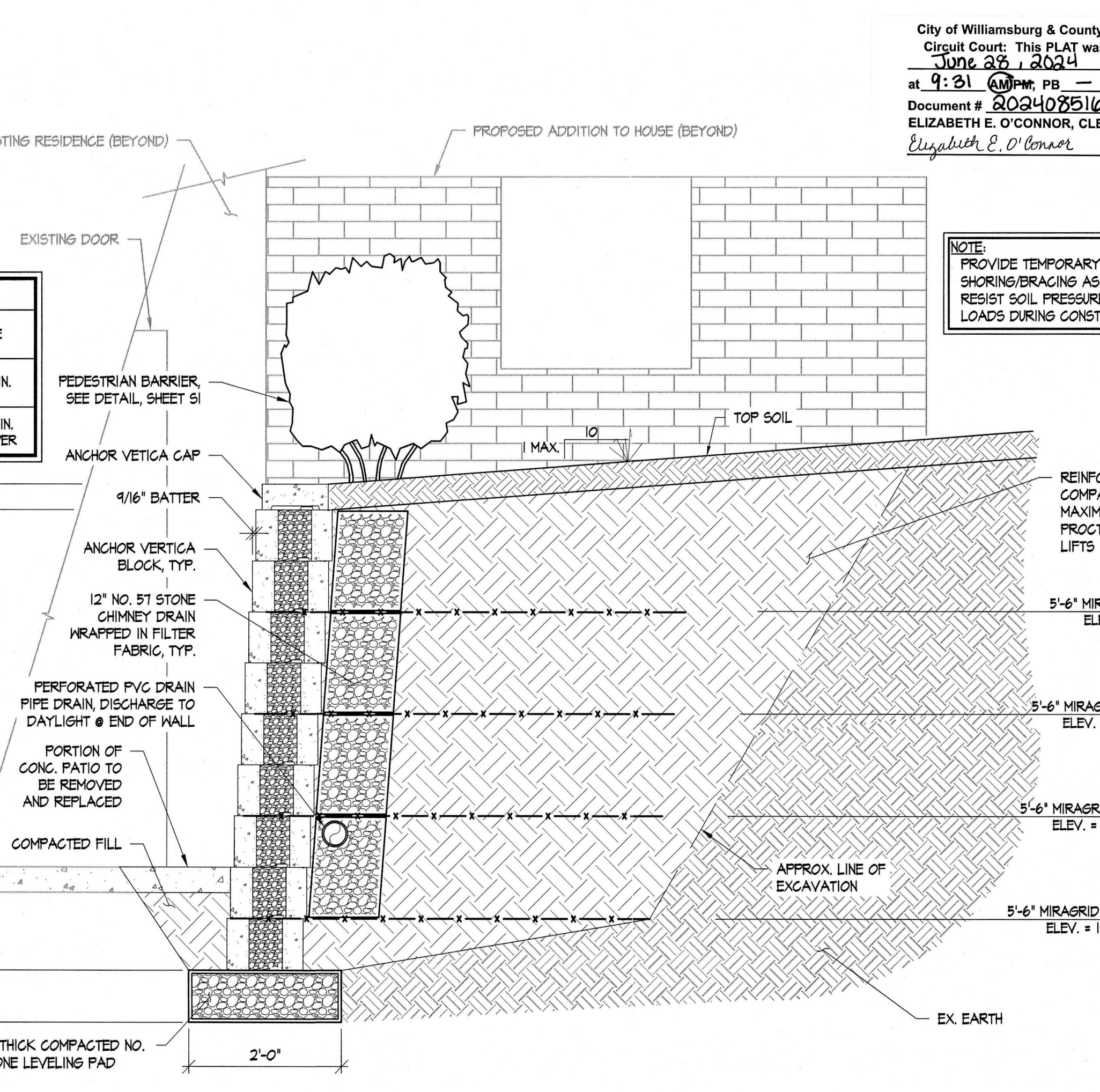

SECTION
SCALE: 3/4" = 1'-0"

3 Large/Small Plat(s) Recorded
herewith as # 202408516

City of Williamsburg & County of James City
Circuit Court: This PLAT was recorded on
June 30, 2024
at 9:31 AM PM, PB -- PG --
Document # 202408516
ELIZABETH E. O'CONNOR, CLERK
Elizabeth E. O'Connor, Clerk

Project #: VA24004DE5
Date: 3/29/24
Reviewed by: MAM
Drawn by: DAS
Project: 3/29/24
Date: 4/15/24
Revisions: No.

The Structures Group, Inc.
1200 Old Colony Lane • Williamsburg, VA 23185
(757)220-1546 • Fax (757)220-1546
www.thestructuresgroup.com

JCC Stormwater & Resource Protection Comments

RETAINING WALL HILL RESIDENCE 196 THE MAINE

WILLIAMSBURG

3 of 3