

202304131

SUBDIVISION OF
STONEHOUSE
LAND BAY 5
PHASE 2

LOTS 16 THROUGH 50, & LOTS 93 THROUGH 111
STONEHOUSE DISTRICT JAMES CITY COUNTY VIRGINIA
DATE: 2/06/2023 JOB # 20-224

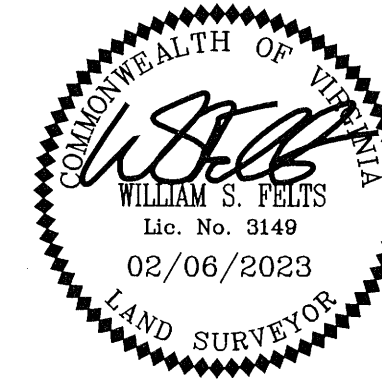

VA STATE PLANE
SOUTH ZONE
(NAD 83/GEOID 12B)

LandTech
Resources, Inc.

Engineering & Surveying Consultants
205 Bulifants Blvd., Suite E, Williamsburg, Virginia 23188
Phone: (757) 565-1677 Fax: (757) 565-0782
web: landtechresources.com

SHEET 2 OF 4

JCC-S-22-0017

SHEET INDEX

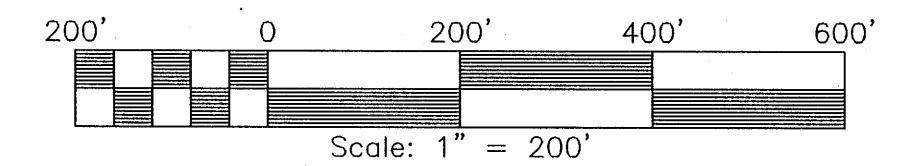

City of Williamsburg & County of James City
Circuit Court: This PLAT was recorded on
May 02, 2023
at 9:54 (AM/PM, PB) PG _____
Document # 202304131
MONA A. FOLEY, CLERK
Mona A. Foley, Clerk

4 (Large) Small Plat(s) Recorded
herewith as # 202304131

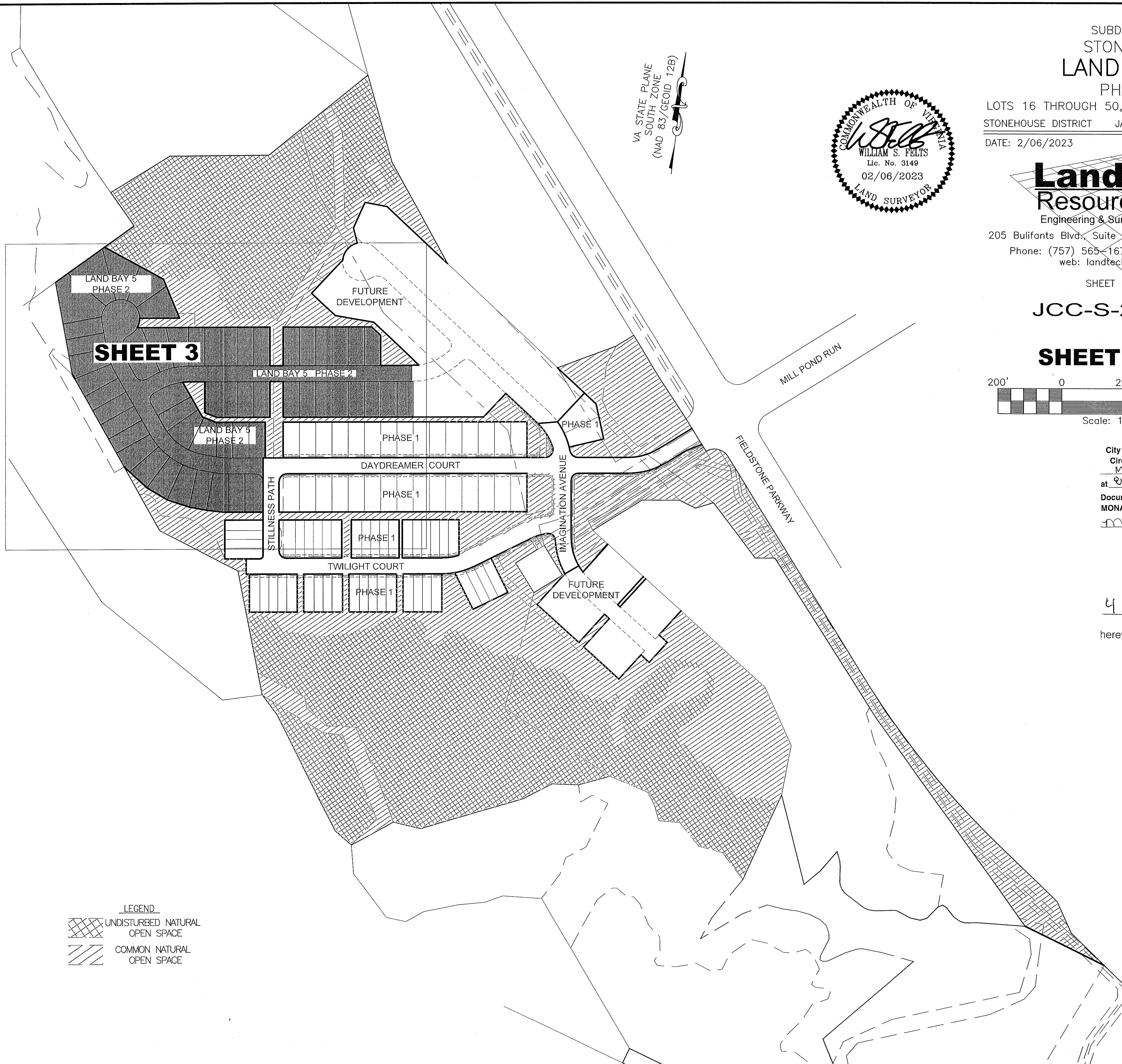

SHEET 3

LEGEND
UNDISTURBED NATURAL OPEN SPACE
COMMON NATURAL OPEN SPACE