

202302699

VIRGINIA COORDINATE SYSTEM
1983 (SOUTH ZONE)

MATCHLINE - SEE SHEET 5

MATCHLINE - SEE SHEET 7

LIMITS OF RPA
(PER JCC GIS MAPPING)

N/F
ROBERT & FIONA LANG
PID#1220100005
INSTR#060031293

N/F
ROB THE BUILDER, INC.
PID#1220100005A
INSTR#110014563

N/F
SCP-JTL STONEHOUSE OWNER 1, LLC
PORTION OF PID#0640100001
INSTR#160007744
ZONE: PUD-C

NEW PARCEL 1A
1,625,654 S.F.
37.32 AC.

S 05°09'17" E 703.37' (TO PIN)
699.26' ± (TIE-LINE TO CL OF STREAM)

SIX MOUNT
ZON ROAD
(VARIABLE WIDTH R/W)

IRF

N 56°57'32" W 604.80'
OLD STAGE ROAD
(100' R/W)

S 78°02'28" W 70.71'
IRF (BENT)

MATCHLINE - SEE SHEET 4

SUBDIVISION PLAT
OF
PARCEL ID #0640100001
LA GRANGE TRACT
(P.B. 50 PG. 11)

STONEHOUSE DISTRICT JAMES CITY COUNTY VIRGINIA
DATE: 10/03/2022 JOB # 22-216

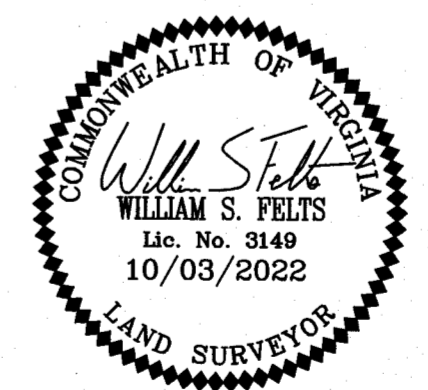

LRI LANDTECH RESOURCES, INC.
ENGINEERING AND SURVEYING CONSULTANTS
205E Bulifants Blvd., Williamsburg, VA 23188
Ph: (757) 565-1677 Fax: (757) 565-0782
web: landtechresources.com

9 Large/Small Plat(s) Recorded
herewith as # 202302699
City of Williamsburg & County of James City
Circuit Court: This PLAT was recorded on
March 23, 2023
at 8:46 AM, PG
Document # 202302699
MONA A. FOLEY, CLERK
Monica Foley, Clerk

SHEET 6 OF 9

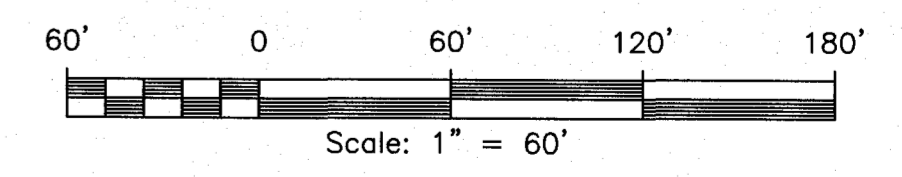

JCC-S-22-0022