

PROJECT MANAGER: Wall, Zoran, P.E. 1751 1956-1272 Hampton Roads District  
SURVEYED BY: DATE: Virginia Department of Transportation, Updated 12/2018  
DESIGN BY: Johnson, Mirmiran & Thompson, J041 267/246  
SUBSURFACE UTILITY BY: DATE: Johnson, Mirmiran & Thompson, Updated 1/2019

REVISED	STATE	ROUTE	PROJECT	SHEET NO.
04/02/21	VA.	607	0607-047-630 R201,C501	3
08/27/21				
10/06/21				
11/09/21				
12/16/22				

DESIGN FEATURES RELATING TO CONSTRUCTION OR TO REGULATION AND CONTROL OF TRAFFIC MAY BE SUBJECT TO CHANGE AS DEEMED NECESSARY BY THE DEPARTMENT

Johnson, Mirmiran & Thompson  
Richmond, Virginia  
HYDRAULIC ENGINEER

Johnson, Mirmiran & Thompson  
Richmond, Virginia  
ROADWAY ENGINEER

NOTE: See Sheet 1E(3) for Utility Owners Information

BEGIN PROJECT 0607-047-630 P101,C501  
CROAKER ROAD SB @ STA. 300+48.50  
BEGIN PROJECT 0607-047-630 R201  
CROAKER ROAD SB @ STA. 300+58.84

- A** Route 607 SB  
Curve SB(C)  
PI • 303+66.04  
DELTA • 27° 40' 13.69" (RT)  
D • 2' 59' 48"  
T • 365.95'  
L • 723.16'  
R • 1912.00'  
PC • 300+00.09  
PT • 307+23.25  
e • 3.30%  
V • 50 MPH  
Lr • 119  
Lt • 72
- B** Route 607 NB  
Curve NB(C)  
PI • 203+62.22  
DELTA • 27° 40' 13.75" (RT)  
D • 3' 01' 42"  
T • 362.12'  
L • 715.59'  
R • 1892.00'  
PC • 200+00.09  
PT • 207+15.69  
e • Match Existing  
V • 45 MPH ULS (Existing)  
Lr • Match Existing  
Lt • Match Existing
- I** Bank Driveway  
Curve BLBANK\_3  
PI • 700+96.51  
DELTA • 28° 04' 41.75" (RT)  
D • 76' 23' 40"  
T • 183.75'  
L • 36.75'  
R • 75.00'  
PC • 700+77.76  
PT • 701+14.51  
e • Match Existing  
Lr • N/A  
Lt • N/A
- J** Curve 3047900LT\_3  
PI • 1+06.42  
DELTA • 10° 22' 30.05" (RT)  
D • 286' 28' 44"  
T • 24.42'  
L • 35.39'  
R • 20.00'  
PC • 0+82.00  
PT • 1+17.39

001

JOHN HOBART SPEEGLE,  
A THREE-QUARTERS UNDIVIDED INTEREST  
AND MELISSA JANE SPEEGLE,  
A ONE-QUARTER UNDIVIDED INTEREST

Will File 10690  
Inst. #18001183  
PDB 365 PG 260  
7.859 AC.  
Tax# 2320100001

PROPOSED VARIABLE WIDTH STANDARD PERMANENT UTILITY EASEMENT REQUIRED FOR DOMINION ENERGY AND VDOT UTILITY EASEMENT

- Legend**
- Perm... Denotes Permanent Easement
  - Temp... Denotes Temporary Easement
  - C... Denotes Construction Limits In Cuts
  - F... Denotes Construction Limits In Fills
  - Denotes mill and overlay
  - Denotes demolition of pavement
  - Denotes proposed hydraulic cement sidewalk
  - Denotes asphalt shared use path
  - Denotes area of proposed pavement
  - Sr'd.EC-2 Lining Req'd.
  - Sr'd.PG-2A Req'd.
  - Sr'd.PG-5 Req'd.
  - Travel Lane

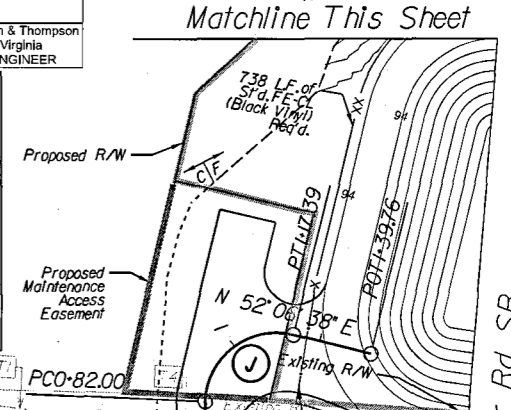
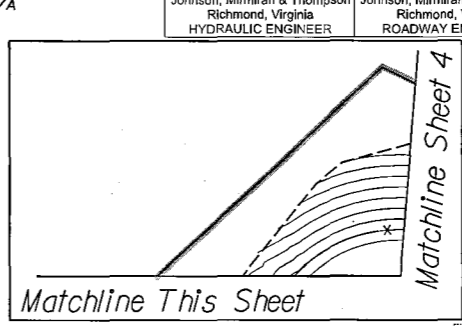
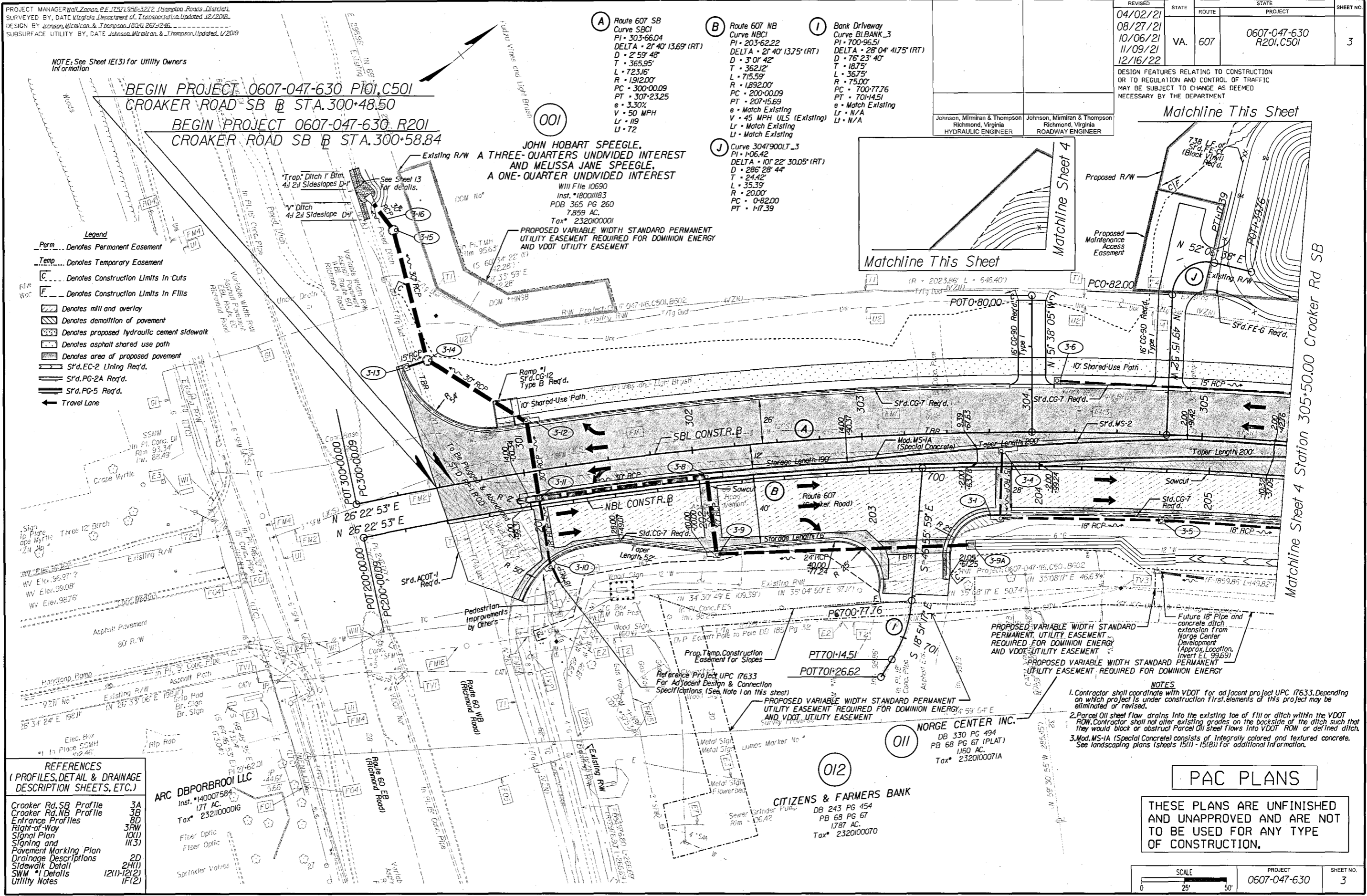

**REFERENCES**  
(PROFILES, DETAIL & DRAINAGE DESCRIPTION SHEETS, ETC.)

Croaker Rd SB Profile	3A
Croaker Rd NB Profile	3B
Entrance Profiles	8D
Right-of-Way	3RW
Signal Plan	10(1)
Signaling and	11(3)
Pavement Marking Plan	2D
Drainage Descriptions	24(1)
Sidewalk Detail	12(1)-12(2)
SWM *1 Details	1F(2)
Utility Notes	

ARC DBPORBROOK LLC  
Inst. #14007584  
177 AC.  
Tax# 232100001G

CITIZENS & FARMERS BANK  
DB 243 PG 454  
PB 68 PG 67  
1787 AC.  
Tax# 2320100070

NORGE CENTER INC.  
DB 330 PG 494  
PB 68 PG 67 (PLAT)  
1160 AC.  
Tax# 2320100071A

- NOTES**
- Contractor shall coordinate with VDOT for adjacent project UPC 17633. Depending on which project is under construction first, elements of this project may be eliminated or revised.
  - Parcel Oil sheet flow drains into the existing toe of fill or ditch within the VDOT ROW. Contractor shall not alter existing grades on the backside of the ditch such that they would block or obstruct Parcel Oil sheet flows into VDOT ROW or defined ditch.
  - Mod.MS-1A (Special Concrete) consists of integrally colored and textured concrete. See landscaping plans (sheets 15(1) - 15(8)) for additional information.

**PAC PLANS**

THESE PLANS ARE UNFINISHED AND UNAPPROVED AND ARE NOT TO BE USED FOR ANY TYPE OF CONSTRUCTION.

SCALE	PROJECT	SHEET NO.
0 25' 50'	0607-047-630	3