

PROJECT MANAGER — *Agency: Marshall, 757-1925-2682, Hampton Roads District*
 SURVEYED BY — *Howard A. Spence, L.S. (257) 549-5388, NewportLinc*
 DESIGN SUPERVISED BY — *PRIME AE GROUP (571) 205-8908*
 DESIGNED BY — *PRIME AE GROUP (703) 865-0606*

FINAL ROADWAY PLAN - 1

REVISED	STATE	ROUTE	STATE PROJECT	SHEET NO.
	VA.	601	0601-047-622, P101 R201, M501, B608	3

DESIGN FEATURES RELATING TO CONSTRUCTION OR TO REGULATION AND CONTROL OF TRAFFIC MAY BE SUBJECT TO CHANGE AS DEEMED NECESSARY BY THE DEPARTMENT

RW PLANS

THESE PLANS ARE UNFINISHED AND UNAPPROVED AND ARE NOT TO BE USED FOR ANY TYPE OF CONSTRUCTION.

Utility Owners

Electric:	Cable:
Dominion Virginia Power 701 East Cary Street Richmond, VA 23219 Telephone: 804-771-4795	Cox Communications 5200 Cleveland Street Virginia Beach, VA 23434 Telephone: 757-222-2027
Communications:	Water:
Verizon 2920 Elmhurst Lane Portsmouth, VA 23701 Telephone: 757-667-2697	Newport News Waterworks 700 Town Centre Drive Newport News, VA 23606 Telephone: 757-926-1000
AT&T	
10 N. Jefferson Street, Suite 308 Frederick, MD 21701 Telephone: 301-228-2502	

CURVE DATA

CURVE-1	CURVE-2	CURVE-3	CURVE-4
PI • 100-67.16	PI • 103-50.97	PI • 104-83.54	PI • 105-89.59
DELTA • 9° 25' 52.96" (RT)	DELTA • 2° 13' 48.60" (LT)	DELTA • 10° 36' 16.90" (LT)	DELTA • 15° 44' 29.26" (LT)
D • 11° 27' 33"	D • 10° 25' 03"	D • 10° 25' 03"	D • 14° 19' 26"
T • 41.25'	T • 10.71'	T • 51.05'	T • 55.30'
L • 82.30'	L • 21.41'	L • 101.80'	L • 109.90'
R • 500.00'	R • 550.00'	R • 550.00'	R • 400.00'
PC • 100-25.92	PC • 103-40.27	PC • 104-32.49	PC • 105-34.29
PT • 101-08.22	PT • 103-61.68	PCC • 105-34.29	PT • 106-44.19
NORMAL CROWN	NORMAL CROWN	NORMAL CROWN	NORMAL CROWN

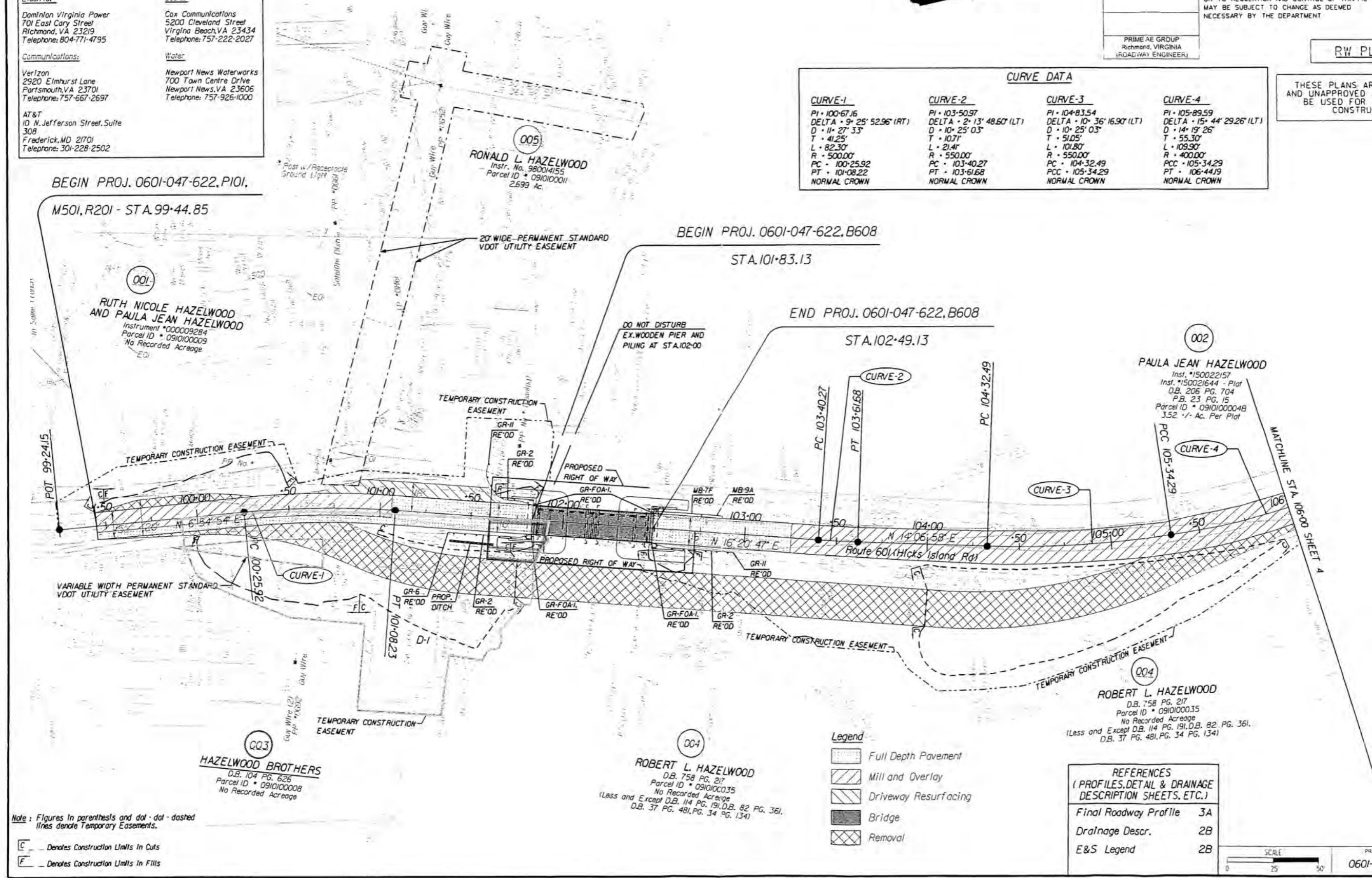

Legend

	Full Depth Pavement
	Mill and Overlay
	Driveway Resurfacing
	Bridge
	Removal

REFERENCES
(PROFILES, DETAIL & DRAINAGE DESCRIPTION SHEETS, ETC.)

Final Roadway Profile	3A
Drainage Descr.	2B
E&S Legend	2B

SCALE	PROJECT	SHEET NO.
0 25 50'	0601-047-622	3

Note: Figures in parenthesis and dot-dash lines denote Temporary Easements.

C — Denotes Construction Limits in Cuts
 F — Denotes Construction Limits in Fills