

200001502

BUILDING 2 (10-PLEX)

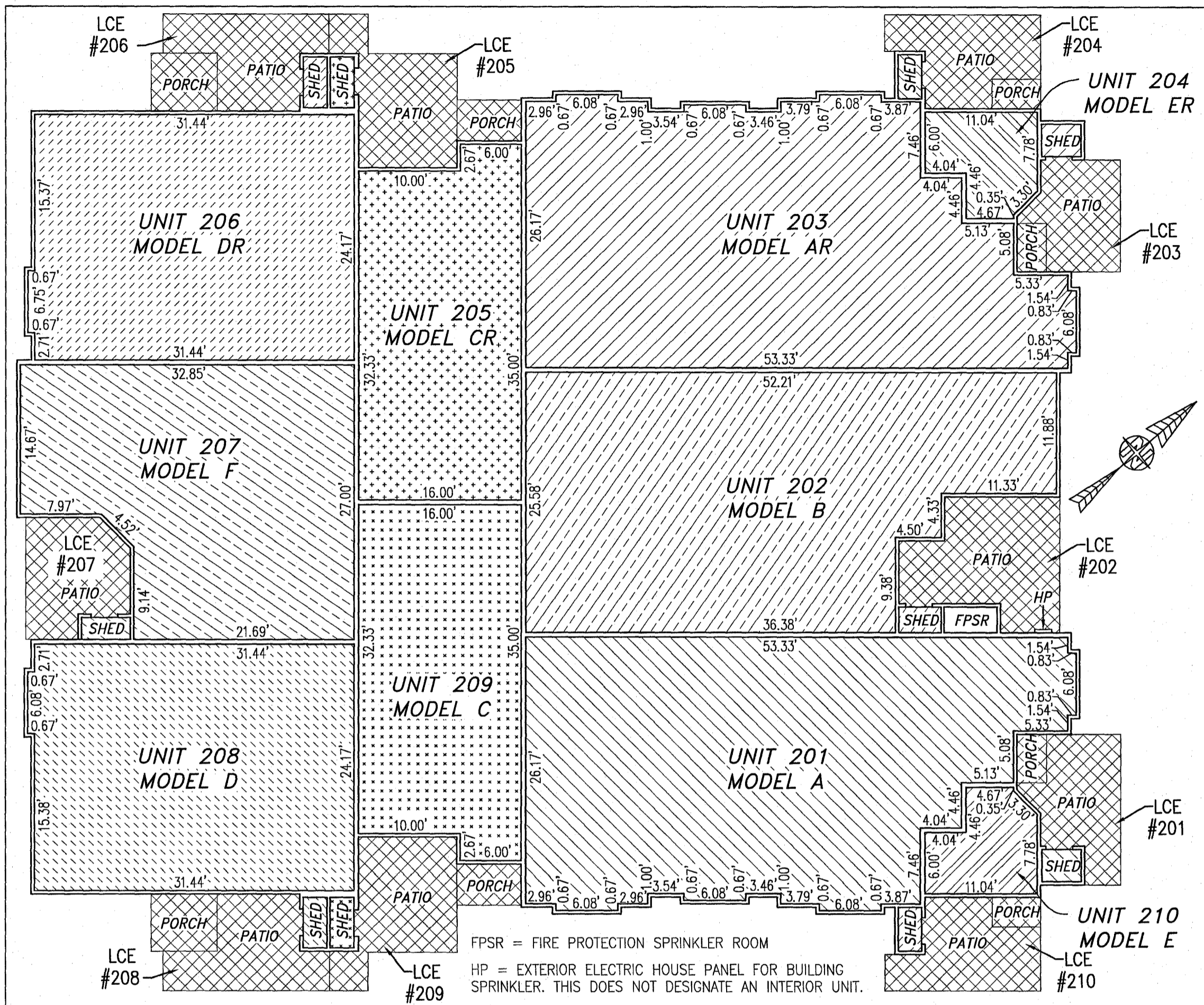

FIRST FLOOR

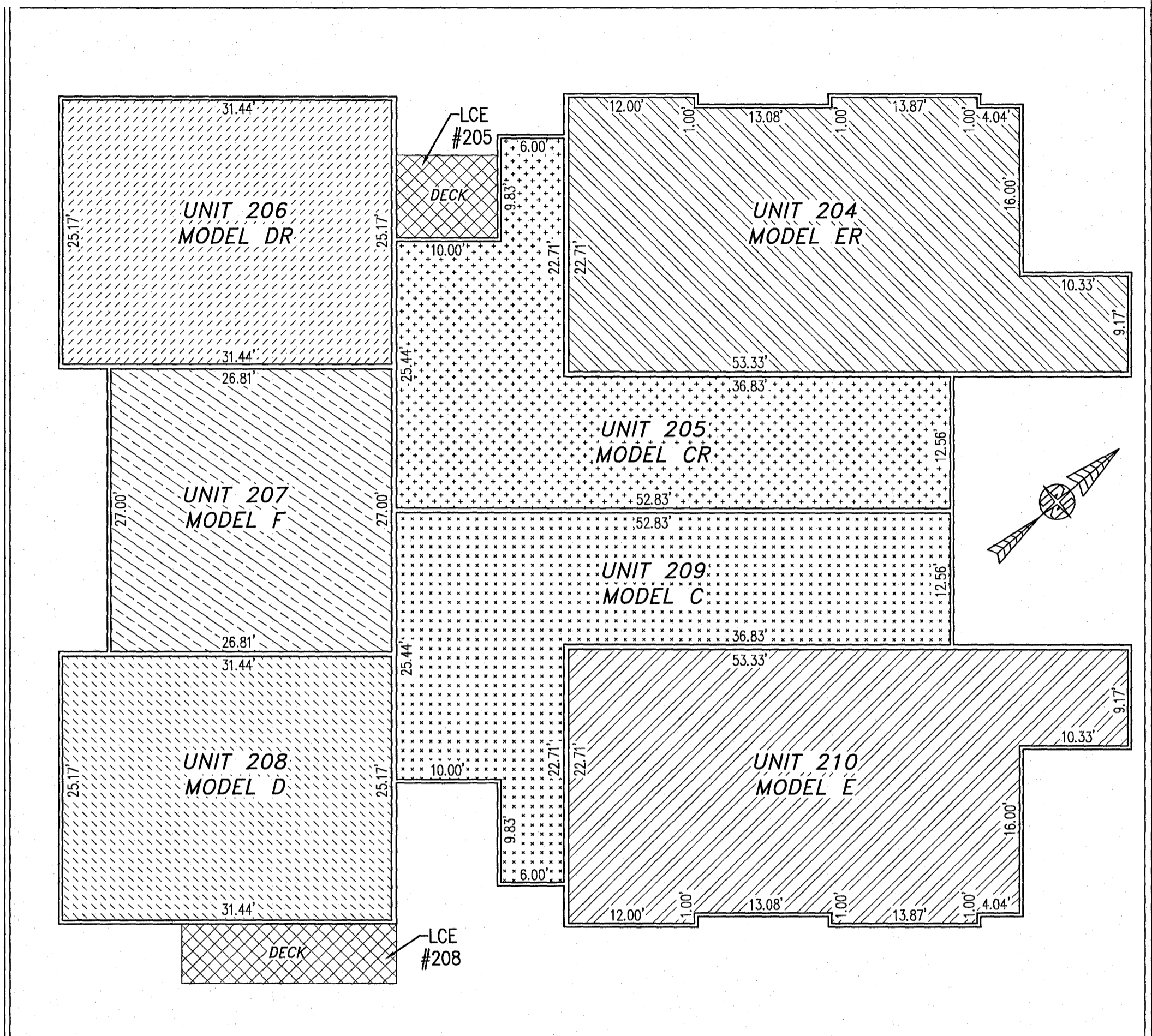

SECOND FLOOR

UNIT ID	UNIT DESCRIPTION	UNIT ADDRESS	PARKING SPACE
A	-INDICATES AREA OF UNIT 201	#201 PROMENADE LANE	216
B	-INDICATES AREA OF UNIT 202	#202 PROMENADE LANE	214
AR	-INDICATES AREA OF UNIT 203	#203 PROMENADE LANE	213
ER	-INDICATES AREA OF UNIT 204	#204 PROMENADE LANE	212
CR	-INDICATES AREA OF UNIT 205	#205 PROMENADE LANE	218
DR	-INDICATES AREA OF UNIT 206	#206 PROMENADE LANE	219
F	-INDICATES AREA OF UNIT 207	#207 PROMENADE LANE	221
D	-INDICATES AREA OF UNIT 208	#208 PROMENADE LANE	222
C	-INDICATES AREA OF UNIT 209	#209 PROMENADE LANE	223
E	-INDICATES AREA OF UNIT 210	#210 PROMENADE LANE	217
HP	HOUSE PANEL (ELECTRIC)	#211 PROMENADE LANE	N/A
FPSR	FIRE PROTECTION SPRINKLER ROOM	#212 PROMENADE LANE	N/A
	-INDICATES COMMON ELEMENT (EXCLUDING AREAS OUTSIDE OF SUBMITTED LAND)		
	-INDICATES LIMITED COMMON ELEMENT (LCE) ASSIGNED TO A UNIT. # UNIT ASSIGNED		

JCC Subdivision Agent Approval Not Required

I HEREBY CERTIFY THAT THIS PLAT IS ACCURATE AND THAT IT COMPLIES WITH THE PROVISIONS OF THE CODE OF VIRGINIA OF 1950 AS AMENDED, § 55.1-1920A & B AND I FURTHER CERTIFY THAT ALL IMPROVEMENTS THEREOF DEPICTED HEREON, PURSUANT TO THE CODE OF VIRGINIA § 55.1-1920B, ARE SUBSTANTIALLY COMPLETE.

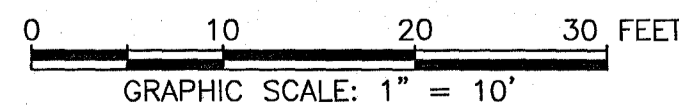

5 Large/Small Plat(s) Recorded herewith as # 200001502

City of Williamsburg & County of James City Circuit Court: This PLAT was recorded on January 31, 2020 at 2:12 AM PM PB PG Document # 200001502 MONA A. FOLEY, CLERK

THIS SHEET: FLOOR PLANS

PHASE 2
 CONDOMINIUM PLAT AND PLAN
 OF
THE PROMENADE
 AT
JOHN TYLER
 A CONDOMINIUM
 JAMES CITY COUNTY, VIRGINIA

Jo# 160921

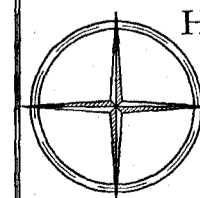

Hayden Frye and Associates, Inc.
 Land Surveyors
 333 KELLAM ROAD, SUITE 200
 VIRGINIA BEACH, VA, 23462
 PH: (757) 491-7228 FX: (757) 491-7229

DATE: JANUARY 17, 2020
 SCALE: 1"=10'
 SHEET 5 OF 5 THIS PHASE