

200001502

BUILDING 2 (10-PLEX)

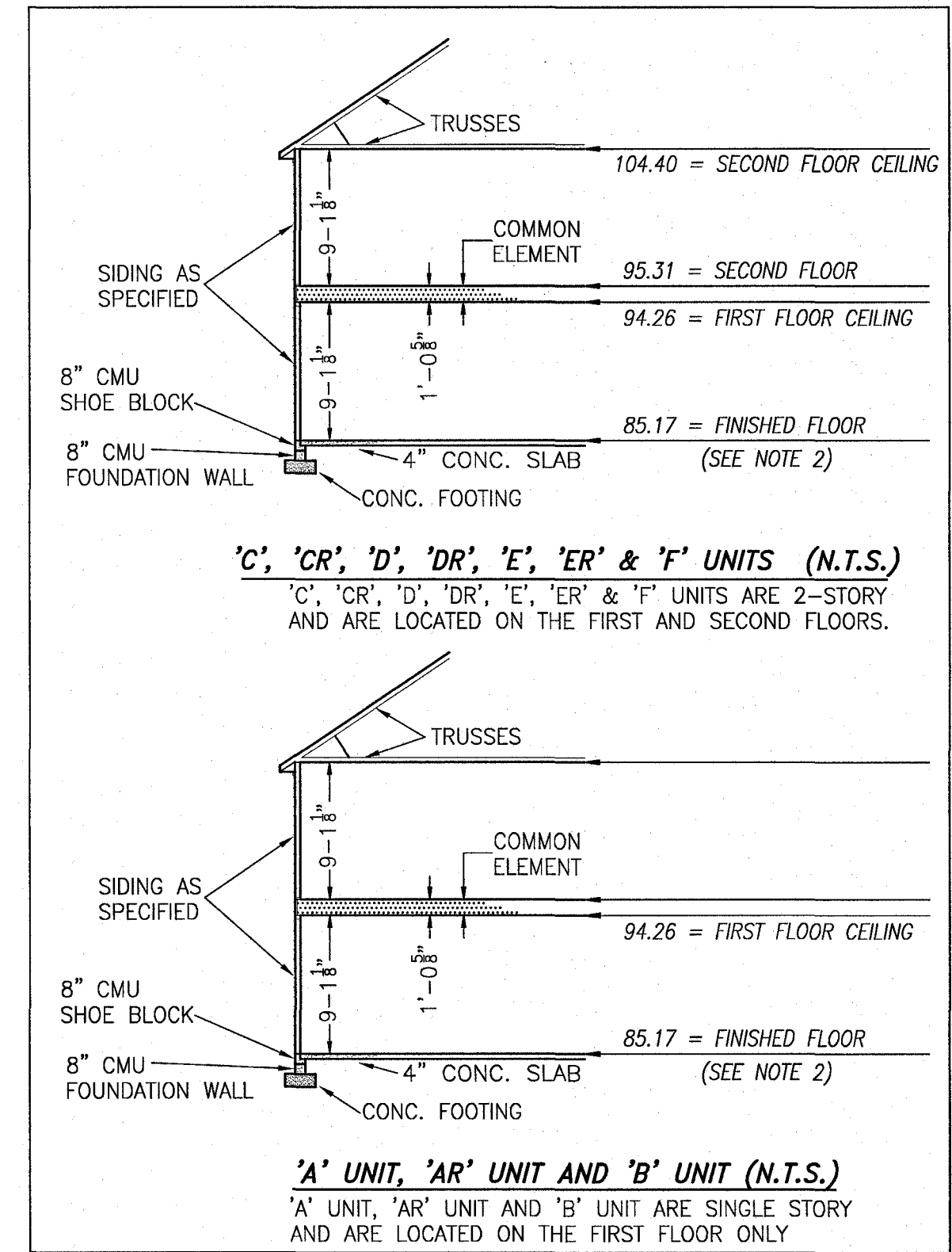
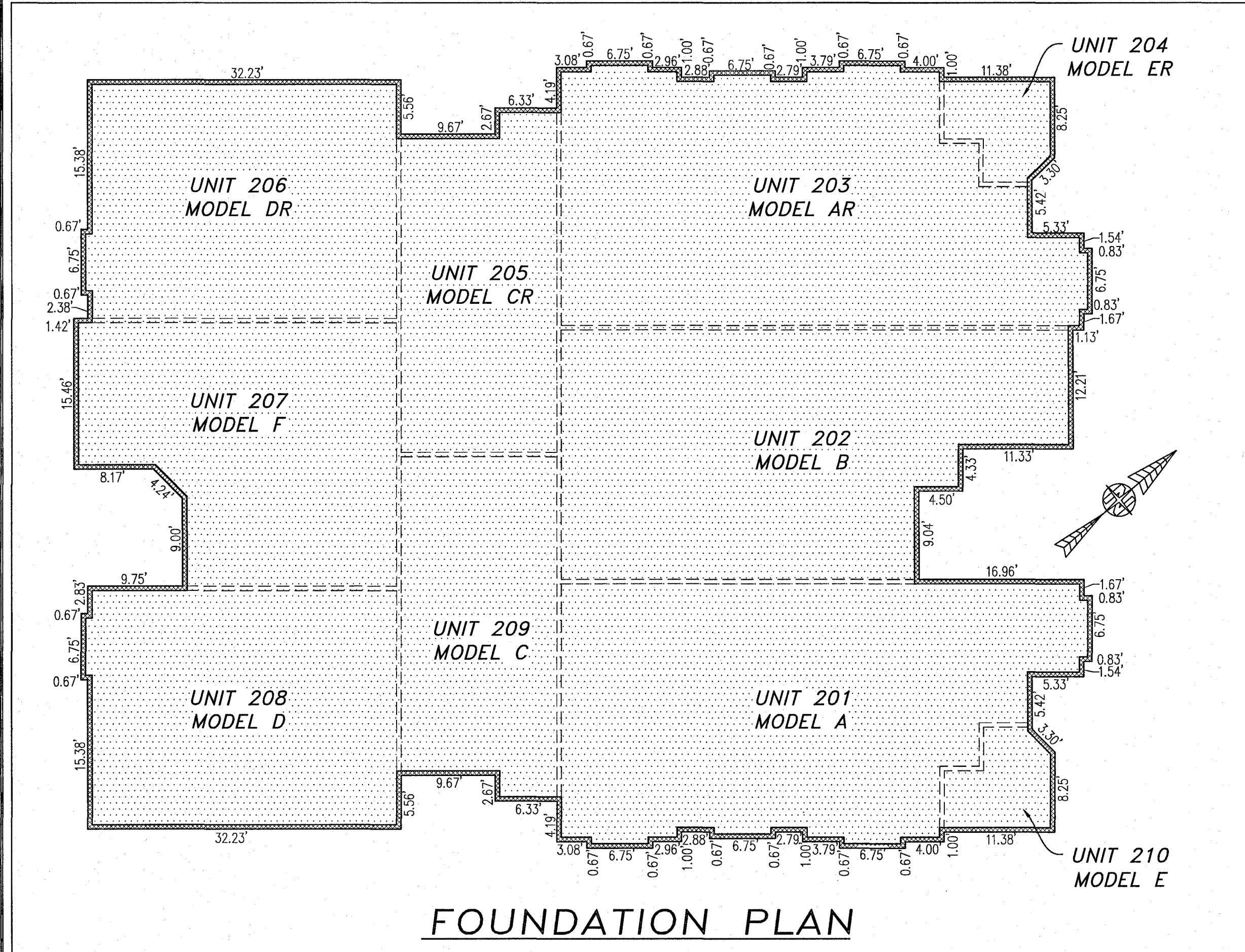

**TYPICAL BUILDING SECTION**  
 NOT TO SCALE (N.T.S.)

- NOTES:
1. VERTICAL DATUM REFERENCE: NATIONAL GEODETIC VERTICAL DATUM OF 1929 (NGVD29).
  2. FINISHED FLOOR ELEVATION SHOWN WAS TAKEN FROM AS-BUILT SURVEY OF BUILDING #2 (10-PLEX) THE PROMENADE AT JOHN TYLER BY HAYDEN FRYE AND ASSOCIATES PERFORMED ON 12/13/2019.

5 Large Small Plat(s) Recorded  
 herewith as # 200001502

City of Williamsburg & County of James City  
 Circuit Court: This PLAT was recorded on  
 January 31, 2020  
 at 2:12 AM (PM) PB PG  
 Document # 200001502  
 MONA A. FOLEY, CLERK  
 Clerk

I HEREBY CERTIFY THAT THIS PLAT IS ACCURATE AND THAT IT COMPLIES WITH THE PROVISIONS OF THE CODE OF VIRGINIA OF 1950 AS AMENDED, § 55.1-1920A & B AND I FURTHER CERTIFY THAT ALL IMPROVEMENTS THEREOF DEPICTED HEREON, PURSUANT TO THE CODE OF VIRGINIA § 55.1-1920B, ARE SUBSTANTIALLY COMPLETE.

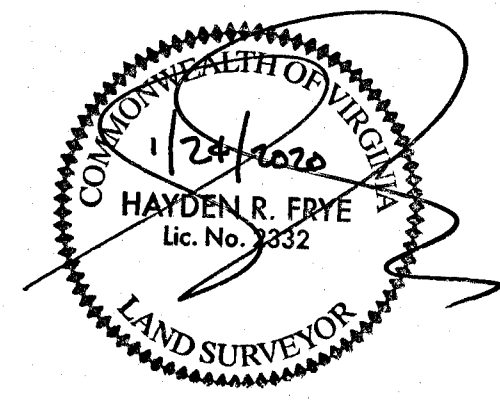

THIS SHEET: FOUNDATION PLAN AND SECTION

**PHASE 2**  
**CONDOMINIUM PLAT AND PLAN**  
 OF  
**THE PROMENADE**  
 AT  
**JOHN TYLER**  
 A CONDOMINIUM  
 JAMES CITY COUNTY, VIRGINIA

Jo# 160921

Hayden Frye and Associates, Inc.  
**Land Surveyors**  
 333 KELLAM ROAD, SUITE 200  
 VIRGINIA BEACH, VA, 23462  
 PH: (757) 491-7228 FX: (757) 491-7229

DATE: JANUARY 17, 2020  
 SCALE: 1"=10'  
 SHEET 4 OF 5 THIS PHASE

---INDICATES COMMON ELEMENT

JCC Subdivision Agent  
 Approval Not Required

