

NOTES:

1. THIS PLAT WAS PRODUCED WITHOUT THE BENEFIT OF A TITLE REPORT AND MAY NOT REFLECT ALL ENCUMBRANCES, EASEMENTS AND SETBACKS AFFECTING THE SUBJECT PROPERTY.
2. PROPERTY LINES AND EXISTING EASEMENT LINES SHOWN HEREON ARE APPROXIMATE AND ARE BASED ON A COMPILATION OF RECORDED PLATS BEST FIT TO PROPERTY CORNERS FOUND. THIS PLAT DOES NOT REPRESENT A BOUNDARY SURVEY OF ANY PROPERTIES SHOWN.
3. PHYSICAL IMPROVEMENTS NOT SHOWN.

WOODLAND ROAD

LINE	BEARING	DISTANCE
L1	N 65°54'25" E	7.51'
L2	N 81°52'12" E	42.42'
L3	S 86°34'46" E	17.97'
L4	S 67°02'36" E	49.78'
L5	S 78°56'35" E	15.49'
L6	N 65°35'40" E	35.16'
L7	N 85°23'37" E	38.54'
L8	S 43°19'36" E	20.53'
L9	S 72°15'58" E	20.29'
L10	N 72°22'14" E	36.29'
L11	N 77°10'11" E	49.23'
L12	S 67°23'15" E	67.36'
L13	N 75°31'50" E	18.56'
L14	N 65°35'40" E	35.31'
L15	N 85°23'37" E	37.88'
L16	S 43°19'36" E	20.30'
L17	S 72°15'58" E	20.87'
L18	N 71°55'34" E	42.01'



TEMPORARY  
CONSTRUCTION  
AND ACCESS  
EASEMENT  
1,036 S.F.

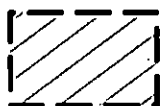

DRAINAGE  
EASEMENT TO  
JAMES CITY  
COUNTY  
7,462 S.F.

VA STATE PLANE  
SOUTH ZONE

LOT 7  
HOWARD E. BRACKENS, II  
INST. #090028411  
P.B. 29, PG. 3  
114 WOODLAND ROAD  
PARCEL ID: 1420200007

LOT 6

N 02°21'55" E  
502.21'(TOTAL)

VARIABLE WIDTH  
DRAINAGE EASEMENT  
TO JAMES CITY COUNTY

N 00°58'25" W 509.26'(TOTAL)

LOT 8

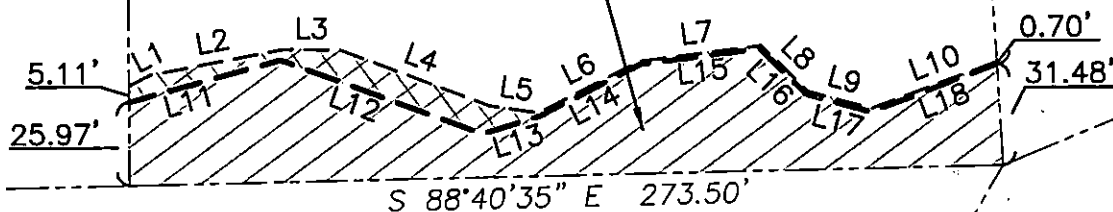

N/F HOENIG  
PARCEL ID #1420600005

N/F  
VANDENBURG  
PARCEL ID #142010001B

STATE OF VIRGINIA  
CITY OF WILLIAMSBURG & COUNTY OF JAMES CITY CIRCUIT COURT.  
THIS DAY OF \_\_\_\_\_, 2018.

THE PLAT SHOWN HEREON WAS PRESENTED AND ADMITTED TO  
THE RECORD AS THE LAW DIRECTS AT \_\_\_\_\_ AM/PM  
INSTRUMENT # \_\_\_\_\_

TESTE: \_\_\_\_\_  
MONA A. FOLEY, CLERK

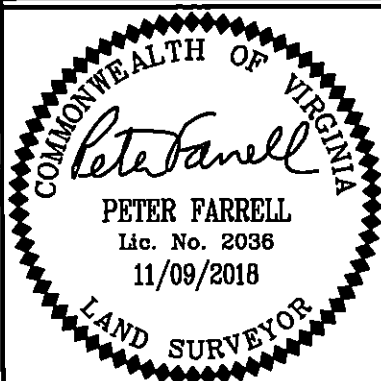

REFERENCES:  
P.B. 29, PG. 3

DATE: 11/09/18  
SCALE: 1"=60'  
JOB# 16-368  
CAD File  
17-368 ESMNT PLATS.dwg

PLAT SHOWING EASEMENTS TO BE GRANTED TO  
**JAMES CITY COUNTY**  
FROM  
**HOWARD E. BRACKENS, II**  
JAMES CITY COUNTY VIRGINIA

**LandTech Resources, Inc.**  
ENGINEERING & SURVEYING CONSULTANTS  
3925 Midlands Road, Williamsburg, Virginia 23188  
Telephone: 757-565-1677 Fax: 757-565-0782  
Web: landtechresources.com