

190017561

BUILDING 1 (10-PLEX)

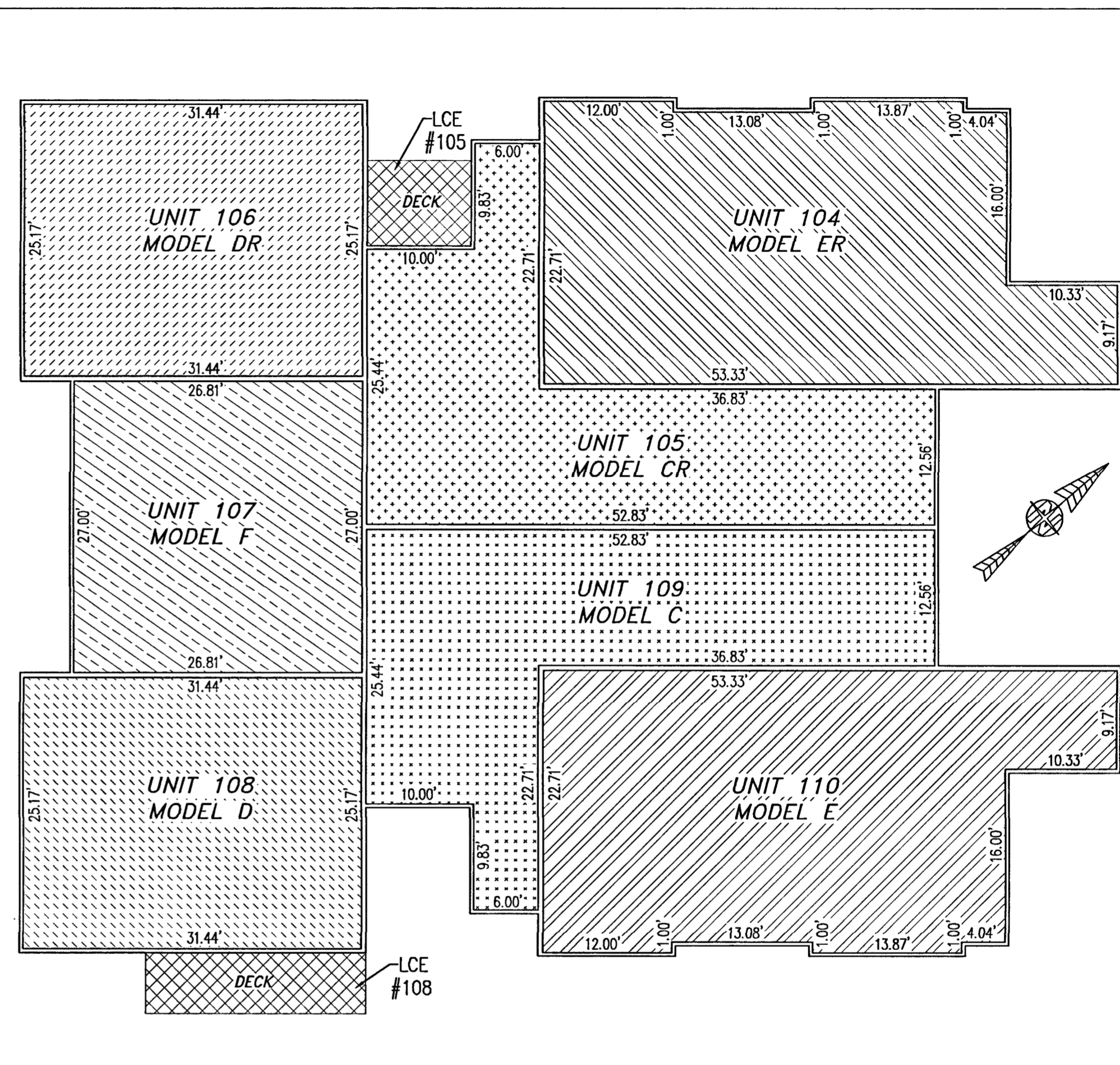
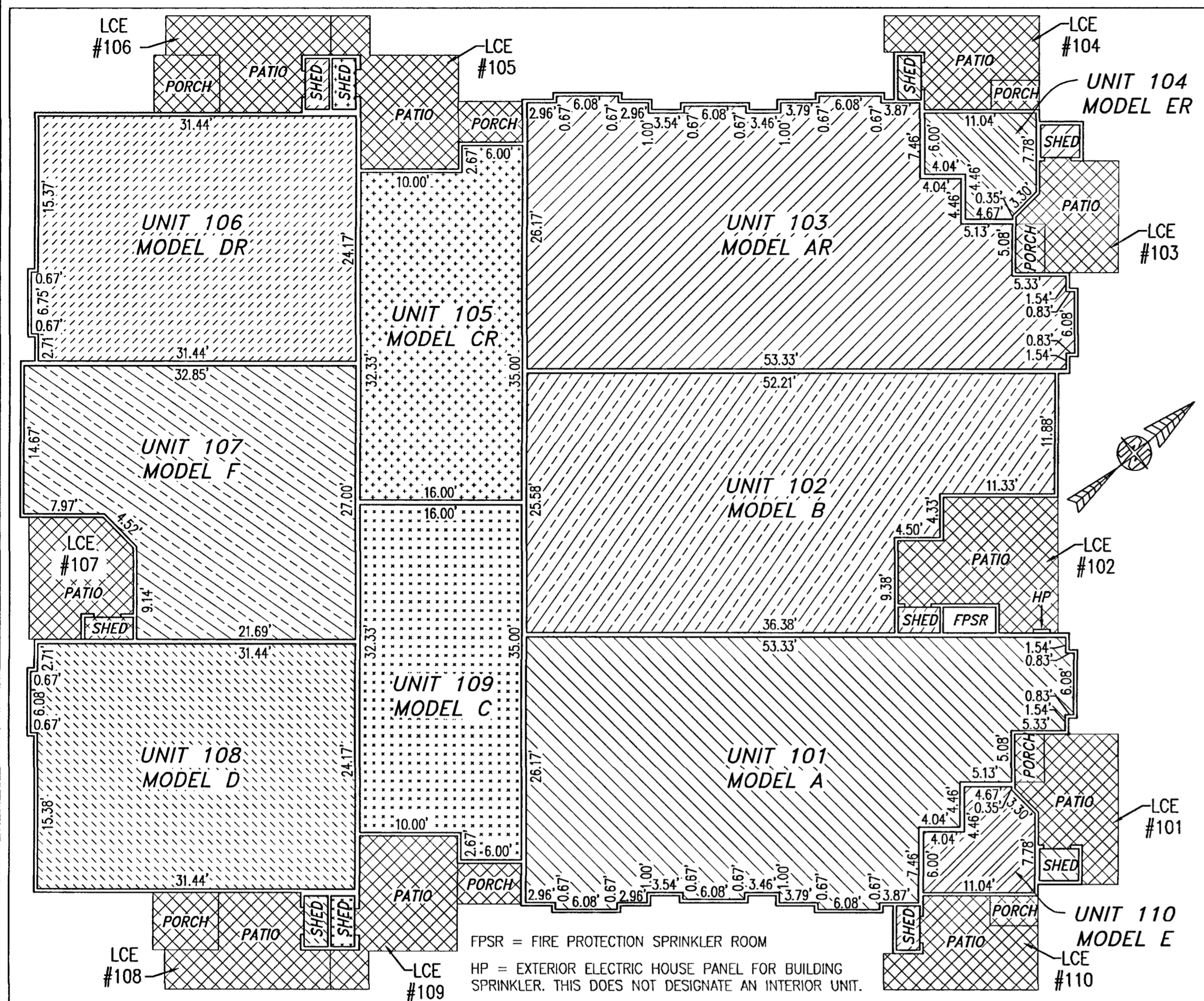

FIRST FLOOR

SECOND FLOOR

UNIT ID	UNIT DESCRIPTION	UNIT ADDRESS	PARKING SPACE
A	-INDICATES AREA OF UNIT 101	#101 PROMENADE LANE	6
B	-INDICATES AREA OF UNIT 102	#102 PROMENADE LANE	5
AR	-INDICATES AREA OF UNIT 103	#103 PROMENADE LANE	2
ER	-INDICATES AREA OF UNIT 104	#104 PROMENADE LANE	1
CR	-INDICATES AREA OF UNIT 105	#105 PROMENADE LANE	14
DR	-INDICATES AREA OF UNIT 106	#106 PROMENADE LANE	13
F	-INDICATES AREA OF UNIT 107	#107 PROMENADE LANE	11
D	-INDICATES AREA OF UNIT 108	#108 PROMENADE LANE	10
C	-INDICATES AREA OF UNIT 109	#109 PROMENADE LANE	9
E	-INDICATES AREA OF UNIT 110	#110 PROMENADE LANE	7
HP	HOUSE PANEL (ELECTRIC)	#111 PROMENADE LANE	N/A
FPSR	FIRE PROTECTION SPRINKLER ROOM	#112 PROMENADE LANE	N/A
	-INDICATES COMMON ELEMENT (EXCLUDING AREAS OUTSIDE OF SUBMITTED LAND)		
	-INDICATES LIMITED COMMON ELEMENT (LCE) ASSIGNED TO A UNIT. # UNIT ASSIGNED		

I HEREBY CERTIFY THAT THIS PLAT IS ACCURATE AND THAT IT COMPLIES WITH THE PROVISIONS OF THE CODE OF VIRGINIA OF 1950 AS AMENDED, § 55.1-1920A & B AND I FURTHER CERTIFY THAT ALL IMPROVEMENTS THEREOF DEPICTED HEREON, PURSUANT TO THE CODE OF VIRGINIA § 55.1-1920B, ARE SUBSTANTIALLY COMPLETE.

5 Large/Small Plat(s) Recorded
 herewith as # 190017561

City of Williamsburg & County of James City
 Circuit Court: This PLAT was recorded on
 Nov. 25, 2019
 at 2:36 PM, PG
 Document # 190017561
 MONA A. FOLEY, CLERK



JCC Subdivision Agent Approval Not Required

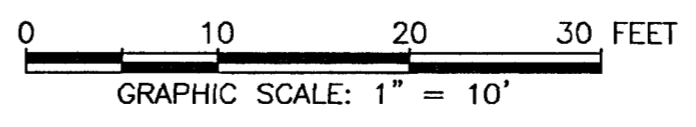

THIS SHEET: FLOOR PLANS

PHASE 52
CONDOMINIUM PLAT AND PLAN
 OF
THE PROMENADE
 AT
JOHN TYLER
 A CONDOMINIUM
 JAMES CITY COUNTY, VIRGINIA

Jo# 160921
 Hayden Frye and Associates, Inc.
Land Surveyors
 333 KILLAM ROAD, SUITE 200
 VIRGINIA BEACH, VA, 23462
 PH: (757) 491-7228 FX: (757) 491-7229

DATE: NOVEMBER 5, 2019
 SCALE: 1" = 10'
 SHEET 5 OF 5 THIS PHASE