

EASEMENT CURVE AND EASEMENT LINE TABLE						
EC1	DELTA=10°55'40"	RADIUS=960.00'	LENGTH=183.10'	TANGENT=91.83'	CHORD=182.82'	CHORD BEARING=S24°22'45"E
EL1	BEARING=S18°54'55"E	DISTANCE=19.41'				
EL2	BEARING=S79°31'21"W	DISTANCE=14.00'				
EL3	BEARING=S63°40'29"W	DISTANCE=16.28'				
EL4	BEARING=N18°54'55"W	DISTANCE=19.45'				
EC2	DELTA=10°55'40"	RADIUS=930.00'	LENGTH=177.37'	TANGENT=88.96'	CHORD=177.11'	CHORD BEARING=N24°22'45"W
EC3	DELTA=24°49'02"	RADIUS=830.00'	LENGTH=402.82'	TANGENT=204.62'	CHORD=399.68'	CHORD BEARING=N42°15'06"W
EC4	DELTA=24°11'58"	RADIUS=870.00'	LENGTH=367.45'	TANGENT=186.51'	CHORD=364.73'	CHORD BEARING=N42°33'38"W
EL5	BEARING=N30°27'39"W	DISTANCE=90.99'				

RIGHT-OF-WAY CURVE TABLE						
CURVE #	DELTA	RADIUS	LENGTH	TANGENT	CHORD	CHORD BEARING
C1	31°03'54"	1492.00'	808.94'	414.68'	799.07'	S45°59'36"E
C2	17°50'26"	840.00'	261.56'	131.85'	260.50'	S39°22'52"E
C3	24°49'02"	960.00'	415.82'	211.22'	412.57'	S42°15'06"E
C4	24°49'02"	840.00'	363.84'	184.82'	361.00'	N42°15'06"W
C5	24°11'58"	960.00'	405.46'	205.80'	402.46'	N42°33'38"W
C6	31°03'54"	1372.00'	743.68'	381.33'	734.80'	N45°59'36"W

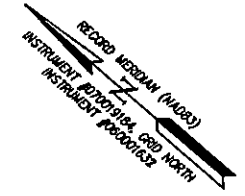
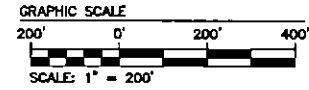

N OR F
HAYNES DISTRIBUTION, L.L.C.
INSTR. #060001420
PARCEL ID #6010200003C
LOT 3C
INSTR. #030032887 (PLAT)

PORTION OF EXISTING 30' INGRESS & EGRESS EASEMENT FROM PARCEL ID #6010100003 TO EXISTING GREEN MOUNT PARKWAY PER INSTRUMENT #150002349 TO BE VACATED EFFECTIVE WHEN GREEN MOUNT PARKWAY OPENS

EXISTING 30' INGRESS & EGRESS EASEMENT FROM PARCEL ID #6010100003 TO EXISTING GREEN MOUNT PARKWAY INSTRUMENT #150002349

RELOCATED 30' INGRESS & EGRESS EASEMENT FROM PARCEL ID #6010100003 TO EXISTING GREEN MOUNT PARKWAY HEREBY CREATED

N OR F
WAL-MART STORES EAST, LP
INSTR. #040013145
PARCEL ID #6010100010
LOT 2A
INSTR. #060001632 (PLAT)
410.3449 ACRES
INSTR. #040013144 (PLAT)
PLAT BOOK 77, PAGES 22 & 23

EXISTING 30' INGRESS & EGRESS EASEMENT FROM PARCEL ID #6010100003 TO EXISTING GREEN MOUNT PARKWAY INSTRUMENT #150002349

PORTION OF EXISTING 30' INGRESS & EGRESS EASEMENT FROM PARCEL ID #6010100003 TO EXISTING GREEN MOUNT PARKWAY PER INSTRUMENT #150002349 HEREBY VACATED AND RELOCATED NOW AS SHOWN HEREON

PART OF REMAINDER LOT 3A PARCEL ID #6010100004 INSTRUMENT #

EXISTING 120' RESERVATION OF INGRESS-EGRESS EASEMENT N OR F JAMES CITY COUNTY, VA INSTR. #070019184 PARCEL ID #6010100004B INSTR. #070019184 (EXHIBIT A) INSTRUMENT #

TRAVERSE LINE INSTR. #150002349 (NOT A PROPERTY LINE)

N OR F CITY OF NEWPORT NEWS, VA INSTR. #150002349 INSTR. #150002349 N=3651246.2900 E=12040423.5900

PROPERTY LINE INSTR. #150002349

REMAINDER LOT 3A PARCEL ID #6010100004 INSTRUMENT #030032887 AREA = 202.8281 ACRES INSTRUMENT #150002349 INSTRUMENT #

PROPERTY LINE INSTR. #150002349

PROPERTY LINE INSTR. #150002349

EXISTING GREEN MOUNT PARKWAY 120' RIGHT OF WAY FOR PUBLIC USE INSTRUMENT #030032887

- 30' INGRESS & EGRESS EASEMENT HATCH LEGEND**
- HEREBY VACATED AND RELOCATED
 - TO BE VACATED EFFECTIVE WHEN GREEN MOUNT PARKWAY OPENS
 - RELOCATED AND HEREBY CREATED

N OR F
CITY OF NEWPORT NEWS, VA
NEWPORT NEWS WATERWORKS DEPARTMENT
"SKIFFES CREEK RESERVOIR"
INSTR. #150002349
DEED BOOK 18, PAGE 215
PARCEL ID #6010100003

SKIFFES CREEK RESERVOIR

EXISTING LOT 1, PHASE 2 INSTRUMENT #

PORTION OF EXISTING 30' INGRESS & EGRESS EASEMENT FROM PARCEL ID #6010100003 TO EXISTING GREEN MOUNT PARKWAY PER INSTRUMENT #150002349 HEREBY VACATED AND RELOCATED NOW AS SHOWN HEREON

PROPOSED GREEN MOUNT PARKWAY 120' PUBLIC R/W INSTRUMENT #

PART OF REMAINDER LOT 3A PARCEL ID #6010100004 INSTRUMENT #

EXISTING TEMPORARY TURN-AROUND EASEMENT INSTR. #

EXISTING 20' DRAINAGE EASEMENT INSTR. #

FUTURE RIGHT OF WAY

PROPERTY LINE INSTR. #150002349

PROPERTY LINE INSTR. #150002349

Rev.	Date	Description	Revised By

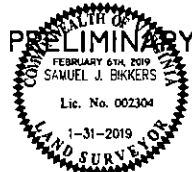

AES
CONSULTING ENGINEERS
2248 Old Towne Road, Suite 1
Williamsburg, Virginia 23108
Phone: (757) 263-0040
Fax: (757) 222-8994
www.aesva.com
Hampson Roads | Central Virginia | Middle Peninsula

EXHIBIT SHOWING VACATED AND RELOCATED PORTIONS OF THE 30' INGRESS & EGRESS EASEMENT FROM PARCEL ID #6010100003 TO EXISTING GREEN MOUNT PARKWAY PREPARED FOR GREEN MOUNT ASSOCIATES, L.L.C.
ROBERTS DISTRICT JAMES CITY COUNTY VIRGINIA

Project Contact: SJB
Project Number: W10231-09
Scale: 1" = 200'
Date: 01-31-2019
Sheet Number
1 OF 1