

190010971

BUILDING 48 (DUPLEX)

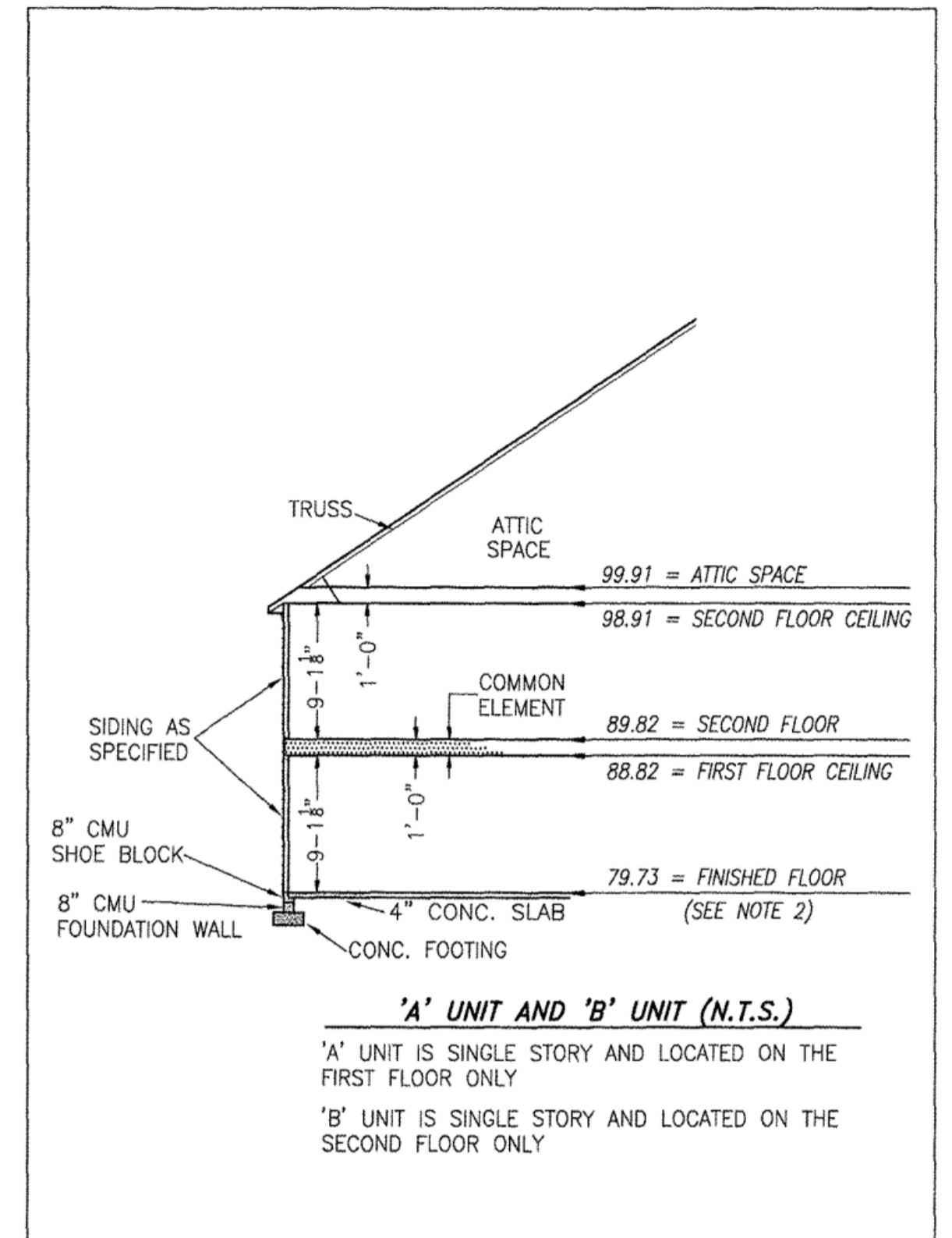
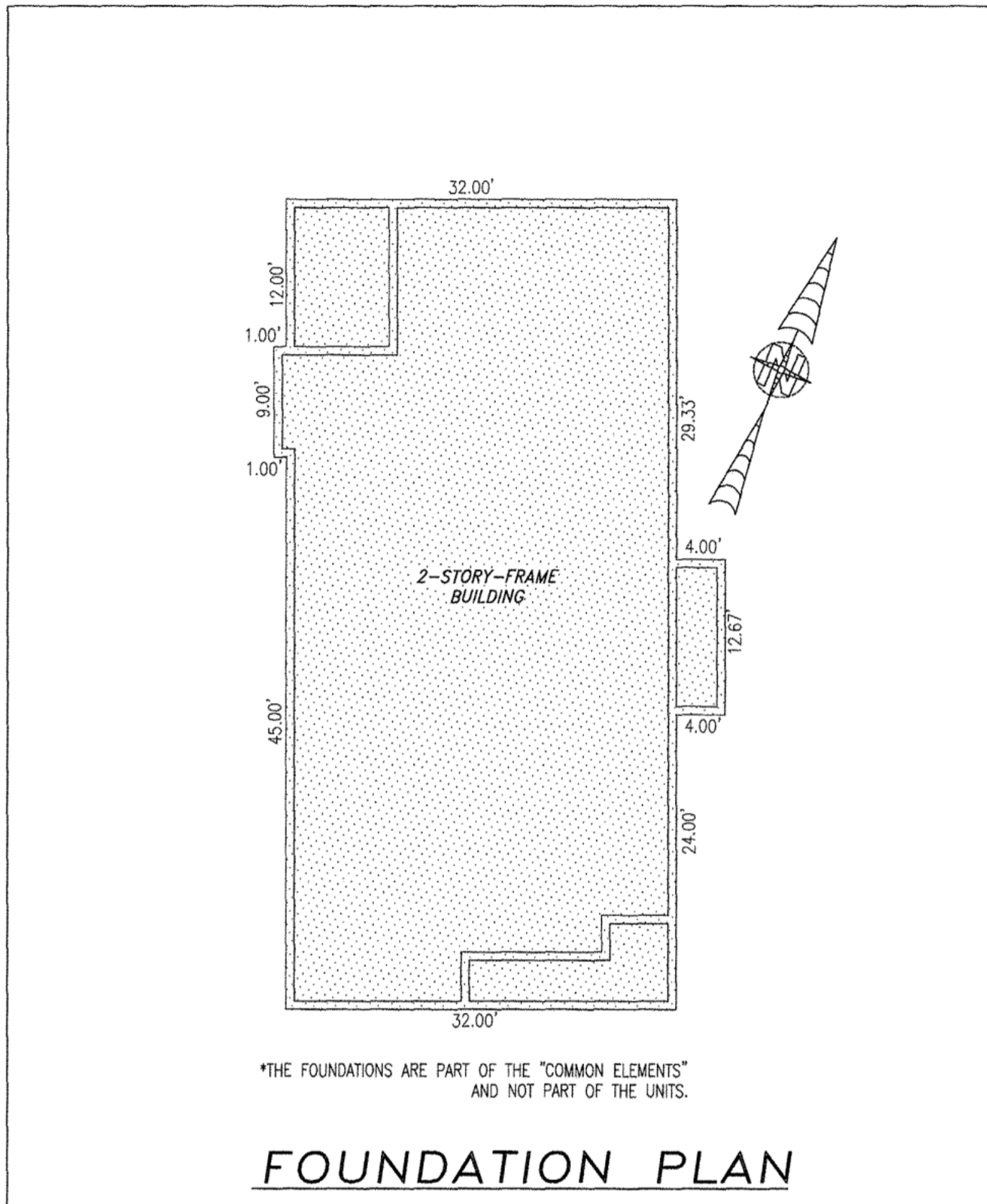

TYPICAL BUILDING SECTION

NOT TO SCALE (N.T.S.)

- NOTES:
1. VERTICAL DATUM REFERENCE: NATIONAL GEODETIC VERTICAL DATUM OF 1929 (NGVD29).
 2. FINISHED FLOOR ELEVATION SHOWN WAS TAKEN FROM AS-BUILT SURVEY OF BUILDING #48 (DUPLEX) THE PROMENADE AT JOHN TYLER BY HAYDEN FRYE AND ASSOCIATES. FIELD WORK WAS PERFORMED ON 05-15-19.

I HEREBY CERTIFY THAT THIS PLAN IS ACCURATE AND THAT IT COMPLIES WITH THE PROVISIONS OF THE CODE OF VIRGINIA OF 1950 AS AMENDED, § 55-79.58 AND I FURTHER CERTIFY THAT ALL UNITS THEREOF DEPICTED HEREON, PURSUANT TO THE CODE OF VIRGINIA § 55-79.58B, ARE SUBSTANTIALLY COMPLETE.



5 Large/Small Plat(s) Recorded herewith as # 190010971

-INDICATES COMMON ELEMENT

City of Williamsburg & County of James City
Circuit Court: This PLAT was recorded on
July 31, 2019
at 9:45 AM/PM, PB PG
Document # 190010971

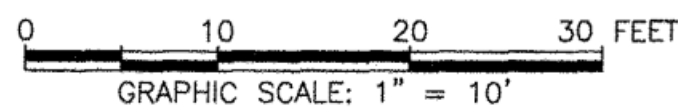

JCC Subdivision Agent Approval Not Required *EGC*

MONA A. FOLEY, CLERK
Mona A. Foley
Clerk

THIS SHEET: FOUNDATION PLAN AND SECTION

PHASE 48
CONDOMINIUM PLAT AND PLAN
OF
THE PROMENADE
AT
JOHN TYLER
A CONDOMINIUM
JAMES CITY COUNTY, VIRGINIA

Jo# 160921

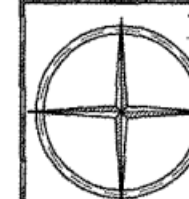

Hayden Frye and Associates, Inc.
Land Surveyors
333 KELLAM ROAD, SUITE 200
VIRGINIA BEACH, VA., 23462
PH: (757) 491-7228 FX: (757) 491-7229

DATE: MAY 16, 2019
SCALE: 1"=10'
SHEET 4 OF 5 THIS PHASE