

182857

I, JUDY G. BEALE, A LICENSED LAND SURVEYOR, DO HEREBY CERTIFY THAT THIS SUBDIVISION WAS MADE BY ME AT THE DIRECTION OF THE OWNER, AND THAT THIS SUBDIVISION IS ENTIRELY WITHIN THE BOUNDARIES OF LAND OWNED BY HS APT LAND LC, AND THAT STEEL PINS AND OTHER MONUMENTATION, AS SHOWN ON THIS PLAT BY SMALL CIRCLES, HAVE ACTUALLY BEEN PLACED AND THEIR LOCATIONS CORRECTLY SHOWN.

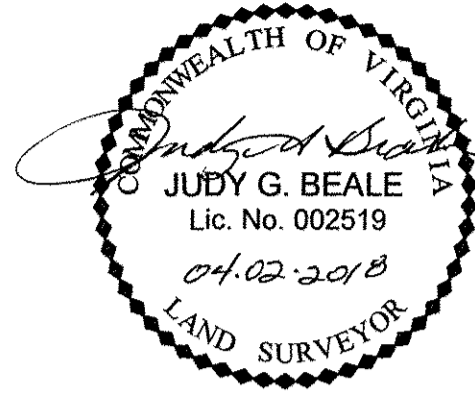

SOURCE OF TITLE:

THE PROPERTY EMBRACED WITHIN THE LIMITS OF THIS SUBDIVISION OF LAND WAS CONVEYED TO HS APT LAND LC FROM WILLIAMSBURG HIGH STREET HOLDINGS, L.L.C. AND THE TOWNHOMES AT TREYBURN PHASE I L.L.C. BY DEED DATED JULY 19, 2017, AND RECORDED JULY 25, 2017 AS INSTRUMENT NUMBER 173267 IN THE CLERK'S OFFICE OF THE CIRCUIT COURT OF WILLIAMSBURG, VIRGINIA.

OWNER'S CERTIFICATE:

THE PLATTING OR DEDICATION OF LOTS 9-1 BLOCK 3, LOTS 12-16 BLOCK 4, LOTS 17-21 BLOCK 5, LOTS 22-24 BLOCK 6, LOTS 33-36 BLOCK 9, LOTS 37-41 BLOCK 10, LOTS 42-47 BLOCK 11, LOTS 48-53 BLOCK 12; LANE C; LANE D; THE SOUTHERLY PORTIONS OF MANOR BOULEVARD, LANE A & LANE B; AND A PORTION OF SHADOW LANE IS WITH THE FREE CONSENT AND IN ACCORDANCE WITH THE DESIRE OF THE UNDERSIGNED OWNER, PROPRIETORS AND TRUSTEES, IF ANY.

Edward D. Mitchell

DATE: 4/10/18

EDWARD D. MITCHELL, MANAGER OF DEVON, LC
MANAGER OF HS APT LAND LC,

STATE OF VIRGINIA
CITY/COUNTY OF Richmond, TO WIT:
I, Traci Clark, A NOTARY PUBLIC IN AND FOR THE CITY/COUNTY AND STATE AFORESAID, DO HEREBY CERTIFY THAT EDWARD D. MITCHELL AS MANAGER OF DEVON LC, MANAGER OF HS APT LAND LC HAS ACKNOWLEDGED THE SAME BEFORE ME IN MY CITY/COUNTY AND STATE AFORESAID.

GIVEN UNDER MY HAND THIS 10th DAY OF April, 2018.

NOTARY PUBLIC: *Traci Clark* REG. NO. 7609826

MY COMMISSION EXPIRES: 3/31/22



2 Large/Small Plat(s) Recorded
herewith as # 182857

THE UNDERSIGNED DO HEREBY CERTIFY THAT THIS SUBDIVISION IS IN ACCORDANCE WITH THE REQUIREMENTS RELATING TO THE SUBDIVISION OF LAND AND IS HEREBY ACCORDINGLY APPROVED.

SIGNED: *Carolyn A. Murphy* DATE: 5-9-18
CAROLYN A. MURPHY
PLANNING AND CODES COMPLIANCE DIRECTOR, CITY OF WILLIAMSBURG

VIRGINIA:

IN THE CLERK'S OFFICE OF THE CIRCUIT COURT OF THE CITY OF WILLIAMSBURG, VIRGINIA ON THIS 17th DAY OF May, 2018, THIS PLAT WAS RECEIVED AND ADMITTED TO RECORD IN INSTRUMENT NUMBER 182857 AT 10:44am

TESTE: MONA A. FOLEY, CLERK, CLERK *Jeff Zitzler DC.*

NOTES:

1. BEARINGS AND DISTANCES SHOWN HEREON ARE BASED ON VIRGINIA STATE PLANE COORDINATE SYSTEM, SOUTH ZONE, NAD 83, CITY OF WILLIAMSBURG CONTROL NETWORK.
2. IT IS THE INTENT OF THIS PLAT TO VACATE THE INTERNAL LOT LINES AND BLOCK LINES OF BLOCKS 3, 4, 5, 6, 9, 10, 11 AND 12 AS CREATED BY PLAT ENTITLED "SUBDIVISION OF PARCEL B PROPERTY OF TOWNHOMES AT TREYBURN PHASE I, LLC (INSTR. NO. 061836, INSTR. NO. 071836), WILLIAMSBURG, VIRGINIA" DATED JULY 6, 2005, LAST REVISED AUGUST 3, 2007, RECORDED AS INSTR. NO. 080016.
3. ALL EXISTING EASEMENTS ARE TO REMAIN.
4. 10' PRIVATE DRAINAGE EASEMENTS WITHIN BLOCKS 3, 4, 5, 6, 9, 10, 11 AND 12 AS SHOWN ON PLAT RECORDED AS INSTR. NO. 080016 WERE TERMINATED IN INSTR. NO. 173264.
5. 5' PEDESTRIAN ACCESS EASEMENT WITHIN LOT 24 BLOCK 6 AS SHOWN ON PLAT RECORDED AS INSTR. NO. 080016 WAS TERMINATED IN INSTR. NO. 173264.
6. LOTS 9-1 BLOCK 3, LOTS 12-16 BLOCK 4, LOTS 17-21 BLOCK 5, LOTS 22-24 BLOCK 6, LOTS 33-36 BLOCK 9, LOTS 37-41 BLOCK 10, LOS 42-47 BLOCK 11, AND LOTS 48-53 BLOCK 12 ARE UNIMPROVED.
7. TOTAL AREA ENCOMPASSED WITHIN THE LIMITS OF THIS SUBDIVISION = 207,126 SQ. FT. OR 4.755 ACRES.
8. THIS PLAT MAY NOT SHOW ALL EASEMENTS THAT AFFECT THE PROPERTY SHOWN HEREON.

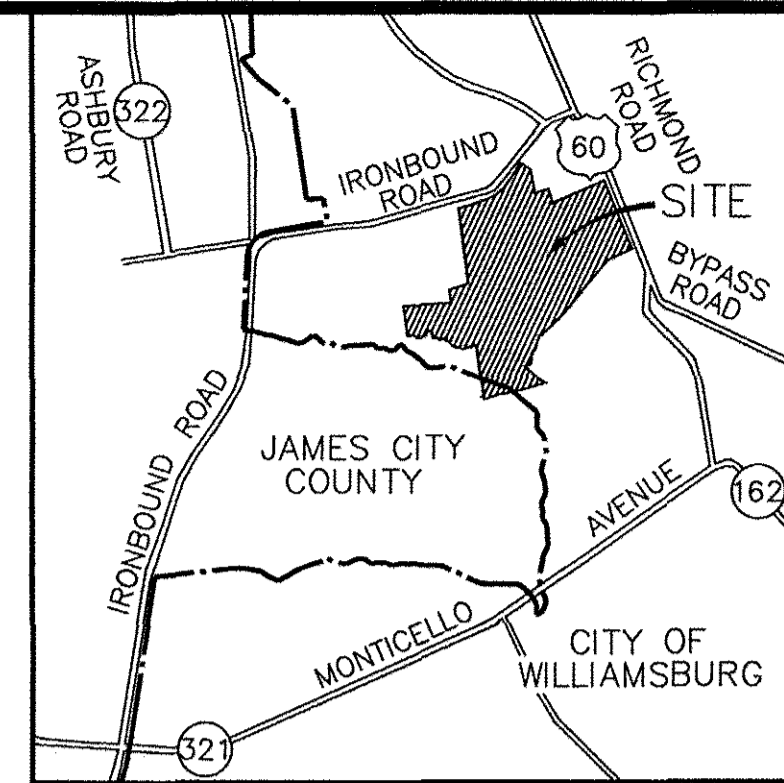

VICINITY MAP
1"=2000'

OWNER OF RECORD:

HS APT LAND LC
1415 E. MAIN STREET
RICHMOND, VA 23219

RESUBDIVISION
OF
LOTS 9-11 BLOCK 3, LOTS 12-16 BLOCK 4, LOTS 17-21 BLOCK 5, LOTS 22-24 BLOCK 6, LOTS 33-36 BLOCK 9, LOTS 37-41 BLOCK 10, LOTS 42-47 BLOCK 11, LOTS 48-53 BLOCK 12; LANE C; LANE D; THE SOUTHERLY PORTIONS OF MANOR BOULEVARD, LANE A & LANE B; AND A PORTION OF SHADOW LANE
(INSTR. No. 080016, INSTR. No. 173267)
WILLIAMSBURG, VIRGINIA

	676 INDEPENDENCE PKWY	DES. <u>N/A</u>	JOB NO. <u>77606.05</u>
	SUITE 100	DRN. <u>JGB</u>	SCALE <u>1"=50'</u>
	CHESAPEAKE, VA 23320	CKD. <u>JGB</u>	DATE <u>07-29-2017</u>
	757.549.3549 FAX: 757.549.3450		

SHEET NO. 1 OF 2
FILE NO. Parcel B Resub.dwg