

SCALE 1"=500'
 0 500' 1000'
 CURVE AND LINE INFORMATION, SEE SHEET 4

4 Large/Small Plat(s) Recorded
 herewith as # 180020132

City of Williamsburg & County of James City
 Circuit Court: This PLAT was recorded on
 19 Dec 2018
 at 3:56 AM/PM, PB — PG —
 Document # 180020132
 MONA A. FOLEY, CLERK
Mona Foley, Clerk

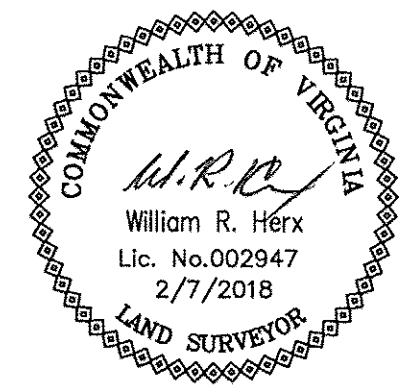

Subdivision Plat Showing
 Pump House Parcel on
 Stonehouse Tract 3

| | |
|---------------------------------------|-----------------------|
| Stonehouse District | James City County, VA |
| DATE: Feb. 7, 2018 | SCALE: 1" = 500' |
| SHEET 2 OF 4 | J.N.: 34549.005 |
| DRAWN BY: W.R. Herx | CHECK BY: W.R. Herx |
| REV: August 1, 2018 - County Comments | |

YOUR VISION ACHIEVED THROUGH OURS.
 THIS DRAWING PREPARED AT THE
CORPORATE OFFICE
 1001 Boulders Parkway, Suite 300 | Richmond, VA 23225
 TEL 804.200.6500 FAX 804.560.1016 www.timmons.com
Technology
Infrastructure
Residential
Site Development

TIMMONS GROUP