

180018358

# BUILDING 6 (10-PLEX)

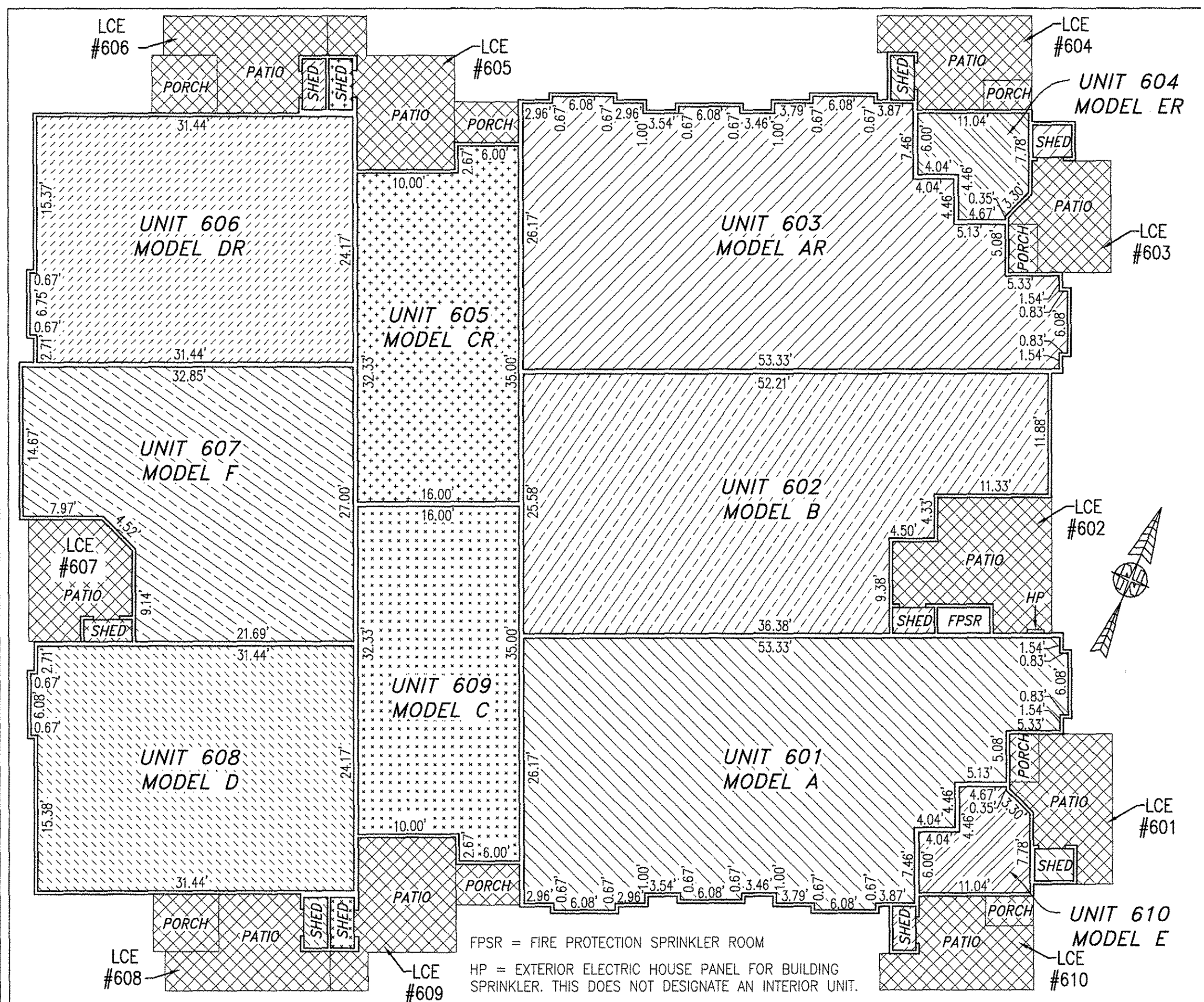

**FIRST FLOOR**

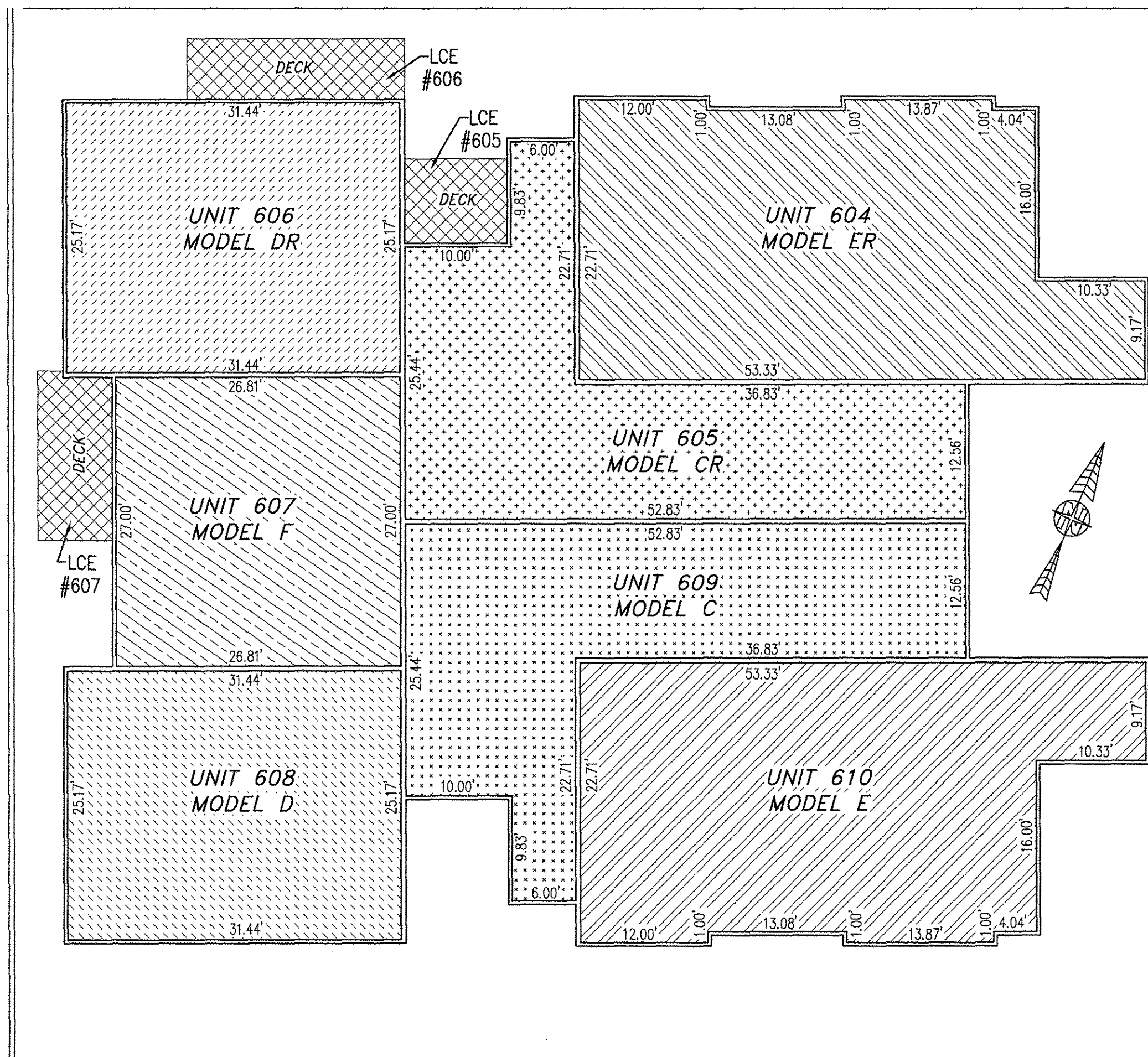

**SECOND FLOOR**

UNIT ID	UNIT DESCRIPTION	UNIT ADDRESS	PARKING SPACE
A	-INDICATES AREA OF UNIT 601	#601 PROMENADE LANE	98
B	-INDICATES AREA OF UNIT 602	#602 PROMENADE LANE	97
AR	-INDICATES AREA OF UNIT 603	#603 PROMENADE LANE	96
ER	-INDICATES AREA OF UNIT 604	#604 PROMENADE LANE	95
CR	-INDICATES AREA OF UNIT 605	#605 PROMENADE LANE	92
DR	-INDICATES AREA OF UNIT 606	#606 PROMENADE LANE	89
F	-INDICATES AREA OF UNIT 607	#607 PROMENADE LANE	80
D	-INDICATES AREA OF UNIT 608	#608 PROMENADE LANE	79
C	-INDICATES AREA OF UNIT 609	#609 PROMENADE LANE	78
E	-INDICATES AREA OF UNIT 610	#610 PROMENADE LANE	77
HP	HOUSE PANEL (ELECTRIC)	#611 PROMENADE LANE	N/A
FPSR	FIRE PROTECTION SPRINKLER ROOM	#612 PROMENADE LANE	N/A
	-INDICATES COMMON ELEMENT (EXCLUDING AREAS OUTSIDE OF SUBMITTED LAND)		
	-INDICATES LIMITED COMMON ELEMENT (LCE) ASSIGNED TO A UNIT. # UNIT ASSIGNED		

I HEREBY CERTIFY THAT THIS PLAN IS ACCURATE AND THAT IT COMPLIES WITH THE PROVISIONS OF THE CODE OF VIRGINIA OF 1950 AS AMENDED, § 55-79.58 AND I FURTHER CERTIFY THAT ALL UNITS THEREOF DEPICTED HEREON, PURSUANT TO THE CODE OF VIRGINIA § 55-79.58B, ARE SUBSTANTIALLY COMPLETE.

5 Large/Small-Plat(s) Recorded  
herewith as # 180018358

City of Williamsburg & County of James City  
Circuit Court: This PLAT was recorded on  
Nov. 13, 2018  
at 8:47 AM/PM, PG  
Document # 180018358  
MONA A. FOLEY, CLERK  
Mona Foley, Clerk



JCC Subdivision Agent *EOL*  
Approval Not Required

THIS SHEET: FLOOR PLANS

**PHASE 6**  
**CONDOMINIUM PLAT AND PLAN**  
OF  
**THE PROMENADE**  
AT  
**JOHN TYLER**  
A CONDOMINIUM  
JAMES CITY COUNTY, VIRGINIA

Jo# 160921

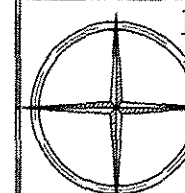

Hayden Frye and Associates, Inc.  
**Land Surveyors**

333 KELLAM ROAD, SUITE 200  
VIRGINIA BEACH, VA., 23462  
PH: (757) 491-7228 FX: (757) 491-7229

DATE: NOVEMBER 5, 2018

SCALE: 1"=10'

SHEET 5 OF 5 THIS PHASE