

180010369

BUILDING 8 (10-PLEX)

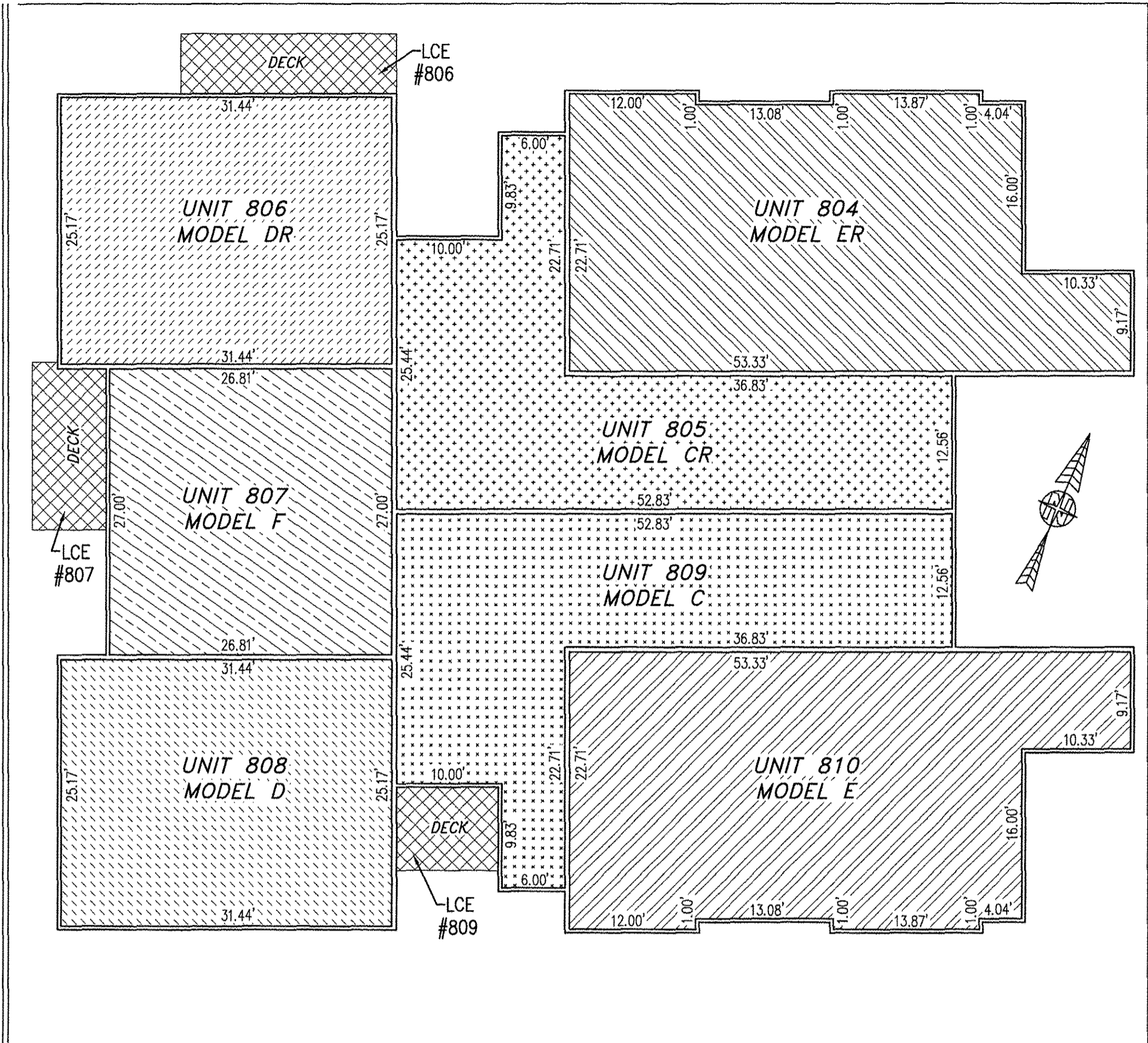
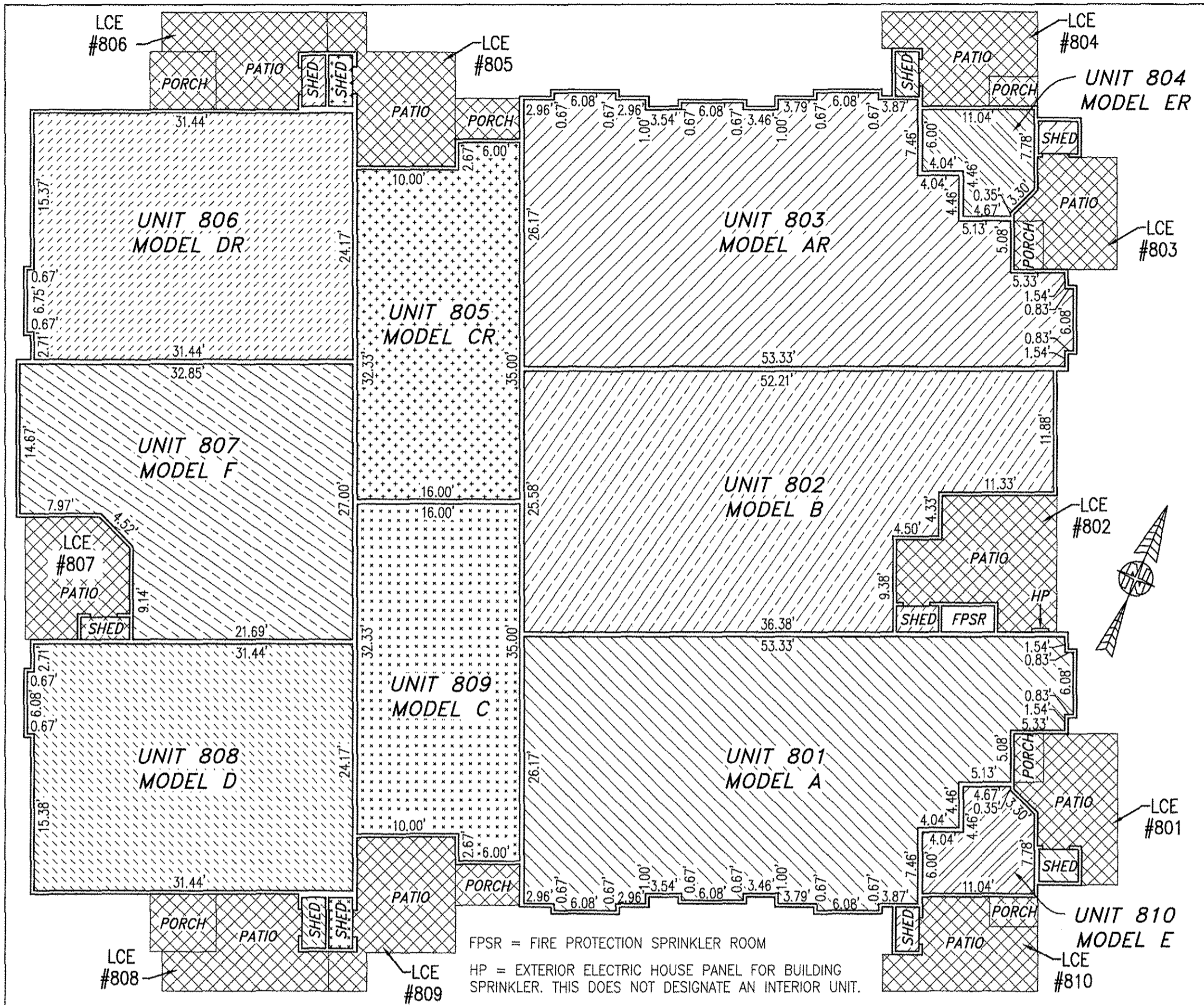

FIRST FLOOR

SECOND FLOOR

UNIT ID	UNIT DESCRIPTION	UNIT ADDRESS	PARKING SPACE
A	-INDICATES AREA OF UNIT 801	#801 PROMENADE LANE	150
B	-INDICATES AREA OF UNIT 802	#802 PROMENADE LANE	149
AR	-INDICATES AREA OF UNIT 803	#803 PROMENADE LANE	148
ER	-INDICATES AREA OF UNIT 804	#804 PROMENADE LANE	147
CR	-INDICATES AREA OF UNIT 805	#805 PROMENADE LANE	146
DR	-INDICATES AREA OF UNIT 806	#806 PROMENADE LANE	142
F	-INDICATES AREA OF UNIT 807	#807 PROMENADE LANE	131
D	-INDICATES AREA OF UNIT 808	#808 PROMENADE LANE	130
C	-INDICATES AREA OF UNIT 809	#809 PROMENADE LANE	129
E	-INDICATES AREA OF UNIT 810	#810 PROMENADE LANE	128
HP	HOUSE PANEL (ELECTRIC)	#811 PROMENADE LANE	N/A
FPSR	FIRE PROTECTION SPRINKLER ROOM	#812 PROMENADE LANE	N/A
	-INDICATES COMMON ELEMENT (EXCLUDING AREAS OUTSIDE OF SUBMITTED LAND)		
	-INDICATES LIMITED COMMON ELEMENT (LCE) ASSIGNED TO A UNIT. # UNIT ASSIGNED		

I HEREBY CERTIFY THAT THIS PLAN IS ACCURATE AND THAT IT COMPLIES WITH THE PROVISIONS OF THE CODE OF VIRGINIA OF 1950 AS AMENDED, § 55-79.58 AND I FURTHER CERTIFY THAT ALL UNITS THEREOF DEPICTED HEREON, PURSUANT TO THE CODE OF VIRGINIA § 55-79.58B, ARE SUBSTANTIALLY COMPLETE.



5 Large/Small Plat(s) Recorded herewith as # 180010369

JCC Subdivision Agent Approval Not Required

City of Williamsburg & County of James City Circuit Court: This PLAT was recorded on June 20, 2018

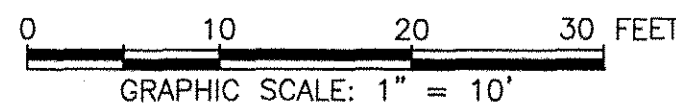

at 8:44 AM/PM, PG Document # 180010369 MONA A. FOLEY, CLERK JZ, Du. Clerk

THIS SHEET: FLOOR PLANS

PHASE 8
CONDOMINIUM PLAT AND PLAN
 OF
THE PROMENADE
 AT
JOHN TYLER
 A CONDOMINIUM
 JAMES CITY COUNTY, VIRGINIA

DATE: JUNE 11, 2018
 SCALE: 1"=10'
 SHEET 5 OF 5 THIS PHASE

Hayden Frye and Associates, Inc.
Land Surveyors
 333 KELLAM ROAD, SUITE 200
 VIRGINIA BEACH, VA, 23462
 PH: (757) 491-7228 FX: (757) 491-7229