

180010369

# BUILDING 8 (10-PLEX)

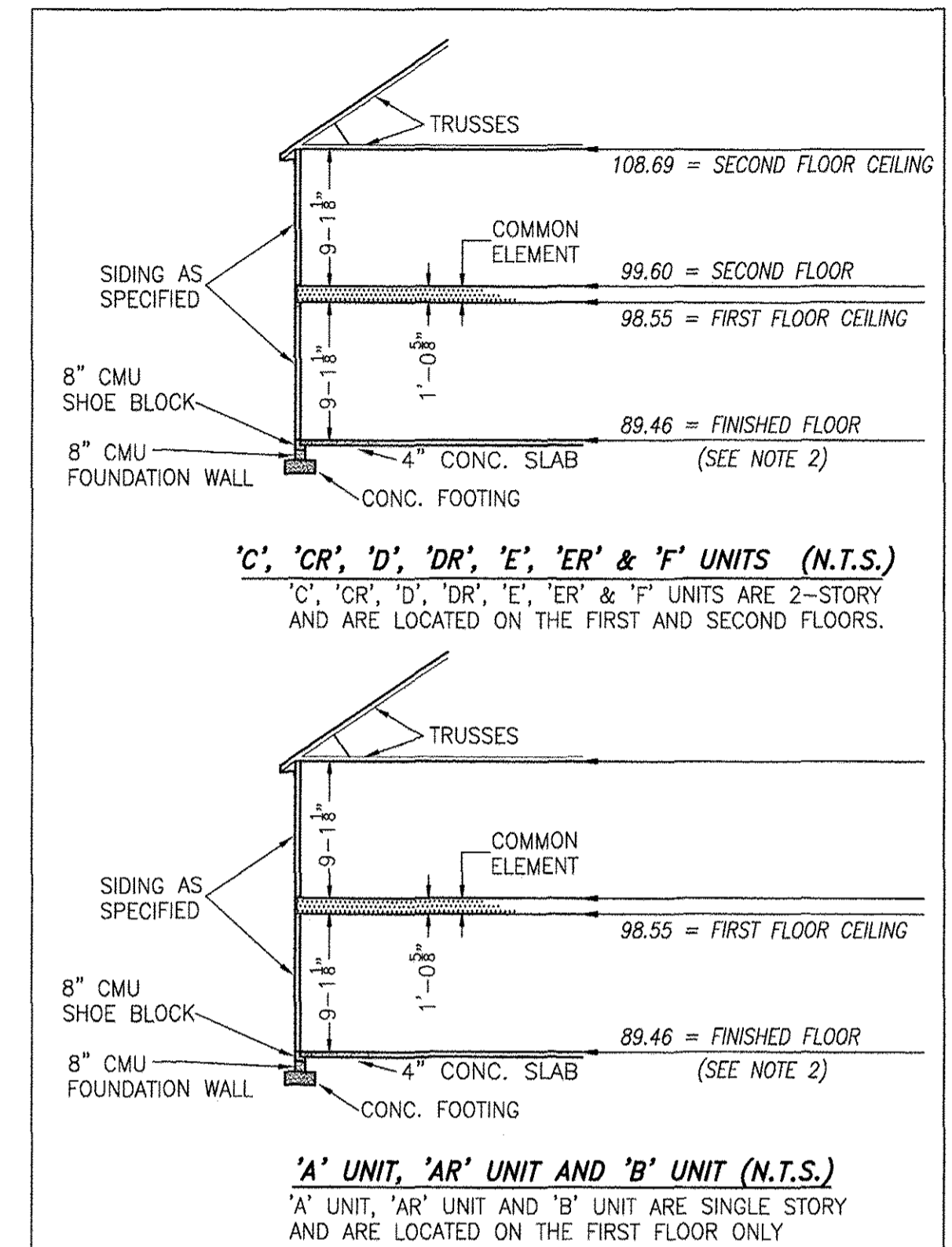
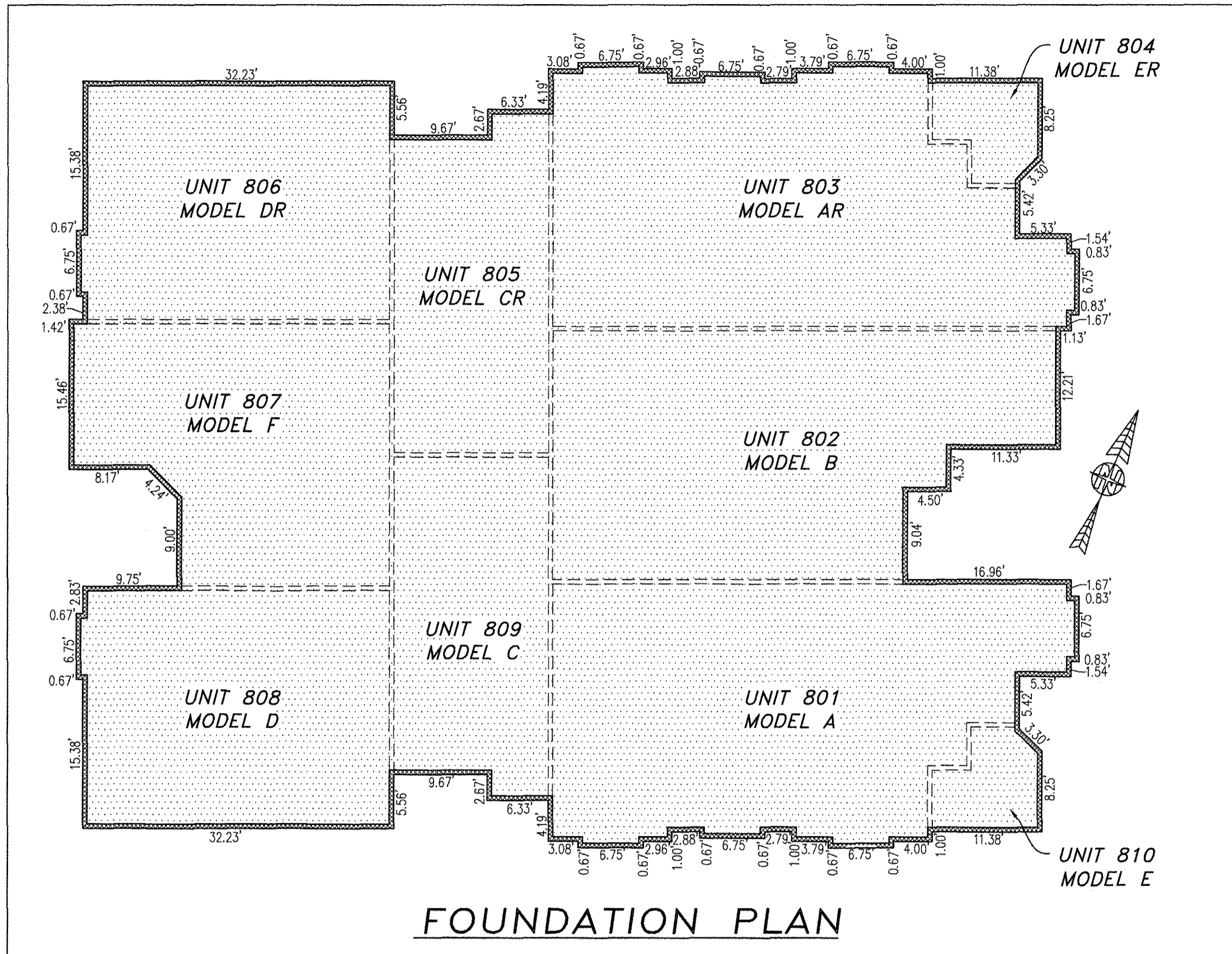

## TYPICAL BUILDING SECTION

NOT TO SCALE (N.T.S.)

NOTES:

1. VERTICAL DATUM REFERENCE: NATIONAL GEODETIC VERTICAL DATUM OF 1929 (NGVD29).
2. FINISHED FLOOR ELEVATION SHOWN WAS TAKEN FROM AS-BUILT SURVEY OF BUILDING #8 (10-PLEX) THE PROMENADE AT JOHN TYLER BY HAYDEN FRYE AND ASSOCIATES PERFORMED ON 06/04/2018.

I HEREBY CERTIFY THAT THIS PLAN IS ACCURATE AND THAT IT COMPLIES WITH THE PROVISIONS OF THE CODE OF VIRGINIA OF 1950 AS AMENDED, § 55-79.58 AND I FURTHER CERTIFY THAT ALL UNITS THEREOF DEPICTED HEREON, PURSUANT TO THE CODE OF VIRGINIA § 55-79.58B, ARE SUBSTANTIALLY COMPLETE.

5 Large/Small Plat(s) Recorded  
herewith as # 180010369



JCC Subdivision Agent  
Approval Not Required EGC

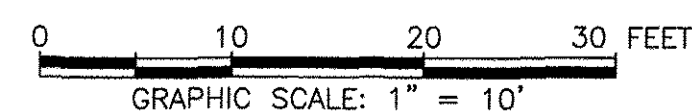

-INDICATES COMMON ELEMENT

City of Williamsburg & County of James City  
Circuit Court: This PLAT was recorded on  
June 20, 2018  
at 8:44 AM/PM, PB \_\_\_\_\_ PG \_\_\_\_\_  
Document # 180010369  
MONA A. FOLEY, CLERK JZ, DC.  
Mona A. Foley, Clerk

THIS SHEET: FOUNDATION PLAN AND SECTION

**PHASE 8**  
**CONDOMINIUM PLAT AND PLAN**  
OF  
**THE PROMENADE**  
AT  
**JOHN TYLER**  
A CONDOMINIUM  
JAMES CITY COUNTY, VIRGINIA

Jo# 160921

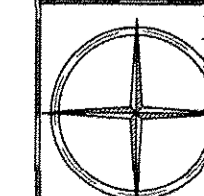

Hayden Frye and Associates, Inc.

**Land Surveyors**

333 KELLAM ROAD, SUITE 200  
VIRGINIA BEACH, VA, 23462  
PH: (757) 491-7228 FX: (757) 491-7229

DATE: JUNE 11, 2018

SCALE: 1"=10'

SHEET 4 OF 5 THIS PHASE